



RECORD PLANS

REVISED
4-3-2009

PVI NB 9+100.000
ELEV= 243.472
L = 200 m
M.O. = -0.432
K = 115

NOTE:
ELEVATIONS SHOWN ARE FOR THE ULTIMATE FINISHED GRADE.
THE TOP 50 MM PAVEMENT COURSE (TYPE IIIS) WILL NOT BE
CONSTRUCTED AS PART OF THIS CONTRACT. THIS CONTRACT
ONLY INCLUDES 100 MM OF TYPE IS AND 80 MM OF TYPE IIS
SUPERPAVE BITUMINOUS CONCRETE PAVEMENT (ITEM 490.30).
PLEASE REFER TO THE ROADWAY TYPICAL SECTIONS FOR DETAILS.

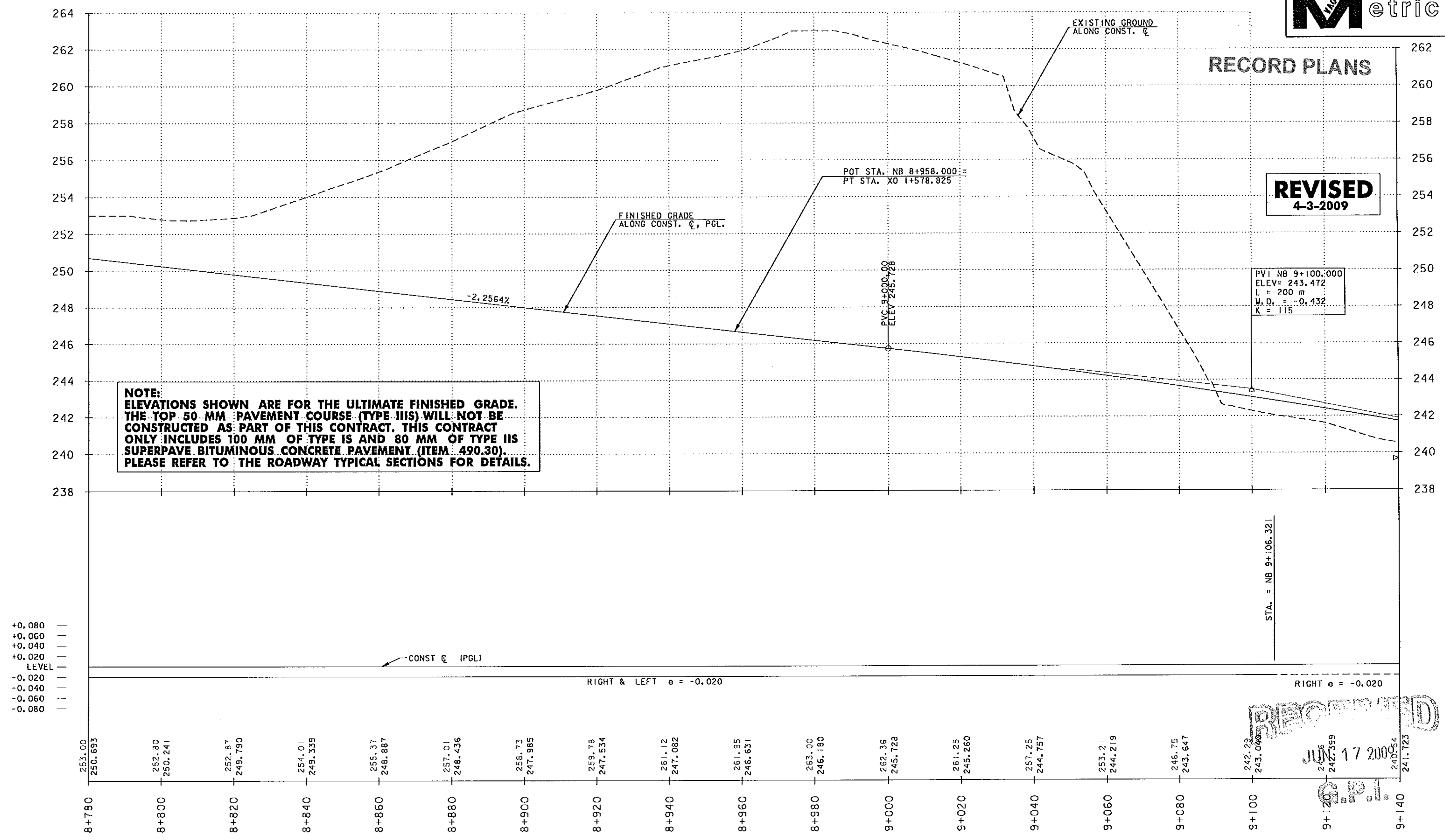

+0.080
+0.060
+0.040
+0.020
LEVEL
-0.020
-0.040
-0.060
-0.080

RIGHT & LEFT e = -0.020

RIGHT e = -0.020

RECORDED
JUN 17 2009
G.P.I.

v:\9535\active\9535\02\transportation\drawing\contract\3\work\revisions\2007\23rev\roadno_nb.pft

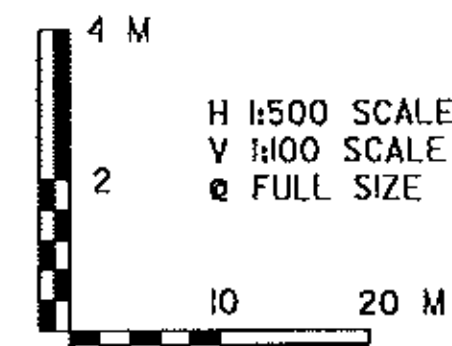

VERMONT AGENCY OF TRANSPORTATION



| | |
|---|------------------------|
| PROJECT NAME: BENNINGTON | PLOT DATE: 6/16/2009 |
| PROJECT NUMBER: AC NH 019-(K53) | DRAWN BY: STANTEC |
| FILE NAME: ...z\2307c3\revised.pro.nb.pft | CHECKED BY: GARY SANTY |
| DESIGN SUPERVISOR: GREG EDWARDS | SHEET 67 OF 577 |
| DESIGNED BY: MARC FOISY | |
| NORTHBOUND - PR-2 | |