

STA. NB 10+776.00  
END PROJECT NH F019-1(5)

END R.O.W. PROJECT  
STA. NB 10+558.86  
105.45 m (345.96') LT

VT. STATE PLANE GRID

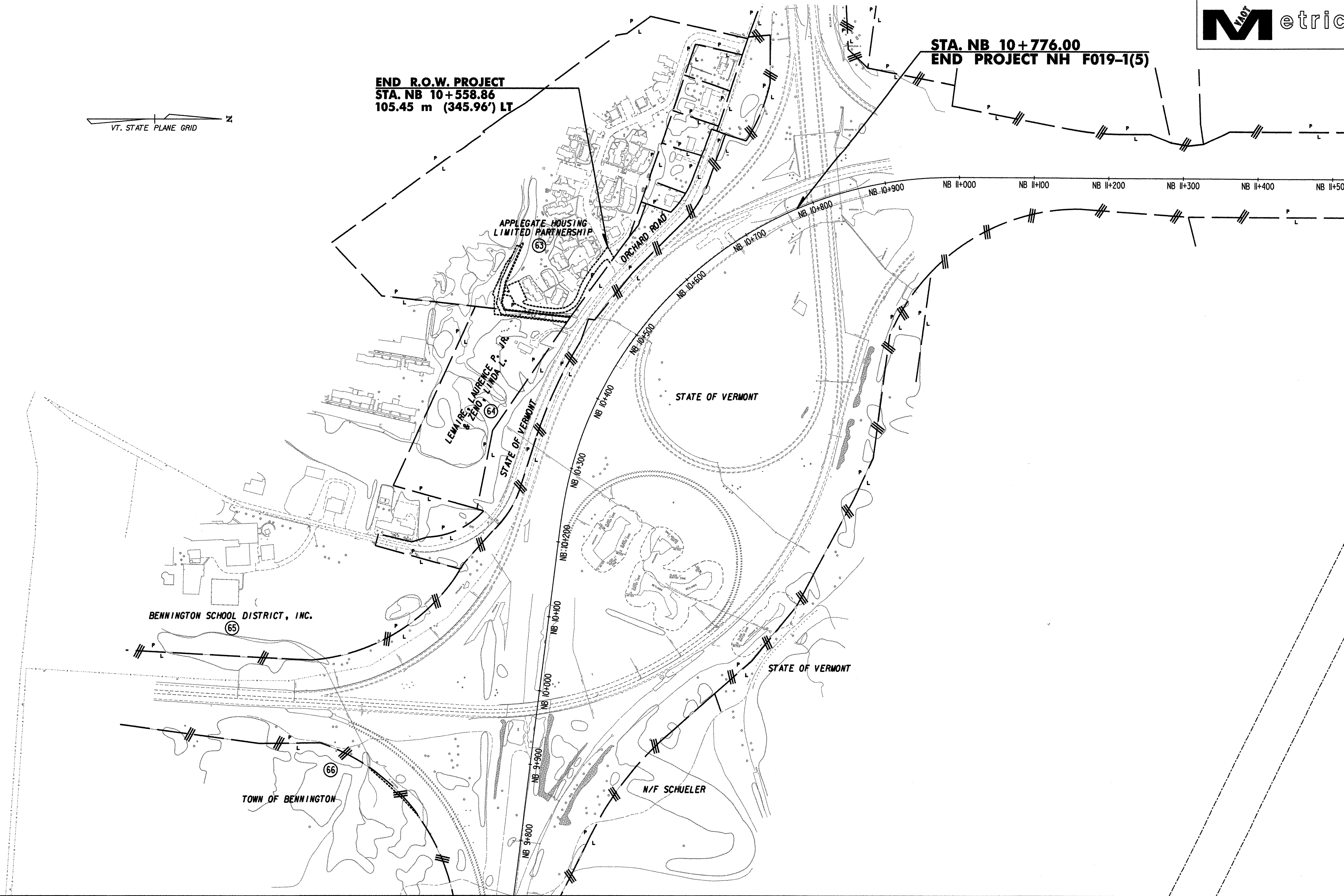

MATCHLINE - SHEET ROW-FF

LINES SHOWN ON THIS PLAN AS EXISTING PROPERTY LINES P/L ARE BELIEVED TO BE ACCURATE BUT SHOULD NOT BE RELIED UPON FOR PURPOSES UNRELATED TO THE STATE OF VERMONT'S ACQUISITION OF LAND AND RIGHTS FOR THIS PROJECT.

THIS SHEET TO BE USED FOR RIGHT-OF-WAY INFORMATION ONLY

DATUM  
VERTICAL NAVD 88  
HORIZONTAL NAD 83 (1992)

0 50 100 150  
SCALE 1:2500  
@ FULL SIZE

<b>ROW PLAN</b> <b>ROW-GG</b>	PROJECT NAME: BENNINGTON BYPASS	PROJECT NUMBER: NH F019-1(5)
	DESIGN FILE NAME: g:\nh\bennington\row PROJECT LEADER: JDP	PLOT DATE: 3-26-07 DRAWN BY: ADM CHECKED BY: GAK
		SHEET: 112 OF 112