

VT. STATE PLANE GRID

BENNINGTON SCHOOL DISTRICT INC.

65

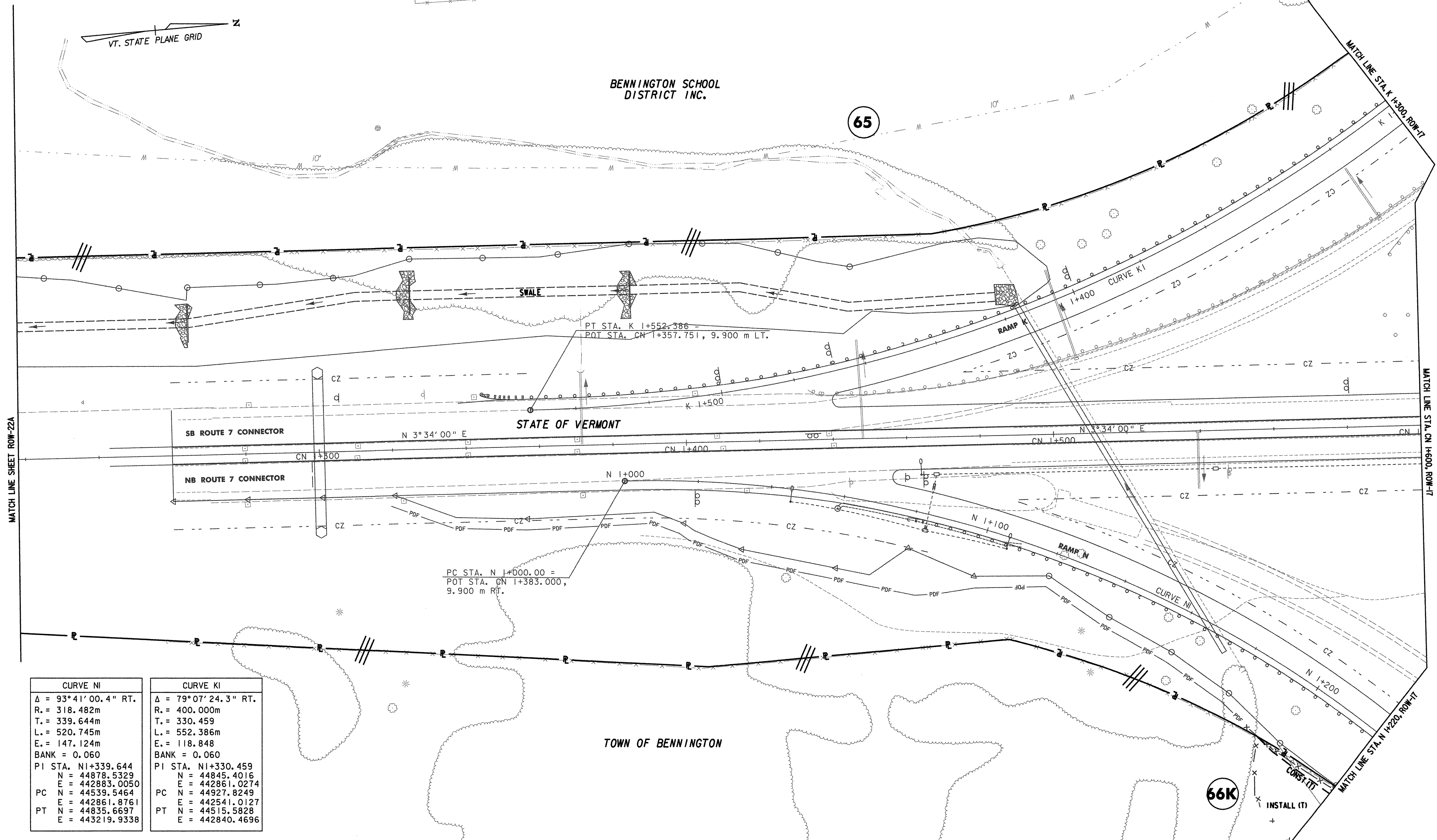

PT STA. K 1+552.386
POT STA. CN 1+357.751, 9.900 m LT.

PC STA. N 1+000.00 =
POT STA. CN 1+383.000,
9.900 m RT.

CURVE NI	CURVE KI
$\Delta = 93^\circ 41' 00.4''$ RT.	$\Delta = 79^\circ 07' 24.3''$ RT.
R. = 318.482m	R. = 400.000m
T. = 339.644m	T. = 330.459
L. = 520.745m	L. = 552.386m
E. = 147.124m	E. = 118.848
BANK = 0.060	BANK = 0.060
PI STA. N1+339.644	PI STA. N1+330.459
N = 44878.5329	N = 44845.4016
E = 442883.0050	E = 442861.0274
PC N = 44539.5464	PC N = 44927.8249
E = 442861.8761	E = 442541.0127
PT N = 44835.6697	PT N = 44515.5828
E = 443219.9338	E = 442840.4696

LINES SHOWN ON THIS PLAN AS EXISTING PROPERTY LINES P/L ARE BELIEVED TO BE ACCURATE BUT SHOULD NOT BE RELIED UPON FOR PURPOSES UNRELATED TO THE STATE OF VERMONT'S ACQUISITION OF LAND AND RIGHTS FOR THIS PROJECT.

THIS SHEET TO BE USED FOR RIGHT-OF-WAY INFORMATION ONLY

DATUM

VERTICAL	NAVD 88
HORIZONTAL	NAD 83 (1992)

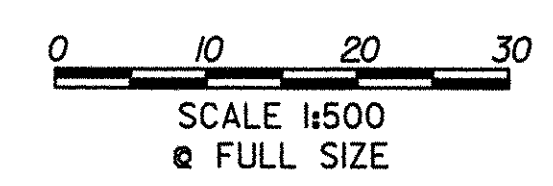

R.O.W. PLAN ROW-22	PROJECT NAME: BENNINGTON BYPASS	PROJECT NUMBER: NH F019-1(5)
	DESIGN FILE NAME: c:\ndh\bennington\row	PLOT DATE: 3-26-07
	PROJECT LEADER: JDP	DRAWN BY: MBB
		CHECKED BY: GAK
		SHEET: 94 OF 112