

REMOVING AND RESETTING FENCE
STA DRN 20+055 - DRN 20+220 RT

GATE FOR CHAIN-LINK FENCE, 1.8 m (6 FEET)
STA DRN 20+117.6 - DRN 20+120.0 RT
STA DRN 20+120.0 - DRN 20+122.4 RT
STA DRN 20+177.6 - DRN 20+180.0 RT
STA DRN 20+180.0 - DRN 20+182.4 RT

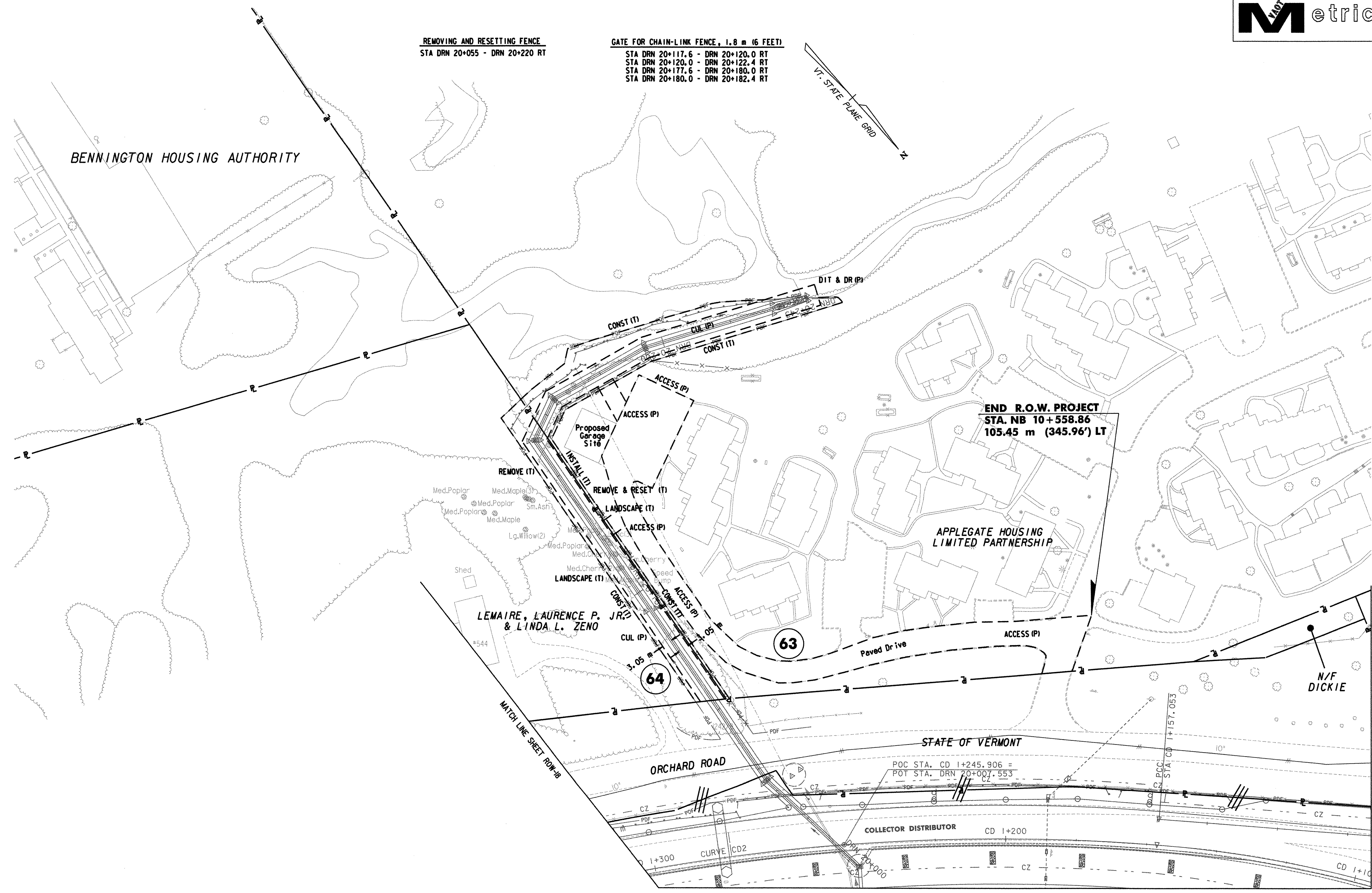
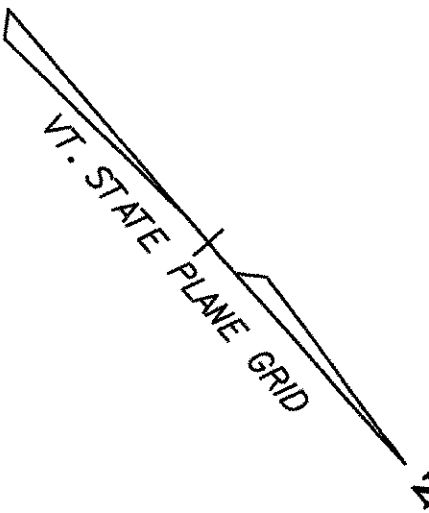

END R.O.W. PROJECT
STA. NB 10+558.86
105.45 m (345.96') LT

LEMAIRE, LAURENCE P. JR.
& LINDA L. ZENO

APPLGATE HOUSING
LIMITED PARTNERSHIP

ORCHARD ROAD

COLLECTOR DISTRIBUTOR

DATUM
VERTICAL NAVD 88
HORIZONTAL NAD 83 (1992)

LINES SHOWN ON THIS PLAN AS EXISTING PROPERTY LINES P/L ARE BELIEVED TO BE ACCURATE BUT SHOULD NOT BE RELIED UPON FOR PURPOSES UNRELATED TO THE STATE OF VERMONT'S ACQUISITION OF LAND AND RIGHTS FOR THIS PROJECT.

THIS SHEET TO BE USED FOR RIGHT-OF-WAY INFORMATION ONLY

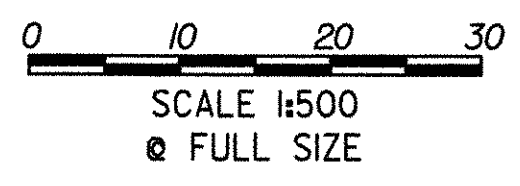

R.O.W. PLAN
ROW-19A

PROJECT NAME: BENNINGTON BYPASS
DESIGN FILE NAME: c:\dh\bennington\row
PROJECT LEADER: JDP

PROJECT NUMBER: NH FO19-1(5)
PLOT DATE: 1-30-06
DRAWN BY: MBB
CHECKED BY: GAK
SHEET: 91 OF 112