

11+20.70

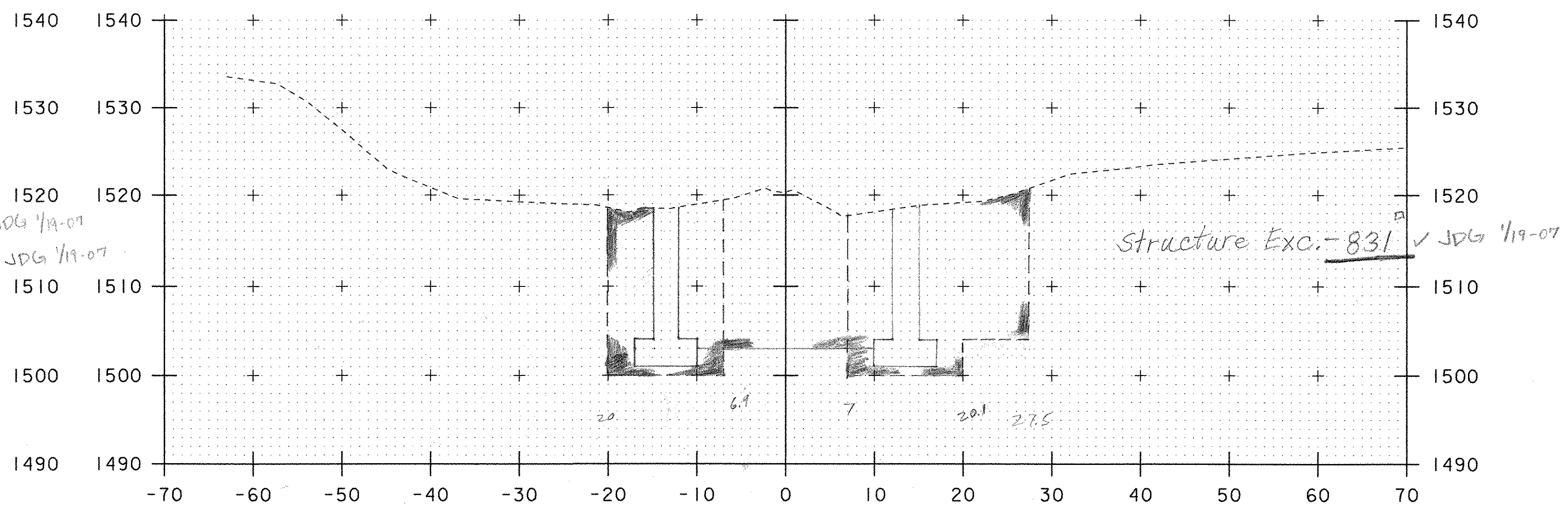

11+23.00

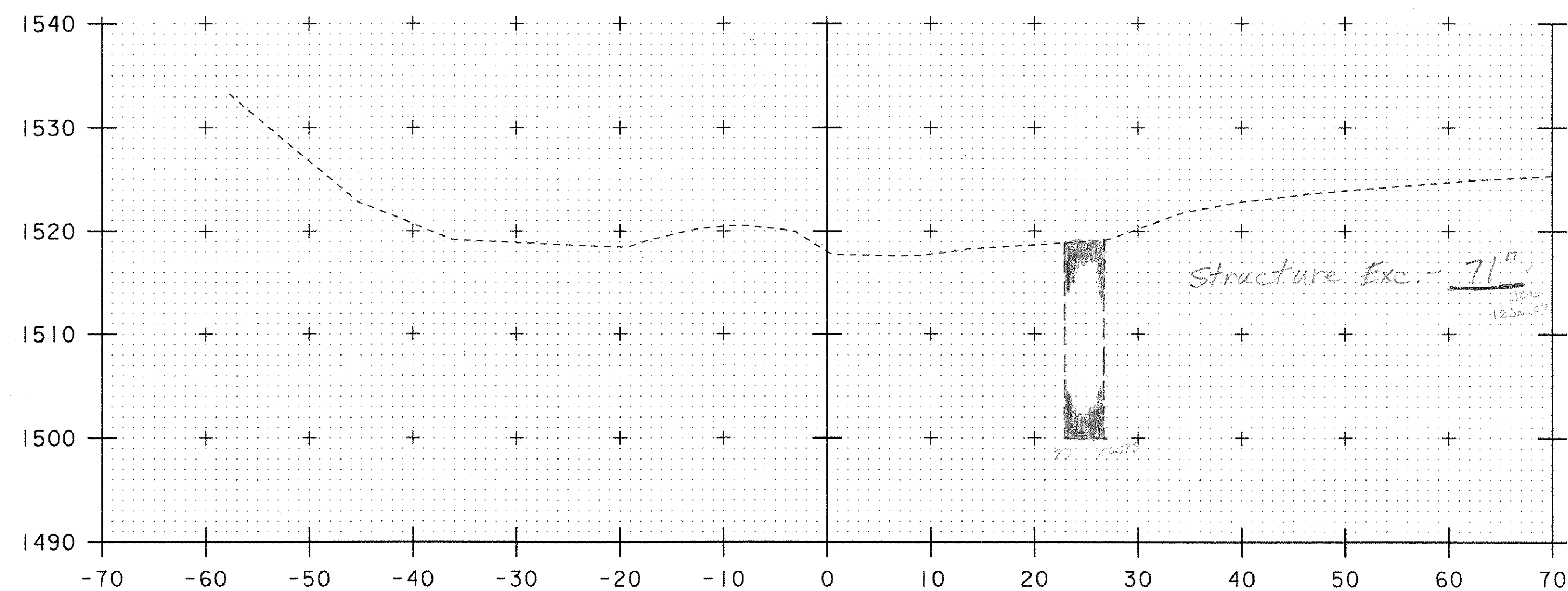

11+17.00

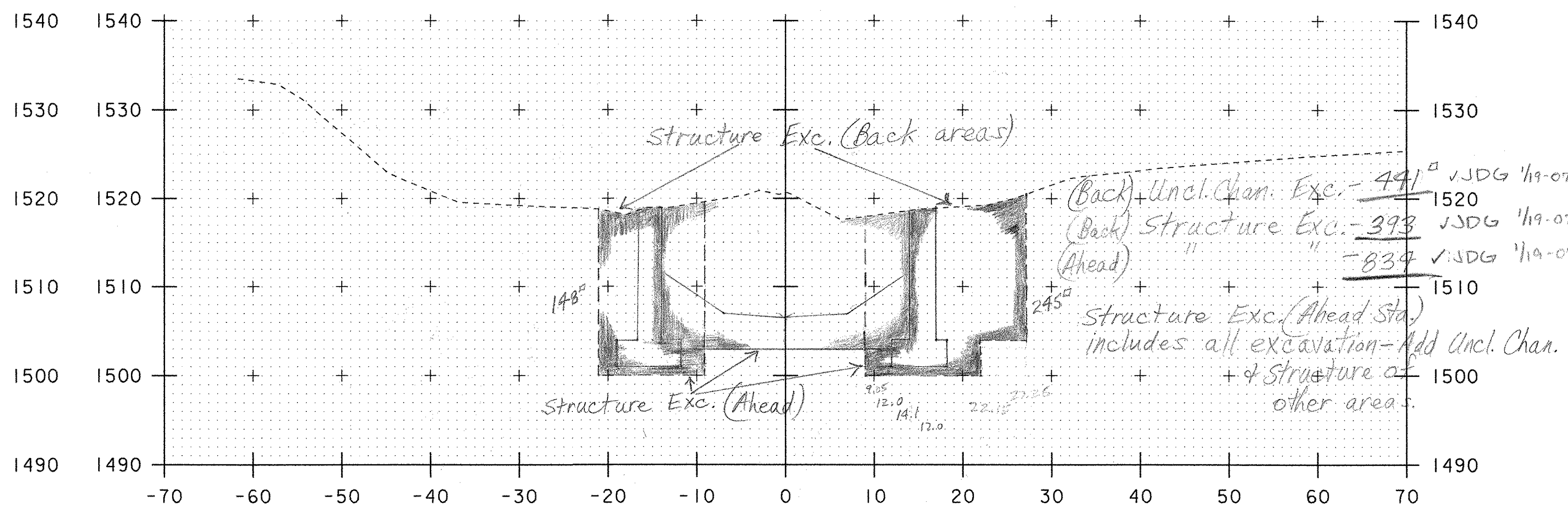

11+22.25

EXCAVATION LIMITS IN FRONT OF FOOTING - END UNCL. CHANNEL EXCAVATION.

PROJECT: WHITINGHAM	PROJECT NO.: ST CULV (6)
DESIGN FILE NAME: 05c128/structures/s05c128.dgn	PLOT DATE: 08-DEC-2006
IPARM FILE NAME:	DRAWN BY: E.L.RUSTAY
DESIGNED BY: E.L.RUSTAY	CHECKED BY:
SQUAD LEADER: C.P.WILLIAMS	SHEET: 78 OF 1
SECTIONS FOR M.HAUGHWOUT 12/8/06	

SCALE 1" = 10'-0"
10 0 10