

CURVE # 17  
 $\Delta$  42° 37' 31" RT  
 R = 1075'  
 D = 5° 19' 47"  
 T = 419'  
 L = 800'  
 BANKING 0.074 FT./FT.  
 175' RUNOFF (50 MPH)  
 SEE SHEET 26 FOR BANKING DETAIL

SHIM EXISTING GRAVEL TURN OUT WITH ITEM 402.13, "AGGREGATE SHOULDERS, RAP".

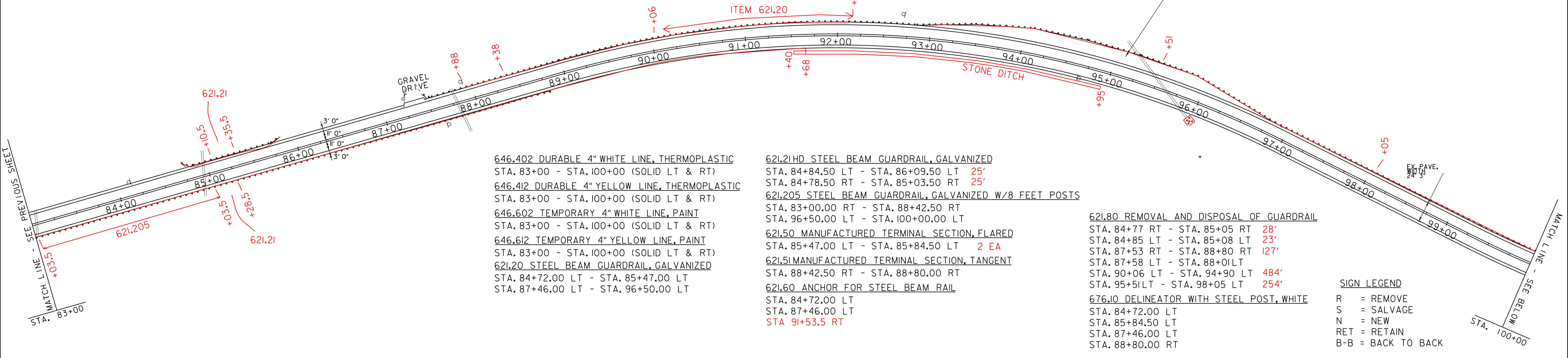

- 646.402 DURABLE 4" WHITE LINE, THERMOPLASTIC  
STA. 83+00 - STA. 100+00 (SOLID LT & RT)
- 646.412 DURABLE 4" YELLOW LINE, THERMOPLASTIC  
STA. 83+00 - STA. 100+00 (SOLID LT & RT)
- 646.602 TEMPORARY 4" WHITE LINE, PAINT  
STA. 83+00 - STA. 100+00 (SOLID LT & RT)
- 646.612 TEMPORARY 4" YELLOW LINE, PAINT  
STA. 83+00 - STA. 100+00 (SOLID LT & RT)
- 621.20 STEEL BEAM GUARDRAIL, GALVANIZED  
STA. 84+72.00 LT - STA. 85+47.00 LT  
STA. 87+46.00 LT - STA. 96+50.00 LT

- 621.21 HD STEEL BEAM GUARDRAIL, GALVANIZED  
STA. 84+84.50 LT - STA. 86+09.50 LT 25'  
STA. 84+78.50 RT - STA. 85+03.50 RT 25'
- 621.205 STEEL BEAM GUARDRAIL, GALVANIZED W/8 FEET POSTS  
STA. 83+00.00 RT - STA. 88+42.50 RT  
STA. 96+50.00 LT - STA. 100+00.00 LT
- 621.50 MANUFACTURED TERMINAL SECTION, FLARED  
STA. 85+47.00 LT - STA. 85+84.50 LT 2 EA
- 621.51 MANUFACTURED TERMINAL SECTION, TANGENT  
STA. 88+42.50 RT - STA. 88+80.00 RT
- 621.60 ANCHOR FOR STEEL BEAM RAIL  
STA. 84+72.00 LT  
STA. 87+46.00 LT  
STA. 91+53.5 RT

- 621.80 REMOVAL AND DISPOSAL OF GUARDRAIL  
STA. 84+77 RT - STA. 85+05 RT 28'  
STA. 84+85 LT - STA. 85+08 LT 23'  
STA. 87+53 RT - STA. 88+80 RT 127'  
STA. 87+58 LT - STA. 88+01 LT  
STA. 90+06 LT - STA. 94+90 LT 484'  
STA. 95+51 LT - STA. 98+05 LT 254'
- 676.10 DELINEATOR WITH STEEL POST, WHITE  
STA. 84+72.00 LT  
STA. 85+84.50 LT  
STA. 87+46.00 LT  
STA. 88+80.00 RT

**SIGN LEGEND**  
 R = REMOVE  
 S = SALVAGE  
 N = NEW  
 RET = RETAIN  
 B-B = BACK TO BACK

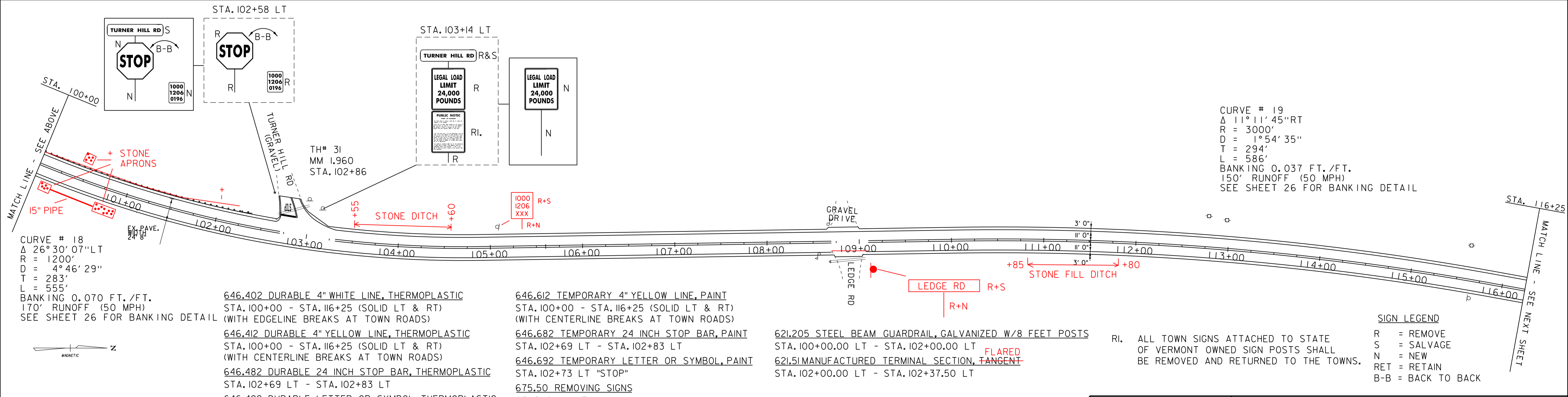

CURVE # 19  
 $\Delta$  11° 11' 45" RT  
 R = 3000'  
 D = 1° 54' 35"  
 T = 294'  
 L = 586'  
 BANKING 0.037 FT./FT.  
 150' RUNOFF (50 MPH)  
 SEE SHEET 26 FOR BANKING DETAIL

CURVE # 18  
 $\Delta$  26° 30' 07" LT  
 R = 1200'  
 D = 4° 46' 29"  
 T = 283'  
 L = 555'  
 BANKING 0.070 FT./FT.  
 170' RUNOFF (50 MPH)  
 SEE SHEET 26 FOR BANKING DETAIL

- 646.402 DURABLE 4" WHITE LINE, THERMOPLASTIC  
STA. 100+00 - STA. 116+25 (SOLID LT & RT)  
(WITH EDGELINE BREAKS AT TOWN ROADS)
- 646.412 DURABLE 4" YELLOW LINE, THERMOPLASTIC  
STA. 100+00 - STA. 116+25 (SOLID LT & RT)  
(WITH CENTERLINE BREAKS AT TOWN ROADS)
- 646.482 DURABLE 24 INCH STOP BAR, THERMOPLASTIC  
STA. 102+69 LT - STA. 102+83 LT
- 646.492 DURABLE LETTER OR SYMBOL, THERMOPLASTIC  
STA. 102+73 LT "STOP"
- 646.602 TEMPORARY 4" WHITE LINE, PAINT  
STA. 100+00 - STA. 116+25 (SOLID LT & RT)  
(WITH EDGELINE BREAKS AT TOWN ROADS)

- 646.612 TEMPORARY 4" YELLOW LINE, PAINT  
STA. 100+00 - STA. 116+25 (SOLID LT & RT)  
(WITH CENTERLINE BREAKS AT TOWN ROADS)
- 646.682 TEMPORARY 24 INCH STOP BAR, PAINT  
STA. 102+69 LT - STA. 102+83 LT
- 646.692 TEMPORARY LETTER OR SYMBOL, PAINT  
STA. 102+73 LT "STOP"
- 675.50 REMOVING SIGNS  
AS SHOWN - 5
- 675.60 ERECTING SALVAGED SIGNS  
AS SHOWN - 1
- 676.10 DELINEATOR WITH STEEL POST, WHITE  
STA. 102+37.50 LT

- 621.205 STEEL BEAM GUARDRAIL, GALVANIZED W/8 FEET POSTS  
STA. 100+00.00 LT - STA. 102+00.00 LT
- 621.51 MANUFACTURED TERMINAL SECTION, FLARED TANGENT  
STA. 102+00.00 LT - STA. 102+37.50 LT

RI. ALL TOWN SIGNS ATTACHED TO STATE OF VERMONT OWNED SIGN POSTS SHALL BE REMOVED AND RETURNED TO THE TOWNS.

**SIGN LEGEND**  
 R = REMOVE  
 S = SALVAGE  
 N = NEW  
 RET = RETAIN  
 B-B = BACK TO BACK

DATUM	
VERTICAL	N/A
HORIZONTAL	N/A

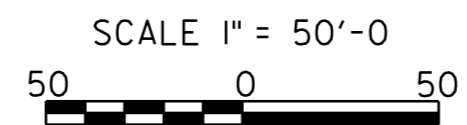

**PROJECT LAYOUT SHEET 5**

PROJECT NAME: MORETOWN-DUXBURY-MORETOWN	PLOT DATE: 31-OCT-2012 16:08
PROJECT NUMBER: STP 2507 (1)S	DRAWN BY: SJB/RHB
FILE NAME: p05b050.dgn	CHECKED BY: EPD
PROJECT LEADER: EPD	SHEET 17 OF 33
DESIGNED BY: CDL	
PLOT FILE: p05b050pi05.i	