

646.402 DURABLE 4 INCH WHITE LINE, THERMOPLASTIC OR
 646.403 DURABLE 4 INCH WHITE LINE, EPOXY PAINT OR
 646.404 DURABLE 4 INCH WHITE LINE, POLYUREA
 (ALL LINES WILL INCLUDE EDGE LINE BREAKS AND
 RADII FOR TOWN HIGHWAYS)
 WARREN:
 STA 291+50.00 - STA 297+50.00 LT & RT

646.412 DURABLE 4 INCH YELLOW LINE, THERMOPLASTIC OR
 646.413 DURABLE 4 INCH YELLOW LINE, EPOXY PAINT OR
 646.414 DURABLE 4 INCH YELLOW LINE, POLYUREA
 (ALL LINES WILL INCLUDE C/L BREAKS FOR
 TOWN HIGHWAYS) S=SOLID, D=DASHED
 WARREN: LT C RT
 STA 291+50.00 - STA 297+50.00 S - S
 STA 295+31.04 DOUBLE SOLID LT, TH-45
 STA 296+89.44 DOUBLE SOLID LT, TH-5

646.602 TEMPORARY 4 INCH WHITE LINE, PAINT
 (ALL LINES WILL INCLUDE EDGE LINE BREAKS AND
 RADII FOR TOWN HIGHWAYS)
 WARREN:
 STA 291+50.00 - STA 297+50.00 LT & RT

646.612 TEMPORARY 4 INCH YELLOW LINE, PAINT
 (ALL LINES WILL INCLUDE C/L BREAKS FOR
 TOWN HIGHWAYS) S=SOLID, D=DASHED
 WARREN: LT C RT
 STA 291+50.00 - STA 297+50.00 S - S
 STA 295+31.04 DOUBLE SOLID LT, TH-45
 STA 296+89.44 DOUBLE SOLID LT, TH-5

646.482 DURABLE 24 INCH STOP BAR, THERMOPLASTIC OR
 646.483 DURABLE 24 INCH STOP BAR, EPOXY PAINT OR
 646.484 DURABLE 24 INCH STOP BAR, POLYUREA
 WARREN:
 STA 295+31.04 LT, TH-45
 STA 296+89.44 LT, TH-5

646.492 DURABLE LETTER OR SYMBOL, THERMOPLASTIC OR
 646.493 DURABLE LETTER OR SYMBOL, EPOXY PAINT OR
 646.494 DURABLE LETTER OR SYMBOL, POLYUREA
 WARREN:
 STA 295+31.04 LT, TH-45, "S,T,O,P" (4 EA)
 STA 296+89.44 LT, TH-5, "S,T,O,P" (4 EA)

646.682 TEMPORARY 24 INCH STOP BAR, PAINT
 WARREN:
 STA 295+31.04 LT, TH-45
 STA 296+89.44 LT, TH-5
 646.692 TEMPORARY LETTER OR SYMBOL, PAINT
 WARREN:
 STA 295+31.04 LT, TH-45, "S,T,O,P" (8 EA)
 STA 296+89.44 LT, TH-5, "S,T,O,P" (8 EA)

675.50 REMOVING SIGNS
 AS SHOWN - 6

675.60 ERECTING SALVAGED SIGNS
 AS SHOWN - 2

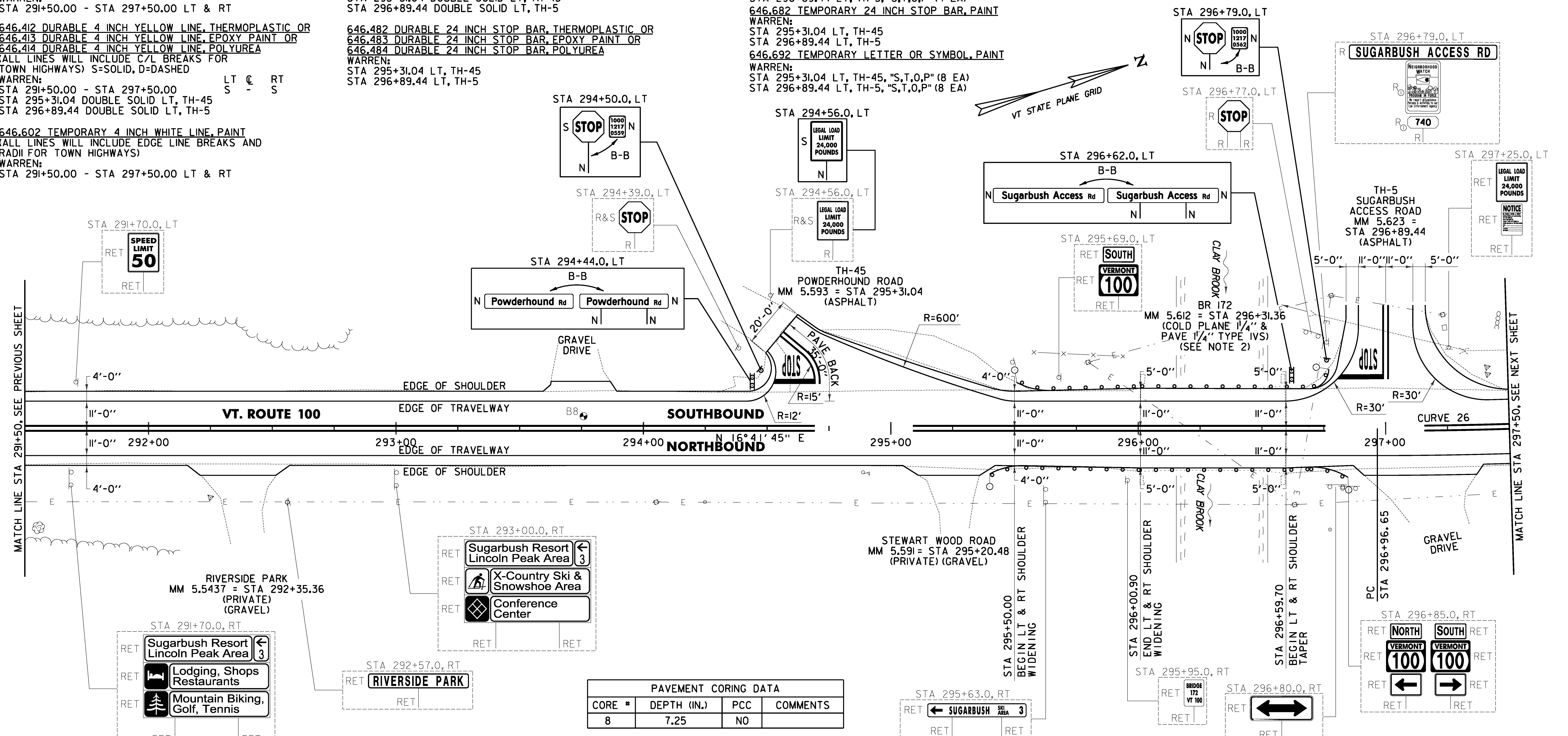

PAVEMENT CORING DATA			
CORE #	DEPTH (IN.)	PCC	COMMENTS
8	7.25	NO	

621.70 GUARDRAIL APPROACH SECTION, GALVANIZED TYPE I
 WARREN:
 STA 295+51.0 - STA 296+01.0 RT

621.71 GUARDRAIL APPROACH SECTION, GALVANIZED TYPE II
 WARREN:
 STA 295+88.5 - STA 296+01.0 LT
 STA 296+60.0 - STA 296+72.5 RT
 STA 296+60.0 - STA 296+72.5 LT

621.80 REMOVAL AND DISPOSAL OF GUARDRAIL
 WARREN:
 STA 295+40.0 - STA 296+01.0 RT (61.0 LF)
 STA 295+51.0 - STA 296+01.0 LT (50.0 LF)
 STA 296+60.0 - STA 296+87.0 RT (27.0 LF)
 STA 296+60.0 - STA 296+84.0 LT (27.0 LF)

676.10 DELINEATOR WITH STEEL POST
 WARREN:
 STA 295+36.5 RT
 STA 295+49.0 LT
 STA 296+87.0 RT
 STA 296+84.0 LT

621.205 STEEL BEAM GUARDRAIL, GALVANIZED W/8 FEET POSTS
 WARREN:
 STA 295+36.5 - STA 295+51.0 RT (14.5 LF)
 STA 295+49.0 - STA 295+88.5 LT (39.5 LF)
 STA 296+72.5 - STA 296+87.0 RT (14.5 LF)
 STA 296+72.5 - STA 296+84.0 LT (14.5 LF)

621.60 ANCHOR FOR STEEL BEAM RAIL
 WARREN:
 STA 295+43.0 RT
 STA 295+55.5 LT
 STA 296+77.5 LT
 STA 296+80.5 RT

NOTES:
 1. PAVING LIMIT ON ALL TOWN HIGHWAYS SHALL BE MEASURED 25 FT BACK FROM VT. ROUTE 100 EDGE OF SHOULDER UNLESS DENOTED OTHERWISE ON THE PLANS OR AS DIRECTED BY THE ENGINEER.
 2. SEE SHEET 308 FOR BR 172 DETAILS.

CURVE 26
 $\Delta = 16^{\circ}06'52''$
 $D = 3^{\circ}10'59''$
 $R = 1800.00'$
 $T = 254.81'$
 $L = 506.25'$
 $E = 17.95'$
 $e = 0.055 \text{ FT/FT}$

SIGN LEGEND
 R = REMOVE
 S = SALVAGED
 N = NEW
 RET = RETAIN
 B-B = BACK TO BACK
 EXISTING = -----
 NEW = _____
 ⊙ = RETURN TO THE TOWN OF WARREN



PROJECT LAYOUT SHEET #46

LEGEND
 [Pattern] ITEM 613.10 STONE FILL, TYPE I
 [Pattern] ITEM 653.20 TEMPORARY EROSION MATTING

PROJECT NAME: WARREN - WAITSFIELD
 PROJECT NUMBER: STP 2506(1)
 FILE NAME: p05b048.dgn
 PROJECT LEADER: D.E.G.
 DESIGNED BY: M.J.M.
 IPARM FILE: p05b048i46.t

PLOT DATE: 12/20/2012
 DRAWN BY: W.G.P.
 CHECKED BY: D.E.G.
 SHEET 72 OF 310

FILE NAME: UN17762.CADD.NSTWSTP_2506.p05b048.Contrast_Plan.dgn
 DATE/TIME: 12/20/2012 4:06:58 PM
 USER: J.4866