

E1545800
N131000

NEW 18" x 77' CSP OR CPEP (SL)
@ INLET AND 3' x 6' STONE FILL,
TYPE II @ OUTLET
STA 123+55.2 - STA 123+80.6 RT/LT

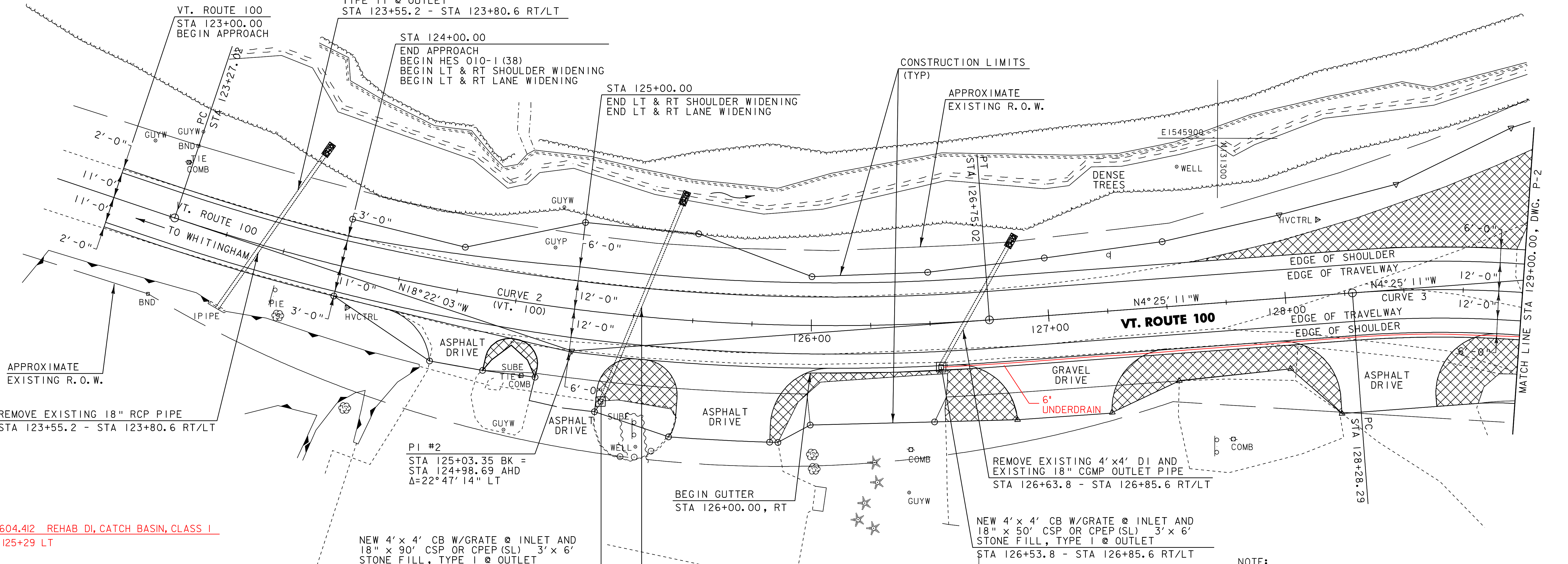

APPROXIMATE
EXISTING R.O.W.

REMOVE EXISTING 18" RCP PIPE
STA 123+55.2 - STA 123+80.6 RT/LT

604.412 REHAB DI, CATCH BASIN, CLASS I
125+29 LT

PI #2
STA 125+03.35 BK =
STA 124+98.69 AHD
Δ=22°47'14" LT

NEW 4' x 4' CB W/GRATE @ INLET AND
18" x 90' CSP OR CPEP (SL) 3' x 6'
STONE FILL, TYPE I @ OUTLET
STA 125+18.8 - STA 125+40.6 RT/LT

SAVED TIE TO NEW CATCH BASIN @ 125+40.6
REMOVE EXISTING 4' x 4' DI AND
REMOVED EXISTING 18" CGMP PIPE
STA 125+15.8 - STA 125+40.6 RT/LT

BEGIN GUTTER
STA 126+00.00, RT

REMOVE EXISTING 4' x 4' DI AND
EXISTING 18" CGMP OUTLET PIPE
STA 126+63.8 - STA 126+85.6 RT/LT

NEW 4' x 4' CB W/GRATE @ INLET AND
18" x 50' CSP OR CPEP (SL) 3' x 6'
STONE FILL, TYPE I @ OUTLET
STA 126+53.8 - STA 126+85.6 RT/LT

CONSTRUCT DRIVEWAY

VT. ROUTE 100:
STA 124+55.0 RT
STA 125+05.0 RT
STA 125+65.0 RT
STA 127+05.0 RT
STA 128+40.0 RT

616.47 BITUMINOUS CONCRETE GUTTERS AND TRAFFIC ISLANDS

VT. ROUTE 100:
STA 126+00.0 - STA. 129+00.0 RT (+10.6 TON)
125+20 RT 0.6 TON 4.66

CURVE 2 (VT. 100)

Delta = 22°47'14"
D = 6°32'53.12"
R = 875.00'
T = 176.33'
L = 348.00'
E = 17.59'

CURVE 3 (VT. 100)

Delta = 21°20'18"
D = 11°27'33"
R = 500.00'
T = 94.20'
L = 186.21'
E = 8.80'

EXISTING VT ROUTE 100
PAVEMENT TO BE REMOVED,
SEE NOTE 1.

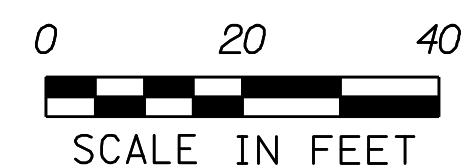

NOTE:

- 1. THE CONTRACTOR SHALL REMOVE THE TOP 18" OF THE EXISTING VT. ROUTE 100 ROAD SURFACE LOCATED OUTSIDE THE PROPOSED ROADWAY. THE CONTRACTOR SHALL COMPACT THE EXCAVATED MATERIAL WITH EARTH BORROW AND 1 1/2" ROUGH TOP SOIL ROAD AS DIRECTED BY THE RESIDENT ENGINEER.

PROJECT LAYOUT SHEET 3

PROJECT NAME:	WILMINGTON	FILE NAME:	p05c324.dgn	PLOT DATE:	23-APR-2024 10:48:43
PROJECT NUMBER:	HES_OIO-1(38)	PROJECT LEADER:	DEC	DRAWN BY:	CAK
		DESIGNED BY:	DWE	CHECKED BY:	DWE