

STATE OF VERMONT AGENCY OF TRANSPORTATION



INTERSECTION RECONSTRUCTION TOWN OF WILMINGTON COUNTY OF WINDHAM VT. ROUTE 9 & VT. ROUTE 100

BEGINNING IN THE TOWN OF WILMINGTON ON VT. ROUTE 9 AT STA. 218+00.00
AND EXTENDING EASTERLY FOR A DISTANCE OF 750.00 FEET TO A
POINT IN THE TOWN OF WILMINGTON AT STA. 225+50.00

THIS PROJECT ALSO BEGINS AT A POINT APPROXIMATELY 0.146 MILES SOUTH OF THE VT. ROUTE 9 & VT. ROUTE 100 INTERSECTION
AT STA 123+00.00 IN THE TOWN OF WILMINGTON AND EXTENDS NORTHERLY FOR A DISTANCE OF 77.22 FEET (0.146 MILES) TO A
POINT AT STA. 130+71.21 IN THE TOWN OF WILMINGTON AT THE INTERSECTION OF VT. ROUTE 9 & VT. ROUTE 100.

LENGTH OF ROADWAY 1,521.21 FT (0.288 MILES)
LENGTH OF PROJECT 1,521.21 FT (0.288 MILES)

WORK TO BE PERFORMED UNDER THIS PROJECT INCLUDES RECONSTRUCTING A PORTION OF THE EXISTING HIGHWAY
ON A NEW LOCATION, RESURFACING A PORTION OF THE EXISTING HIGHWAY WITH A SHIM/LEVELING COURSE AND
WEARING COURSE, NEW PAVEMENT MARKINGS, DRAINAGE IMPROVEMENTS, NEW SIGNS AND INCIDENTAL ITEMS.

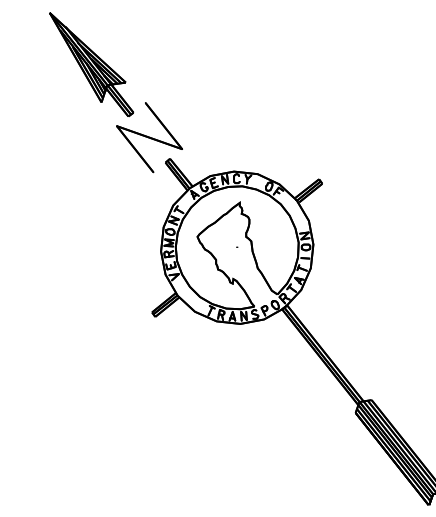
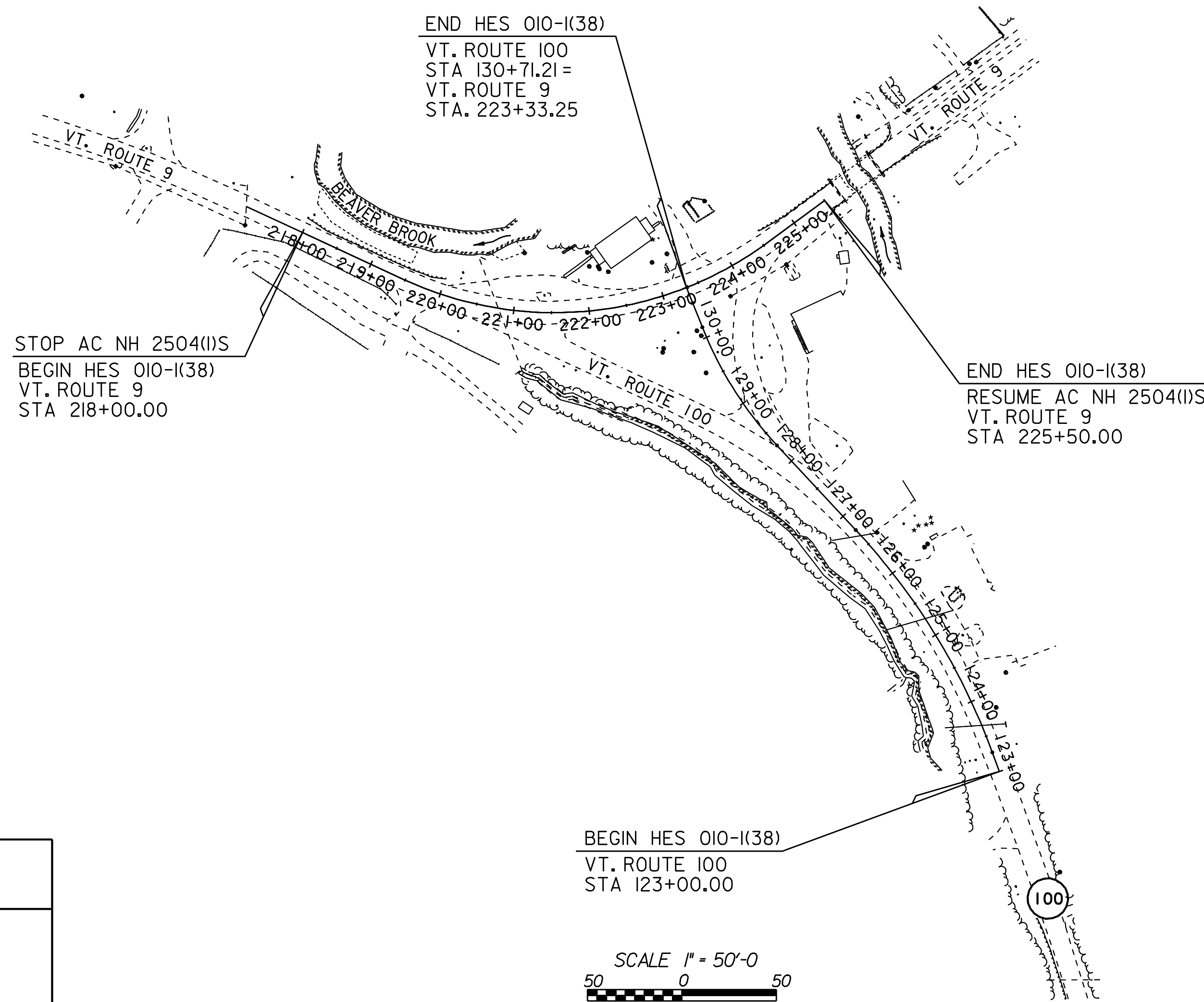
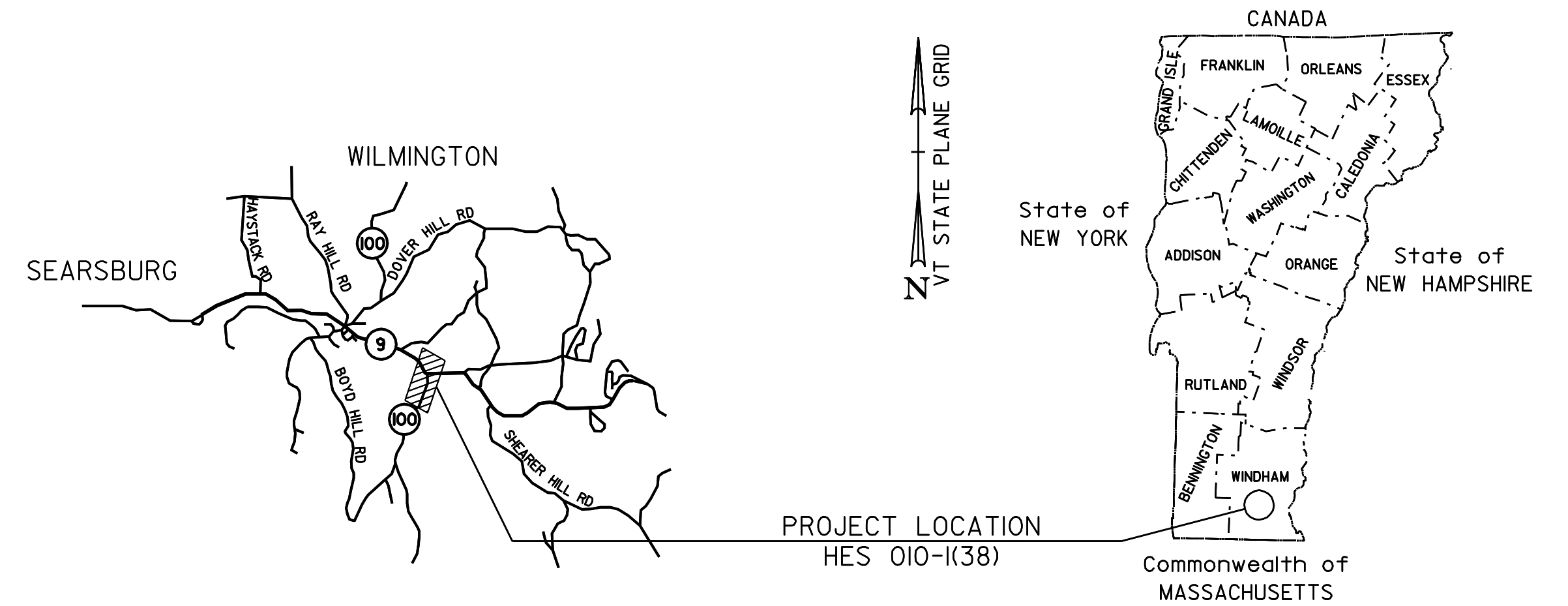

BITUMINOUS CONCRETE PAVEMENT SUPERPAVE MIXTURE DESIGN CRITERIA	
DESIGN LANE/DESIGN LIFE ESALS	2,319,500
DESIGN NUMBER OF GYRATIONS	65
PERFORMANCE GRADED ASPHALT BINDER	58-28

CONVENTIONAL SYMBOLS	
COUNTY LINE	---
TOWN LINE	----
LIMITS OF ACCESS	○-----○
POINT OF ACCESS	X
FENCE LINE	X---X---X---X---
STONE WALL	○-----○
TRAVELED WAY	----
GUARD RAIL	○-----○
RAILROAD	
SURVEY LINE	+
CULVERT	-----
POWER POLE	⊕
TELEPHONE POLE	⊙
TREES	⊗
CONTROL OF ACCESS	///
PROPERTY LINE	---
R.O.W. TAKING LINE	SR
SLOPE RIGHTS	△
TOP OF CUT	△
TOE OF SLOPE	○

SURVEYED BY : NA
SURVEYED DATE : NA

DATUM
VERTICAL NA
HORIZONTAL NA

BEGIN HES 010-I(38)
VT. ROUTE 100
STA 123+00.00

SCALE 1" = 50'-0"
50 0 50

THESE PLANS ARE SUBJECT TO SUCH ENGINEERING CHANGES AS MAY BE REQUIRED BY THE FEDERAL HIGHWAY ADMINISTRATION OR THE DIRECTOR OF PROGRAM DEVELOPMENT.

CONSTRUCTION IS TO BE CARRIED ON IN ACCORDANCE WITH THESE PLANS AND THE STANDARD SPECIFICATIONS FOR CONSTRUCTION DATED 2006, AS APPROVED BY THE FEDERAL HIGHWAY ADMINISTRATION ON JUNE 15, 2006 FOR USE ON THIS PROJECT, INCLUDING ALL SUBSEQUENT REVISIONS AND SUCH REVISED SPECIFICATIONS AND SPECIAL PROVISIONS AS ARE INCORPORATED IN THESE PLANS.

DIRECTOR OF PROGRAM DEVELOPMENT	
APPROVED _____	DATE _____
PROJECT MANAGER : TED DOMEY	
PROJECT NAME : WILMINGTON	
PROJECT NUMBER : HES 010-I (38)	
SHEET 79 OF 125 SHEETS	