

646.402 DURABLE 4 INCH WHITE LINE, THERMOPLASTIC
(ALL LINES WILL INCLUDE EDGE LINE BREAKS AND RADIUS FOR TOWN HIGHWAYS)

WILMINGTON:
STA. 332+00.00 - STA. 348+00.00 EDGE LINE LT & RT
STA. 332+00.00 - STA. 348+00.00 DASHED LINE RT

646.412 DURABLE 4 INCH YELLOW LINE, THERMOPLASTIC
(ALL LINES WILL INCLUDE C/L BREAKS FOR TOWN HIGHWAYS) S=SOLID, D=DASHED

WILMINGTON:
STA. 332+00.00 - STA. 348+00.00 LT S C RT S
STA. 339+08.00 DOUBLE SOLID RT, SFH

646.602 TEMPORARY 4 INCH WHITE LINE, PAINT
(ALL LINES WILL INCLUDE EDGE LINE BREAKS AND RADIUS FOR TOWN HIGHWAYS)

WILMINGTON:
STA. 332+00.00 - STA. 348+00.00 EDGE LINE LT & RT
STA. 332+00.00 - STA. 348+00.00 DASHED LINE RT

646.612 TEMPORARY 4 INCH YELLOW LINE, PAINT
(ALL LINES WILL INCLUDE C/L BREAKS FOR TOWN HIGHWAYS) S=SOLID, D=DASHED

WILMINGTON:
STA. 332+00.00 - STA. 348+00.00 LT S C RT S
STA. 339+08.00 DOUBLE SOLID RT, SFH

646.482 TEMPORARY 24 INCH STOP BAR, THERMOPLASTIC
WILMINGTON:
STA. 339+08.00 RT, SFH

646.682 TEMPORARY 24 INCH STOP BAR, PAINT
WILMINGTON:
STA. 339+08.00 RT, SFH

646.492 DURABLE LETTER OR SYMBOL, THERMOPLASTIC
WILMINGTON:
STA. 339+08.00 RT, SFH 'S,T,O,P' (4 EA)

646.692 TEMPORARY LETTER OR SYMBOL, PAINT
WILMINGTON:
STA. 339+08.00 RT, SFH 'S,T,O,P' (4 EA)

675.50 REMOVING SIGNS
AS SHOWN - II

675.60 ERECTING SALVAGED SIGNS
AS SHOWN - I

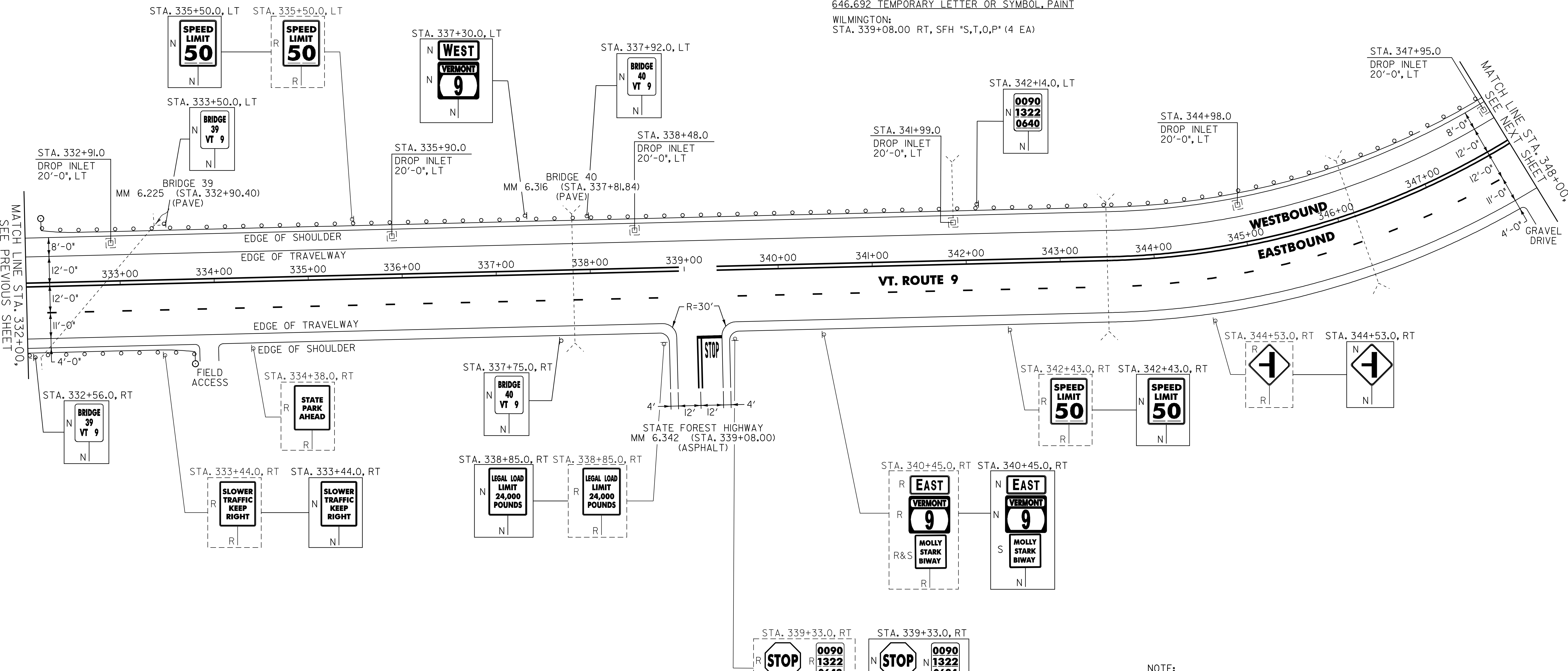

604.412 REHAB. DROP INLETS, CATCH BASINS, OR MANHOLES, CLASS I
WILMINGTON:
STA. 332+91.0 LT 333+07 LT
STA. 335+90.0 LT 336+05 LT
STA. 338+48.0 LT 338+61 LT
STA. 341+99.0 LT 342+14 LT
STA. 344+98.0 LT 345+12 LT
STA. 347+95.0 LT

621.20 STEEL BEAM GUARDRAIL, GALVANIZED
WILMINGTON:
STA. 332+00.0 - STA. 333+8.0 RT (18.0 LF)
STA. 332+52.5 - STA. 348+00.0 LT (1547.5 LF)
33 33
33 33

621.50 MANUFACTURED TERMINAL SECTION, FLARED
WILMINGTON:
STA. 332+15.0 - STA. 332+52.5 LT 33
STA. 333+8.0 - STA. 333+56.5 RT 33
33 33
621.80 REMOVAL AND DISPOSAL OF GUARDRAIL
WILMINGTON:
STA. 332+16.0 - STA. 348+00.0 LT (1584.0 LF)
STA. 332+00.0 - STA. 333+53.0 RT (153.0 LF)

676.10 DELINEATOR WITH STEEL POST
TYPE I WHITE
WILMINGTON:
STA. 332+15.0 LT
STA. 333+56.5 RT

NOTE:
I. PAVING LIMIT ON ALL TOWN HIGHWAYS SHALL BE MEASURED 25 FT BACK FROM VT. ROUTE 9 EDGE OF SHOULDER UNLESS DENOTED OTHERWISE ON THE PLANS OR AS DIRECTED BY THE RESIDENT ENGINEER.

SIGN LEGEND
R = REMOVE
S = SALVAGE
N = NEW
RET = RETAIN
B-B = BACK TO BACK
EXISTING = - - - - -
NEW = _____

NOT TO SCALE

PROJECT LAYOUT SHEET #18

PROJECT NAME: WILMINGTON
PROJECT NUMBER: AC_NH_2504(I)S
FILE NAME: p05b044.dgn__ PLOT DATE: 23-AUG-2010 14
PROJECT LEADER: D.E.G. DRAWN BY: C.A.K.
DESIGNED BY: M.J.M. CHECKED BY: D.W.E.
IPARM FILE: p05b044L18.i SHEET 37 OF 125