

646.402 DURABLE 4 INCH WHITE LINE, THERMOPLASTIC
 (ALL LINES WILL INCLUDE EDGE LINE BREAKS AND
 RADIUS FOR TOWN HIGHWAYS)
 WILMINGTON:
 STA. 225+50.00 - STA. 236+00.00 EDGE LINE LT & RT

646.412 TEMPORARY 4 INCH YELLOW LINE, THERMOPLASTIC
 (ALL LINES WILL INCLUDE C/L BREAKS FOR
 TOWN HIGHWAYS) S=SOLID, D=DASHED
 WILMINGTON:
 STA. 225+50.00 - STA. 236+00.00 LT S - RT S

646.602 TEMPORARY 4 INCH YELLOW LINE, PAINT
 (ALL LINES WILL INCLUDE EDGE LINE BREAKS AND
 RADIUS FOR TOWN HIGHWAYS)
 WILMINGTON:
 STA. 225+50.00 - STA. 236+00.00 EDGE LINE LT & RT

646.612 TEMPORARY 4 INCH YELLOW LINE, PAINT
 (ALL LINES WILL INCLUDE C/L BREAKS FOR
 TOWN HIGHWAYS) S=SOLID, D=DASHED
 WILMINGTON:
 STA. 225+50.00 - STA. 236+00.00 LT S - RT S

675.50 REMOVING SIGNS
 AS SHOWN - 13

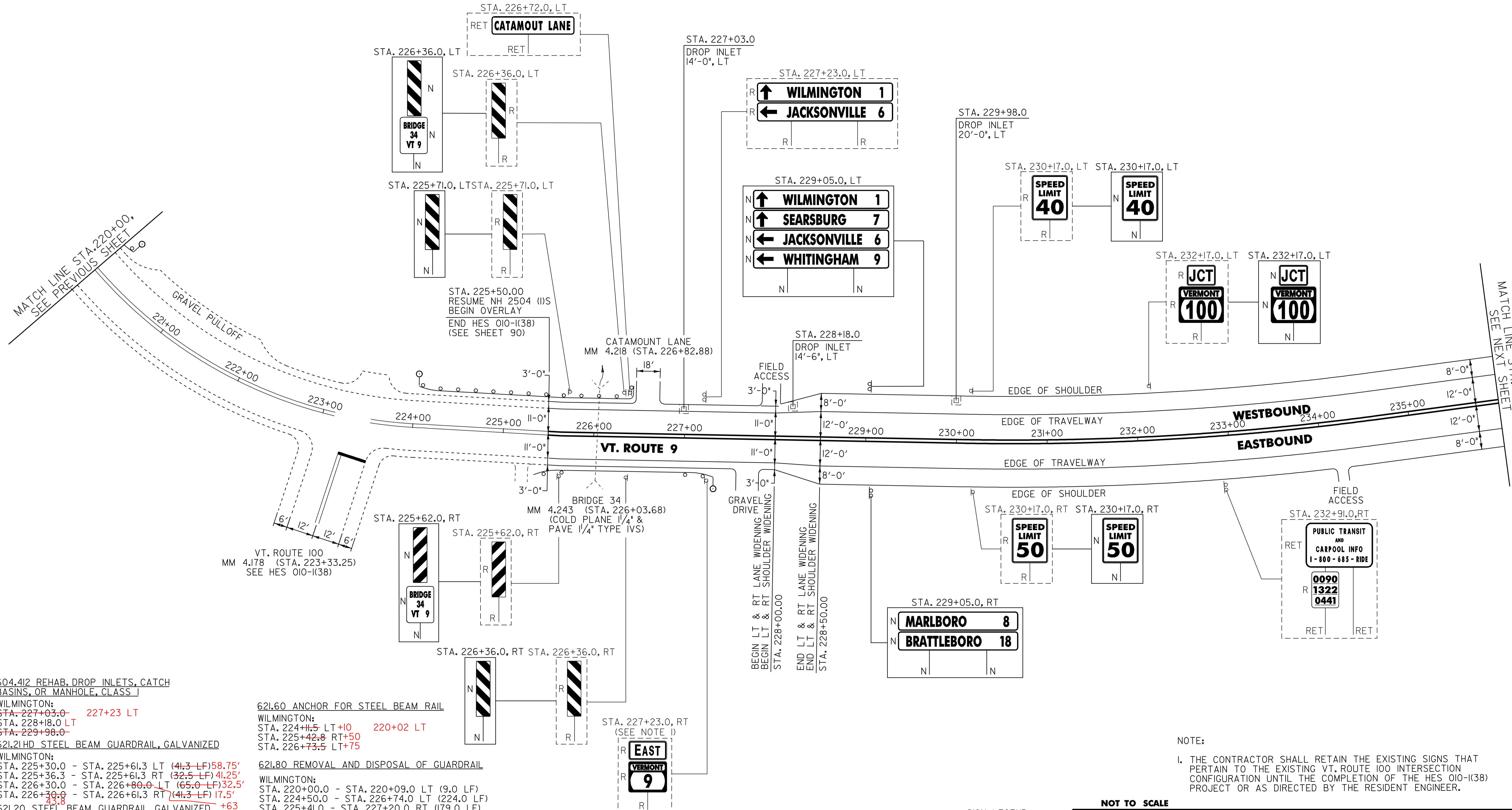

604.412 REHAB. DROP INLETS, CATCH BASINS, OR MANHOLE, CLASS I
 WILMINGTON:
 STA. 227+03.0 - 227+23 LT
 STA. 228+18.0 LT
 STA. 229+98.0
 621.21 HD STEEL BEAM GUARDRAIL, GALVANIZED
 WILMINGTON:
 STA. 225+30.0 - STA. 225+61.3 LT (41.3 LF) 58.75'
 STA. 225+36.3 - STA. 225+61.3 RT (32.5 LF) 41.25'
 STA. 226+30.0 - STA. 226+80.0 LT (65.0 LF) 32.5'
 STA. 226+30.0 - STA. 226+61.3 RT (41.3 LF) 17.5'
 621.20 STEEL BEAM GUARDRAIL, GALVANIZED +63
 WILMINGTON:
 STA. 220+00.0 - STA. 220+15.5 LT (15.5 LF) 16.5'
 STA. 224+05.0 - STA. 225+30.0 LT (125.0 LF) 114.5'
 STA. 226+61.3 - STA. 226+86.3 RT (25.0 LF) 27.0'
 621.50 MANUFACTURED TERMINAL SECTION, FLARED
 WILMINGTON:
 STA. 226+86.3 - STA. 227+23.8 RT
 STA. 227+23.8 RT

621.60 ANCHOR FOR STEEL BEAM RAIL
 WILMINGTON:
 STA. 224+11.5 LT+10 220+02 LT
 STA. 225+42.8 RT+50
 STA. 226+73.5 LT+75
 621.80 REMOVAL AND DISPOSAL OF GUARDRAIL
 WILMINGTON:
 STA. 220+00.0 - STA. 220+09.0 LT (9.0 LF)
 STA. 224+50.0 - STA. 226+74.0 LT (224.0 LF)
 STA. 225+41.0 - STA. 227+20.0 RT (179.0 LF)
 676.10 DELINEATOR WITH STEEL POST
 ♀ TYPE I WHITE
 WILMINGTON:
 STA. 220+15.5 LT
 STA. 224+05.0 LT
 STA. 227+23.8 RT

STA. 227+23.0, RT
 (SEE NOTE 1)
 EAST
 VERMONT
 9

NOTE:
 I. THE CONTRACTOR SHALL RETAIN THE EXISTING SIGNS THAT PERTAIN TO THE EXISTING VT. ROUTE 100 INTERSECTION CONFIGURATION UNTIL THE COMPLETION OF THE HES 010-I(38) PROJECT OR AS DIRECTED BY THE RESIDENT ENGINEER.

SIGN LEGEND
 R = REMOVE
 S = SALVAGE
 N = NEW
 RET = RETAIN
 B-B = BACK TO BACK
 EXISTING = - - - - -
 NEW = _____

NOT TO SCALE
PROJECT LAYOUT SHEET #11

PROJECT NAME: WILMINGTON
 PROJECT NUMBER: AC_NH_2504(I)S
 FILE NAME: p05b044.dgn
 PROJECT LEADER: D.E.G.
 DESIGNED BY: M.J.M.
 IPARM FILE: p05b044LI.I
 PLOT DATE: 23-AUG-2010 14
 DRAWN BY: C.A.K.
 CHECKED BY: D.W.E.
 SHEET 30 OF 125