

646.402 DURABLE 4 INCH WHITE LINE, THERMOPLASTIC
(ALL LINES WILL INCLUDE EDGE LINE BREAKS AND RADIUS FOR TOWN HIGHWAYS)

WILMINGTON:
STA. 172+00.00 - STA. 188+00.00 EDGE LINE LT & RT
STA. 185+50.00 - STA. 186+50.00 DOTTED LANE LINE RT
STA. 186+50.00 - STA. 187+50.00 SOLID LANE LINE RT

646.412 DURABLE 4 INCH YELLOW LINE, THERMOPLASTIC
(ALL LINES WILL INCLUDE C/L BREAKS FOR TOWN HIGHWAYS) S=SOLID, D=DASHED

WILMINGTON:
STA. 172+00.00 - STA. 188+00.00 LT S - S
RT S - S

646.602 TEMPORARY 4 INCH WHITE LINE, PAINT
(ALL LINES WILL INCLUDE EDGE LINE BREAKS AND RADIUS FOR TOWN HIGHWAYS)

WILMINGTON:
STA. 172+00.00 - STA. 188+00.00 EDGE LINE LT & RT
STA. 185+50.00 - STA. 186+50.00 DOTTED LANE LINE RT
STA. 186+50.00 - STA. 187+50.00 SOLID LANE LINE RT

646.612 TEMPORARY 4 INCH YELLOW LINE, PAINT
(ALL LINES WILL INCLUDE C/L BREAKS FOR TOWN HIGHWAYS) S=SOLID, D=DASHED

WILMINGTON:
STA. 172+00.00 - STA. 188+00.00 LT S - S
RT S - S

646.442 DURABLE 8 INCH WHITE LINE, THERMOPLASTIC

WILMINGTON:
STA. 172+82.00 - STA. 172+98.00 NO PARKING FIRE HYDRANT RT
STA. 184+94.00 - STA. 185+06.00 NO PARKING FIRE HYDRANT LT

646.492 DURABLE LETTER OR SYMBOL, THERMOPLASTIC
WILMINGTON:
STA. 174+15.0 LT, "S,C,H,O,O,L" (6 EA)
STA. 186+54.5 RT "O,N,L,Y" (4 EA)
STA. 187+45.5 RT ARROW (1EA)

646.692 TEMPORARY LETTER OR SYMBOL, PAINT

WILMINGTON:
STA. 174+15.0 LT, "S,C,H,O,O,L" (12 EA)
STA. 186+54.5 RT, "O,N,L,Y" (8 EA)
STA. 187+45.5 RT, ARROW (2 EA)

646.81 PAINTED CURB
WILMINGTON:
STA. 172+00.0 - STA. 173+15.0 LT (115.0 LF)
STA. 172+04.0 - STA. 172+60.0 RT (54.0 LF)
STA. 172+82.0 - STA. 172+98.0 RT (16.0 LF)
STA. 173+32.0 - STA. 174+26.0 LT (94.0 LF)
STA. 173+41.0 - STA. 173+53.0 RT (12.0 LF)
STA. 173+58.0 - STA. 173+86.0 RT (28.0 LF)
STA. 174+64.0 - STA. 175+12.0 LT (58.0 LF)
STA. 175+34.0 - STA. 176+86.0 LT (52.0 LF)
STA. 177+06.0 - STA. 177+38.0 LT (32.0 LF)
STA. 177+58.0 - STA. 179+20.0 LT (162.0 LF)
STA. 179+36.0 - STA. 180+11.0 LT (85.0 LF)
STA. 180+30.0 - STA. 180+86.0 LT (56.0 LF)
STA. 180+99.0 - STA. 181+80.0 LT (81.0 LF)
~~STA. 182+02.0 - STA. 182+35.0 LT (33.0 LF)~~

675.50 REMOVING SIGNS
AS SHOWN - 18

179+80 - 180+22 RT 42'
180+53 - 180+93 RT 40'
181+30 - 181+75 RT 45'
178+77 - 178+95 RT 18'
179+12 - 179+63 RT 51'

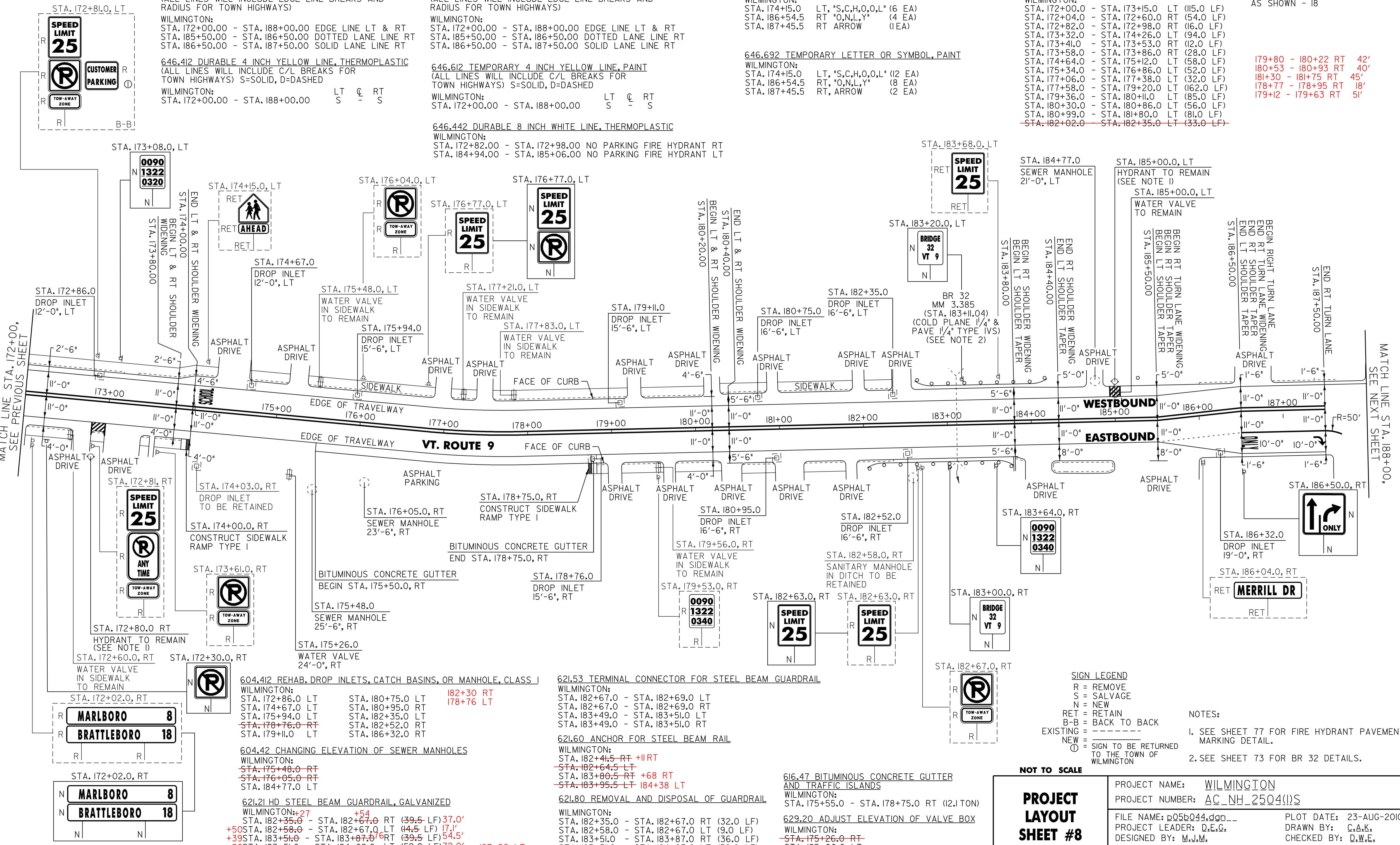

SIGN LEGEND

- R = REMOVE
- S = SALVAGE
- N = NEW
- RET = RETAIN
- B-B = BACK TO BACK
- EXISTING = - - - - -
- NEW = - - - - -
- ⊙ = SIGN TO BE RETURNED TO THE TOWN OF WILMINGTON

NOTES:

1. SEE SHEET 77 FOR FIRE HYDRANT PAVEMENT MARKING DETAIL.
2. SEE SHEET 73 FOR BR 32 DETAILS.

NOT TO SCALE

PROJECT LAYOUT SHEET #8

PROJECT NAME: WILMINGTON	PLOT DATE: 23-AUG-2010 14
PROJECT NUMBER: AC_NH_2504(1)S	DRAWN BY: C.A.K.
FILE NAME: p05b044.dgn	CHECKED BY: D.W.E.
DESIGNED BY: M.J.M.	SHEET 27 OF 125
IPARM FILE: p05b044L08.i	

604.412 REHAB. DROP INLETS, CATCH BASINS, OR MANHOLE, CLASS I

WILMINGTON:
STA. 172+86.0 LT
STA. 174+67.0 LT
STA. 175+94.0 LT
~~STA. 178+76.0 RT~~
STA. 179+11.0 LT
STA. 180+75.0 LT
STA. 180+95.0 RT
STA. 182+35.0 LT
STA. 182+52.0 RT
STA. 186+32.0 RT

604.42 CHANGING ELEVATION OF SEWER MANHOLES

WILMINGTON:
~~STA. 175+48.0 RT~~
~~STA. 176+05.0 RT~~
STA. 184+77.0 LT

621.21 HD STEEL BEAM GUARDRAIL, GALVANIZED

WILMINGTON:
STA. 182+35.0 - STA. 182+67.0 RT (39.5 LF) 37.0'
~~+50~~ STA. 182+58.0 - STA. 182+67.0 LT (4.5 LF) 17.1'
~~+39~~ STA. 183+51.0 - STA. 183+87.0 RT (39.5 LF) 54.5'
~~+36~~ STA. 183+51.0 - STA. 184+02.0 LT (52.0 LF) 72.0' 183+86 LT

621.53 TERMINAL CONNECTOR FOR STEEL BEAM GUARDRAIL

WILMINGTON:
STA. 182+67.0 - STA. 182+69.0 LT
STA. 182+67.0 - STA. 182+69.0 RT
STA. 183+49.0 - STA. 183+51.0 LT
STA. 183+49.0 - STA. 183+51.0 RT

621.60 ANCHOR FOR STEEL BEAM RAIL

WILMINGTON:
STA. 182+41.5 RT +11RT
~~STA. 182+64.5 LT~~
~~STA. 183+80.5 RT +68 RT~~
~~STA. 183+95.5 LT 184+38 LT~~

621.80 REMOVAL AND DISPOSAL OF GUARDRAIL

WILMINGTON:
STA. 182+35.0 - STA. 182+67.0 RT (32.0 LF)
STA. 182+58.0 - STA. 182+67.0 LT (9.0 LF)
STA. 183+51.0 - STA. 183+87.0 RT (36.0 LF)
STA. 183+51.0 - STA. 184+03.0 LT (52.0 LF)

616.47 BITUMINOUS CONCRETE GUTTER AND TRAFFIC ISLANDS

WILMINGTON:
STA. 175+55.0 - STA. 178+75.0 RT (12.1TON)

629.20 ADJUST ELEVATION OF VALVE BOX

WILMINGTON:
~~STA. 175+26.0 RT~~
~~STA. 185+00.0 LT~~