

646.402 DURABLE 4 INCH WHITE LINE, THERMOPLASTIC
 (ALL LINES WILL INCLUDE EDGE LINE BREAKS AND RADIUS FOR TOWN HIGHWAYS)
 FERRISBURGH:
 STA 355+00.00 - STA 371+00.00 EDGE LINE LT & RT
 STA 364+85.00 - STA 366+65.00 DOTTED LANE LINE RT
 STA 366+65.00 - STA 367+40.00 SOLID LANE LINE RT
 STA 367+80.00 - STA 368+55.00 SOLID LANE LINE LT
 STA 368+55.00 - STA 370+35.00 DOTTED LANE LINE LT

646.412 DURABLE 4 INCH YELLOW LINE, THERMOPLASTIC
 (ALL LINES WILL INCLUDE C/L BREAKS FOR TOWN HIGHWAYS) S=SOLID, D=DASHED
 FERRISBURGH:
 STA 355+00.00 - STA 362+85.00 S - S
 STA 362+85.00 - STA 366+65.00 DOUBLE SOLID MEDIAN LT & RT
 STA 366+65.00 - STA 368+55.00 DOUBLE SOLID CENTERLINE
 STA 368+55.00 - STA 371+00.00 DOUBLE SOLID MEDIAN LT & RT
 STA 367+59.36 DOUBLE SOLID LT, TH-I
 STA 367+59.36 DOUBLE SOLID RT, TH-I

646.452 DURABLE 8 INCH YELLOW LINE, THERMOPLASTIC
 FERRISBURGH:
 STA 362+85.00 - STA 366+65.00 HATCHED MEDIAN LT & RT
 STA 368+55.00 - STA 371+00.00 HATCHED MEDIAN LT & RT

646.602 TEMPORARY 4 INCH WHITE LINE, PAINT
 (ALL LINES WILL INCLUDE EDGE LINE BREAKS AND RADIUS FOR TOWN HIGHWAYS)
 FERRISBURGH:
 STA 355+00.00 - STA 371+00.00 EDGE LINE LT & RT
 STA 364+85.00 - STA 366+65.00 DOTTED LANE LINE RT
 STA 366+65.00 - STA 367+40.00 SOLID LANE LINE RT
 STA 367+80.00 - STA 368+55.00 SOLID LANE LINE LT
 STA 368+55.00 - STA 370+35.00 DOTTED LANE LINE LT

646.612 TEMPORARY 4 INCH YELLOW LINE, PAINT
 (ALL LINES WILL INCLUDE C/L BREAKS FOR TOWN HIGHWAYS) S=SOLID, D=DASHED
 FERRISBURGH:
 STA 355+00.00 - STA 362+85.00 S - S
 STA 362+85.00 - STA 366+65.00 DOUBLE SOLID MEDIAN LT & RT
 STA 366+65.00 - STA 368+55.00 DOUBLE SOLID CENTERLINE
 STA 368+55.00 - STA 371+00.00 DOUBLE SOLID MEDIAN LT & RT
 STA 367+59.36 DOUBLE SOLID LT, TH-I
 STA 367+59.36 DOUBLE SOLID RT, TH-I

675.50 REMOVING SIGNS
 AS SHOWN - 15

675.60 ERECTING SALVAGED SIGNS
 AS SHOWN - 5

675.60 ERECTING SALVAGED SIGNS
 AS SHOWN - 5

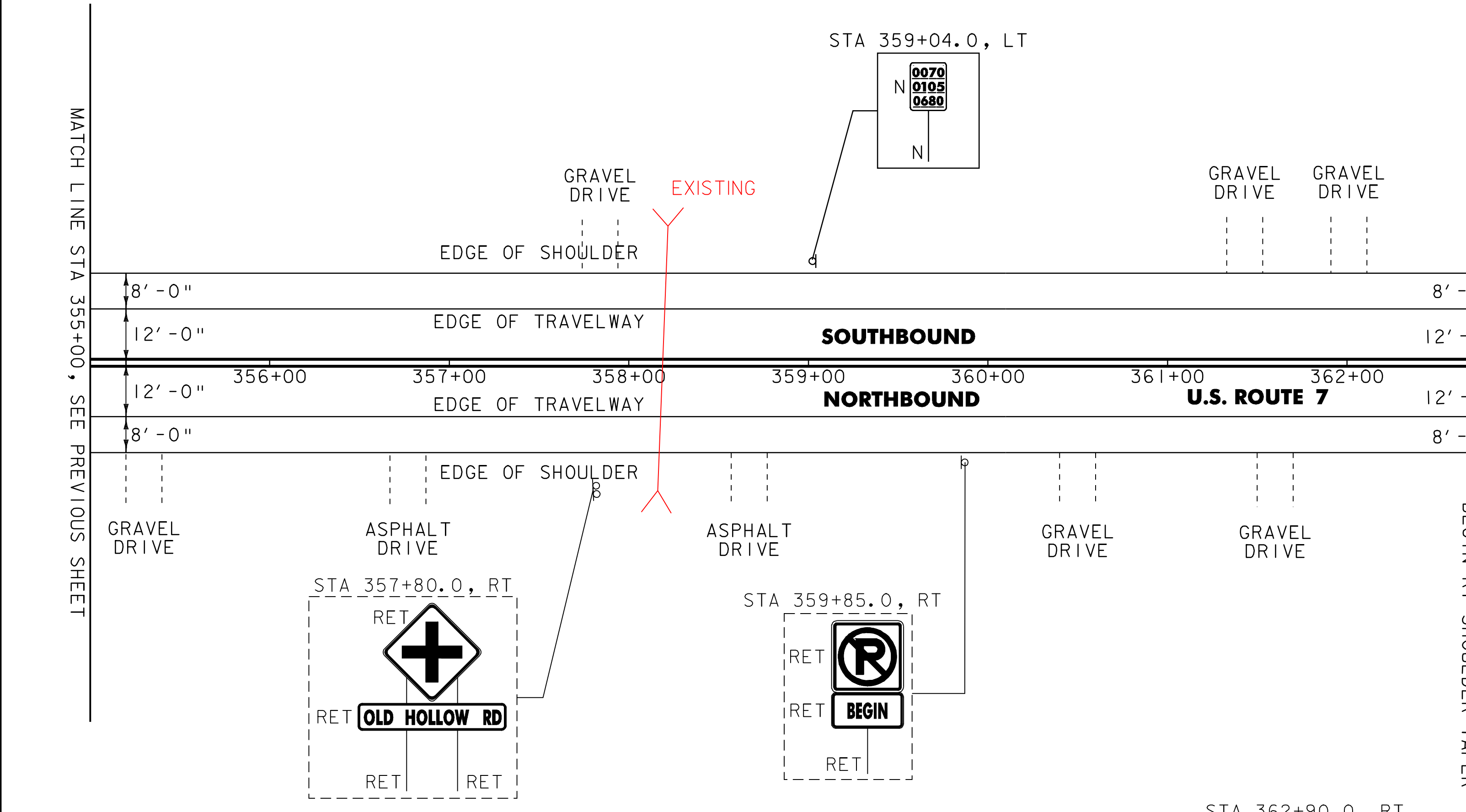
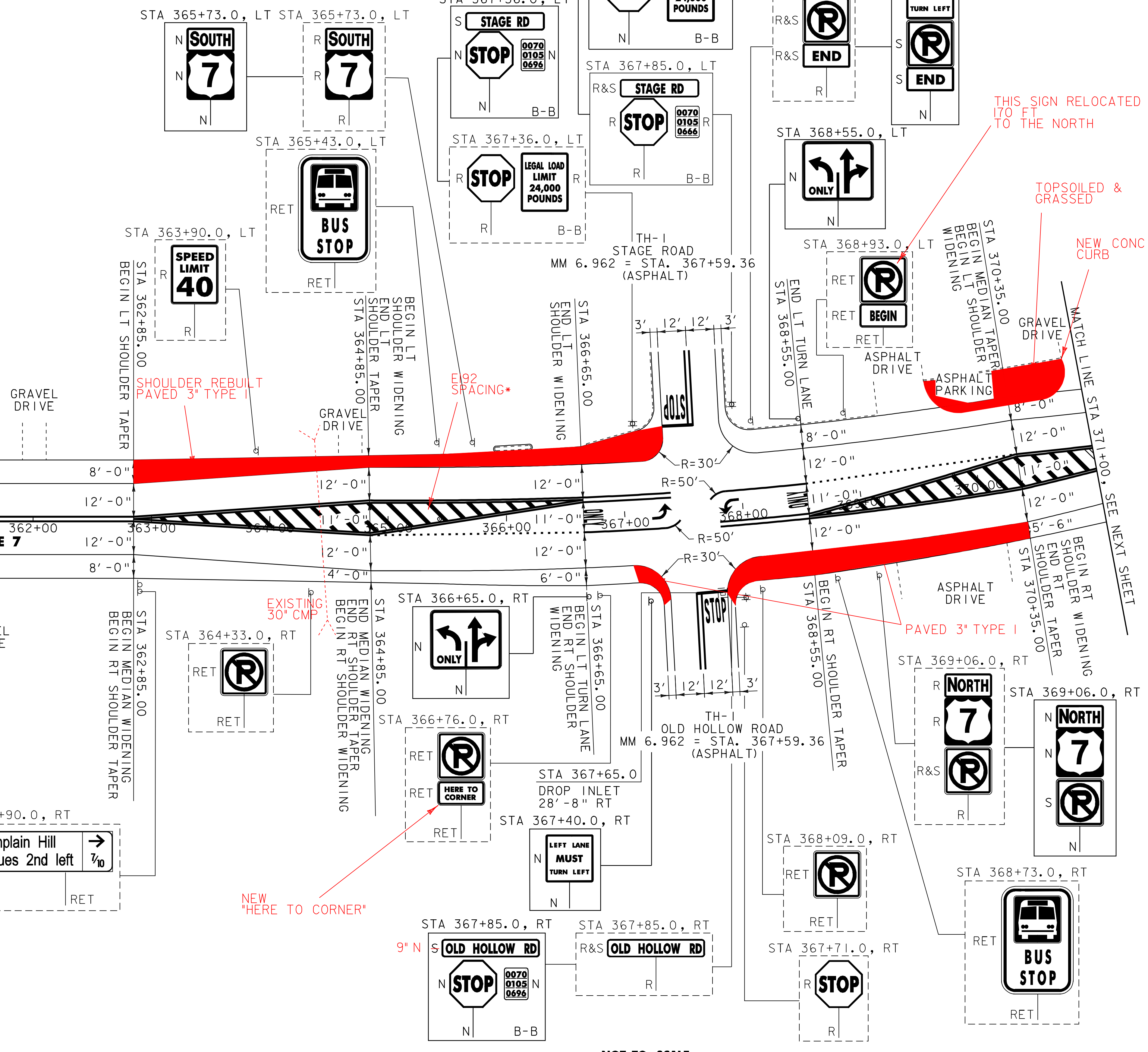

646.482 DURABLE 24 INCH STOP BAR, THERMOPLASTIC
 FERRISBURGH:
 STA 367+59.36 LT, TH-I
 STA 367+59.36 RT, TH-I

646.492 DURABLE LETTER OR SYMBOL, THERMOPLASTIC
 FERRISBURGH:
 STA 366+69.5 RT, "O,N,L,Y" (4 EA)
 STA 367+35.7 RT, ARROW (1EA)
 STA 367+59.36 LT, TH-I "S,T,O,P" (4 EA)
 STA 367+59.36 RT, TH-I "S,T,O,P" (4 EA)
 STA 367+84.3 LT, ARROW (1EA)
 STA 368+50.5 LT, "O,N,L,Y" (4 EA)

646.682 TEMPORARY 24 INCH STOP BAR, PAINT
 FERRISBURGH:
 STA 367+59.36 LT, TH-I
 STA 367+59.36 RT, TH-I

646.692 TEMPORARY LETTER OR SYMBOL, PAINT
 FERRISBURGH:
 STA 367+35.7 RT, ARROW (2 EA)
 STA 367+59.36 LT, TH-I "S,T,O,P" (8 EA)
 STA 367+59.36 RT, TH-I "S,T,O,P" (8 EA)
 STA 367+84.3 LT, ARROW (2 EA)

604.412 REHAB. DROP INLETS, CATCH BASINS OR MANHOLES, CLASS I
 FERRISBURGH:
 STA 367+65.0 RT

NOTE:
 I. PAVING LIMIT ON ALL TOWN HIGHWAYS SHALL BE MEASURED 25 FT BACK FROM U.S. ROUTE 7 EDGE OF SHOULDER UNLESS DENOTED OTHERWISE ON THE PLANS OR AS DIRECTED BY THE RESIDENT ENGINEER.

SIGN LEGEND
 R = REMOVE
 S = SALVAGE
 N = NEW
 RET = RETAIN
 B-B = BACK TO BACK
 EXISTING = - - - - -
 NEW = _____

NOT TO SCALE
PROJECT LAYOUT SHEET #34

PROJECT NAME: NEW HAVEN - FERRISBURGH
 PROJECT NUMBER: NH_2503(I)S
 FILE NAME: Q5b038.dgn
 PROJECT LEADER: D.E.G.
 DESIGNED BY: M.J.M.
 IPARM FILE: p05b038i34.i
 PLOT DATE: 31-JUL-2009 15
 DRAWN BY: C.A.K.
 CHECKED BY: D.W.E.
 SHEET 47 OF 87