

646.402 DURABLE 4 INCH WHITE LINE, THERMOPLASTIC  
 (ALL LINES WILL INCLUDE EDGE LINE BREAKS AND RADIUS FOR TOWN HIGHWAYS)  
 BRIDGEWATER:  
 STA. 32+00.00 - STA. 48+00.00 LT & RT

646.412 DURABLE 4 INCH YELLOW LINE, THERMOPLASTIC  
 (ALL LINES WILL INCLUDE C/L BREAKS FOR TOWN HIGHWAYS) S=SOLID, D=DASHED  
 BRIDGEWATER:  
 STA. 32+00.00 - STA. 36+45.00 LT C S  
 STA. 36+45.00 - STA. 39+05.00 S - S  
 STA. 39+05.00 - STA. 44+90.00 S - D  
 STA. 44+90.00 - STA. 46+45.00 - D -  
 STA. 46+45.00 - STA. 48+00.00 D - S

646.602 TEMPORARY 4 INCH WHITE LINE, PAINT  
 (ALL LINES WILL INCLUDE EDGE LINE BREAKS AND RADIUS FOR TOWN HIGHWAYS)  
 BRIDGEWATER:  
 STA. 32+00.00 - STA. 48+00.00 LT & RT

646.612 TEMPORARY 4 INCH YELLOW LINE, PAINT  
 (ALL LINES WILL INCLUDE C/L BREAKS FOR TOWN HIGHWAYS) S=SOLID, D=DASHED  
 BRIDGEWATER:  
 STA. 32+00.00 - STA. 36+45.00 LT C S  
 STA. 36+45.00 - STA. 39+05.00 S - S  
 STA. 39+05.00 - STA. 44+90.00 S - D  
 STA. 44+90.00 - STA. 46+45.00 - D -  
 STA. 46+45.00 - STA. 48+00.00 D - S

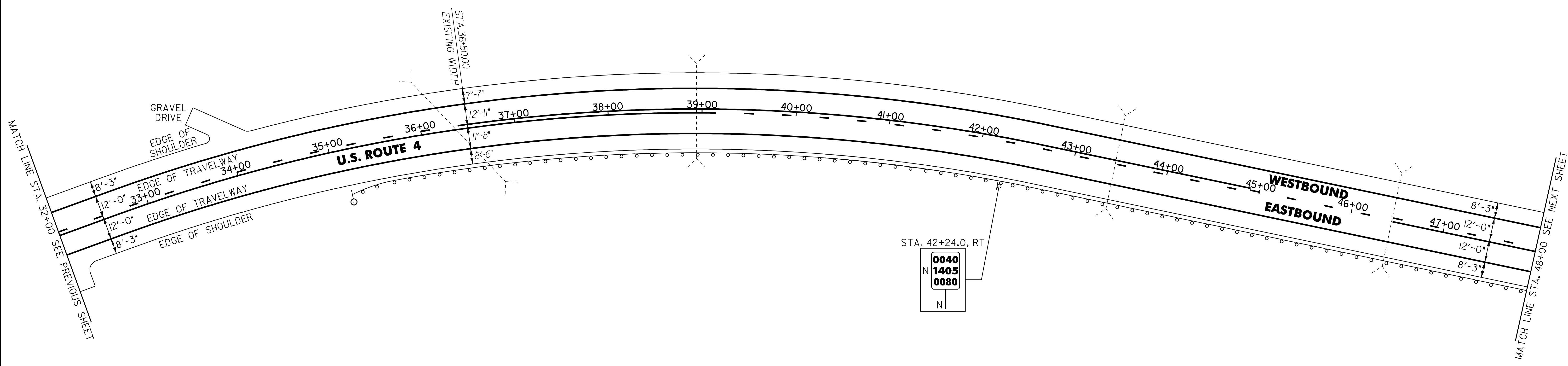

621.205 STEEL BEAM GUARDRAIL W/ 8' POSTS  
 38+94 - 39+44 (50')

621.20 STEEL BEAM GUARDRAIL, GALVANIZED 35+69 - 38+94 RT (225')

KILLINGTON:  
 STA. 35+52.0 - STA. 48+00.0 RT (1248.0 LF)  
 39+44

621.50 MANUFACTURED TERMINAL SECTION, FLARED

KILLINGTON:  
 STA. 35+14.5 - STA. 35+52.0 RT  
 31.5 69

621.80 REMOVAL AND DISPOSAL OF GUARDRAIL

KILLINGTON:  
 STA. 35+18.0 - STA. 48+00.0 RT (1282.0 LF)  
 35

676.10 DELINEATOR WITH STEEL POST  
 TYPE I WHITE

BRIDGEWATER:  
 STA. 35+14.5 RT

SIGN LEGEND  
 R = REMOVE  
 S = SALVAGE  
 N = NEW  
 RET = RETAIN  
 B-B = BACK TO BACK  
 EXISTING = -----  
 NEW = \_\_\_\_\_

NOT TO SCALE

**PROJECT LAYOUT SHEET #7**

NOTE:

1. THERE ARE EXISTING UNDERGROUND UTILITIES LOCATED THROUGHOUT THE U.S. ROUTE 4 CORRIDOR IN THE PROJECT AREA. THE CONTRACTOR IS RESPONSIBLE FOR CONTACTING "DIG SAFE" AT 1-888-344-7233 TO DETERMINE THE LOCATIONS OF THESE UTILITIES PRIOR TO PERFORMING ANY SUBSURFACE OPERATIONS.

PROJECT NAME: KILLINGTON - BRIDGEWATER  
 PROJECT NUMBER: NH 2502(1)S

FILE NAME: p05b036.dgn PLOT DATE: 15-MAY-2008 14  
 PROJECT LEADER: D.E.G. DRAWN BY: C.A.K.  
 DESIGNED BY: J.S.P. CHECKED BY: D.E.G.  
 IPARM FILE: p05b036i07.i SHEET 19 OF 74