

646.402 DURABLE 4 INCH WHITE LINE, THERMOPLASTIC
 (ALL LINES WILL INCLUDE EDGE LINE BREAKS AND
 RADIUS FOR TOWN HIGHWAYS)
 KILLINGTON:
 STA. 432+00.00 - STA. 448+00.00 LT & RT

646.602 TEMPORARY 4 INCH WHITE LINE, PAINT
 (ALL LINES WILL INCLUDE EDGE LINE BREAKS AND
 RADIUS FOR TOWN HIGHWAYS)
 KILLINGTON:
 STA. 432+00.00 - STA. 448+00.00 LT & RT

646.492 DURABLE LETTER OR SYMBOL, THERMOPLASTIC
 KILLINGTON:
 STA. 435+33.60 LT, TH-39
 STA. 438+50.40 RT, TH-III

646.682 TEMPORARY 24 INCH STOP BAR, PAINT
 KILLINGTON:
 STA. 435+33.60 LT, TH-39
 STA. 438+50.40 RT, TH-III

675.50 REMOVING SIGNS AS SHOWN - I9
 675.60 ERECTING SALVAGED SIGNS AS SHOWN - 2

646.412 DURABLE 4 INCH YELLOW LINE, THERMOPLASTIC
 (ALL LINES WILL INCLUDE C/L BREAKS FOR
 TOWN HIGHWAYS) S=SOLID, D=DASHED
 KILLINGTON:
 STA. 432+00.00 - STA. 448+00.00 LT S C RT
 STA. 435+33.60 DOUBLE SOLID LT, TH-39 S - S
 STA. 438+50.40 DOUBLE SOLID RT, TH-III S - S

646.612 TEMPORARY 4 INCH YELLOW LINE, PAINT
 (ALL LINES WILL INCLUDE C/L BREAKS FOR
 TOWN HIGHWAYS) S=SOLID, D=DASHED
 KILLINGTON:
 STA. 432+00.00 - STA. 448+00.00 LT S C RT
 STA. 435+33.60 DOUBLE SOLID LT, TH-39 S - S
 STA. 438+50.40 DOUBLE SOLID RT, TH-III S - S

646.692 TEMPORARY LETTER OR SYMBOL, PAINT
 KILLINGTON:
 STA. 435+33.60 LT, TH-39 "S,T,O,P" (4 EA)
 STA. 438+50.40 RT, TH-III "S,T,O,P" (4 EA)

646.692 TEMPORARY LETTER OR SYMBOL, PAINT
 KILLINGTON:
 STA. 435+33.60 LT, TH-39 "S,T,O,P" (4 EA)
 STA. 438+50.40 RT, TH-III "S,T,O,P" (4 EA)

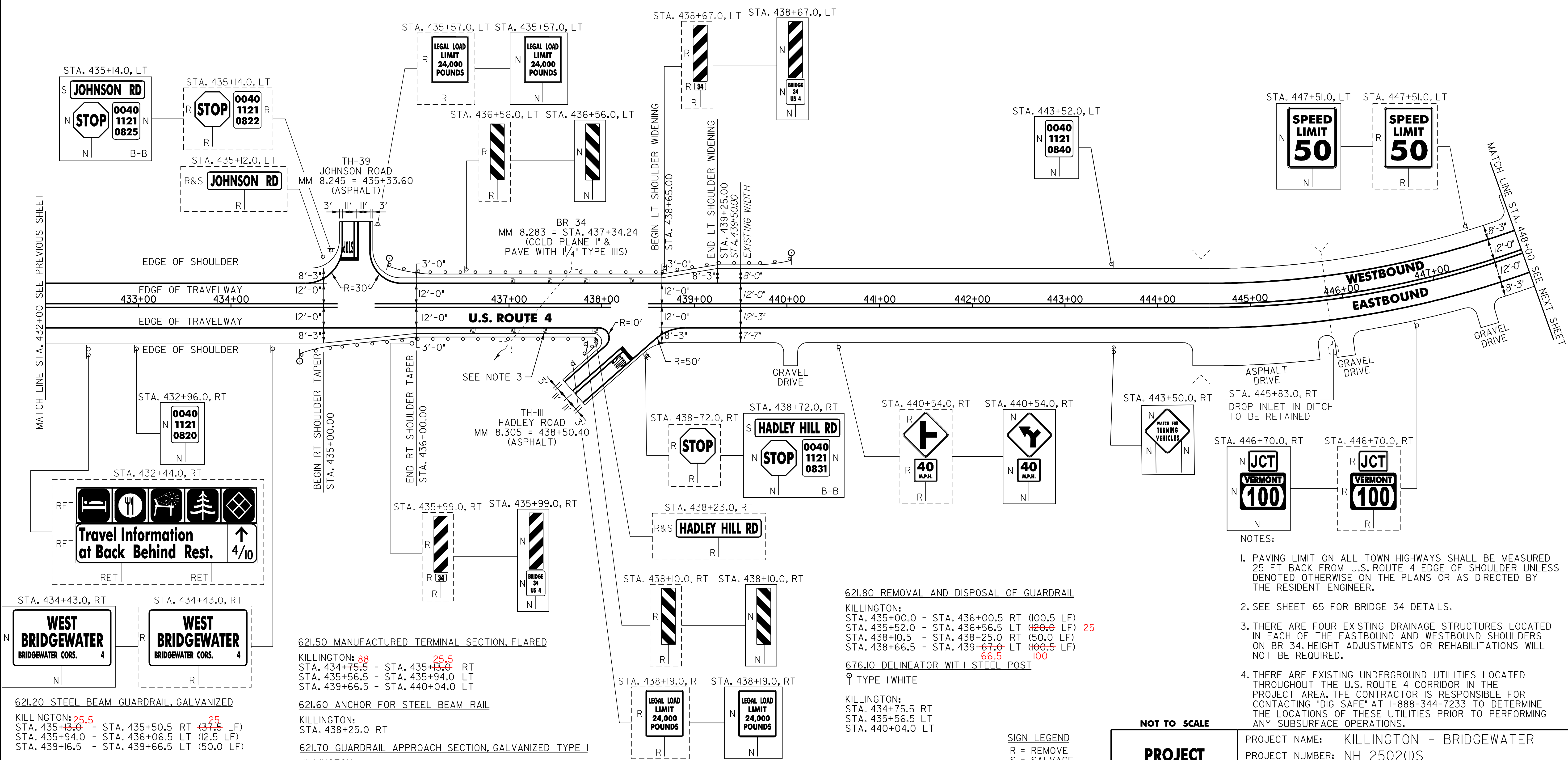

621.50 MANUFACTURED TERMINAL SECTION, FLARED
 KILLINGTON: 88 25.5
 STA. 434+75.5 - STA. 435+13.0 RT
 STA. 435+56.5 - STA. 435+94.0 LT
 STA. 439+66.5 - STA. 440+04.0 LT

621.60 ANCHOR FOR STEEL BEAM RAIL
 KILLINGTON:
 STA. 438+25.0 RT

621.70 GUARDRAIL APPROACH SECTION, GALVANIZED TYPE I
 KILLINGTON:
 STA. 435+50.5 - STA. 436+00.5 RT
 STA. 436+06.5 - STA. 436+56.5 LT
 STA. 438+66.5 - STA. 439+16.5 LT

621.80 REMOVAL AND DISPOSAL OF GUARDRAIL
 KILLINGTON:
 STA. 435+00.0 - STA. 436+00.5 RT (100.5 LF)
 STA. 435+52.0 - STA. 436+56.5 LT (120.0 LF) 125
 STA. 438+10.5 - STA. 438+25.0 RT (50.0 LF)
 STA. 438+66.5 - STA. 439+67.0 LT (100.5 LF) 66.5 100

676.10 DELINEATOR WITH STEEL POST
 ♀ TYPE I WHITE
 KILLINGTON:
 STA. 434+75.5 RT
 STA. 435+56.5 LT
 STA. 440+04.0 LT

- NOTES:
- PAVING LIMIT ON ALL TOWN HIGHWAYS SHALL BE MEASURED 25 FT BACK FROM U.S. ROUTE 4 EDGE OF SHOULDER UNLESS DENOTED OTHERWISE ON THE PLANS OR AS DIRECTED BY THE RESIDENT ENGINEER.
 - SEE SHEET 65 FOR BRIDGE 34 DETAILS.
 - THERE ARE FOUR EXISTING DRAINAGE STRUCTURES LOCATED IN EACH OF THE EASTBOUND AND WESTBOUND SHOULDERS ON BR 34. HEIGHT ADJUSTMENTS OR REHABILITATIONS WILL NOT BE REQUIRED.
 - THERE ARE EXISTING UNDERGROUND UTILITIES LOCATED THROUGHOUT THE U.S. ROUTE 4 CORRIDOR IN THE PROJECT AREA. THE CONTRACTOR IS RESPONSIBLE FOR CONTACTING "DIG SAFE" AT 1-888-344-7233 TO DETERMINE THE LOCATIONS OF THESE UTILITIES PRIOR TO PERFORMING ANY SUBSURFACE OPERATIONS.

SIGN LEGEND
 R = REMOVE
 S = SALVAGE
 N = NEW
 RET = RETAIN
 B-B = BACK TO BACK
 EXISTING = -----
 NEW = _____

NOT TO SCALE

PROJECT LAYOUT SHEET #3

PROJECT NAME: KILLINGTON - BRIDGEWATER
 PROJECT NUMBER: NH 2502(I)S
 FILE NAME: p05b036.dgn
 PROJECT LEADER: D.E.G.
 DESIGNED BY: J.S.P.
 IPARM FILE: p05b036i03.i
 PLOT DATE: 15-MAY-2008 14
 DRAWN BY: C.A.K.
 CHECKED BY: D.E.G.
 SHEET 15 OF 74