

TEMPORARY 4" WHITE LINE, PAINT  
 STA 75+50 TO 78+70 SOLID LT & RT  
 STA 79+30 TO 81+00 SOLID LT & RT

TEMPORARY 4" YELLOW LINE, PAINT  
 DURABLE 4" YELLOW LINE, THERMOPLASTIC  
 STA 75+50 TO 78+80 SOLID LT & RT  
 STA 79+20 TO 81+00 SOLID LT & RT

DURABLE 4" WHITE LINE, THERMOPLASTIC  
 STA 75+50 TO 78+70 SOLID LT & RT  
 STA 79+30 TO 81+00 SOLID LT & RT

REMOVING SIGNS  
 AS SHOWN - 4

DURABLE 8" WHITE LINE, THERMOPLASTIC  
 STA 75+59 TO 75+71 SOLID LT SHOULDER HATCHING

ADJUST ELEVATION OF VALVE BOX  
 75+65 LT  
 77+90 RT

TEMPORARY 8" WHITE LINE, PAINT  
 STA 75+59 TO 75+71 SOLID LT SHOULDER HATCHING

CHANGE ELEVATION OF D.I.  
 78+23 RT

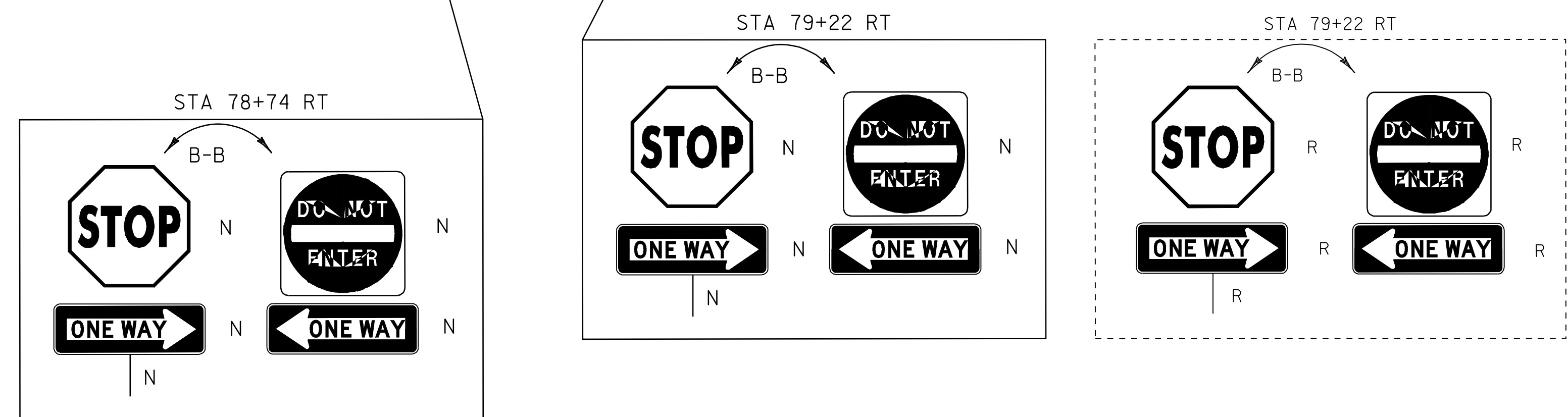
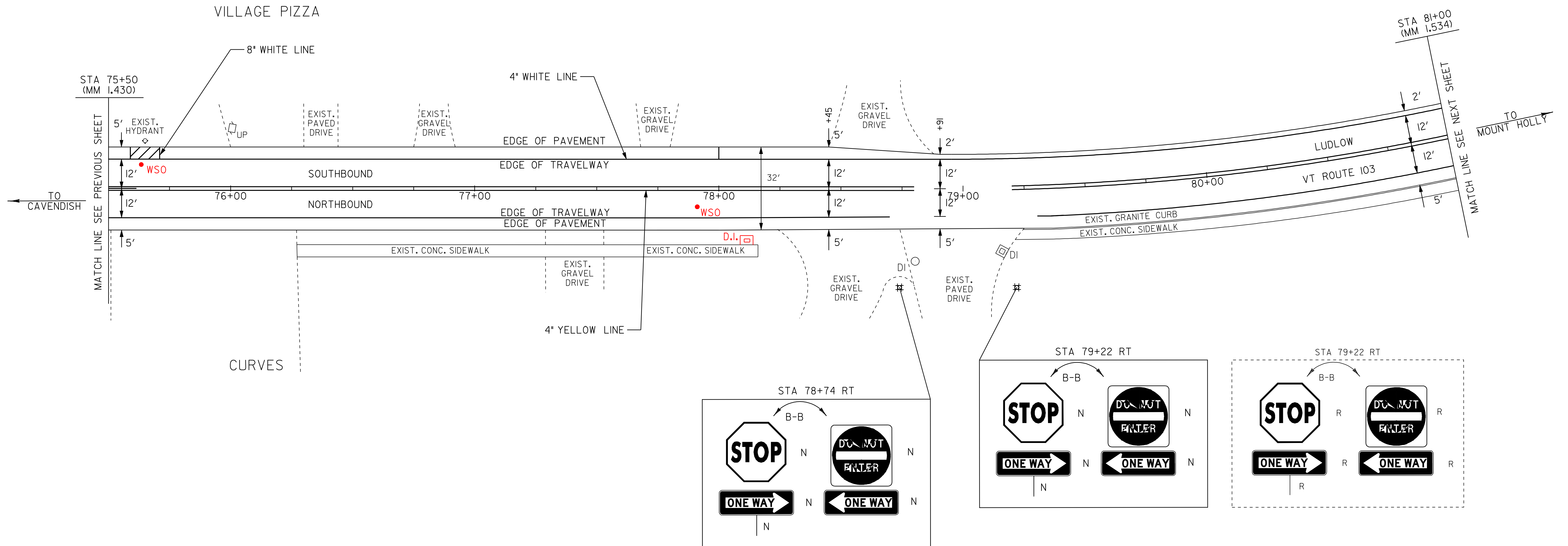

- LEGEND**
- R = REMOVE EXISTING
  - S = SALVAGE
  - R&S = REMOVE AND SALVAGE
  - N = NEW
  - RET = RETAIN
  - B-B = BACK TO BACK
  - = NEW RAIL
  - = EXISTING RAIL

**PAVING PROJECT LAYOUT #3**

PROJECT:	LUDLOW	PROJECT NO.:	NH_2409(I)S
DESIGN FILE NAME:	/pave/05B008/pb008.dgn	PLOT DATE:	20-MAY-2010 14:3
IPARM FILE NAME:	pb008la03.1	SURVEY DATE:	11/205
SURVEYED BY:	CLD_ENGINEERS, INC	DRAWN BY:	MRS
SQUAD LEADER:	PIS		
CLD_REF_NO.:	05-0389	SHEET:	14 OF 51

NOT TO SCALE