

| EXISTING DRAINAGE STRUCTURES | | |
|------------------------------|-----------|---|
| STRUCTURE # | LOCATION | COMMENTS |
| EXDW23 | 126+44 RT | EXISTING DRYWELL, CLEAN OUT ACCUMULATED SEDIMENT AND RETAIN |
| EXDW24 | 127+42 RT | EXISTING DRYWELL, CLEAN OUT ACCUMULATED SEDIMENT AND RETAIN |
| EXDW25 | 126+17 LT | RETAIN |

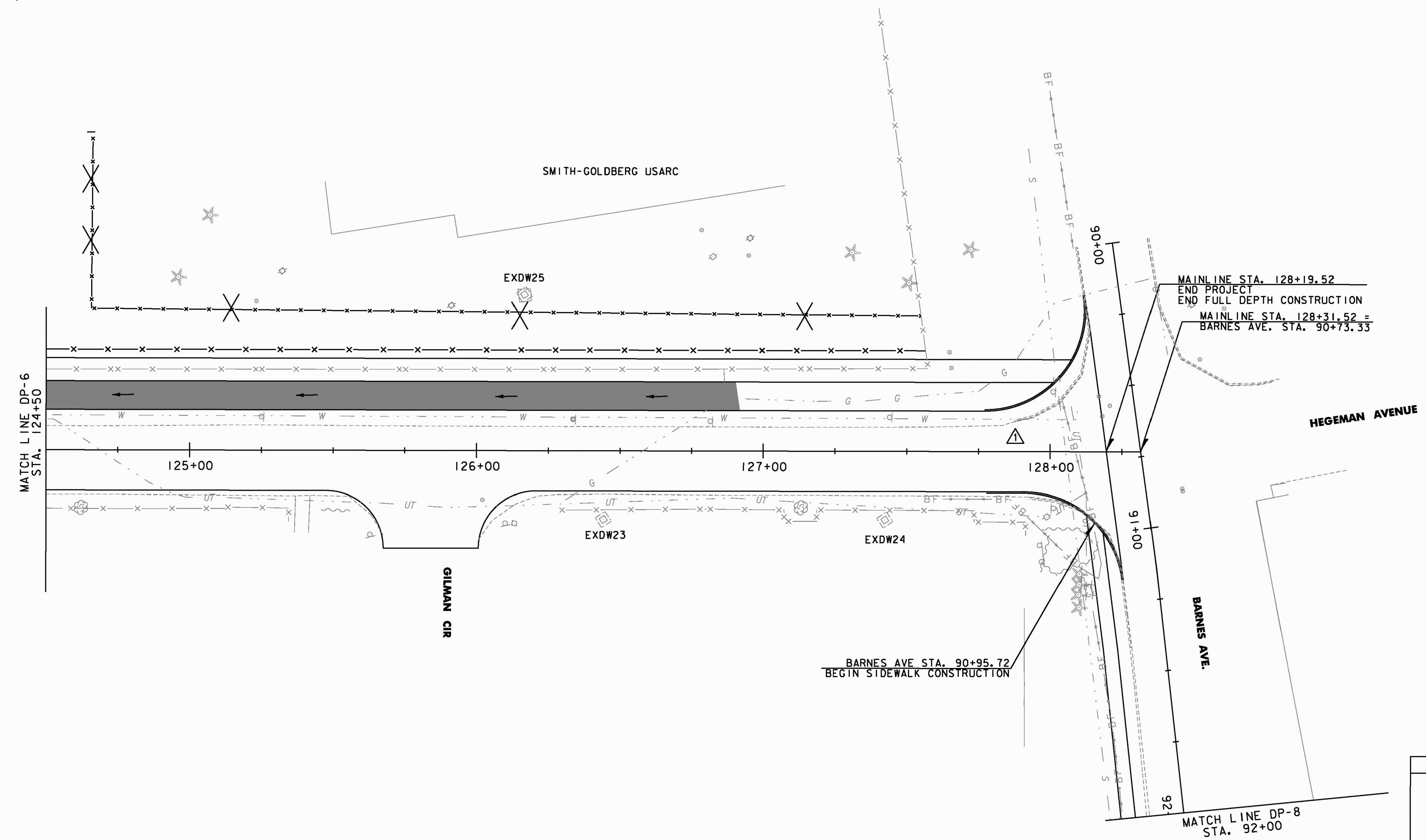

| LEGEND | |
|--------|---|
| | STORM DRAIN (SHOWING DIRECTION OF FLOW) |
| | DROP INLET (EXISTING & PROPOSED) |
| | GRASS CHANNEL (SHOWING DIRECTION OF FLOW) |
| | INFILTRATION AREA |

| REVISION | BY | DATE |
|----------|-----|----------|
| | JBL | 01/24/11 |

RECORD DRAWING
DATE: DECEMBER 21, 2012

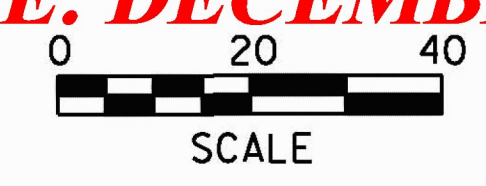

| | | | |
|---------------------------|-----------------------------|-------------|-----------|
| PROJECT NAME: | COLCHESTER CAMPUS CONNECTOR | PLOT DATE: | 9/7/2011 |
| PROJECT NUMBER: | TCSP TCSE (007) | DRAWN BY: | PZA |
| FILE NAME: | ...075-082_Drn.ptf | CHECKED BY: | GGG |
| DESIGNED BY: | TFD | SHEET | 77 OF 155 |
| DRAINAGE PLAN DP-7 | | | |