

EXISTING DRAINAGE STRUCTURES		
STRUCTURE #	LOCATION	COMMENTS
EXDW11	113+90 RT	EXISTING DRYWELL, CLEAN OUT ACCUMULATED SEDIMENT AND RETAIN
EXDW12	114+36 RT	EXISTING DRYWELL, CLEAN OUT ACCUMULATED SEDIMENT AND RETAIN
EXDW13	115+26 RT	EXISTING DRYWELL, CLEAN OUT ACCUMULATED SEDIMENT AND RETAIN
EXDW14	116+87 RT	EXISTING DRYWELL, CLEAN OUT ACCUMULATED SEDIMENT AND RETAIN
EXDW15	117+54 RT	EXISTING DRYWELL, CLEAN OUT ACCUMULATED SEDIMENT AND RETAIN
EXDW16	118+51 RT	EXISTING DRYWELL, CLEAN OUT ACCUMULATED SEDIMENT AND RETAIN

NEW DRAINAGE PIPES				
PIPE #	LOCATION	INV. IN	INV. OUT	COMMENTS
CV3	118+63 LT	316.19 316.54	315.95	12" x 25' OPTION AA W/END SECTION AT INLET AND OUTLET

STONE FILL, TYPE I	
LOCATION	COMMENTS
118+67, LT.	LEVEL SPREADER/ STILLING BASIN

NOTES:
1. SEE STORMWATER MANAGEMENT SHEETS FOR GRADING AND DETAILS OF INFILTRATION AREA CONSTRUCTION.

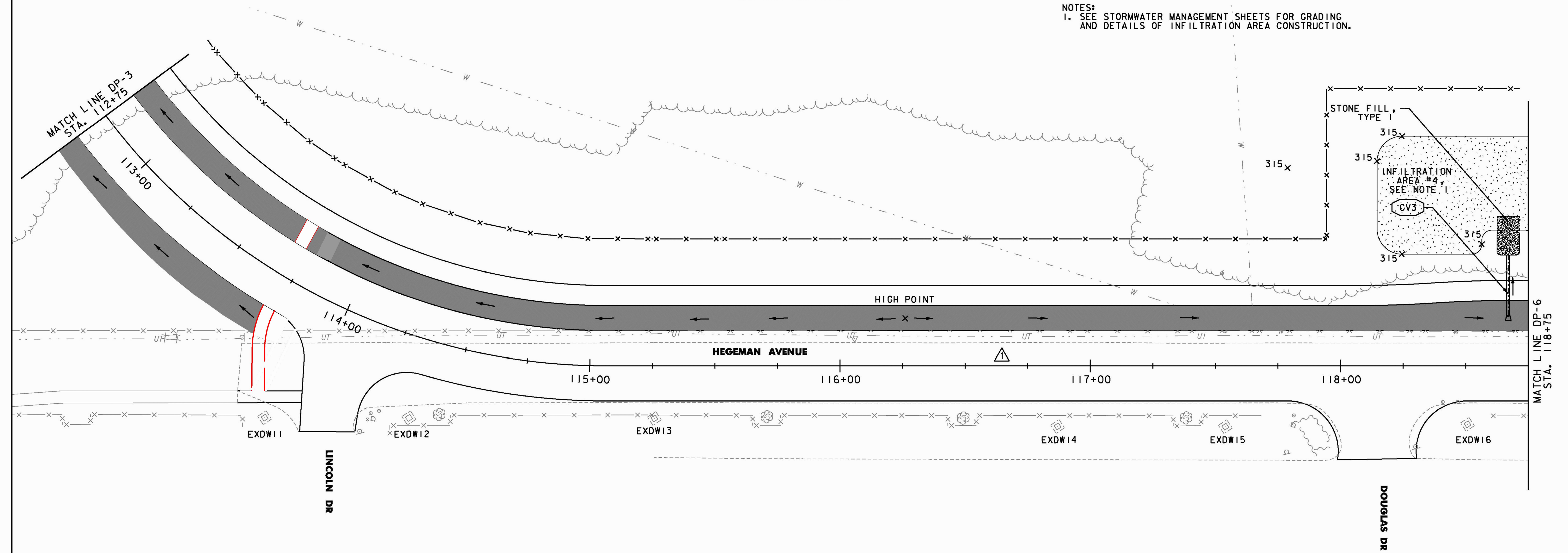

LEGEND	
	STORM DRAIN (SHOWING DIRECTION OF FLOW)
	DROP INLET (EXISTING & PROPOSED)
	GRASS CHANNEL (SHOWING DIRECTION OF FLOW)
	INFILTRATION AREA

REVISION	BY	DATE
	ADDENDUM - 1	JBL 01/24/11

RECORD DRAWING
DATE: DECEMBER 21, 2012

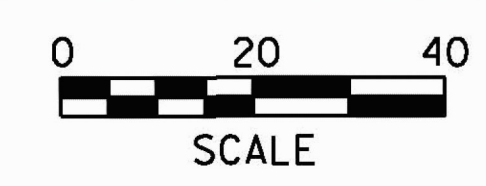

FIELD CHANGE #3 - SEPTEMBER 2, 2011
REVISED CULVERT INVERT

PROJECT NAME:	COLCHESTER CAMPUS CONNECTOR
PROJECT NUMBER:	TCSP TCSE (007)
FILE NAME:	...075-082.Drn.ptf
PROJECT LEADER:	JBL
DESIGNED BY:	TFD
DRAINAGE PLAN DP-5	
PLOT DATE:	9/7/2011
DRAWN BY:	PZA
CHECKED BY:	GCG
SHEET	75 OF 155