

RADIUS POINT	STATION	OFFSET
RP8	102+44.04	24.00 RT
RP9	102+81.65	34.00 LT
RP10	103+44.02	34.00 LT
RP11	103+00.13	24.00 RT
RP12	104+93.18	19.00 LT
RP13	105+28.54	19.00 LT
RP14	104+78.13	26.00' RT
RP15	104+78.13	19.00' RT
RP16	105+28.54	20.00 RT
RP17	105+48.80	19.00 RT
RP18	105+75.79	19.00 RT
RP18A	105+95.00	19.00 RT
RP18B	106+20.99	19.00 RT
RP19	106+33.30	29.00 LT

**MAINLINE**  
 CURVE ML-3  
 PI STA. 106+59.84  
 N 72°17'28" E 1468682.03  
 DELTA = 0°26'48" LT  
 DC = 0°11'28"  
 R = 30,000 FT  
 T = 116.91 FT  
 L = 233.82 FT  
 E = 0.23 FT  
 BANK = NA  
 PC = 105+42.93  
 PT = 107+76.74

AREA WAS RECONFIGURED AS PART  
 OF FIELD CHANGE #4, SEE SHEET 1 OF 1  
 ATTACHED AT END OF PLAN SET

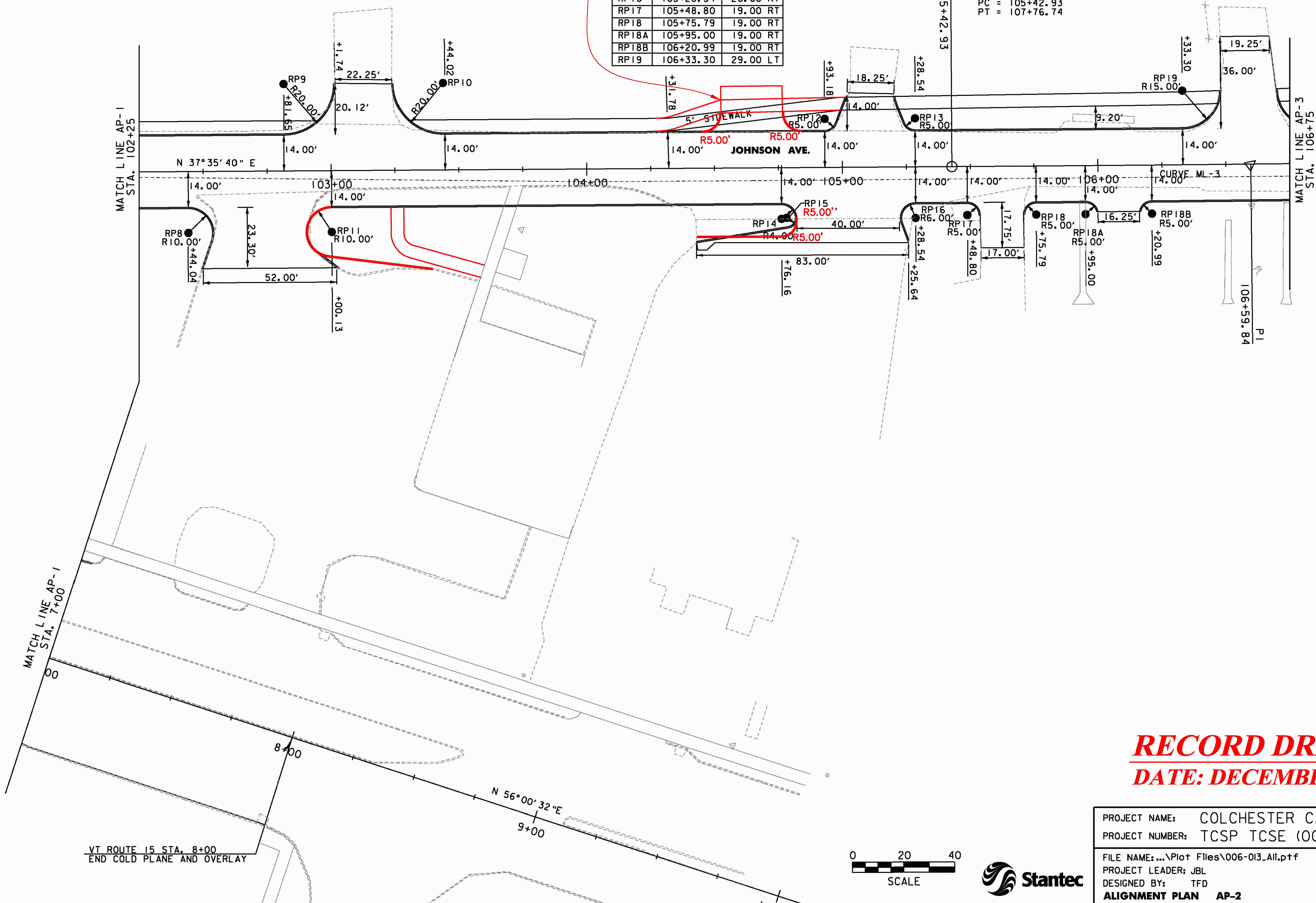

**RECORD DRAWING**  
**DATE: DECEMBER 21, 2012**

PROJECT NAME:	COLCHESTER CAMPUS CONNECTOR
PROJECT NUMBER:	TCSP TCSE (007)
FILE NAME: ...Pilot Files\006-013_All.pptf	PLOT DATE: 12/2/2010
PROJECT LEADER: JBL	DRAWN BY: PZA
DESIGNED BY: TFD	CHECKED BY: GGG
<b>ALIGNMENT PLAN AP-2</b>	SHEET 7 OF 153

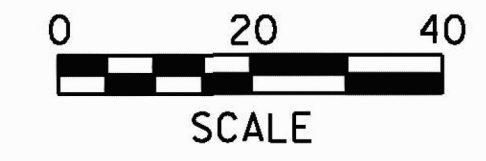

VT ROUTE 15 STA. 8+00  
 END COLD PLANE AND OVERLAY