

1.0 INTRODUCTION

- 1.1 THE FOLLOWING TEMPORARY TRAFFIC CONTROL INFORMATION IS INTENDED TO BE A GENERAL OUTLINE FOR HOW THE WORK SHOULD PROCEED.
- 1.2 THE CONTRACTOR SHALL PROVIDE A TEMPORARY TRAFFIC CONTROL PLAN FOR REVIEW, BY THE CITY AND THE RESIDENT ENGINEER, AND WRITTEN APPROVAL. THIS PLAN SHALL INCLUDE SPECIFIC DETAILS TO ADDRESS PROJECT SPECIFIC SITUATIONS. THIS PLAN SHALL BE CREATED IN ACCORDANCE WITH THE CURRENT VERSION OF THE MANUAL ON UNIFORM TRAFFIC CONTROL DEVICES (MUTCD) AND VTRANS STANDARDS. IN SITUATIONS WHERE CONFLICT EXISTS, THE MUTCD SHALL GOVERN.
- 1.3 IF THE CONTRACTOR DOES NOT WISH TO FOLLOW THIS OUTLINE, AN ALTERNATE PROPOSAL MAY BE SUBMITTED TO THE CITY OF RUTLAND. THE CONTRACTOR MUST ALLOW AT LEAST 4 WEEKS FOR REVIEW AND APPROVAL OF A COMPREHENSIVE PLAN AND 2 WEEKS FOR REVIEW AND APPROVAL OF MINOR CHANGES/DETAILS.

2.0 GENERAL

- 2.1 TRAFFIC CONTROL FOR THE PROJECT WILL BE PAID UNDER ITEM 641.10 - TRAFFIC CONTROL. WORK TO BE PAID UNDER THIS ITEM SHALL INCLUDE, BUT IS NOT LIMITED TO: APPROACH AND ON-PROJECT CONSTRUCTION SIGNING, PORTABLE ARROW BOARDS, BARRELS, CONES, BARRICADES AND TEMPORARY REGULATORY AND WARNING SIGNS AND POSTS. ALL ADJUSTING, RELOCATING AND REMOVING OF THESE DEVICES SHALL ALSO BE INCLUDED. TEMPORARY SIGNAL WORK AND OTHER NECESSARY ADJUSTMENTS TO ACCOMMODATE EACH STAGE OF CONSTRUCTION SHALL BE INCLUDED. DEVELOPING DETAILED TRAFFIC CONTROL PLANS FOR LANE CLOSURES, DETOURS AND OTHER WORK REQUIRING TEMPORARY TRAFFIC CONTROL SHALL ALSO BE INCLUDED. THE FOLLOWING ITEMS WILL BE PAID UNDER THEIR RESPECTIVE BID PRICES:
 - ITEM 621.90 - TEMPORARY TRAFFIC BARRIER
 - ITEM 630.10 - UNIFORMED TRAFFIC OFFICERS
 - ITEM 630.15 - FLAGGERS
 - ITEM 641.15 - PORTABLE CHANGEABLE MESSAGE SIGNS
- 2.2 A MINIMUM OF FOUR LANES OF TRAFFIC ON US 7 SHALL BE MAINTAINED AT ALL TIMES DURING DAYTIME HOURS, BETWEEN THE HOURS OF 6 AM - 6 PM. THIS MAY NECESSITATE THE ROAD WIDENING BETWEEN STRONGS AVENUE AND HOPKINS STREET TO BE COMPLETED PRIOR TO THE PROPOSED SEWER CONSTRUCTION.
- 2.2 ANY WORK TO BE COMPLETED ON THE PROJECT THAT WILL REQUIRE REDUCING THE MAINTAINED LANES BELOW FOUR, SHALL BE PERFORMED DURING NIGHTTIME HOURS, BETWEEN THE HOURS OF 6 PM AND 6 AM. A MINIMUM OF TWO LANES SHALL BE PROVIDED DURING NIGHTTIME HOURS.
- 2.3 ALL CONSTRUCTION LIGHTING REQUIRED DURING NIGHTTIME OPERATIONS SHALL COMPLY WITH SECTION 6 OF THE MUTCD.
- 2.4 DURING CONSTRUCTION, THE MINIMUM WIDTHS ON US ROUTE 7 AND US BR 4 ARE AS FOLLOWS:
 - 1 LANE - 13'
 - 2 LANES - 24'
 - 3 LANES - 35'
 - 4 LANES - 46'
- 2.5 PAVING DROP OFF PROTECTION IN CONSTRUCTION AREAS SHALL CONFORM TO VTRANS STANDARD E-108.
- 2.6 VEHICLES BELONGING TO THE CONTRACTOR OR WORKERS SHALL NOT BE PARKED ON THE PAVEMENT OR SHOULDERS ALONG A ROADWAY BEING USED BY THE GENERAL PUBLIC. VEHICLES SHALL NOT BE PARKED IN A MANNER WHICH OBSTRUCTS ANY SIGNS, BANNERS, BARRICADES OR OTHER TRAFFIC CONTROL DEVICES.
- 2.7 WHEN TYPE III BARRICADES ARE USED NEAR DRIVEWAYS OR INTERSECTIONS, THEY SHALL BE PLACED IN SUCH A WAY AS TO NOT OBSCURE SIGHT DISTANCE.
- 2.8 ALL ROADWAY AREAS TEMPORARILY CLOSED FOR TRENCH, CULVERT, OR CONDUIT EXCAVATION SHALL BE REOPENED AT THE END OF THE WORKDAY. AT ALL TIMES WHEN WORK IS NOT IN PROGRESS, ALL OPENINGS IN THE ROADWAY SHALL BE BACK-FILLED OR PROTECTED TO PROVIDE SAFE PASSAGE OF THE TRAVELING PUBLIC.

- 2.9 WHEN TWO OR MORE WORK AREAS ARE ADJACENT, OVERLAP, OR ARE IN CLOSE PROXIMITY AS DETERMINED BY THE RESIDENT ENGINEER, THE CONTRACTOR SHALL ENSURE THERE IS NO CONFLICTING SIGNAGE AND THAT LANE CONTINUITY IS MAINTAINED THROUGHOUT ALL WORK AREAS.

3.0 SCHOOL ACCESS

- 3.1 SCHOOL ACCESS SHALL BE MAINTAINED AT ALL TIMES. THE CONTRACTOR IS REQUIRED TO COORDINATE, IN WRITING, WITH APPROPRIATE SCHOOL OFFICIALS TWO WEEKS IN ADVANCE OF ANY WORK SO THAT THERE WILL BE ADEQUATE TIME FOR THE CONTRACTOR TO ADJUST THE WORK SCHEDULE TO ACCOMMODATE THE NEEDS OF THE SCHOOL.

4.0 PEDESTRIAN TRAFFIC CONTROL

- 4.1 THE CONTRACTOR SHALL MAINTAIN PEDESTRIAN THROUGH MOVEMENTS FROM ONE END OF THE CONSTRUCTION AREA TO THE OTHER, ON AT LEAST ONE SIDE OF THE STREET DURING CONSTRUCTION. ANY SIDEWALK CLOSURES SHALL BE PROVIDED IN ACCORDANCE WITH THE MUTCD, SECTION 6.
 - 4.2 PEDESTRIAN ACCESS SHALL BE PROVIDED TO ALL ADJACENT PROPERTIES, BUILDINGS, RESIDENCE AND COMMERCIAL PROPERTIES AT ALL TIMES. THIS MAY INCLUDE TEMPORARY WALKWAYS SPANNING CONSTRUCTION AREAS.
 - 4.3 IF SIDEWALKS ARE CLOSED, A TEMPORARY PEDESTRIAN ACCESS ROUTE (TPAR) SHALL BE PROVIDED ON THE SAME SIDE OF THE ROAD AS THE CLOSED SIDEWALK, IF POSSIBLE. SIGNS AND BARRICADES SHALL BE USED TO PROVIDE ADVANCE NOTICE OF THE CLOSURE AND THE ROUTE OF ANY PEDESTRIAN DETOURS. THE TPAR SHALL HAVE A MINIMUM UNOBSTRUCTED WIDTH OF 4 FEET. IF THE TPAR IS LESS THAN 5 FEET IN WIDTH, A 5 FOOT BY 5 FOOT PASSING SPACE SHOULD BE PROVIDED AT LEAST EVERY 200 FEET. THE SURFACE OF THE TPAR SHALL BE SMOOTH AND CONTINUOUS FOR THE LENGTH OF THE TPAR. THE TPAR SHALL MAINTAIN THE SAME LEVEL OF ACCESSIBILITY AND DETECTABILITY AS THE FACILITY THAT IS BEING CLOSED. THE TPAR SHALL NOT LEAD PEDESTRIANS INTO CONFLICTS WITH VEHICLES, EQUIPMENT, OR CONSTRUCTION OPERATIONS.
 - 4.4 IF THE TPAR IS ADJACENT TO MOVING TRAFFIC, CONSTRUCTION OPERATIONS/EQUIPMENT, OR DROP-OFFS, CRASH WORTHY CHANNELIZING DEVICES THAT MEET THE REQUIREMENTS OF THE MUTCD SHALL BE USED.
 - 4.5 THE CONTRACTOR SHALL NOT STORE OR PLACE ANY CONSTRUCTION MATERIALS, EQUIPMENT, OR SIGNS IN THE PEDESTRIAN PATH OF TRAVEL.
 - 4.6 THE CONTRACTOR'S OPERATIONS SHALL NOT OCCUPY SIDEWALKS EXCEPT WHERE PROPER PROTECTION AND A TPAR HAVE BEEN PROVIDED.
 - 4.7 THE CONTRACTOR SHALL PROVIDE A TEMPORARY PEDESTRIAN TRAFFIC CONTROL PLAN FOR REVIEW, BY THE CITY AND THE RESIDENT ENGINEER, AND WRITTEN APPROVAL A MINIMUM OF THREE WEEKS BEFORE SUCH PLAN IS IMPLEMENTED. THIS PLAN SHALL DETAIL THE CONSTRUCTION PHASING AND SCHEDULE AND THE SPECIFIC METHODS OF MAINTAINING SAFE PEDESTRIAN ACCESS THROUGHOUT THE CONSTRUCTION AREA. THIS PLAN SHALL PROVIDE THE LOCATION AND DETAILS OF TEMPORARY CONSTRUCTION SIGNING, MARKINGS, BARRICADES, CHANNELIZING DEVICES, TPARs AND METHODS TO MAINTAIN ACCESS TO ADJACENT PROPERTIES, BUSINESSES, RESIDENCES, ETC.
 - 4.8 ALL WORK ASSOCIATED WITH TPAR SHALL BE CONSIDERED INCIDENTAL TO ITEM 641.10.
- ## 5.0 EMERGENCY ACCESS
- 5.1 THE CONTRACTOR SHOULD NOTE THAT THE RUTLAND CITY FIRE STATION IS LOCATED ON CENTER STREET AND AMBULANCE, POLICE AND OTHER EMERGENCY SERVICES REQUIRE US ROUTE 7 AND BUSINESS ROUTE 4 BE AVAILABLE FOR USE. SPECIAL CARE MUST BE TAKEN TO PROVIDE ACCESS THROUGH WORK ZONES FOR EMERGENCY VEHICLES. THE CONTRACTOR SHALL COORDINATE WITH ALL DEPARTMENTS THROUGH THE COMMUNICATION PROTOCOL AS ESTABLISHED FOR THE PROJECT IN COORDINATION WITH THE CITY OF RUTLAND DEPARTMENT OF PUBLIC WORKS.
 - 5.2 THE CONTRACTOR SHALL MAINTAIN ACCESS TO ALL PROPERTIES AT ALL TIMES FOR EMERGENCY VEHICLES.

- 5.3 THE CONTRACTOR SHALL SUBMIT TO THE APPROPRIATE LAW ENFORCEMENT AND EMERGENCY AGENCIES IN WRITING THE NAME, ADDRESS AND TELEPHONE NUMBER OF THE PERSON OR PERSONS AUTHORIZED TO SECURE LABOR, MATERIALS AND EQUIPMENT FOR EMERGENCY REPAIRS OUTSIDE THE NORMAL WORKING HOURS. DUPLICATE COPIES OF THE ABOVE SHALL BE FILED WITH THE CITY AND THE RESIDENT ENGINEER.

6.0 PUBLIC INGRESS AND EGRESS

- 6.1 MAINTAIN ACCESS TO ALL COMMERCIAL AND MUNICIPAL PROPERTIES DURING BUSINESS HOURS. COORDINATE MAJOR WORK ON COMMERCIAL OR MUNICIPAL ACCESSES WITH THE OWNER, IN WRITING, AT LEAST 1 WEEK PRIOR TO STARTING THE WORK. ALL ACCESSES SHALL ALSO BE KEPT FREE OF WORK AND TRAFFIC CONTROLLED BY UNIFORMED TRAFFIC CONTROL OFFICERS (UTO'S) AS NECESSARY WHEN SPECIAL EVENTS ARE SCHEDULED. THE CONTRACTOR SHALL COORDINATE WITH THE CITY OF RUTLAND TO ACCOMMODATE THESE ACTIVITIES.
- 6.2 ACCESS TO RESIDENTIAL PROPERTIES MAY BE RESTRICTED FOR A SHORT DURATION (A FEW HOURS) WITH PERMISSION OF THE OWNER. THE CONTRACTOR SHALL COORDINATE WITH THE OWNER AT LEAST 24 HOURS IN ADVANCE OF THE POSSIBLE CLOSURE.
- 6.3 THE CONTRACTOR SHALL MAINTAIN SAFE ACCESS FOR BUS PASSENGERS AT MARKED BUS STOPS.

7.0 SIGNS & SIGNALS

- 7.1 EXISTING SIGNING SHALL REMAIN, WHEN RELOCATION IS NECESSARY, UNTIL ITS NEED NO LONGER EXISTS. ALL EXISTING SIGNS THAT DO NOT APPLY TO TEMPORARY CONDITIONS SHALL BE COMPLETELY COVERED BY THE CONTRACTOR. TEMPORARY SIGNING SHALL BE INSTALLED, AS NEEDED AND AS REQUIRED BY THE MUTCD. THIS WORK SHALL BE CONSIDERED INCIDENTAL TO ITEM 641.10.
- 7.2 SIGNALIZED INTERSECTIONS MUST BE CONTROLLED BY UTO'S AT ALL TIMES WHEN THEY ARE NOT IN NORMAL OPERATION, EXCEPT DURING NIGHTTIME FLASHING OPERATION.
- 7.3 ALL NON-OPERATING SIGNAL HEADS SHALL BE REMOVED OR COMPLETELY COVERED.

8.0 FLAGGING AND UNIFORMED TRAFFIC OFFICERS

- 8.1 THE CONTRACTOR SHALL PROVIDE FLAGGERS FOR ONE LANE TRAFFIC CONTROL ON MAIN STREET, ADJACENT TO WORK ZONES ON SIDE STREETS, AND AT LOCATIONS WHERE SIGHT DISTANCES ARE IMPAIRED BY CONSTRUCTION OPERATIONS OR OTHER SITUATIONS. THE CONTRACTOR SHALL PROVIDE UNIFORMED TRAFFIC OFFICERS AT SIGNALIZED INTERSECTIONS DURING MODIFICATION OF SIGNALS.
- 8.2 FLAGGING STATIONS SHALL BE ADJACENT TO THE TRAFFIC LANES BEING CONTROLLED AND SHALL BE POSITIONED SO THAT FLAGGER VISIBILITY TO APPROACHING TRAFFIC IS OPTIMIZED. THE FLAGGER SHALL BE READILY VISIBLE TO APPROACHING TRAFFIC BETWEEN 250' AND 300' IN ADVANCE OF THE FLAGGER LOCATION. ACCORDINGLY, THE TANGENT DIMENSIONS ON EACH END OF THE WORK AREA SHALL BE ESTABLISHED TO ACHIEVE THE APPROPRIATE FLAGGING STATION LOCATION, AS DIRECTED BY THE RESIDENT ENGINEER.
- 8.3 FLAGGERS SHALL BE REQUIRED TO USE TWO-WAY RADIOS, WALKIE-TALKIES OR OTHER FORMS OF ENHANCED COMMUNICATION WHEN ONE FLAGGER IS NOT VISIBLE TO THE OTHER, OR IF THE ENGINEER DEEMS IT NECESSARY. COST TO BE INCLUDED IN ITEM 641.10 TRAFFIC CONTROL.
- 8.4 STOP/SLOW PADDLES SHALL BE USED FOR ALL FLAGGING, AND SHALL CONFORM TO THE REQUIREMENTS SET FORTH IN THE MUTCD.

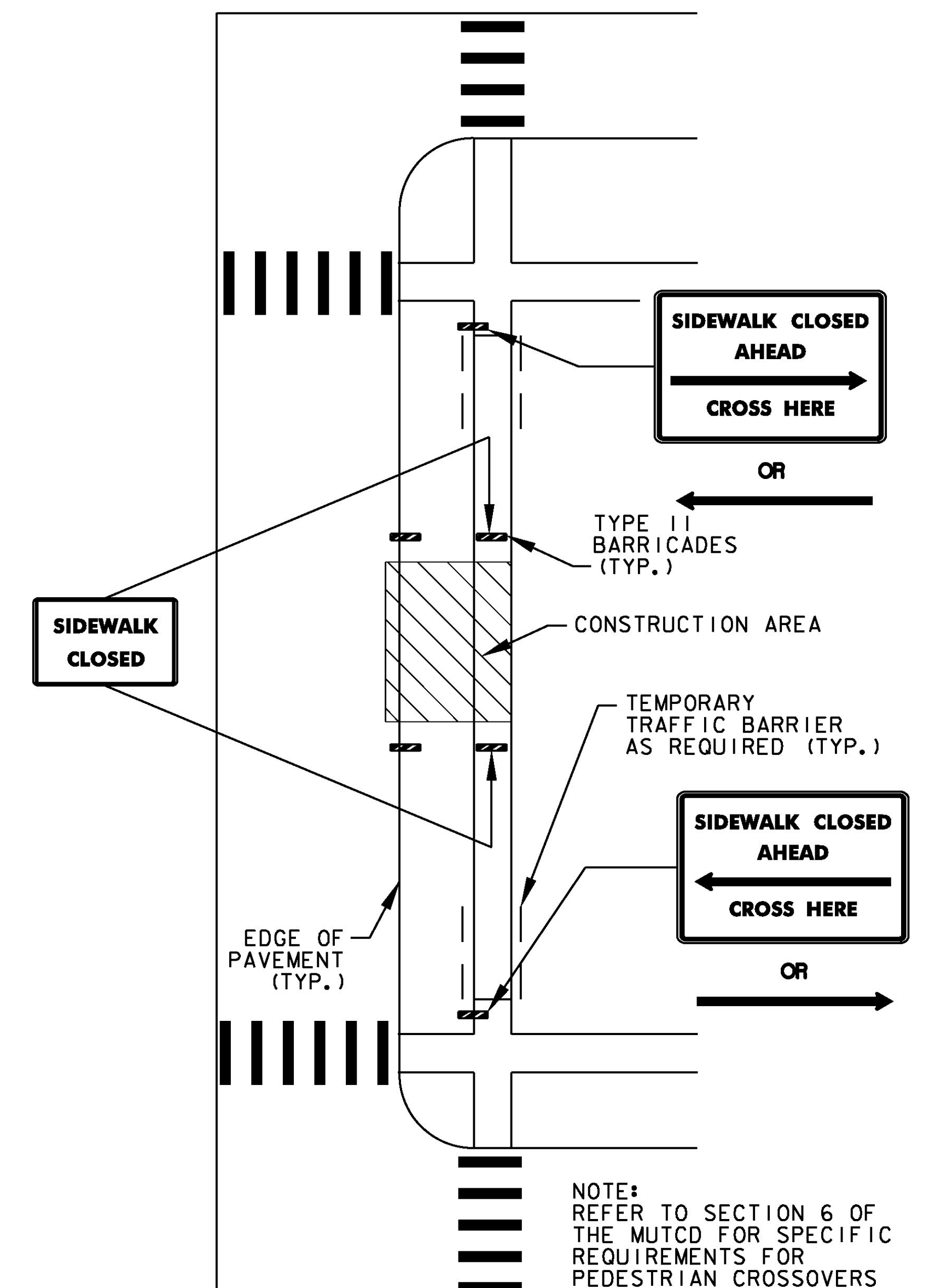

TYPICAL PEDESTRIAN CROSSOVER
(NOT TO SCALE)

PROJECT NAME:	RUTLAND CITY
PROJECT NUMBER:	STP 019-3(57)
FILE NAME: \\rut_traffic_ctrldets.dgn	PLOT DATE: 7/12/2013
PROJECT LEADER: GAE	DRAWN BY: PZA
DESIGNED BY: TFD	CHECKED BY: GAE
TRAFFIC CONTROL DETAILS TD-01	SHEET 372 OF 392

