

SUP CURVE #15	CT CURVE #1
PC STA. 40+13.09	PC STA. CT 2+96.57
PI STA. 40+52.39	PI STA. CT 3+47.63
N 404331.1172	N 404054.0100
E 1515063.1078	E 1515027.1296
PT STA. 40+87.98	PT STA. CT 3+76.16
$\Delta = 42^\circ 54' 18.79''$ LT	$\Delta = 91^\circ 12' 12.00''$ RT
D = 57' 17" 44.81"	D = 114' 35" 29.61"
R = 100'	R = 50'
T = 39.30'	T = 51.06'
L = 74.88'	L = 79.59'
E = 7.44'	E = 21.47'

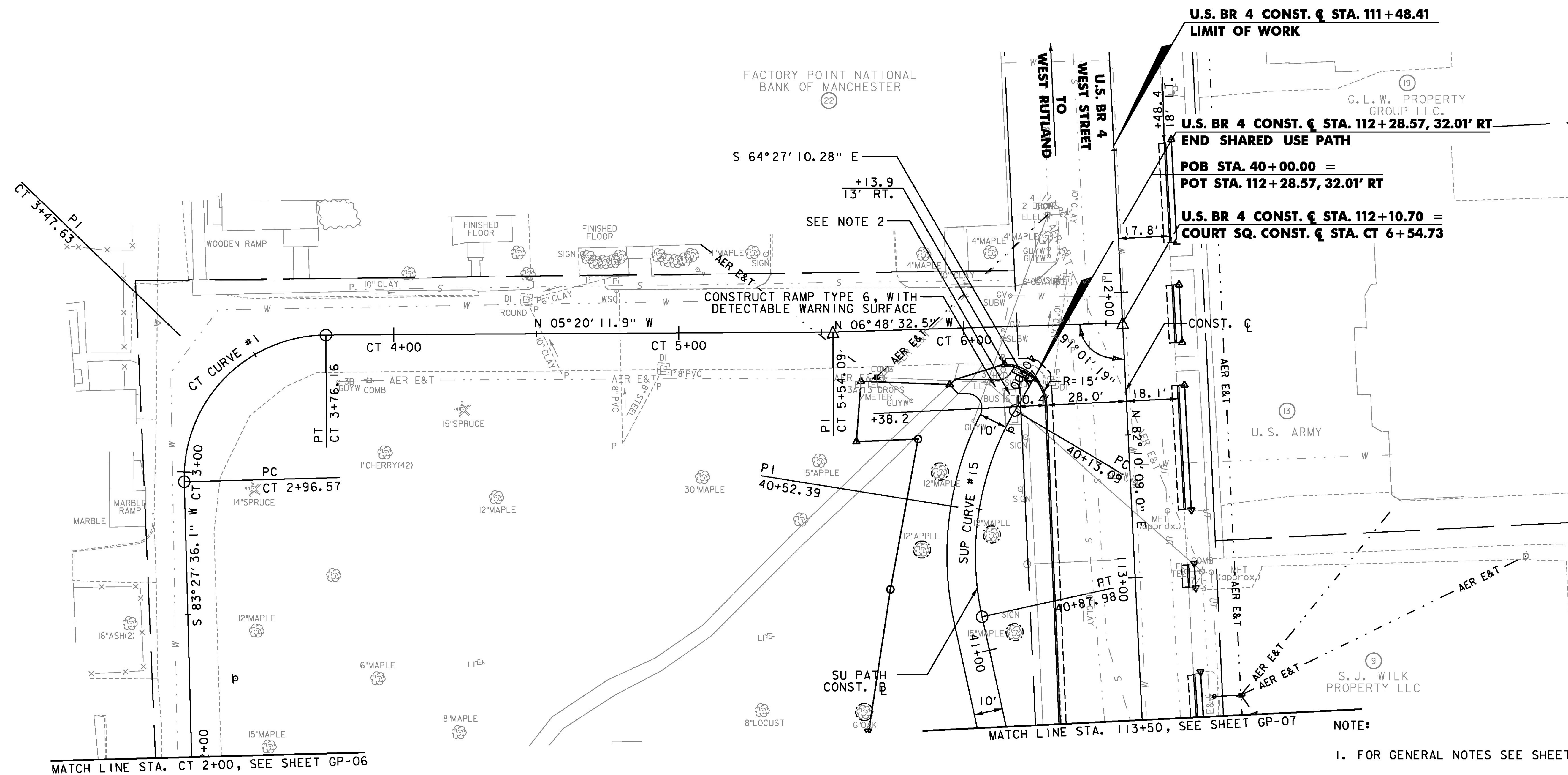
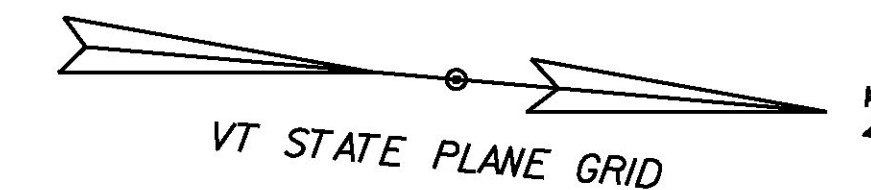

**LEGEND**

- SOIL BORING (SEE GP-01, NOTE 11)
- TREE PROTECTION ZONE (SEE GP-01, NOTE 14)
- SAWCUT LINE (SEE GP-01, NOTE 15)
- ASSUMED LOCATION EXISTING CONCRETE PAVEMENT
- REMOVE EXISTING PAVEMENT

- NOTE:
1. FOR GENERAL NOTES SEE SHEET GP-01.
  2. EXISTING BUS SHELTER SHALL BE REMOVED BY OTHERS. CONTRACTOR IS RESPONSIBLE FOR THE REMOVAL OF ALL EXISTING CONCRETE AND GRAVEL. WHERE NEEDED, COMMON FILL AND 4" OF TOPSOIL SHALL BE USED TO BRING THE EXCAVATED AREA TO PROPOSED GRADE. ALL WORK TO BE PAID UNDER SPECIFIC CONTRACT ITEMS.

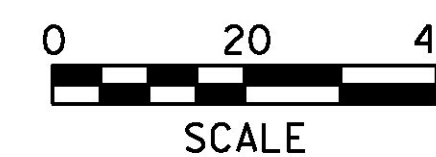

PROJECT NAME:	RUTLAND CITY
PROJECT NUMBER:	STP 019-3(57)
FILE NAME: ...\PlotFiles\rut_genplan.dgn	PLOT DATE: 7/12/2013
PROJECT LEADER: GAE	DRAWN BY: PZA
DESIGNED BY: TFD	CHECKED BY: GAE
<b>GENERAL PLAN GP-08</b>	SHEET 293 OF 392