

SUP CURVE #13	SUP CURVE #14	SUP CURVE #16
PRC STA. 31+51.95	PRC STA. 31+95.01	PC STA. 41+74.01
PI STA. 31+73.82	PI STA. 32+55.10	PI STA. 42+06.01
N 404134.5010	N 404216.4376	N 404378.0567
E 1515312.3330	E 1515314.1329	E 1515213.2770
PRC STA. 31+95.01	PRC STA. 33+15.01	PT STA. 42+37.48
$\Delta = 24^\circ 40' 29.14''$ RT	$\Delta = 06^\circ 52' 36.86''$ LT	$\Delta = 18^\circ 11' 02.13''$ RT
D = 57' 17" 44.81"	D = 05' 43" 46.48"	D = 28' 38" 52.40"
R = 100'	R = 1000'	R = 200'
T = 21.87'	T = 60.08'	T = 32.01'
L = 43.07'	L = 120.02'	L = 63.47'
E = 2.36'	E = 1.80'	E = 2.54'

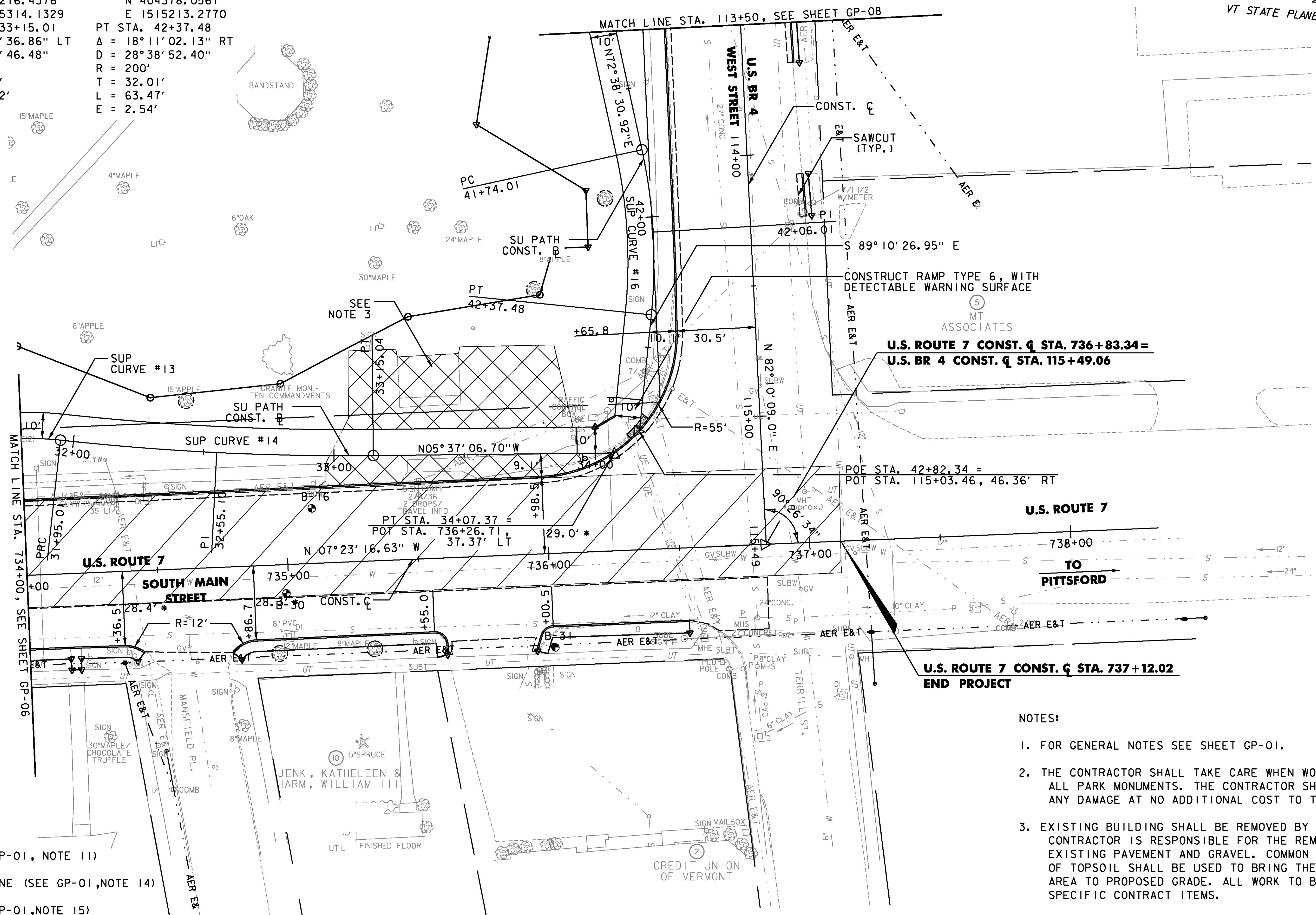

- LEGEND**
- SOIL BORING (SEE GP-01, NOTE 11)
 - TREE PROTECTION ZONE (SEE GP-01, NOTE 14)
 - SAWCUT LINE (SEE GP-01, NOTE 15)
 - ASSUMED LOCATION EXISTING CONCRETE PAVEMENT
 - REMOVE EXISTING PAVEMENT

- NOTES:**
1. FOR GENERAL NOTES SEE SHEET GP-01.
 2. THE CONTRACTOR SHALL TAKE CARE WHEN WORKING AROUND ALL PARK MONUMENTS. THE CONTRACTOR SHALL REPAIR ANY DAMAGE AT NO ADDITIONAL COST TO THE PROJECT.
 3. EXISTING BUILDING SHALL BE REMOVED BY OTHERS. CONTRACTOR IS RESPONSIBLE FOR THE REMOVAL OF ALL EXISTING PAVEMENT AND GRAVEL. COMMON FILL AND 4" OF TOPSOIL SHALL BE USED TO BRING THE EXCAVATED AREA TO PROPOSED GRADE. ALL WORK TO BE PAID UNDER SPECIFIC CONTRACT ITEMS.

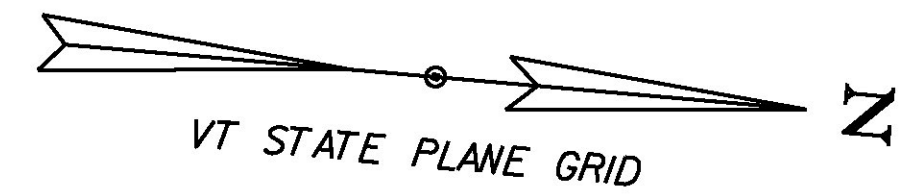
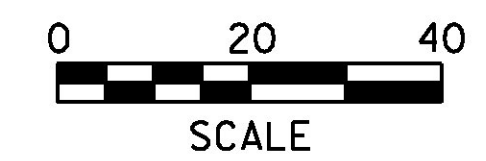

PROJECT NAME: RUTLAND CITY	PLOT DATE: 7/12/2013
PROJECT NUMBER: STP 019-3(57)	DRAWN BY: PZA
FILE NAME: ...\\PlotFiles\rut_genplan.dgn	DESIGNED BY: TFD
PROJECT LEADER: GAE	CHECKED BY: GAE
GENERAL PLAN GP-07	SHEET 292 OF 392