

**CONSTRUCT DRIVE**

STATION	WIDTH*	TYPE
706+90, RT.	12'	BIT. RES.
707+42, RT.	14'	BIT. RES.
708+37, RT.	17'	BIT. RES.
708+71, LT.	10'	BIT. RES.
708+87, RT.	16'	BIT. RES.

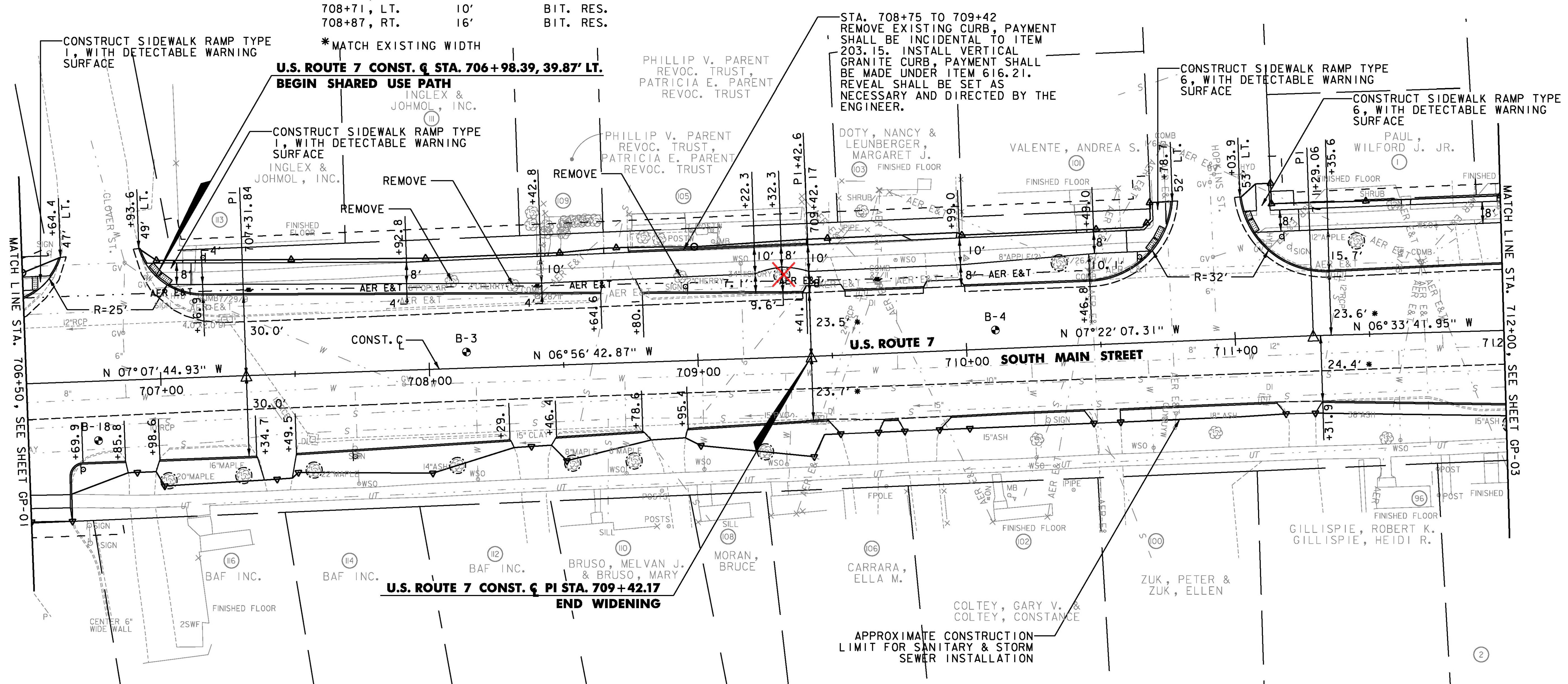

- LEGEND**
- ⊕ SOIL BORING (SEE GP-01, NOTE 11)
  - TREE PROTECTION ZONE (SEE GP-01, NOTE 14)
  - SAWCUT LINE (SEE GP-01, NOTE 15)
  - ▨ ASSUMED LOCATION EXISTING CONCRETE PAVEMENT
  - ▩ REMOVE EXISTING PAVEMENT

ITEM 201.20 - MEDIUM STUMP REMOVAL  
STA 709+40 LT

**NOTE:**  
1. FOR GENERAL NOTES SEE SHEET GP-01.

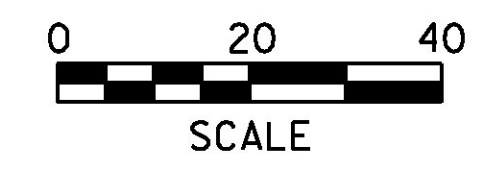

PROJECT NAME:	RUTLAND CITY
PROJECT NUMBER:	STP 019-3(57)
FILE NAME: ... \PlotFiles\rut_genplan.dgn	PLOT DATE: 7/12/2013
PROJECT LEADER: GAE	DRAWN BY: PZA
DESIGNED BY: TFD	CHECKED BY: GAE
<b>GENERAL PLAN GP-02</b>	SHEET 287 OF 392