

SUP CURVE #6	SUP CURVE #7	SUP CURVE #8	SUP CURVE #9	SUP CURVE #10	SUP CURVE #11
PC STA. 20+86.54	PRC STA. 21+37.36	PRC STA. 21+99.54	PRC STA. 22+73.42	PRC STA. 23+50.94	PC STA. 30+15.85
PI STA. 21+11.97	PI STA. 21+68.70	PI STA. 22+36.91	PI STA. 23+12.68	PI STA. 23+67.75	PI STA. 30+46.19
N 403632.3129	N 403687.3668	N 403755.9340	N 403829.0264	N 403884.8924	N 404010.4801
E 1515393.5030	E 1515379.6707	E 1515384.1150	E 1515361.1268	E 1515365.7676	E 1515338.2991
PRC STA. 21+37.36	PRC STA. 21+99.54	PRC STA. 22+73.42	PRC STA. 23+50.94	PT STA. 23+84.30	PRC STA. 30+76.07
$\Delta = 04^{\circ}51'09.84''$ LT	$\Delta = 17^{\circ}48'43.75''$ RT	$\Delta = 21^{\circ}10'02.73''$ LT	$\Delta = 22^{\circ}12'27.07''$ RT	$\Delta = 17^{\circ}22'24.62''$ LT	$\Delta = 17^{\circ}14'56.90''$ RT
D = $09^{\circ}32'57.47''$	D = $28^{\circ}38'52.40''$	D = $28^{\circ}38'52.40''$	D = $28^{\circ}38'52.40''$	D = $52^{\circ}05'13.46''$	D = $28^{\circ}38'52.40''$
R = 600'	R = 200'	R = 200'	R = 200'	R = 110'	R = 200'
T = 25.42'	T = 31.34'	T = 37.37'	T = 39.25'	T = 16.81'	T = 30.33'
L = 50.82'	L = 62.18'	L = 73.89'	L = 77.52'	L = 33.35'	L = 60.21'
E = 0.54'	E = 2.44'	E = 3.46'	E = 3.82'	E = 1.28'	E = 2.29'

COURT SQUARE  $\zeta$  STA. CT 1+34.59  
LIMIT OF WORK

VT. STATE PLANE GRID

SUP CURVE #12

PRC STA. 30+76.07
PI STA. 31+14.47
N 404079.1895
E 1515336.2872
PRC STA. 31+51.95
$\Delta = 21^{\circ}44'21.14''$ LT
D = $28^{\circ}38'52.40''$
R = 200'
T = 38.40'
L = 75.88'
E = 3.65'

N/F  
MAYNARD, HULL P.  
MAYNARD, JOANNA T.

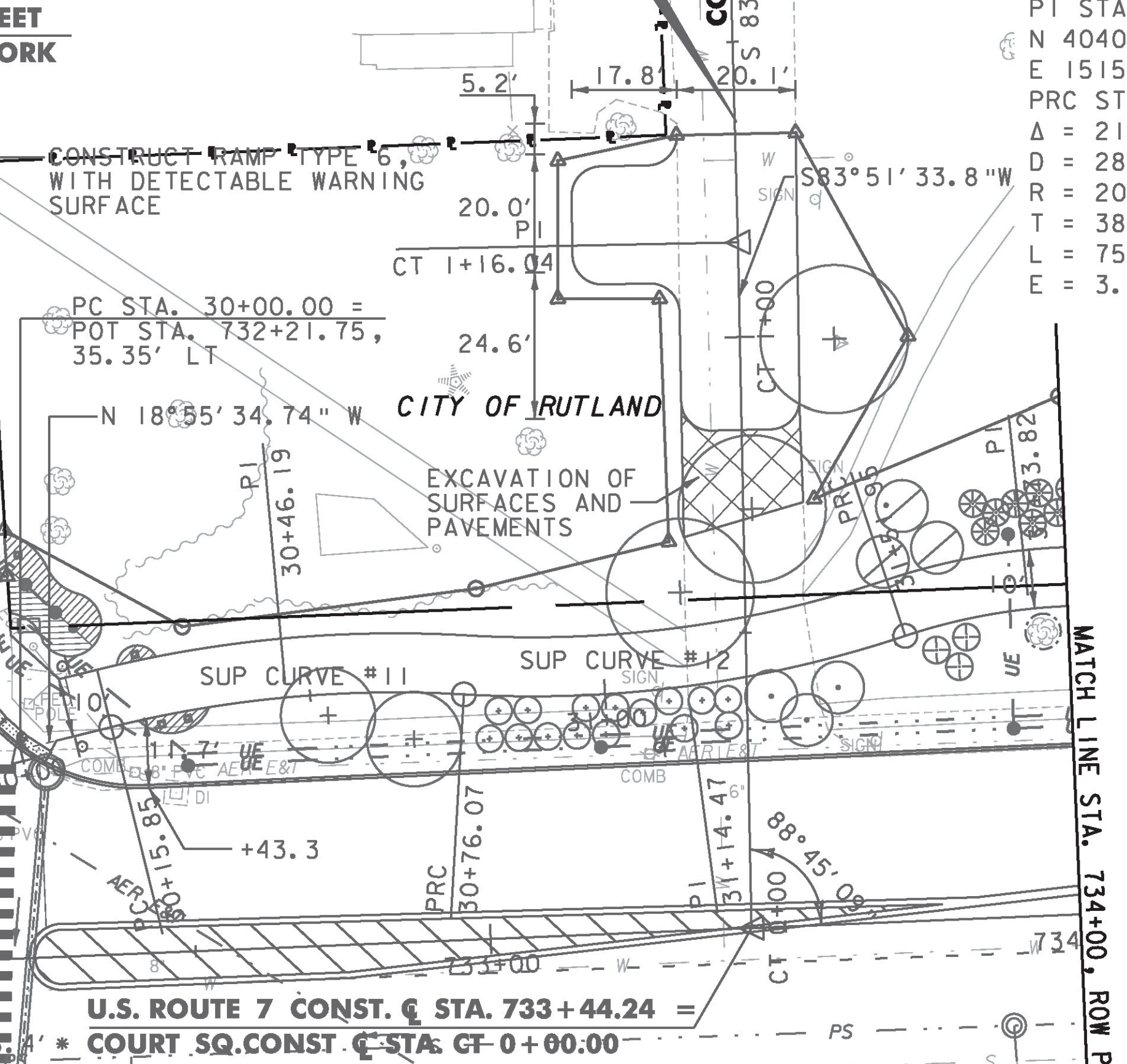

MATCH LINE STA. 728+50, ROW PLAN ROW-5

MATCH LINE STA. 734+00, ROW PLAN ROW-7

LINES SHOWN ON THIS PLAN AS EXISTING PROPERTY LINES P/L ARE BELIEVED TO BE ACCURATE BUT SHOULD NOT BE RELIED UPON FOR PURPOSES UNRELATED TO THE CITY OF RUTLAND'S ACQUISITION OF LAND AND RIGHTS FOR THIS PROJECT.

ALL RIGHTS REQUIRED FOR PROPOSED ELECTRICAL AND TELEPHONE IMPROVEMENTS TO BE ACQUIRED BY OTHERS

THIS SHEET TO BE USED FOR RIGHT-OF-WAY INFORMATION ONLY

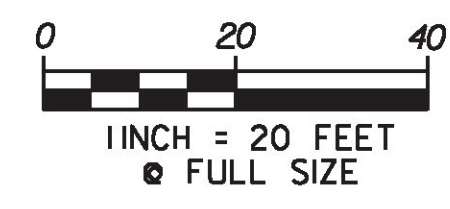

HIGHWAY RIGHT-OF-WAY LIMITS SHOWN ON THESE PLANS HAVE BEEN DETERMINED THROUGH RESEARCH, FIELD SURVEY, AND THROUGH EVIDENCE OF ACTUAL HIGHWAY USE FOR 15 OR MORE YEARS SUFFICIENT TO SHOW DEDICATION AND ACCEPTANCE

DATUM  
VERTICAL NAVD 88  
HORIZONTAL NAD 83(996)

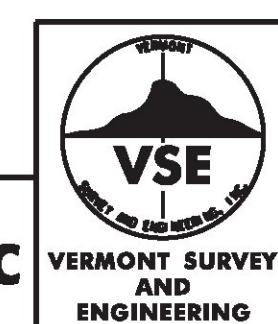

**ROW PLAN  
ROW-6**



PROJECT NAME: RUTLAND CITY	PLOT DATE: 2/15/12
PROJECT NUMBER: STP 019-3(57)	DRAWN BY: ADM
FILE NAME: vse_row_border.dgn	DESIGNED BY: TFD
PROJECT LEADER: GAE	CHECKED BY: GAK
DWG. NO.	SHEET 283 OF 392