

SUP CURVE #1  
 PC STA. 10+00.00  
 PI STA. 10+54.89  
 N 402984.2355  
 E 1515488.9560  
 PRC STA. 11+07.13  
 $\Delta = 30^\circ 41' 30.26''$  LT  
 $D = 28^\circ 38' 52.40''$   
 $R = 200'$   
 $T = 54.89'$   
 $L = 107.13'$   
 $E = 7.39'$

CONSTRUCT DRIVE  
 STATION WIDTH TYPE  
 721+41, LT. 10' BIT.

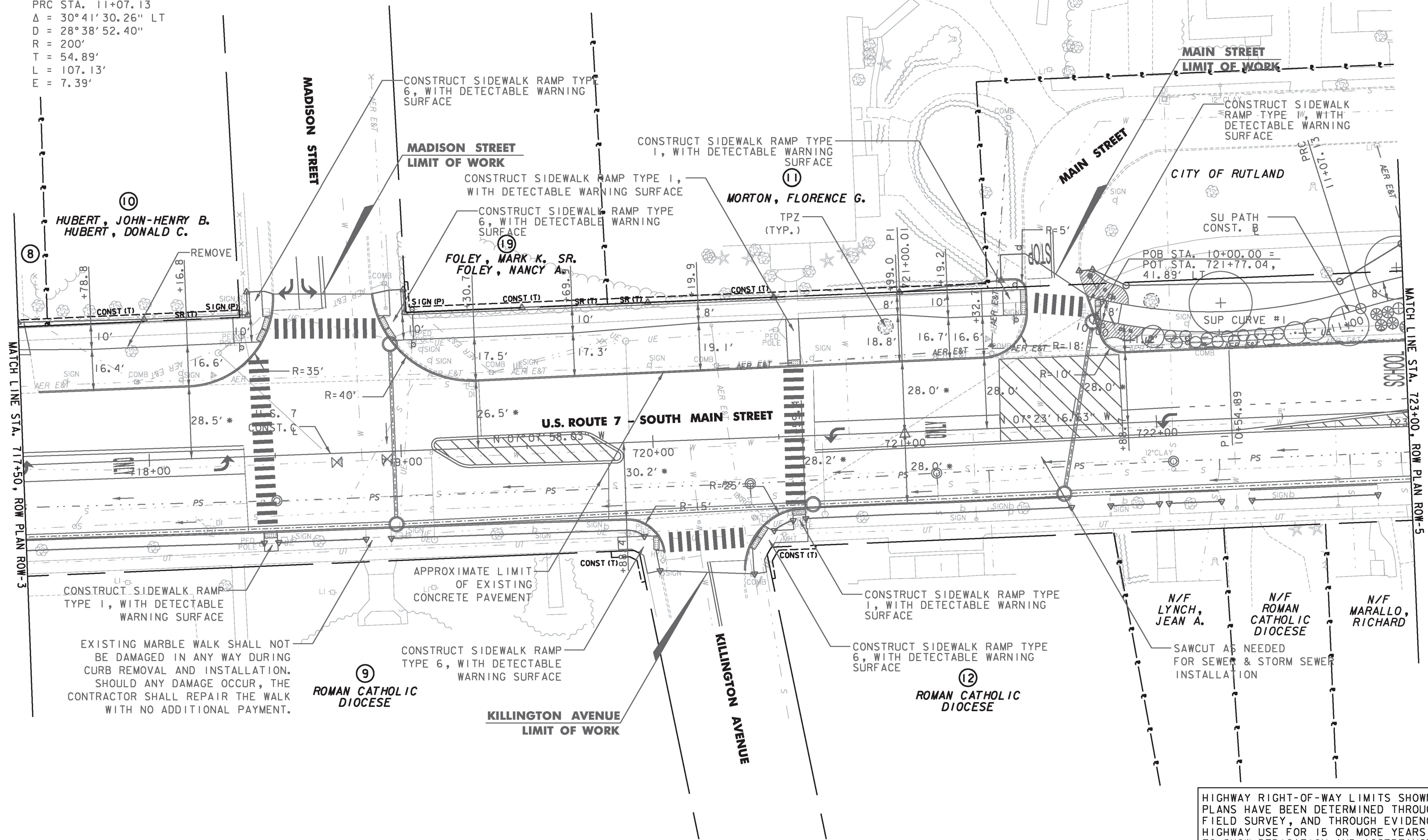

EXISTING MARBLE WALK SHALL NOT BE DAMAGED IN ANY WAY DURING CURB REMOVAL AND INSTALLATION. SHOULD ANY DAMAGE OCCUR, THE CONTRACTOR SHALL REPAIR THE WALK WITH NO ADDITIONAL PAYMENT.

HIGHWAY RIGHT-OF-WAY LIMITS SHOWN ON THESE PLANS HAVE BEEN DETERMINED THROUGH RESEARCH, FIELD SURVEY, AND THROUGH EVIDENCE OF ACTUAL HIGHWAY USE FOR 15 OR MORE YEARS SUFFICIENT TO SHOW DEDICATION AND ACCEPTANCE

LINES SHOWN ON THIS PLAN AS EXISTING PROPERTY LINES P/L ARE BELIEVED TO BE ACCURATE BUT SHOULD NOT BE RELIED UPON FOR PURPOSES UNRELATED TO THE CITY OF RUTLAND'S ACQUISITION OF LAND AND RIGHTS FOR THIS PROJECT.

ALL RIGHTS REQUIRED FOR PROPOSED ELECTRICAL AND TELEPHONE IMPROVEMENTS TO BE ACQUIRED BY OTHERS  
 THIS SHEET TO BE USED FOR RIGHT-OF-WAY INFORMATION ONLY

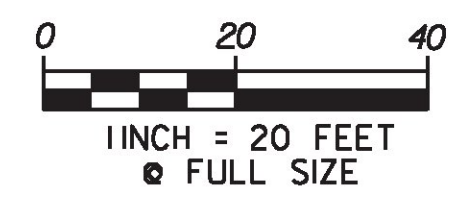

DATUM  
 VERTICAL NAVD 88  
 HORIZONTAL NAD 83(1996)



**ROW PLAN ROW-4**

PROJECT NAME: RUTLAND CITY  
 PROJECT NUMBER: STP 019-3(57)  
 FILE NAME: vse\_row\_border.dgn  
 PROJECT LEADER: GAE  
 DESIGNED BY: TFD  
 DWG. NO.  
 PLOT DATE: 9/27/12  
 DRAWN BY: ADM  
 CHECKED BY: GAK  
 SHEET 281 OF 392