

646.406 DURABLE 4 INCH WHITE LINE, RECESSED POLYUREA
 (ALL LINES WILL INCLUDE EDGE LINE BREAKS AND RADIUS FOR TOWN HIGHWAYS)
 U.S. ROUTE 4:
 STA 7+00.00 - STA 13+00.00 EDGE LINE LT & RT
 STA 7+00.00 - STA 13+00.00 DASHED LANE LINE LT
 STA 7+00.00 - STA 8+50.00 DASHED LANE LINE CL
 STA 8+50.00 - STA 9+50.00 SOLID LANE LINE CL
 STA 9+50.00 - STA 10+50.00 DOTTED LANE LINE CL
 STA 10+50.00 - STA 13+00.00 DASHED LANE LINE RT

646.602 TEMPORARY 4 INCH WHITE LINE, PAINT
 (ALL LINES WILL INCLUDE EDGE LINE BREAKS AND RADIUS FOR TOWN HIGHWAYS)
 U.S. ROUTE 4:
 STA 7+00.00 - STA 13+00.00 EDGE LINE LT & RT
 STA 7+00.00 - STA 13+00.00 DASHED LANE LINE LT
 STA 7+00.00 - STA 8+50.00 DASHED LANE LINE CL
 STA 8+50.00 - STA 9+50.00 SOLID LANE LINE CL
 STA 9+50.00 - STA 10+50.00 DOTTED LANE LINE CL
 STA 10+50.00 - STA 13+00.00 DASHED LANE LINE RT

646.491 DURABLE LETTER OR SYMBOL, TYPE I TAPE
 U.S. ROUTE 4:
 STA 8+23.68 RT, EAST STREET, "S,T,O,P" (4 EA)
 STA 8+54.00 RT, ARROW (1EA)
 STA 9+00.00 RT, "O,N,L,Y" (4 EA)
 STA 9+46.00 RT, ARROW (1EA)
 STA 11+19.36 LT, BELLEVUE AVENUE, "S,T,O,P" (4 EA)

646.416 DURABLE 4 INCH YELLOW LINE, RECESSED POLYUREA
 (ALL LINES WILL INCLUDE C/L BREAKS FOR TOWN HIGHWAYS)
 U.S. ROUTE 4:
 STA 7+00.00 - STA 10+50.00 DOUBLE SOLID RT
 STA 8+23.68 DOUBLE SOLID RT, EAST STREET
 STA 10+50.00 - STA 13+00.00 DOUBLE SOLID CL
 STA 11+19.36 DOUBLE SOLID LT, BELLEVUE AVENUE

646.612 TEMPORARY 4 INCH YELLOW LINE, PAINT
 (ALL LINES WILL INCLUDE C/L BREAKS FOR TOWN HIGHWAYS)
 U.S. ROUTE 4:
 STA 7+00.00 - STA 10+50.00 DOUBLE SOLID RT
 STA 8+23.68 DOUBLE SOLID RT, EAST STREET
 STA 10+50.00 - STA 13+00.00 DOUBLE SOLID CL
 STA 11+19.36 DOUBLE SOLID LT, BELLEVUE AVENUE

646.692 TEMPORARY LETTER OR SYMBOL, PAINT
 U.S. ROUTE 4:
 STA 8+23.68 RT, EAST STREET, "S,T,O,P" (8 EA)
 STA 8+54.00 RT, ARROW (2 EA)
 STA 9+46.00 RT, ARROW (2 EA)
 STA 11+19.36 LT, BELLEVUE AVENUE, "S,T,O,P" (8 EA)

646.487 DURABLE 24 INCH STOP BAR, RECESSED TYPE I TAPE
 U.S. ROUTE 4:
 STA 8+23.68 RT, EAST STREET
 STA 11+19.36 LT, BELLEVUE AVENUE

646.501 DURABLE CROSSWALK MARKING, TYPE I TAPE
 U.S. ROUTE 4:
 STA 8+23.68 RT, EAST STREET
 STA 11+19.36 LT, BELLEVUE AVENUE

646.682 TEMPORARY 24 INCH STOP BAR, PAINT
 U.S. ROUTE 4:
 STA 8+23.68 RT, EAST STREET
 STA 11+19.36 LT, BELLEVUE AVENUE

646.702 TEMPORARY CROSSWALK MARKING, PAINT
 U.S. ROUTE 4:
 STA 8+23.68 RT, EAST STREET
 STA 11+19.36 LT, BELLEVUE AVENUE

675.50 REMOVING SIGNS
 AS SHOWN - 15

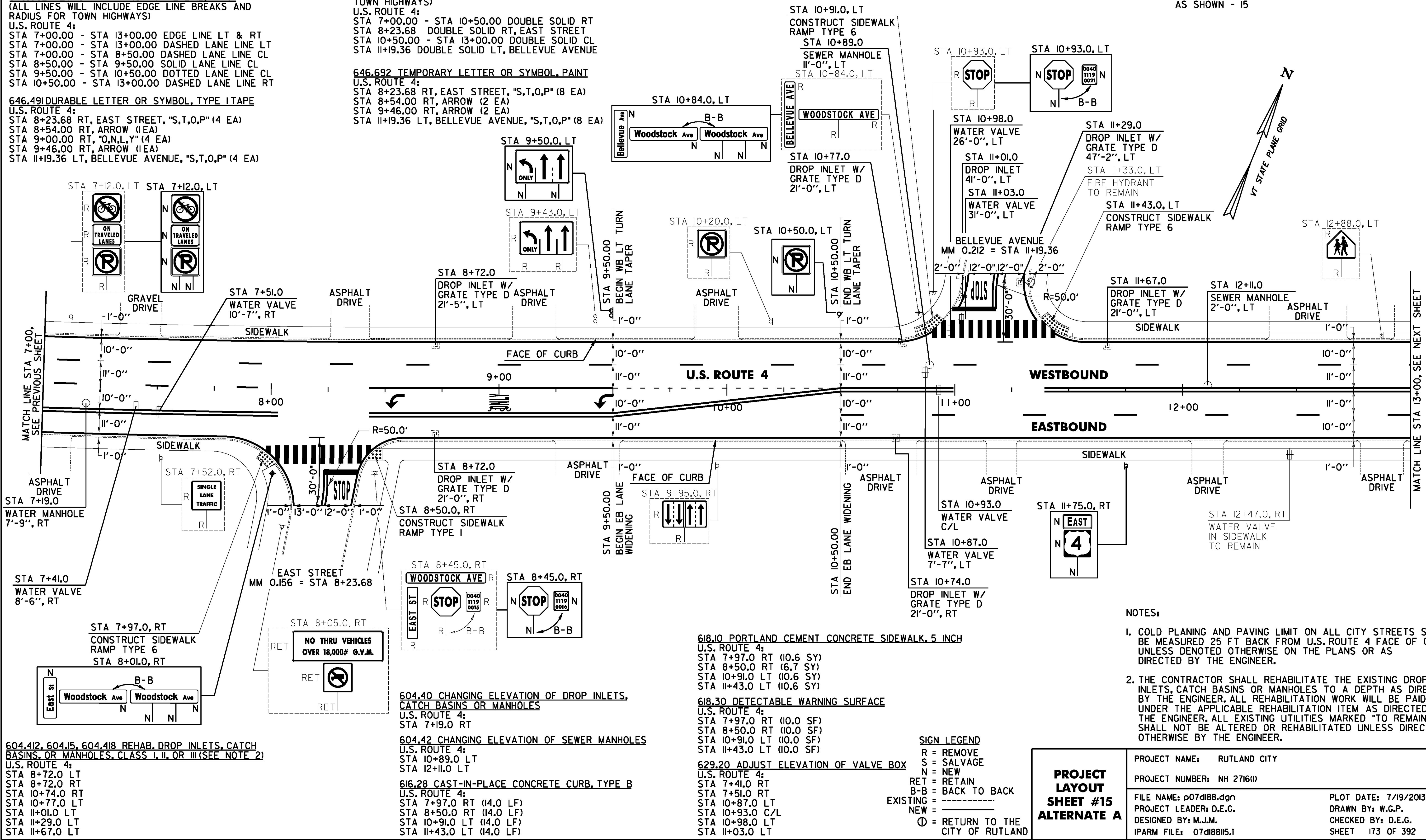

618.10 PORTLAND CEMENT CONCRETE SIDEWALK, 5 INCH
 U.S. ROUTE 4:
 STA 7+97.0 RT (10.6 SY)
 STA 8+50.0 RT (6.7 SY)
 STA 10+91.0 LT (10.6 SY)
 STA 11+43.0 LT (10.6 SY)

618.30 DETECTABLE WARNING SURFACE
 U.S. ROUTE 4:
 STA 7+97.0 RT (10.0 SF)
 STA 8+50.0 RT (10.0 SF)
 STA 10+91.0 LT (10.0 SF)
 STA 11+43.0 LT (10.0 SF)

629.20 ADJUST ELEVATION OF VALVE BOX
 U.S. ROUTE 4:
 STA 7+41.0 RT
 STA 7+51.0 RT
 STA 10+87.0 LT
 STA 10+93.0 C/L
 STA 10+98.0 LT
 STA 11+03.0 LT

SIGN LEGEND
 R = REMOVE
 S = SALVAGE
 N = NEW
 RET = RETAIN
 B-B = BACK TO BACK
 EXISTING = -----
 NEW = _____
 ⊕ = RETURN TO THE CITY OF RUTLAND

- NOTES:**
1. COLD PLANING AND PAVING LIMIT ON ALL CITY STREETS SHALL BE MEASURED 25 FT BACK FROM U.S. ROUTE 4 FACE OF CURB UNLESS DENOTED OTHERWISE ON THE PLANS OR AS DIRECTED BY THE ENGINEER.
 2. THE CONTRACTOR SHALL REHABILITATE THE EXISTING DROP INLETS, CATCH BASINS OR MANHOLES TO A DEPTH AS DIRECTED BY THE ENGINEER. ALL REHABILITATION WORK WILL BE PAID FOR UNDER THE APPLICABLE REHABILITATION ITEM AS DIRECTED BY THE ENGINEER. ALL EXISTING UTILITIES MARKED "TO REMAIN" SHALL NOT BE ALTERED OR REHABILITATED UNLESS DIRECTED OTHERWISE BY THE ENGINEER.

PROJECT LAYOUT SHEET #15 ALTERNATE A	PROJECT NAME: RUTLAND CITY	PLOT DATE: 7/19/2013
	PROJECT NUMBER: NH 2716(I)	DRAWN BY: W.G.P.
	FILE NAME: p07d188.dgn	DESIGNED BY: M.J.M.
	PROJECT LEADER: D.E.G.	CHECKED BY: D.E.G.
	IPARM FILE: 07d188i15	SHEET 173 OF 392

FILE NAME = I:\17765\CA000\NSTR\NH_2716\07d188.dgn
 DATE/TIME = 7/19/2013 10:49:16
 USER = 4916