

646.406 DURABLE 4 INCH WHITE LINE, RECESSED POLYUREA
 (ALL LINES WILL INCLUDE EDGE LINE BREAKS AND RADIUS FOR TOWN HIGHWAYS)
 U.S. ROUTE 7:
 STA 66+00.00 - STA 68+27.04 EDGE LINE LT & RT
 STA 66+00.00 - STA 67+25.00 DASHED LANE LINE LT
 STA 66+00.00 - STA 67+35.00 DASHED LANE LINE RT
 STA 66+00.00 - STA 67+35.00 SOLID LANE LINE RT

646.602 TEMPORARY 4 INCH WHITE LINE, PAINT
 (ALL LINES WILL INCLUDE EDGE LINE BREAKS AND RADIUS FOR TOWN HIGHWAYS)
 U.S. ROUTE 7:
 STA 66+00.00 - STA 68+27.04 EDGE LINE LT & RT
 STA 66+00.00 - STA 67+25.00 DASHED LANE LINE LT
 STA 66+00.00 - STA 67+35.00 DASHED LANE LINE RT
 STA 66+00.00 - STA 67+35.00 SOLID LANE LINE RT

646.416 DURABLE 4 INCH YELLOW LINE, RECESSED POLYUREA
 (ALL LINES WILL INCLUDE C/L BREAKS FOR TOWN HIGHWAYS) S=SOLID, D=DASHED
 U.S. ROUTE 7:
 STA 66+00.00 - STA 67+35.00 DOUBLE SOLID CL

646.612 TEMPORARY 4 INCH YELLOW LINE, PAINT
 (ALL LINES WILL INCLUDE C/L BREAKS FOR TOWN HIGHWAYS) S=SOLID, D=DASHED
 U.S. ROUTE 7:
 STA 66+00.00 - STA 67+35.00 DOUBLE SOLID CL

604.42 CHANGING ELEVATION OF SEWER MANHOLES
 U.S. ROUTE 7:
 STA 67+70.0 RT

616.28 CAST-IN-PLACE CONCRETE CURB, TYPE B
 U.S. ROUTE 7:
 STA 67+59.0 RT (14.0 LF)

618.10 PORTLAND CEMENT CONCRETE SIDEWALK, 5 INCH
 U.S. ROUTE 7:
 STA 67+59.0 RT (10.6 SF)

618.30 DETECTABLE WARNING SURFACE
 U.S. ROUTE 7:
 STA 67+59.0 RT (10.0 SF)

629.20 ADJUST ELEVATION OF VALVE BOX
 U.S. ROUTE 7:
 STA 67+55.0 RT
 STA 67+87.0 RT
 STA 68+08.0 RT

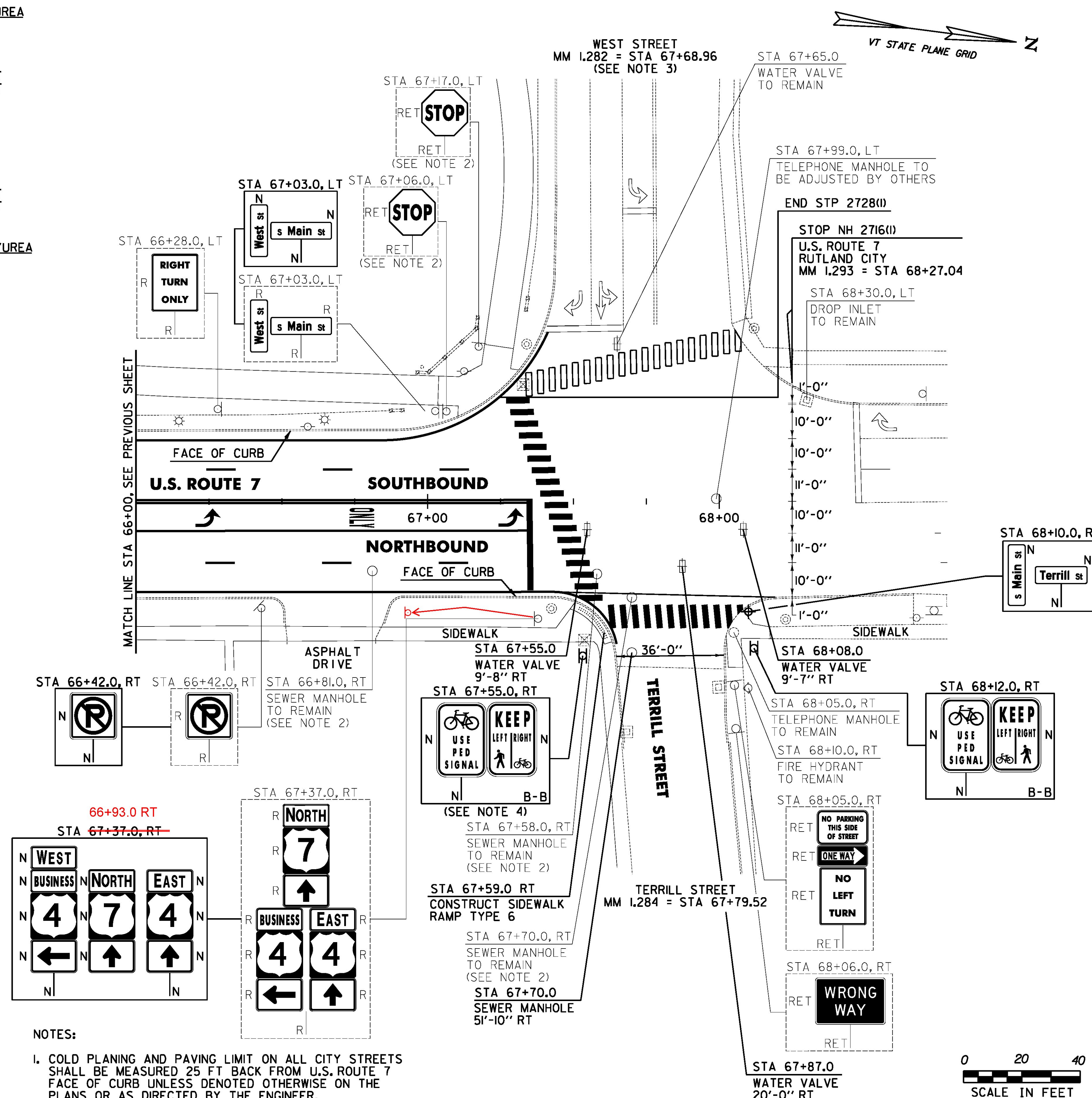

- NOTES:**
1. COLD PLANING AND PAVING LIMIT ON ALL CITY STREETS SHALL BE MEASURED 25 FT BACK FROM U.S. ROUTE 7 FACE OF CURB UNLESS DENOTED OTHERWISE ON THE PLANS OR AS DIRECTED BY THE ENGINEER.
 2. INSTALLED OR ADJUSTED UNDER STP 019-3(57) PRIOR TO CONSTRUCTION.
 3. SEE STP 2728(I) PROJECT FOR PROPOSED WEST STREET STRIPING.
 4. PROPOSED SIGNS AND POSTS TO BE INSTALLED BY OTHERS.

646.487 DURABLE 24 INCH STOP BAR, RECESSED TYPE I TAPE
 U.S. ROUTE 7:
 STA 67+36.00 RT

646.682 TEMPORARY 24 INCH STOP BAR, PAINT
 U.S. ROUTE 7:
 STA 67+36.00 RT

646.491 DURABLE LETTER OR SYMBOL, TYPE I TAPE
 U.S. ROUTE 7:
 STA 66+24.70 RT ARROW (1EA)
 STA 66+77.50 RT "O,N,L,Y" (4 EA)
 STA 67+26.00 RT ARROW (1EA)

646.501 DURABLE CROSSWALK MARKING, TYPE I TAPE
 U.S. ROUTE 7:
 STA 67+45.00 LT/RT
 STA 67+79.52 RT, TERRILL STREET

646.692 TEMPORARY LETTER OR SYMBOL, PAINT
 U.S. ROUTE 7:
 STA 66+24.70 RT ARROW (2 EA)
 STA 67+26.00 RT ARROW (2 EA)

646.702 TEMPORARY CROSSWALK MARKING, PAINT
 U.S. ROUTE 7:
 STA 67+45.00 LT/RT
 STA 67+79.52 RT, TERRILL STREET

675.50 REMOVING SIGNS
 AS SHOWN - 13

SIGN LEGEND
 R = REMOVE
 S = SALVAGE
 N = NEW
 RET = RETAIN
 B-B = BACK TO BACK
 EXISTING = -----
 NEW = _____
 ⊙ = RETURN TO THE CITY OF RUTLAND

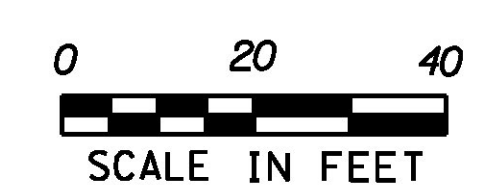

PROJECT LAYOUT SHEET #13	PROJECT NAME: RUTLAND CITY
	PROJECT NUMBER: NH 2716(I)
	FILE NAME: p07d188.dgn
	IPARM FILE: 07d188i13.1
	PLOT DATE: 7/19/2013
	DRAWN BY: W.G.P.
	CHECKED BY: D.E.G.
	SHEET 171 OF 392

FILE NAME: I:\17765\ACADD\WST\NH 2716\07d188.dgn
 DATE/TIME: 7/19/2013 4:16
 USER: