

**646.406 DURABLE 4 INCH WHITE LINE, RECESSED POLYUREA**  
 (ALL LINES WILL INCLUDE EDGE LINE BREAKS AND RADIUS FOR TOWN HIGHWAYS)  
 U.S. ROUTE 7:  
 STA 42+00.00 - STA 45+00.00 EDGE LINE LT & RT  
 STA 42+00.00 - STA 45+00.00 DASHED LANE LINE LT  
 STA 42+00.00 - STA 45+00.00 DASHED LANE LINE RT

**646.602 TEMPORARY 4 INCH WHITE LINE, PAINT**  
 (ALL LINES WILL INCLUDE EDGE LINE BREAKS AND RADIUS FOR TOWN HIGHWAYS)  
 U.S. ROUTE 7:  
 STA 42+00.00 - STA 45+00.00 EDGE LINE LT & RT  
 STA 42+00.00 - STA 45+00.00 DASHED LANE LINE LT  
 STA 42+00.00 - STA 45+00.00 DASHED LANE LINE RT

**646.416 DURABLE 4 INCH YELLOW LINE, RECESSED POLYUREA**  
 (ALL LINES WILL INCLUDE C/L BREAKS FOR TOWN HIGHWAYS)  
 U.S. ROUTE 7:  
 STA 42+00.00 - STA 42+10.00 DOUBLE SOLID CL  
 STA 42+10.00 - STA 43+55.00 DOUBLE SOLID MEDIAN CL/RT  
 STA 43+77.12 DOUBLE SOLID LT, JACKSON AVENUE  
 STA 44+10.00 - STA 45+00.00 SOLID/DASH TURN LANE LINES CL/RT

**646.612 TEMPORARY 4 INCH YELLOW LINE, PAINT**  
 (ALL LINES WILL INCLUDE C/L BREAKS FOR TOWN HIGHWAYS)  
 U.S. ROUTE 7:  
 STA 42+00.00 - STA 42+10.00 DOUBLE SOLID CL  
 STA 42+10.00 - STA 43+55.00 DOUBLE SOLID MEDIAN CL/RT  
 STA 43+77.12 DOUBLE SOLID LT, JACKSON AVENUE  
 STA 44+10.00 - STA 45+00.00 SOLID/DASH TURN LANE LINES CL/RT

**646.456 DURABLE 8 INCH YELLOW LINE, RECESSED POLYUREA**  
 U.S. ROUTE 7:  
 STA 42+10.00 - STA 43+55.00 HATCHED MEDIAN CL/RT

**646.487 DURABLE 24 INCH STOP BAR, RECESSED TYPE I TAPE**  
 U.S. ROUTE 7:  
 STA 43+77.12 RT, JACKSON AVENUE

**646.682 TEMPORARY 24 INCH STOP BAR, PAINT**  
 U.S. ROUTE 7:  
 STA 43+77.12 RT, JACKSON AVENUE

**646.491 DURABLE LETTER OR SYMBOL, TYPE I TAPE**  
 U.S. ROUTE 7:  
 STA 43+77.12 RT, JACKSON AVENUE, "S,T,O,P" (4 EA)  
 STA 44+34.25 RT, ARROW (1 EA)  
 STA 44+45.25 RT, ARROW (1 EA)

**646.692 TEMPORARY LETTER OR SYMBOL, PAINT**  
 U.S. ROUTE 7:  
 STA 43+77.12 RT, JACKSON AVENUE, "S,T,O,P" (8 EA)  
 STA 44+34.25 RT, ARROW (2 EA)  
 STA 44+45.25 RT, ARROW (2 EA)

**646.501 DURABLE CROSSWALK MARKING, TYPE I TAPE**  
 U.S. ROUTE 7:  
 STA 43+77.12 RT, JACKSON AVENUE

**646.702 TEMPORARY CROSSWALK MARKING, PAINT**  
 U.S. ROUTE 7:  
 STA 43+77.12 RT, JACKSON AVENUE

**675.50 REMOVING SIGNS**  
 AS SHOWN - 6

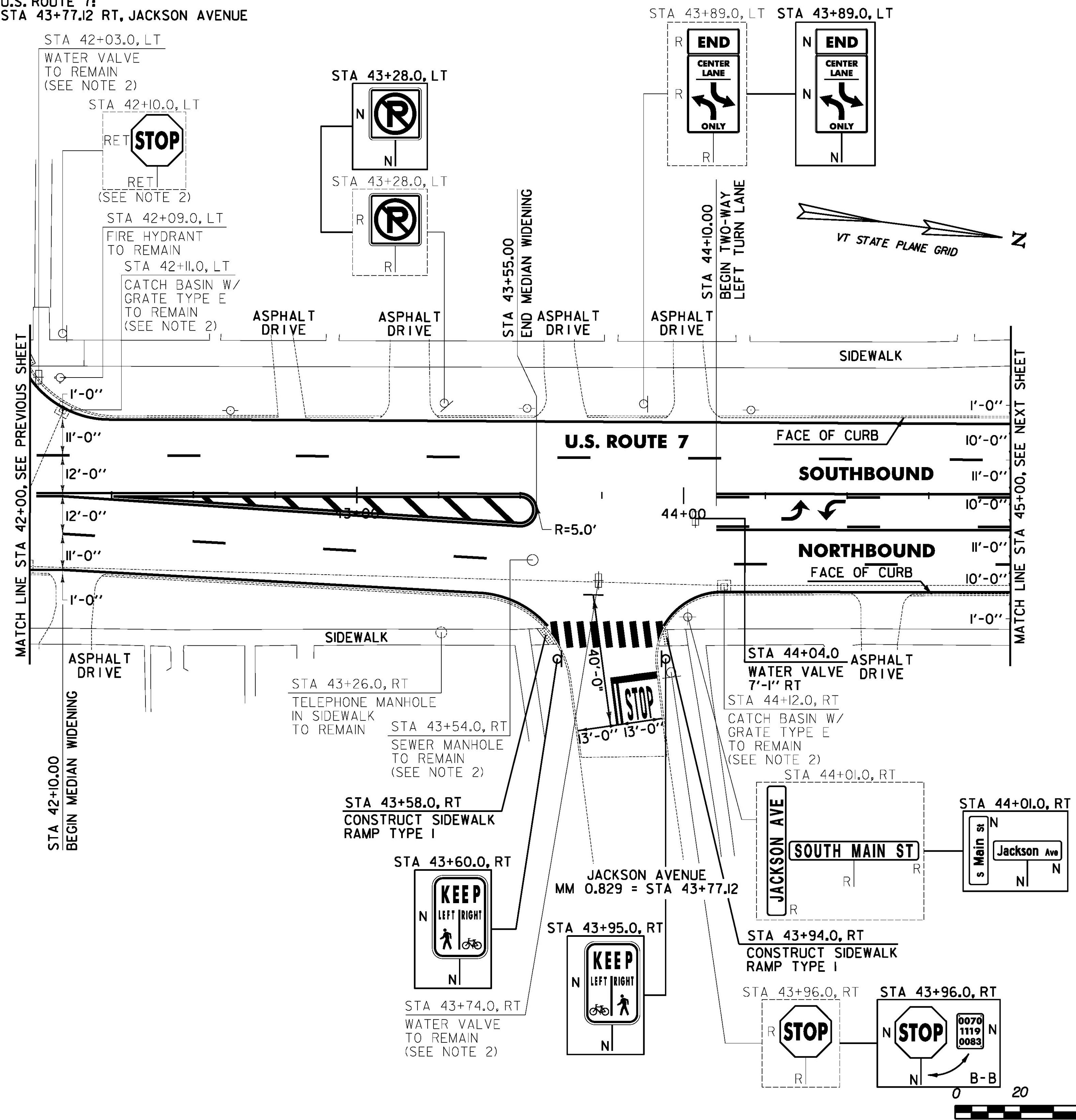

**616.28 CAST-IN-PLACE CONCRETE CURB, TYPE B**  
 U.S. ROUTE 7:  
 STA 43+58.0 RT (14.0 LF)  
 STA 43+94.0 RT (14.0 LF)

**618.10 PORTLAND CEMENT CONCRETE SIDEWALK, 5 INCH**  
 U.S. ROUTE 7:  
 STA 43+58.0 RT (6.7 SY)  
 STA 43+94.0 RT (6.7 SY)

**618.30 DETECTABLE WARNING SURFACE**  
 U.S. ROUTE 7:  
 STA 43+58.0 RT (10.0 SF)  
 STA 43+94.0 RT (10.0 SF)

**629.20 ADJUST ELEVATION OF VALVE BOX**  
 U.S. ROUTE 7:  
 STA 44+04.0 RT

**NOTES:**

- COLD PLANING AND PAVING LIMIT ON ALL CITY STREETS SHALL BE MEASURED 25 FT BACK FROM U.S. ROUTE 7 FACE OF CURB UNLESS DENOTED OTHERWISE ON THE PLANS OR AS DIRECTED BY THE ENGINEER.
- INSTALLED OR ADJUSTED UNDER STP 019-3(57) PRIOR TO CONSTRUCTION.

**SIGN LEGEND**  
 R = REMOVE  
 S = SALVAGE  
 N = NEW  
 RET = RETAIN  
 B-B = BACK TO BACK  
 EXISTING = - - - - -  
 NEW = \_\_\_\_\_  
 Ⓞ = RETURN TO THE CITY OF RUTLAND

SCALE IN FEET

**PROJECT LAYOUT SHEET #5**

PROJECT NAME:	RUTLAND CITY
PROJECT NUMBER:	NH 2716(1)
FILE NAME:	p07d188.dgn
PROJECT LEADER:	D.E.G.
DESIGNED BY:	M.J.M.
IPARM FILE:	07d18805.1
PLOT DATE:	7/19/2013
DRAWN BY:	W.G.P.
CHECKED BY:	D.E.G.
SHEET	163 OF 392

FILE NAME = I:\17762\ACADD\WSTIN\NH\_2716\07d188.dgn  
 DATE/TIME = 7/19/2013 4:49:16  
 USER =