

646.406 DURABLE 4 INCH WHITE LINE, RECESSED POLYUREA
(ALL LINES WILL INCLUDE EDGE LINE BREAKS AND RADIUS FOR TOWN HIGHWAYS)

U.S. ROUTE 7:
STA 30+00.00 - STA 36+00.00 EDGE LINE LT & RT
STA 30+00.00 - STA 30+60.00 SOLID LANE LINE CL
STA 30+00.00 - STA 30+60.00 SOLID LANE LINE RT
STA 30+00.00 - STA 36+00.00 DASHED LANE LINE LT
STA 30+00.00 - STA 36+00.00 DASHED LANE LINE RT
STA 31+57.44 SOLID LANE LINE LT, STRONGS AVENUE
STA 31+57.44 DASHED LANE LINE LT, STRONGS AVENUE
STA 32+00.00 - STA 32+75.00 SOLID LANE LINE LT
STA 32+75.00 - STA 33+75.00 DOTTED LANE LINE LT

646.602 TEMPORARY 4 INCH WHITE LINE, PAINT
(ALL LINES WILL INCLUDE EDGE LINE BREAKS AND RADIUS FOR TOWN HIGHWAYS)

U.S. ROUTE 7:
STA 30+00.00 - STA 36+00.00 EDGE LINE LT & RT
STA 30+00.00 - STA 30+60.00 SOLID LANE LINE CL
STA 30+00.00 - STA 30+60.00 SOLID LANE LINE RT
STA 30+00.00 - STA 36+00.00 DASHED LANE LINE LT
STA 30+00.00 - STA 36+00.00 DASHED LANE LINE RT
STA 31+57.44 SOLID LANE LINE LT, STRONGS AVENUE
STA 31+57.44 DASHED LANE LINE LT, STRONGS AVENUE
STA 32+00.00 - STA 32+75.00 SOLID LANE LINE LT
STA 32+75.00 - STA 33+75.00 DOTTED LANE LINE LT

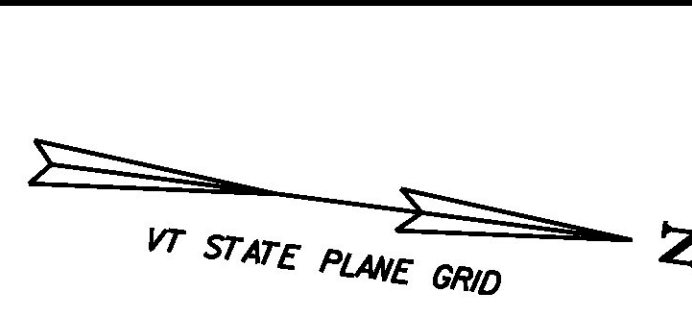

646.416 DURABLE 4 INCH YELLOW LINE, RECESSED POLYUREA
(ALL LINES WILL INCLUDE C/L BREAKS FOR TOWN HIGHWAYS)

U.S. ROUTE 7:
STA 30+00.00 - STA 30+60.00 DOUBLE SOLID LT
STA 31+57.44 DOUBLE SOLID LT, STRONGS AVENUE
STA 31+95.00 - STA 32+75.00 DOUBLE SOLID MEDIAN CL/RT
STA 32+75.00 - STA 33+75.00 DOUBLE SOLID MEDIAN LT/RT
STA 33+75.00 - STA 36+00.00 SOLID/DASH TURN LANE LINES LT/RT

646.612 TEMPORARY 4 INCH YELLOW LINE, PAINT
(ALL LINES WILL INCLUDE C/L BREAKS FOR TOWN HIGHWAYS)

U.S. ROUTE 7:
STA 30+00.00 - STA 30+60.00 DOUBLE SOLID LT
STA 31+57.44 DOUBLE SOLID LT, STRONGS AVENUE
STA 31+95.00 - STA 32+75.00 DOUBLE SOLID MEDIAN CL/RT
STA 32+75.00 - STA 33+75.00 DOUBLE SOLID MEDIAN LT/RT
STA 33+75.00 - STA 36+00.00 SOLID/DASH TURN LANE LINES LT/RT

646.456 DURABLE 8 INCH YELLOW LINE, RECESSED POLYUREA
U.S. ROUTE 7:
STA 31+95.00 - STA 33+75.00 HATCHED MEDIAN LT/RT

646.487 DURABLE 24 INCH STOP BAR, RECESSED TYPE I TAPE
U.S. ROUTE 7:
STA 30+62.00 LT/RT
STA 31+57.44 LT, STRONGS AVENUE
STA 31+99.00 LT

646.682 TEMPORARY 24 INCH STOP BAR, PAINT
U.S. ROUTE 7:
STA 30+62.00 LT/RT
STA 31+57.44 LT, STRONGS AVENUE
STA 31+99.00 LT

646.491 DURABLE LETTER OR SYMBOL, TYPE I TAPE
U.S. ROUTE 7:
STA 30+54.00 LT, ARROW (1EA)
STA 30+54.00 RT, ARROW (1EA)
STA 31+57.44 LT, STRONGS AVENUE, ARROW (1EA)
STA 31+57.44 LT, STRONGS AVENUE, ARROW (2 EA)
STA 32+08.00 LT, ARROW (1EA)
STA 32+70.80 LT, ARROW (1EA)
STA 33+99.25 CL ARROW (1EA)
STA 34+12.63 CL ARROW (1EA)

646.511 DURABLE RAILROAD CROSSING SYMBOL, TYPE I TAPE
U.S. ROUTE 7:
STA 30+13.00 LT (2 EA)

646.692 TEMPORARY LETTER OR SYMBOL, PAINT
U.S. ROUTE 7:
STA 30+54.00 LT, ARROW (2 EA)
STA 30+54.00 RT, ARROW (2 EA)
STA 31+57.44 LT, STRONGS AVENUE, ARROW (2 EA)
STA 31+57.44 LT, STRONGS AVENUE, ARROW (4 EA)
STA 32+08.00 LT, ARROW (2 EA)
STA 32+70.80 LT, ARROW (2 EA)
STA 33+99.25 CL ARROW (2 EA)
STA 34+12.63 CL ARROW (2 EA)

646.501 DURABLE CROSSWALK MARKING, TYPE I TAPE
U.S. ROUTE 7:
STA 31+57.44 LT, STRONGS AVENUE

646.702 TEMPORARY CROSSWALK MARKING, PAINT
U.S. ROUTE 7:
STA 31+57.44 LT, STRONGS AVENUE

646.712 TEMPORARY RAILROAD CROSSING SYMBOL, PAINT
U.S. ROUTE 7:
STA 30+13.00 LT (4 EA)

675.50 REMOVING SIGNS
AS SHOWN - 7

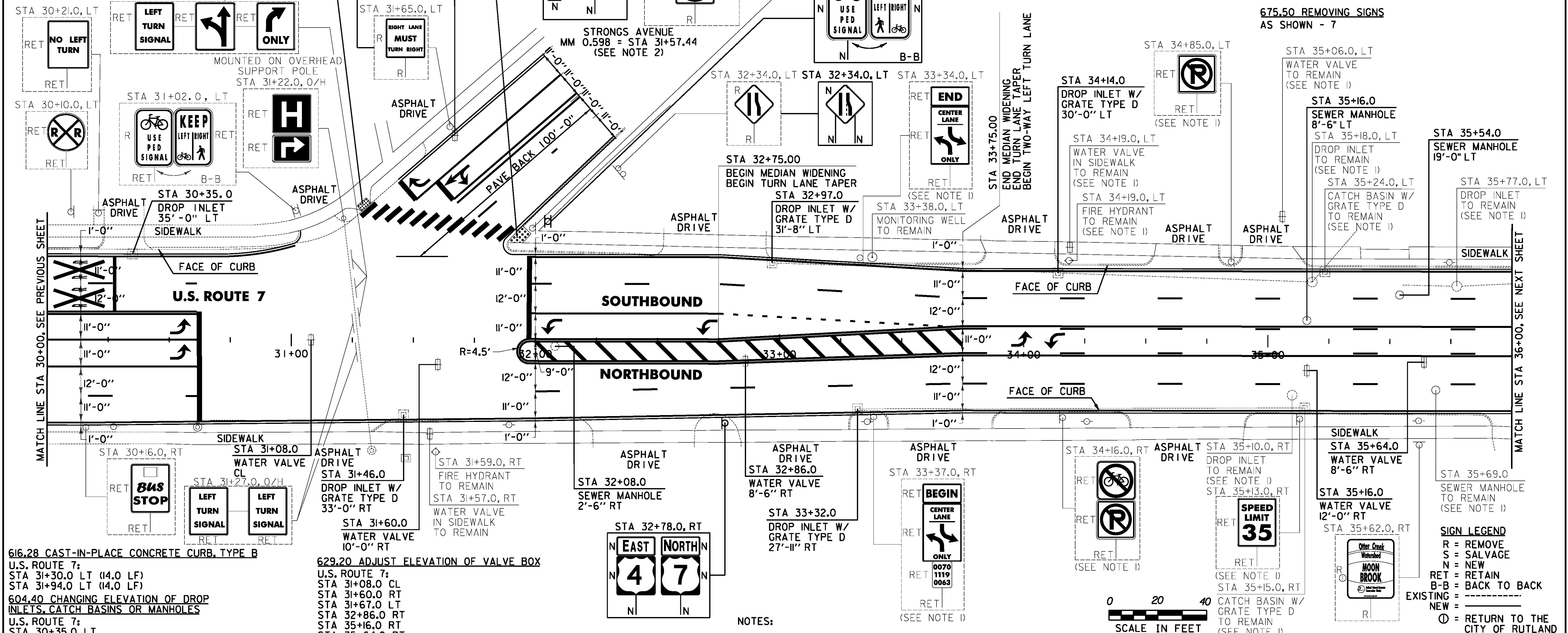

616.28 CAST-IN-PLACE CONCRETE CURB, TYPE B
U.S. ROUTE 7:
STA 31+30.0 LT (4.0 LF)
STA 31+94.0 LT (4.0 LF)

604.40 CHANGING ELEVATION OF DROP INLETS, CATCH BASINS OR MANHOLES
U.S. ROUTE 7:
STA 30+35.0 LT
STA 31+46.0 RT
STA 32+97.0 LT
STA 33+32.0 RT
STA 34+14.0 LT

604.42 CHANGING ELEVATION OF SEWER MANHOLES
U.S. ROUTE 7:
STA 32+08.0 RT
STA 35+16.0 LT
STA 35+54.0 LT

629.20 ADJUST ELEVATION OF VALVE BOX
U.S. ROUTE 7:
STA 31+08.0 CL
STA 31+60.0 RT
STA 31+67.0 LT
STA 32+86.0 RT
STA 35+16.0 RT
STA 35+64.0 RT

618.30 DETECTABLE WARNING SURFACE
U.S. ROUTE 7:
STA 31+30.0 LT (10.0 SF)
STA 31+94.0 LT (10.0 SF)

618.10 PORTLAND CEMENT CONCRETE SIDEWALK, 5 INCH
U.S. ROUTE 7:
STA 31+30.0 LT (10.6 SY)
STA 31+94.0 LT (10.6 SY)

- NOTES:
- INSTALLED OR ADJUSTED UNDER STP 019-3(57) PRIOR TO CONSTRUCTION.
 - SEE SHEET 158 FOR STRONGS AVENUE STRIPING DETAILS.
 - COLD PLANING AND PAVING LIMIT ON ALL CITY STREETS SHALL BE MEASURED 25 FT BACK FROM U.S. ROUTE 7 FACE OF CURB UNLESS DENOTED OTHERWISE ON THE PLANS OR AS DIRECTED BY THE ENGINEER.

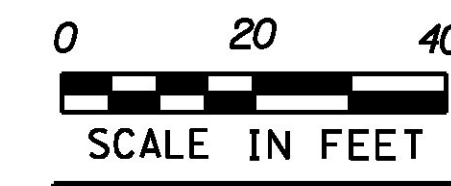

PROJECT LAYOUT SHEET #3

PROJECT NAME: RUTLAND CITY	PLOT DATE: 7/19/2013
PROJECT NUMBER: NH 2716(1)	DRAWN BY: W.G.P.
FILE NAME: p07d188.dgn	CHECKED BY: D.E.G.
DESIGNED BY: M.J.M.	SHEET 161 OF 392
IPARM FILE: 07d18803.1	

FILE NAME: I:\17765\CADD\NH\2716\07d188.dgn
 DATE/TIME: 7/19/2013 4:49:16
 USER: