

646.406 DURABLE 4 INCH WHITE LINE, RECESSED POLYUREA
 (ALL LINES WILL INCLUDE EDGE LINE BREAKS AND RADIUS FOR TOWN HIGHWAYS)
 PROCTOR:
 STA 107+75.00 - STA 113+75.00 EDGE LINE LT & RT
 STA 107+75.00 - STA 108+43.00 SIDEWALK DESIGNATION LINE LT
 STA 107+75.00 - STA 108+43.00 SIDEWALK DESIGNATION LINE RT
 STA 109+54.00 - STA 110+79.00 SIDEWALK DESIGNATION LINE LT
 STA 109+54.00 - STA 110+79.00 SIDEWALK DESIGNATION LINE RT

646.416 DURABLE 4 INCH YELLOW LINE, RECESSED POLYUREA
 (ALL LINES WILL INCLUDE C/L BREAKS FOR TOWN HIGHWAYS) S=SOLID, D=DASHED
 PROCTOR:
 STA 107+75.00 - STA 113+75.00 LT S - S
 STA 109+61.28 DOUBLE SOLID RT, TH-43 S - S

646.487 DURABLE 24 INCH STOP BAR, RECESSED TYPE ITAPE
 PROCTOR:
 STA 109+61.28 RT, TH-43

646.491 DURABLE LETTER OR SYMBOL, TYPE ITAPE
 PROCTOR:
 STA 109+61.28 RT, TH-43 "S,T,O,P" (4 EA)

646.501 DURABLE CROSSWALK MARKING, TYPE ITAPE
 PROCTOR:
 STA 109+39.00 LT & RT

646.602 TEMPORARY 4 INCH WHITE LINE, PAINT
 (ALL LINES WILL INCLUDE EDGE LINE BREAKS AND RADIUS FOR TOWN HIGHWAYS)
 PROCTOR:
 STA 107+75.00 - STA 113+75.00 EDGE LINE LT & RT
 STA 107+75.00 - STA 108+43.00 SIDEWALK DESIGNATION LINE LT
 STA 107+75.00 - STA 108+43.00 SIDEWALK DESIGNATION LINE RT
 STA 109+54.00 - STA 110+79.00 SIDEWALK DESIGNATION LINE LT
 STA 109+54.00 - STA 110+79.00 SIDEWALK DESIGNATION LINE RT

646.612 TEMPORARY 4 INCH YELLOW LINE, PAINT
 (ALL LINES WILL INCLUDE C/L BREAKS FOR TOWN HIGHWAYS) S=SOLID, D=DASHED
 PROCTOR:
 STA 107+75.00 - STA 113+75.00 LT S - S
 STA 109+61.28 DOUBLE SOLID RT, TH-43 S - S

646.682 TEMPORARY 24 INCH STOP BAR, PAINT
 PROCTOR:
 STA 109+61.28 RT, TH-43

646.692 TEMPORARY LETTER OR SYMBOL, PAINT
 PROCTOR:
 STA 109+61.28 RT, TH-43 "S,T,O,P" (8 EA)

646.702 TEMPORARY CROSSWALK MARKING, PAINT
 PROCTOR:
 STA 109+39.00 LT & RT

675.50 REMOVING SIGNS
 AS SHOWN - 4

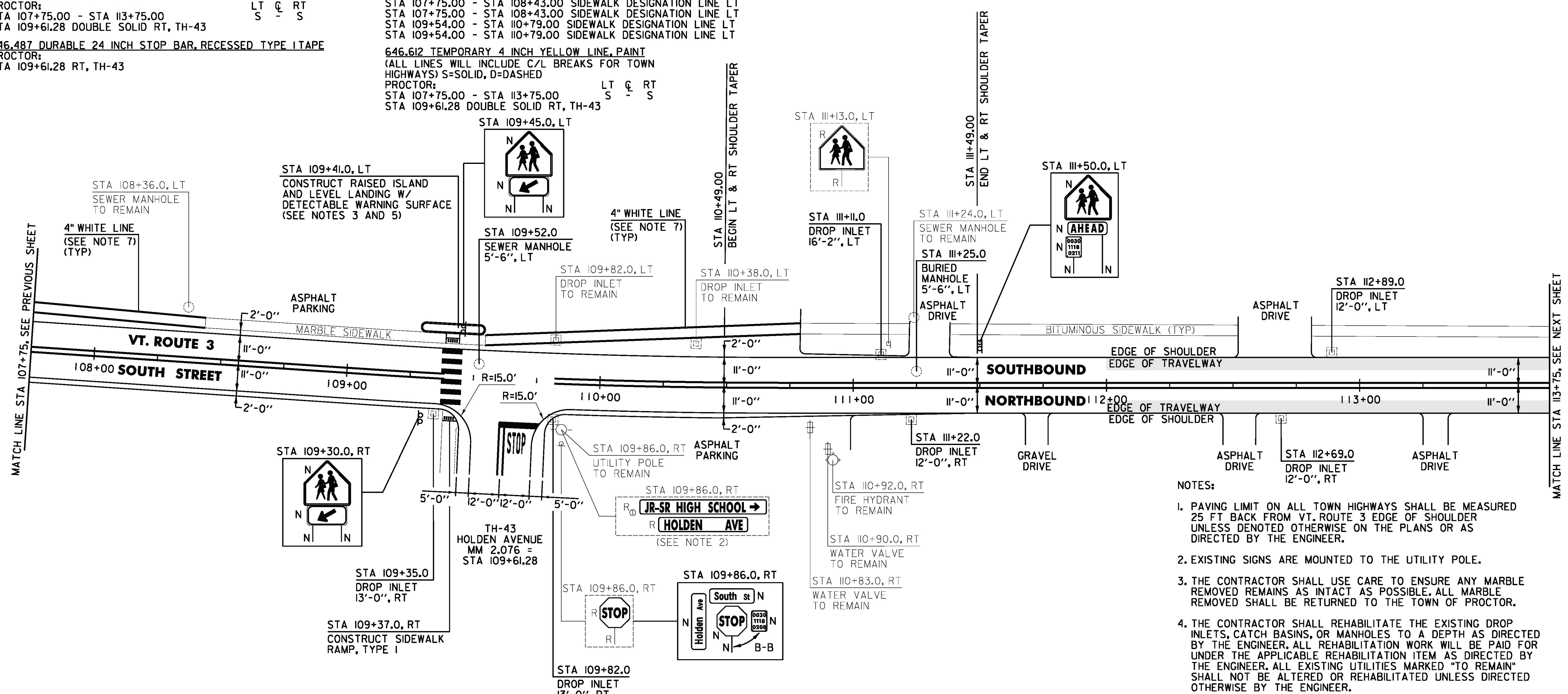
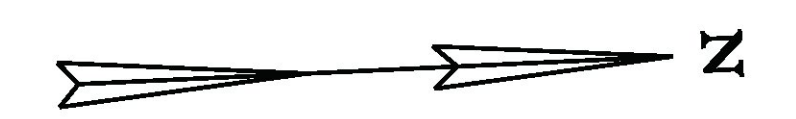

- NOTES:
1. PAVING LIMIT ON ALL TOWN HIGHWAYS SHALL BE MEASURED 25 FT BACK FROM VT. ROUTE 3 EDGE OF SHOULDER UNLESS DENOTED OTHERWISE ON THE PLANS OR AS DIRECTED BY THE ENGINEER.
 2. EXISTING SIGNS ARE MOUNTED TO THE UTILITY POLE.
 3. THE CONTRACTOR SHALL USE CARE TO ENSURE ANY MARBLE REMOVED REMAINS AS INTACT AS POSSIBLE. ALL MARBLE REMOVED SHALL BE RETURNED TO THE TOWN OF PROCTOR.
 4. THE CONTRACTOR SHALL REHABILITATE THE EXISTING DROP INLETS, CATCH BASINS, OR MANHOLES TO A DEPTH AS DIRECTED BY THE ENGINEER. ALL REHABILITATION WORK WILL BE PAID FOR UNDER THE APPLICABLE REHABILITATION ITEM AS DIRECTED BY THE ENGINEER. ALL EXISTING UTILITIES MARKED "TO REMAIN" SHALL NOT BE ALTERED OR REHABILITATED UNLESS DIRECTED OTHERWISE BY THE ENGINEER.
 5. SEE SHEET 45 FOR RAISED ISLAND DETAIL.
 6. SEE SHEET 31 FOR PAVEMENT REPAIR DETAIL.
 7. THE CONTRACTOR SHALL PROVIDE 4" WHITE LINES TO CONNECT THE SIDEWALKS ACROSS THE PARKING LOT AND SEPARATE THE PARKING LOT AND THE PEDESTRIAN WALKWAY.

604.412, 604.415 OR 604.418 REHAB. DROP INLETS, CATCH BASINS OR MANHOLES (SEE NOTE 4)

PROCTOR:
 STA 109+35.0 RT
 STA 109+82.0 RT
 STA 111+11.0 LT
 STA 111+22.0 RT
 STA 112+69.0 RT
 STA 112+89.0 LT

604.42 CHANGING ELEVATIONS OF SEWER MANHOLES

PROCTOR:
 STA 109+52.0 LT
 STA 111+25.0 LT

616.28 CAST-IN-PLACE CONCRETE CURB, TYPE B

PROCTOR:
 STA 109+41.0 LT (55.0 LF)

616.40 REMOVING AND RESETTING CURB

PROCTOR:
 STA 109+37.0 RT (14.0 LF)

618.10 PORTLAND CEMENT CONCRETE SIDEWALK, 5 INCH

PROCTOR:
 STA 109+37.0 RT (6.7 SY)
 STA 109+41.0 LT (2.8 SY)

618.30 DETECTABLE WARNING SURFACE

PROCTOR:
 STA 109+37.0 RT (10.0 SF)
 STA 109+41.0 LT (10.0 SF)

SIGN LEGEND
 R = REMOVE
 S = SALVAGE
 N = NEW
 RET = RETAIN
 B-B = BACK TO BACK
 EXISTING = -----
 NEW = _____
 ⊕ = RETURN TO THE TOWN OF PROCTOR

NOT TO SCALE

PROJECT LAYOUT SHEET #23	PROJECT NAME: RUTLAND CITY - PROCTOR
	PROJECT NUMBER: STP 2728(I)
	FILE NAME: p07d282.dgn
	PLOT DATE: 7/19/2013
	DRAWN BY: W.G.P.
	CHECKED BY: J.P.S.
	IPARM FILE: p07d282i23.i
	SHEET 68 OF 392

FILE NAME: U:\17653\CAD\DWG\STP 2728\p07d282.dwg - rml_23.dwg
 DATE/TIME: 7/19/2013 4:16
 USER: