

646.406 DURABLE 4 INCH WHITE LINE, RECESSED POLYUREA
 (ALL LINES WILL INCLUDE EDGE LINE BREAKS AND RADIUS FOR TOWN HIGHWAYS)
 U.S. BR 4:
 STA 41+50.00 - STA 47+50.00 EDGE LINE LT & RT
 STA 46+50.00 - STA 47+50.00 DOTTED LANE LINE RT

646.416 DURABLE 4 INCH YELLOW LINE, RECESSED POLYUREA
 (ALL LINES WILL INCLUDE C/L BREAKS FOR TOWN HIGHWAYS) S=SOLID, D=DASHED
 U.S. BR 4:
 STA 46+50.00 - STA 47+50.00 LT C RT
 STA 41+50.00 - STA 46+50.00 S - S
 STA 41+50.00 - STA 46+50.00 SOLID/DASH TURN LANE LINES LT/RT

646.602 TEMPORARY 4 INCH WHITE LINE, PAINT
 (ALL LINES WILL INCLUDE EDGE LINE BREAKS AND RADIUS FOR TOWN HIGHWAYS)
 U.S. BR 4:
 STA 41+50.00 - STA 47+50.00 EDGE LINE LT & RT
 STA 46+50.00 - STA 47+50.00 DOTTED LANE LINE RT

646.612 TEMPORARY 4 INCH YELLOW LINE, PAINT
 (ALL LINES WILL INCLUDE C/L BREAKS FOR TOWN HIGHWAYS) S=SOLID, D=DASHED
 U.S. BR 4:
 STA 46+50.00 - STA 47+50.00 LT C RT
 STA 41+50.00 - STA 46+50.00 S - S
 STA 41+50.00 - STA 46+50.00 SOLID/DASH TURN LANE LINES LT/RT

646.446 DURABLE 8 INCH WHITE LINE, RECESSED POLYUREA
 U.S. BR 4:
 STA 42+08.00 - STA 42+20.00 RT, NO PARKING, FIRE HYDRANT
 646.491 DURABLE LETTER OR SYMBOL, TYPE I TAPE
 U.S. BR 4:
 STA 41+68.30 C/L ARROW (1 EA)
 STA 41+81.80 C/L ARROW (1 EA)
 STA 43+90.30 C/L ARROW (1 EA)
 STA 44+03.80 C/L ARROW (1 EA)
 STA 46+12.30 C/L ARROW (1 EA)
 STA 46+25.80 C/L ARROW (1 EA)

646.692 TEMPORARY LETTER OR SYMBOL, PAINT
 U.S. BR 4:
 STA 41+68.30 C/L ARROW (2 EA)
 STA 41+81.80 C/L ARROW (2 EA)
 STA 43+90.30 C/L ARROW (2 EA)
 STA 44+03.80 C/L ARROW (2 EA)
 STA 46+12.30 C/L ARROW (2 EA)
 STA 46+25.80 C/L ARROW (2 EA)

675.50 REMOVING SIGNS AS SHOWN - 7

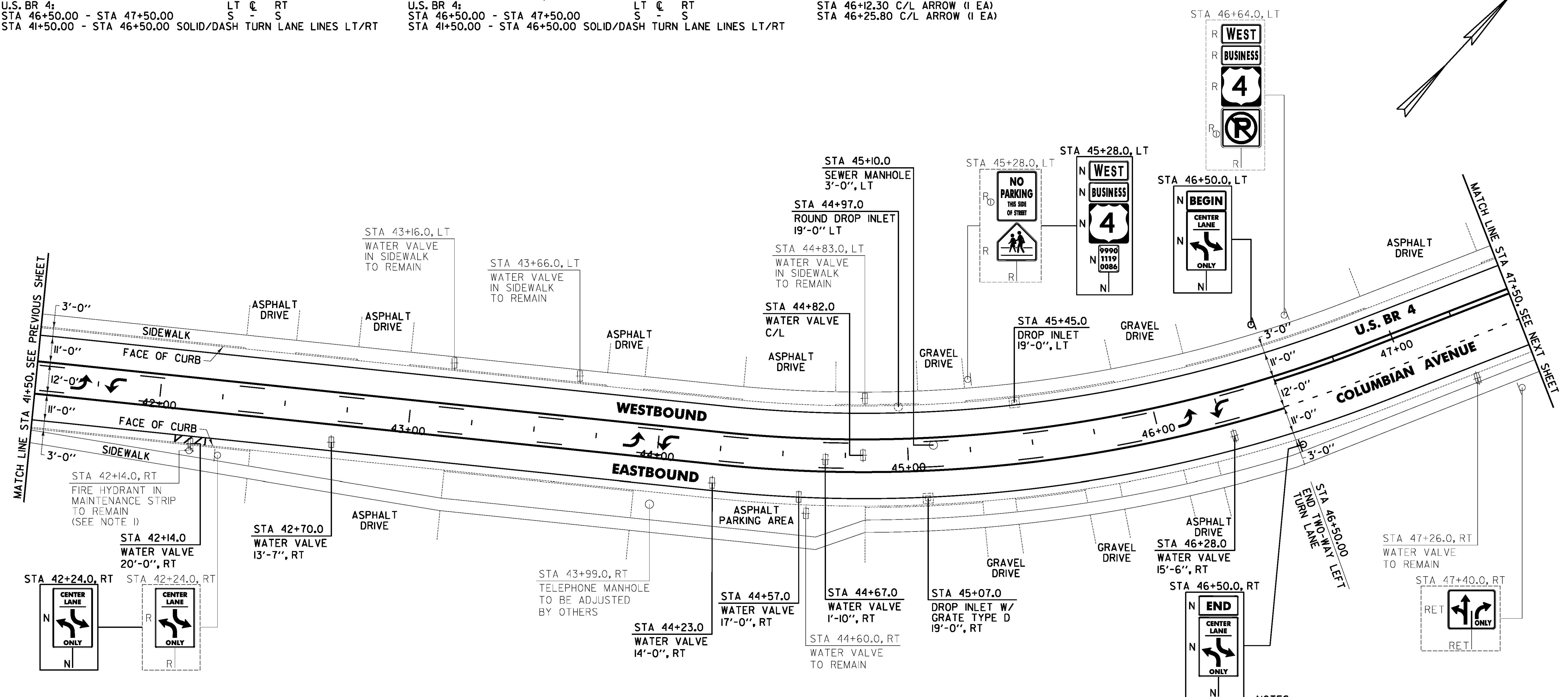

NOTES:
 1. SEE SHEET 44 FOR FIRE HYDRANT PAVEMENT MARKING DETAIL.
 2. THE CONTRACTOR SHALL REHABILITATE THE EXISTING DROP INLETS, CATCH BASINS OR MANHOLES TO A DEPTH AS DIRECTED BY THE ENGINEER. ALL REHABILITATION WORK WILL BE PAID FOR UNDER THE APPLICABLE REHABILITATION ITEM AS DIRECTED BY THE ENGINEER. ALL EXISTING UTILITIES MARKED "TO REMAIN" SHALL NOT BE ALTERED OR REHABILITATED UNLESS DIRECTED OTHERWISE BY THE ENGINEER.

604.412, 604.415, 604.418 REHAB. DROP INLETS, CATCH BASINS, OR MANHOLES, CLASS I, II, III (SEE NOTE 2)
 U.S. BR 4:
 STA 44+97.0 LT
 STA 45+07.0 RT
 STA 45+45.0 LT

604.42 CHANGING ELEVATION OF SEWER MANHOLE
 U.S. BR 4:
 STA 45+10.0 LT

629.20 ADJUST ELEVATION OF VALVE BOX
 U.S. BR 4:
 STA 42+14.0 RT
 STA 42+70.0 RT
 STA 44+23.0 RT
 STA 44+57.0 RT
 STA 44+67.0 RT
 STA 44+82.0 C/L
 STA 46+28.0 RT

SIGN LEGEND
 R = REMOVE
 S = SALVAGE
 N = NEW
 RET = RETAIN
 B-B = BACK TO BACK
 EXISTING = -----
 NEW = _____
 ⊕ = RETURN TO THE CITY OF RUTLAND

PROJECT LAYOUT SHEET #8	PROJECT NAME: RUTLAND CITY - PROCTOR
	PROJECT NUMBER: STP 2728(1)
	FILE NAME: p07d282.dgn
	IPARM FILE: p07d282108.t
	PLOT DATE: 7/19/2013
	DRAWN BY: W.G.P.
	CHECKED BY: J.P.S.
	SHEET 53 OF 392

FILE NAME: U:\17525\CAD\DWG\STP 2728\p07d282.dwg - rml_88.dgn
 DATE/TIME: 7/19/2013 4:49:16
 USER: