

646.406 DURABLE 4 INCH WHITE LINE, RECESSED POLYUREA
(ALL LINES WILL INCLUDE EDGE LINE BREAKS AND RADIUS FOR TOWN HIGHWAYS)
U.S. BR 4:
STA 29+50.00 - STA 35+50.00 EDGE LINE LT & RT
STA 29+50.00 - STA 32+90.00 SOLID LANE LINE RT
STA 32+92.00 - STA 34+05.00 DOTTED LANE LINE RT
STA 34+24.00 - STA 35+50.00 SOLID LANE LINE LT
WEST STREET:
STA W 0+73.00 - STA W 1+50.00 DOTTED LANE LINE CL
STA W 0+84.00 - STA W 1+50.00 EDGE LINE LT/RT

646.416 DURABLE 4 INCH YELLOW LINE, RECESSED POLYUREA
(ALL LINES WILL INCLUDE C/L BREAKS FOR TOWN HIGHWAYS) S=SOLID, D=DASHED
U.S. BR 4:
STA 34+25.00 - STA 35+50.00 LT C RT S - S
STA 29+50.00 - STA 32+95.00 DOUBLE SOLID MEDIUM LT/RT
STA 31+78.56 DOUBLE SOLID LT, WATKINS AVENUE

646.501 DURABLE CROSSWALK MARKING, TYPE I TAPE
U.S. BR 4:
STA 31+78.56 LT, WATKINS AVENUE

646.491 DURABLE LETTER OR SYMBOL, TYPE I TAPE
U.S. BR 4:
STA 29+51.00 RT, ARROW (1 EA)
STA 30+00.50 RT, "O,N,L,Y" (4 EA)
STA 30+56.75 RT, ARROW (1EA)
STA 31+13.00 RT, "O,N,L,Y" (4 EA)
STA 31+69.25 RT, ARROW (1EA)
STA 31+78.56 LT WATKINS AVENUE, YIELD MARKINGS (4 EA)
STA 32+25.50 RT, "O,N,L,Y" (4 EA)
STA 32+81.75 RT, ARROW (1EA)
STA 34+32.00 LT, ARROW (1EA)
STA 34+73.00 LT "O,N,L,Y" (4 EA)
STA 35+14.00 LT, ARROW (1EA)

646.692 TEMPORARY LETTER OR SYMBOL, PAINT
U.S. BR 4:
STA 29+51.00 RT, ARROW (2 EA)
STA 30+56.75 RT, ARROW (2 EA)
STA 31+69.25 RT, ARROW (2 EA)
STA 31+78.56 LT, WATKINS AVENUE, YIELD MARKINGS (8 EA)
STA 32+81.75 RT, ARROW (2 EA)
STA 34+32.00 LT, ARROW (2 EA)
STA 35+14.00 LT, ARROW (2 EA)

646.602 TEMPORARY 4 INCH WHITE LINE, PAINT
(ALL LINES WILL INCLUDE EDGE LINE BREAKS AND RADIUS FOR TOWN HIGHWAYS)
U.S. BR 4:
STA 29+50.00 - STA 35+50.00 EDGE LINE LT & RT
STA 29+50.00 - STA 32+90.00 SOLID LANE LINE RT
STA 32+92.00 - STA 34+05.00 DOTTED LANE LINE RT
STA 34+24.00 - STA 35+50.00 SOLID LANE LINE LT
WEST STREET:
STA W 0+73.00 - STA W 1+50.00 DOTTED LANE LINE CL
STA W 0+84.00 - STA W 1+50.00 EDGE LINE LT/RT

646.456 DURABLE 8 INCH YELLOW LINE, RECESSED POLYUREA
U.S. BR 4:
STA 29+50.00 - STA 31+66.00 HATCHED MEDIAN LT/ C/L
STA 32+05.00 - STA 32+95.00 HATCHED MEDIAN LT/ C/L

646.487 DURABLE 24 INCH STOP BAR RECESSED, TYPE I TAPE
U.S. BR 4:
STA 32+91.00 RT
STA 34+25.00 LT

646.682 TEMPORARY 24 INCH STOP BAR, PAINT
U.S. BR 4:
STA 32+91.00 RT
STA 34+25.00 LT

675.50 REMOVING SIGNS AS SHOWN - 17
STA 35+25.0, LT

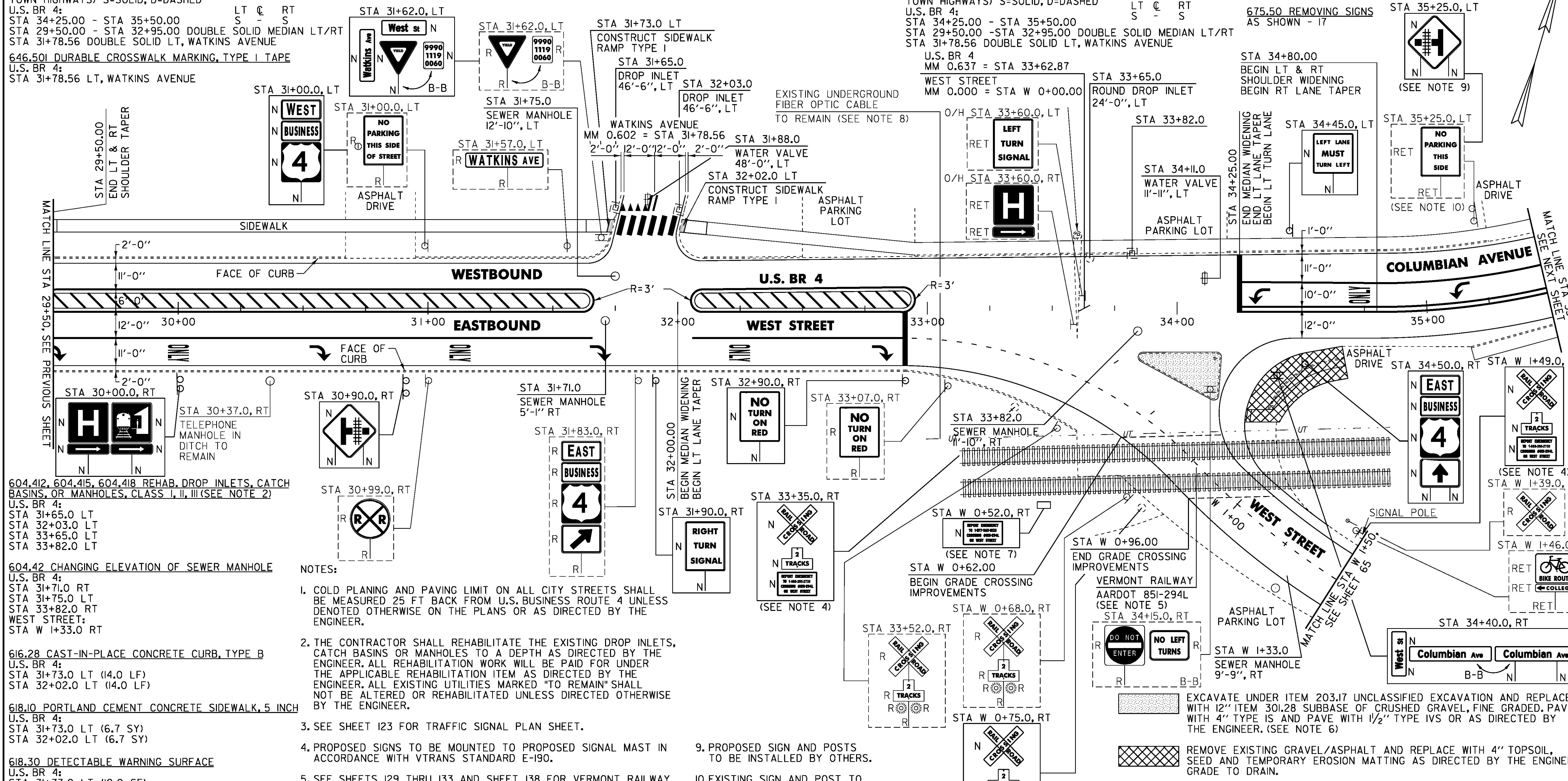

604.412, 604.415, 604.418 REHAB. DROP INLETS, CATCH BASINS, OR MANHOLES, CLASS I, II, III (SEE NOTE 2)
U.S. BR 4:
STA 31+65.0 LT
STA 32+03.0 LT
STA 33+65.0 LT
STA 33+82.0 LT

604.42 CHANGING ELEVATION OF SEWER MANHOLE
U.S. BR 4:
STA 31+71.0 RT
STA 31+75.0 LT
STA 33+82.0 RT
WEST STREET:
STA W 1+33.0 RT

616.28 CAST-IN-PLACE CONCRETE CURB, TYPE B
U.S. BR 4:
STA 31+73.0 LT (4.0 LF)
STA 32+02.0 LT (4.0 LF)

618.10 PORTLAND CEMENT CONCRETE SIDEWALK, 5 INCH
U.S. BR 4:
STA 31+73.0 LT (6.7 SY)
STA 32+02.0 LT (6.7 SY)

618.30 DETECTABLE WARNING SURFACE
U.S. BR 4:
STA 31+73.0 LT (10.0 SF)
STA 32+02.0 LT (10.0 SF)

629.20 ADJUST ELEVATION OF VALVE BOX
U.S. BR 4:
STA 31+88.0 LT
STA 34+11.0 LT

653.20 TEMPORARY EROSION MATTING
U.S. BR 4:
STA 34+27.0 - STA 34+66.0 LT (71.8 SY)

- NOTES:
1. COLD PLANING AND PAVING LIMIT ON ALL CITY STREETS SHALL BE MEASURED 25 FT BACK FROM U.S. BUSINESS ROUTE 4 UNLESS DENOTED OTHERWISE ON THE PLANS OR AS DIRECTED BY THE ENGINEER.
 2. THE CONTRACTOR SHALL REHABILITATE THE EXISTING DROP INLETS, CATCH BASINS OR MANHOLES TO A DEPTH AS DIRECTED BY THE ENGINEER. ALL REHABILITATION WORK WILL BE PAID FOR UNDER THE APPLICABLE REHABILITATION ITEM AS DIRECTED BY THE ENGINEER. ALL EXISTING UTILITIES MARKED "TO REMAIN" SHALL NOT BE ALTERED OR REHABILITATED UNLESS DIRECTED OTHERWISE BY THE ENGINEER.
 3. SEE SHEET I23 FOR TRAFFIC SIGNAL PLAN SHEET.
 4. PROPOSED SIGNS TO BE MOUNTED TO PROPOSED SIGNAL MAST IN ACCORDANCE WITH VTRANS STANDARD E-190.
 5. SEE SHEETS I29 THRU I33 AND SHEET I38 FOR VERMONT RAILWAY AARDOT 85I-294L GRADE CROSSING DETAIL SHEETS.
 6. SEE SHEET 44 FOR ISLAND REMOVAL DETAIL.
 7. PROPOSED SIGN TO BE MOUNTED TO PROPOSED RAILROAD SIGNAL CABINET.
 8. THE CONTRACTOR SHALL BE AWARE THAT AN UNDERGROUND FIBER OPTIC CABLE EXISTS AT THE WEST STREET GRADE CROSSING AT A DEPTH OF 4'-0" BELOW THE EXISTING SURFACE. IT IS THE CONTRACTOR'S RESPONSIBILITY TO LOCATE AND PROTECT THIS CABLE THROUGHOUT CONSTRUCTION.
 9. PROPOSED SIGN AND POSTS TO BE INSTALLED BY OTHERS.
 10. EXISTING SIGN AND POST TO BE REMOVED BY OTHERS.

SIGN LEGEND
R = REMOVE
S = SALVAGE
N = NEW
RET = RETAIN
B-B = BACK TO BACK
EXISTING = - - - - -
NEW = _____
⊙ = RETURN TO THE CITY OF RUTLAND

NOT TO SCALE

PROJECT LAYOUT SHEET #6

PROJECT NAME: RUTLAND CITY - PROCTOR	FILE NAME: p07d282.dgn	PLOT DATE: 13-AUG-2013
PROJECT NUMBER: STP 2728(1)	PROJECT LEADER: D.E.G.	DRAWN BY: W.G.P.
	DESIGNED BY: L.M.B.	CHECKED BY: J.P.S.
	IPARM FILE: p07d282106.t	SHEET 51 OF 392