

646.406 DURABLE 4 INCH WHITE LINE, RECESSED POLYUREA
 (ALL LINES WILL INCLUDE EDGE LINE BREAKS AND
 RADIUS FOR TOWN HIGHWAYS)
 U.S. BR 4:
 STA 17+50.00 - STA 23+50.00 EDGE LINE LT & RT

646.416 DURABLE 4 INCH YELLOW LINE, RECESSED POLYUREA
 (ALL LINES WILL INCLUDE C/L BREAKS FOR
 TOWN HIGHWAYS) S=SOLID, D=DASHED
 U.S. BR 4:
 STA 17+50.00 - STA 23+50.00 SOLID/DASH TURN LANE LINES LT/RT

646.602 TEMPORARY 4 INCH WHITE LINE, PAINT
 (ALL LINES WILL INCLUDE EDGE LINE BREAKS AND
 RADIUS FOR TOWN HIGHWAYS)
 U.S. BR 4:
 STA 17+50.00 - STA 23+50.00 EDGE LINE LT & RT

646.612 TEMPORARY 4 INCH YELLOW LINE, PAINT
 (ALL LINES WILL INCLUDE C/L BREAKS FOR
 TOWN HIGHWAYS) S=SOLID, D=DASHED
 U.S. BR 4:
 STA 17+50.00 - STA 23+50.00 SOLID/DASH TURN LANE LINES LT/RT

646.446 DURABLE 8 INCH WHITE LINE, RECESSED POLYUREA
 U.S. BR 4:
 STA 21+91.00 - STA 22+03.00 LT FIRE HYDRANT, NO PARKING

646.491 DURABLE LETTER OR SYMBOL, TYPE ITAPE
 U.S. BR 4:
 STA 17+70.30 C/L ARROW (1 EA)
 STA 17+83.80 C/L ARROW (1 EA)
 STA 19+92.30 C/L ARROW (1 EA)
 STA 20+05.80 C/L ARROW (1 EA)
 STA 22+14.30 C/L ARROW (1 EA)
 STA 22+27.80 C/L ARROW (1 EA)

646.692 TEMPORARY LETTER OR SYMBOL, PAINT
 U.S. BR 4:
 STA 17+70.30 C/L ARROW (2 EA)
 STA 17+83.80 C/L ARROW (2 EA)
 STA 19+92.30 C/L ARROW (2 EA)
 STA 20+05.80 C/L ARROW (2 EA)
 STA 22+14.30 C/L ARROW (2 EA)
 STA 22+27.80 C/L ARROW (2 EA)

675.50 REMOVING SIGNS
 AS SHOWN-3

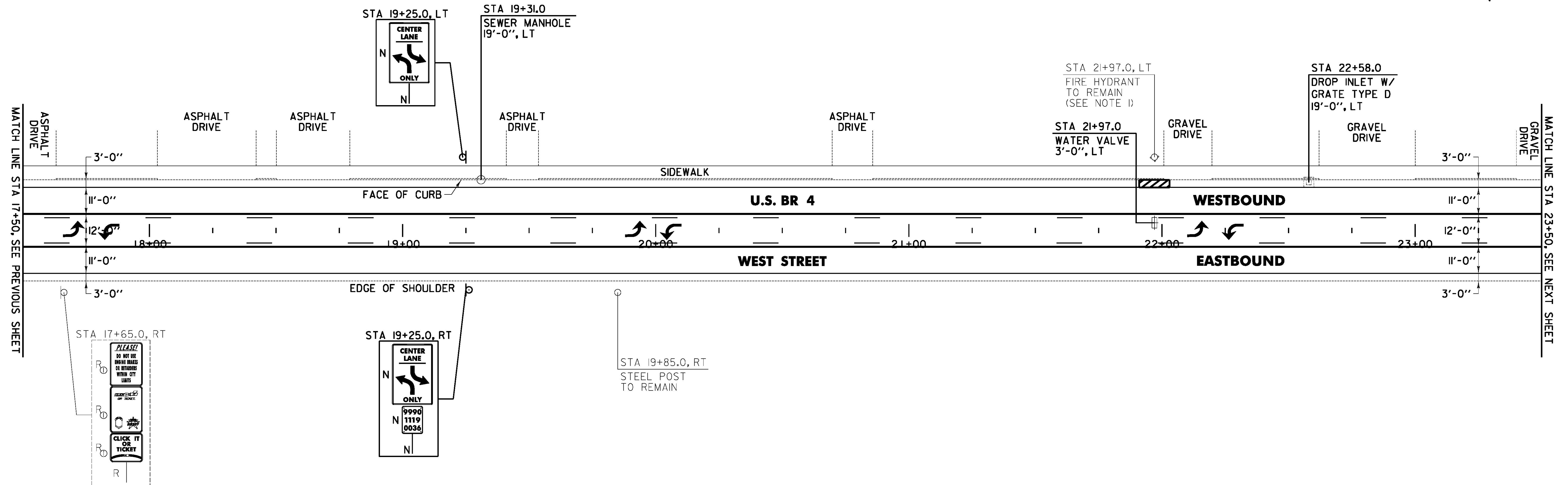
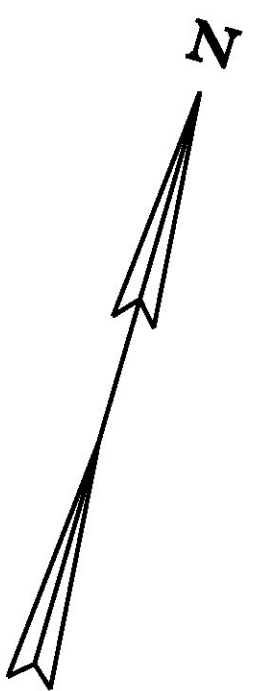

NOTES:

- SEE SHEET 44 FOR FIRE HYDRANT PAVEMENT MARKING DETAIL.
- THE CONTRACTOR SHALL REHABILITATE THE EXISTING DROP INLETS, CATCH BASINS OR MANHOLES TO A DEPTH AS DIRECTED BY THE ENGINEER. ALL REHABILITATION WORK WILL BE PAID FOR UNDER THE APPLICABLE REHABILITATION ITEM AS DIRECTED BY THE ENGINEER. ALL EXISTING UTILITIES MARKED "TO REMAIN" SHALL NOT BE ALTERED OR REHABILITATED UNLESS DIRECTED OTHERWISE BY THE ENGINEER.

604.412, 604.415, 604.418 REHAB. DROP INLETS, CATCH
 BASINS OR MANHOLES, CLASS I, II, III (SEE NOTE 2)
 U.S. BR 4:
 STA 22+58.0 LT

604.42 CHANGING ELEVATION OF SEWER MANHOLE
 U.S. BR 4:
 STA 19+31.0 LT

629.20 ADJUST ELEVATION OF VALVE BOX
 U.S. BR 4:
 STA 21+97.0 LT

SIGN LEGEND
 R = REMOVE
 S = SALVAGE
 N = NEW
 RET = RETAIN
 B-B = BACK TO BACK
 EXISTING = -----
 NEW = _____
 Ⓞ = RETURN TO THE
 CITY OF RUTLAND

NOT TO SCALE

PROJECT LAYOUT SHEET #4	PROJECT NAME: RUTLAND CITY - PROCTOR
	PROJECT NUMBER: STP 2728(1)
	FILE NAME: p07d282.dgn PROJECT LEADER: D.E.G. DESIGNED BY: L.M.B. IPARM FILE: p07d282104.t
	PLOT DATE: 7/19/2013 DRAWN BY: W.G.P. CHECKED BY: J.P.S. SHEET 49 OF 392

FILE NAME: U:\177523\ACAD\DWG\STP 2728\p07d282.dwg - rml_04.dgn
 DATE/TIME: 7/19/2013 4:49:16
 USER: