

SPECIAL PROVISION (DRY HYDRANT)

STA. 61+34.00 - 62+04.92 LT

DELINEATOR WITH STEEL POST (TYPE I)

STA. 59+84 LT (GREEN)  
STA. 59+81 RT (BLUE)

REMOVAL AND DISPOSAL OF GUARDRAIL

STA. 60+43.09 - 60+84.28 RT  
STA. 59+22.82 - 60+85.48 LT  
STA. 61+50.29 - 63+37.35 RT  
STA. 61+49.41 - 62+25.00 LT

HEAVY DUTY STEEL BEAM GUARDRAIL, GALVANIZED

STA. 59+69.40 - 60+58.90 LT  
STA. 59+61.67 - 60+57.17 RT  
STA. 62+09.73 - 62+25.00 LT  
STA. 62+10.04 - 62+25.00 RT

ANCHORS FOR HEAVY DUTY STEEL BEAM GUARDRAIL

STA. 59+78.90 LT  
STA. 59+75.00 RT

CONSTRUCT DRIVE

STA. 57+58 LT, 19' - GRAVEL  
STA. 58+11 LT, 14' - GRAVEL  
STA. 57+97 RT, 12' - GRAVEL

REMOVAL OF EXISTING FENCE

STA. 58+50 - STA. 61+00 RT  
STA. 59+00 - STA. 60+00 LT  
STA. 62+15 - STA. 62+20 LT

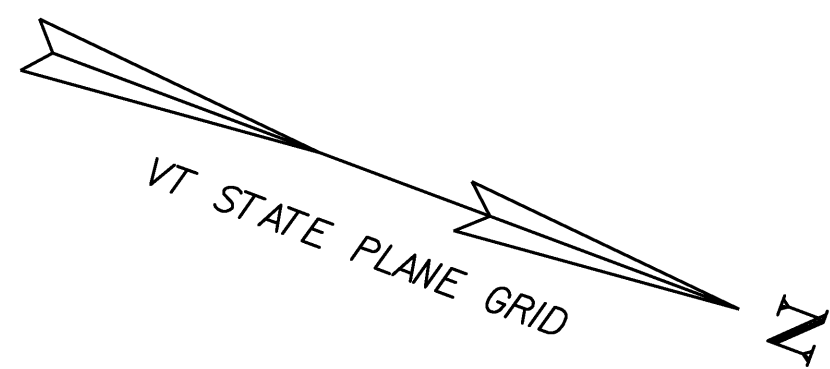

4" YELLOW LINE (DOUBLE)

STA. 57+50 - 62+25

4" WHITE LINE

STA. 57+50 - 62+25 LT  
STA. 57+50 - 62+25 RT

**RICHARDS, DENNIS B. & LISA G.**

**BEGIN R.O.W. PROJECT  
ER ST 0271(16)  
STA. 56+21.00  
33.44 RT.**

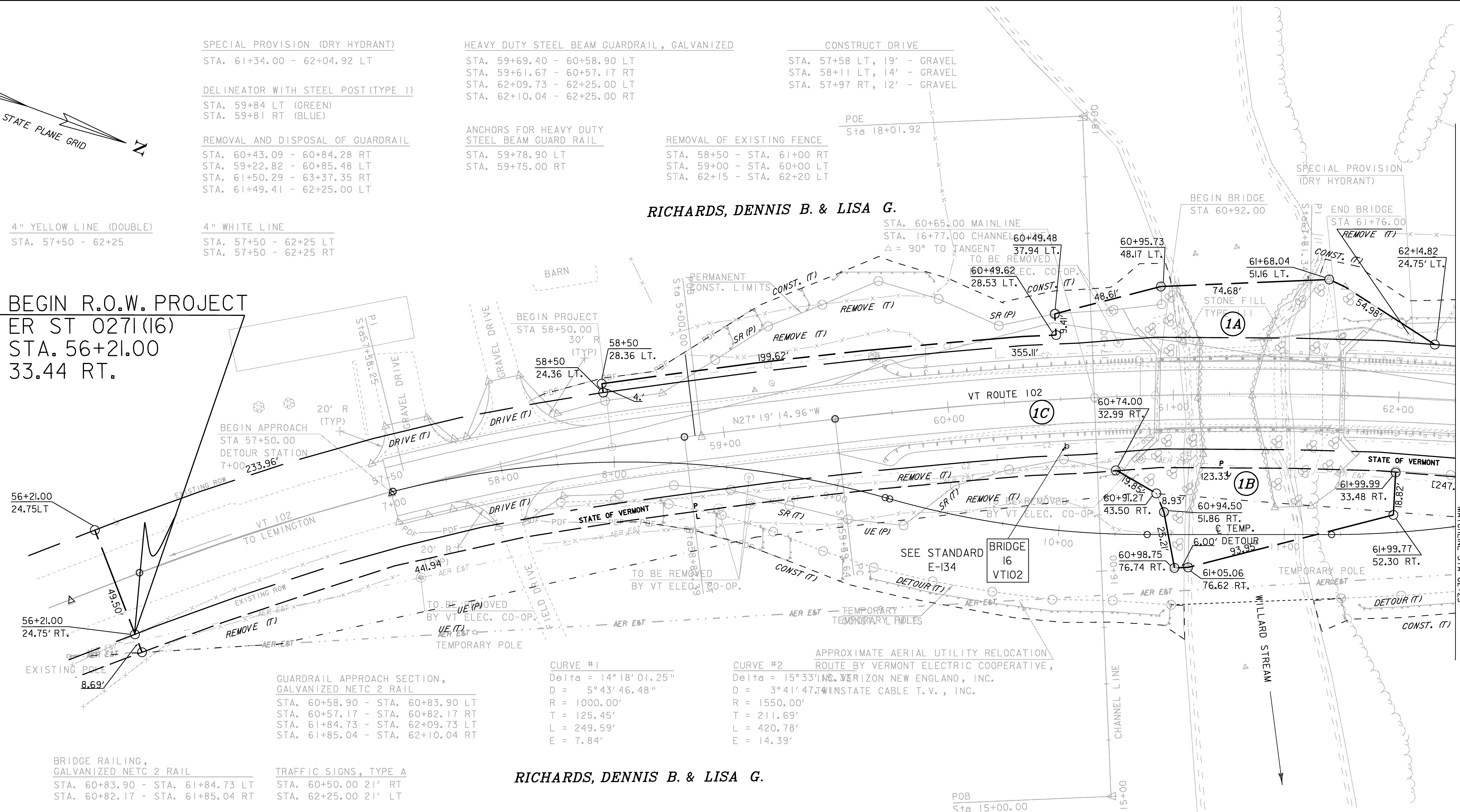

GUARDRAIL APPROACH SECTION, GALVANIZED NETC 2 RAIL  
STA. 60+58.90 - STA. 60+83.90 LT  
STA. 60+57.17 - STA. 60+82.17 RT  
STA. 61+84.73 - STA. 62+09.73 LT  
STA. 61+85.04 - STA. 62+10.04 RT

CURVE #1  
Delta = 14°18'01.25"  
D = 5°43'46.48"  
R = 1000.00'  
T = 125.45'  
L = 249.59'  
E = 7.84'

CURVE #2  
Delta = 15°33'15.00"  
D = 3°41'47.00"  
R = 1550.00'  
T = 211.69'  
L = 420.78'  
E = 14.39'

BRIDGE RAILING, GALVANIZED NETC 2 RAIL  
STA. 60+83.90 - STA. 61+84.73 LT  
STA. 60+82.17 - STA. 61+85.04 RT

TRAFFIC SIGNS, TYPE A  
STA. 60+50.00 21' RT  
STA. 62+25.00 21' LT

**RICHARDS, DENNIS B. & LISA G.**

CURRENT STRUCTURE  
WIDTH: 24  
LENGTH: 80

LINES SHOWN ON THIS PLAN AS EXISTING PROPERTY LINES P/L ARE BELIEVED TO BE ACCURATE BUT SHOULD NOT BE RELIED UPON FOR PURPOSES UNRELATED TO THE STATE OF VERMONT'S ACQUISITION OF LAND AND RIGHTS FOR THIS PROJECT.

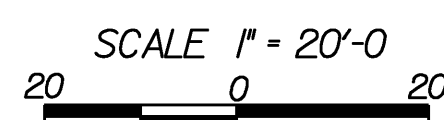

PREVIOUS BRIDGE DATA  
SINGLE SPAN OPEN BOTTOM CONCRETE ARCH - DESTROYED IN 2004 FLOOD  
CLEAR SPAN (NORMAL TO STREAM): 31 FEET MIN.  
OVERALL LENGTH: 34.5 FEET BACK TO BACK OF ABUTMENTS  
VERTICAL CLEARANCE: 7 FEET  
BRIDGE WIDTH: +/- 34.5 FEET FACE OF RAIL TO FACE OF RAIL

**ROW LAYOUT SHEET #1**

PROJECT NAME:	Canaan	PLOT DATE:	18-AUG-2008
PROJECT NUMBER:	ER ST 0271(16)	DRAWN BY:	L. DUQUETTE
FILE NAME:	04c098\struc\04c098bdr	DESIGNED BY:	S. SCRIBNER
PROJECT LEADER:	M. Evans-Mongeon	CHECKED BY:	S. SCRIBNER
ROW SHEET 14 OF 15			SHEET 9 OF 66