

MATCH LINE SHEET 5 OF 10

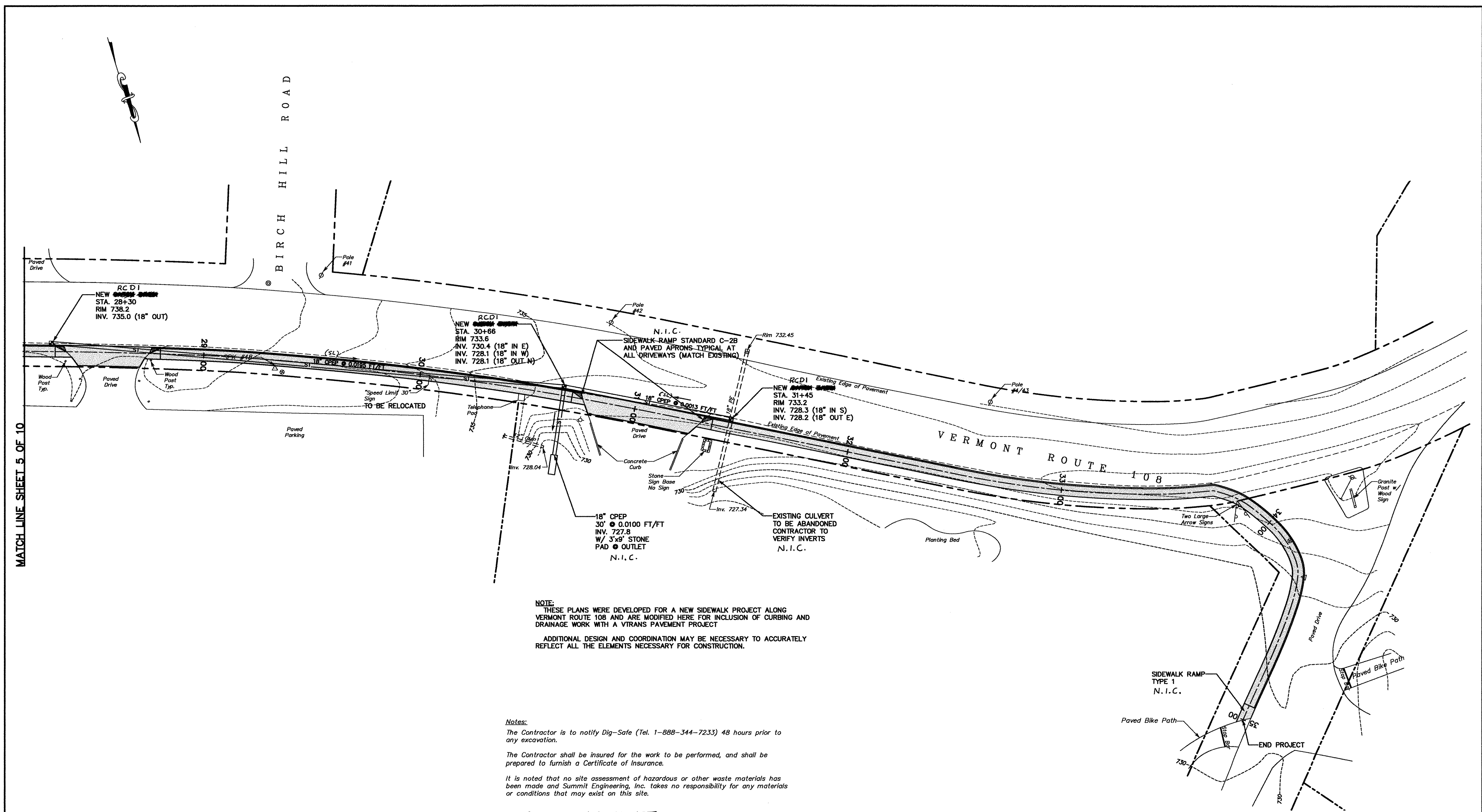

**NOTE:**  
 THESE PLANS WERE DEVELOPED FOR A NEW SIDEWALK PROJECT ALONG VERMONT ROUTE 108 AND ARE MODIFIED HERE FOR INCLUSION OF CURBING AND DRAINAGE WORK WITH A VTRANS PAVEMENT PROJECT.  
 ADDITIONAL DESIGN AND COORDINATION MAY BE NECESSARY TO ACCURATELY REFLECT ALL THE ELEMENTS NECESSARY FOR CONSTRUCTION.

**Notes:**  
 The Contractor is to notify Dig-Safe (Tel. 1-888-344-7233) 48 hours prior to any excavation.  
 The Contractor shall be insured for the work to be performed, and shall be prepared to furnish a Certificate of Insurance.  
 It is noted that no site assessment of hazardous or other waste materials has been made and Summit Engineering, Inc. takes no responsibility for any materials or conditions that may exist on this site.

N.I.C. - NOT IN CONTRACT

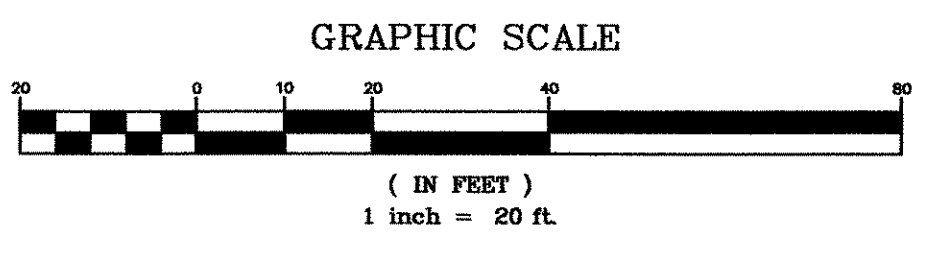

STOWE AC STP 2407(1)S SHEET 65 OF 69

SURVEY NPN/BTG DESIGNED DAW DRAWN NPN CHECKED DAW SCALE 1"=20' FILE NAME: S01000		ROUTE 108 SIDEWALK DATE 4/26/05
	<b>SUMMIT ENGINEERING, INC.</b> Engineers • Surveyors • Planners • Landscape Architects 50 Joy Drive P.O. Box 2225 South Burlington, VT 05407-2225 Bus. (802) 658-5588 Fax (802) 658-3629	TOWN OF STOWE WEEKS HILL ROAD-ROUTE 108 STOWE, VERMONT DRAWING NO. SHEET 6 OF 10 PROJECT NO. 7715