

TEMPORARY AND DURABLE 4 in YELLOW LINE  
 STA 507+00 TO 528+30 SOLID LT&RT  
 STA 528+30 TO 535+65 SOLID LT & DASHED RT  
 STA 535+65 TO 537+00 DASHED LT & SOLID RT  
 (WITH CENTERLINE BREAKS FOR TOWN HIGHWAYS)

TEMPORARY AND DURABLE 4 in WHITE LINE  
 STA 507+00 TO 537+00 SOLID LT&RT  
 (WITH EDGE LINE BREAKS FOR TOWN HIGHWAYS)

REMOVING SIGNS  
 3

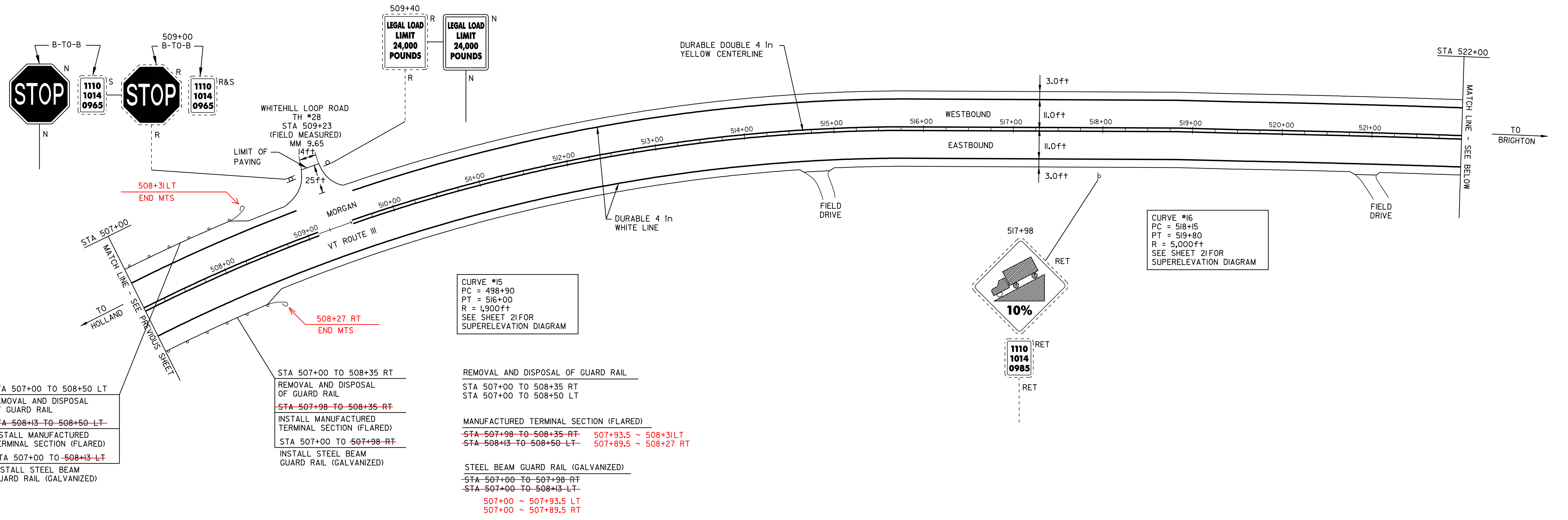

STA 507+00 TO 508+50 LT  
 REMOVAL AND DISPOSAL  
 OF GUARD RAIL  
~~STA 508+13 TO 508+50 LT~~  
 INSTALL MANUFACTURED  
 TERMINAL SECTION (FLARED)  
 STA 507+00 TO ~~508+13 LT~~  
 INSTALL STEEL BEAM  
 GUARD RAIL (GALVANIZED)

STA 507+00 TO 508+35 RT  
 REMOVAL AND DISPOSAL  
 OF GUARD RAIL  
~~STA 507+98 TO 508+35 RT~~  
 INSTALL MANUFACTURED  
 TERMINAL SECTION (FLARED)  
 STA 507+00 TO ~~507+98 RT~~  
 INSTALL STEEL BEAM  
 GUARD RAIL (GALVANIZED)

REMOVAL AND DISPOSAL OF GUARD RAIL  
 STA 507+00 TO 508+35 RT  
 STA 507+00 TO 508+50 LT

MANUFACTURED TERMINAL SECTION (FLARED)  
~~STA 507+98 TO 508+35 RT~~ 507+93.5 ~ 508+31LT  
~~STA 508+13 TO 508+50 LT~~ 507+89.5 ~ 508+27 RT

STEEL BEAM GUARD RAIL (GALVANIZED)  
~~STA 507+00 TO 507+98 RT~~  
~~STA 507+00 TO 508+13 LT~~  
 507+00 ~ 507+93.5 LT  
 507+00 ~ 507+89.5 RT

CURVE #15  
 PC = 498+90  
 PT = 516+00  
 R = 1,900ft  
 SEE SHEET 21 FOR  
 SUPERELEVATION DIAGRAM

CURVE #16  
 PC = 518+15  
 PT = 519+80  
 R = 5,000ft  
 SEE SHEET 21 FOR  
 SUPERELEVATION DIAGRAM

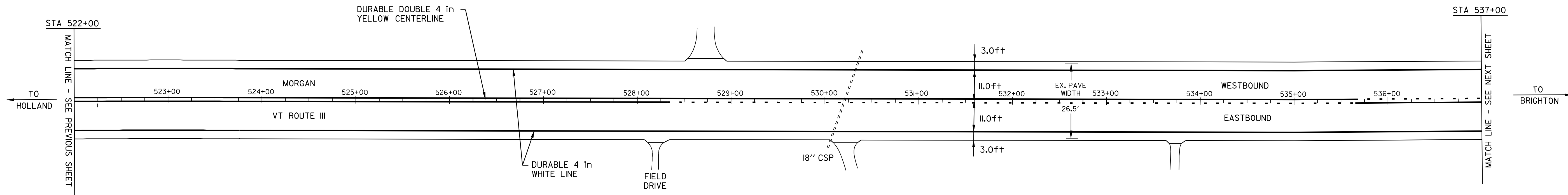

- LEGEND
- N = NEW
  - R = REMOVE
  - R&S = REMOVE & SALVAGE
  - S = SALVAGE
  - RET = RETAIN
  - B-T-O-B = BACK TO BACK
  - ⊕ ⊞ □ = CATCH BASIN/DI
  - ⊙ ⊞ = EXISTING THROAT DI
  - I = MARKER POST
  - ⊗ = UTILITY POLE
  - ⊗/I = UTIL. POLE W/UNDERGROUND UTIL.
  - ⌋ = DRIVE

## PAVING PROJECT LAYOUT SHEET #7

DESIGNED BY BCE/PJM DATE 8-05  
 DRAWN BY C.E.A., INC. DATE 8-05  
 DESIGN FILE NO. /pave/04c036/p04c036.dgn  
 PRF FILE p04c036i07.1 DATE PLOTTED II-JUN-2007 14:  
 PROJ. NAME **MORGAN - BRIGHTON**  
 PROJ. NO. **STP 2404(1)S**  
 SHEET **14** OF **26** SHEETS