

MANUFACTURED TERMINAL SECTION (MOD.)
 STA 15+40.9 - 15+90.0 RT

CONSTRUCT DRIVEWAY APRON
 STA 15+50.0 LT

BOX BEAM GUARDRAIL (MOD. - 7' POSTS & 3' POST SPACING)
 STA 13+75.0 - 15+40.9 RT

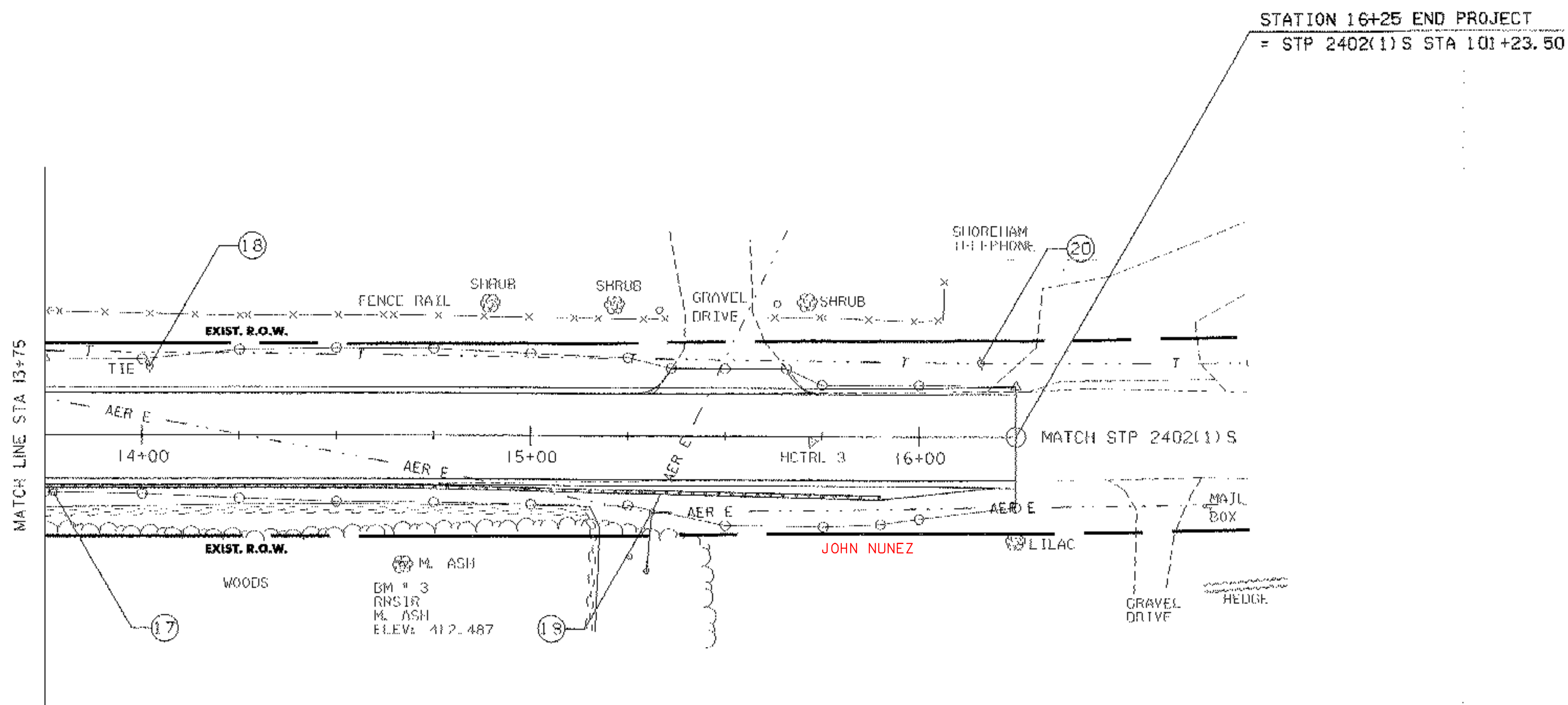

UTILITY NOTES

- ①7 STA 13+77.00 RIGHT
 EXISTING ELECTRIC POLE 226
 TO BE REMOVED
- ①8 STA 14+02.00 LEFT
 EXISTING TELEPHONE POLE 196
 TO BE REMOVED
- ①9 STA 15+31.00 RIGHT
 EXISTING ELECTRIC POLE 53 225 TO REMAIN
 EXISTING GUY WIRE TO BE REMOVED
 NEW GUY WIRE
- ②0 STA 16+16.00 LEFT
 EXISTING TELEPHONE POLE 2/8/4 TO REMAIN

THE CONTRACTOR SHOULD BE AWARE THAT EXISTING ACTIVE BURIED UTILITIES (SUCH AS PHONE CABLE, FIBER OPTIC CABLE, ETC.) ARE LOCATED ADJACENT TO VT. ROUTE 30 WITHIN THE PROJECT LIMITS NORTH OF COMBINATION POLE 226. THE CONTRACTOR IS RESPONSIBLE FOR CONTACTING "DIG SAFE" AT 1-888-344-7233 TO DETERMINE THE EXACT LOCATIONS OF THESE UTILITIES PRIOR TO PERFORMING ANY OPERATION THAT MAY DISTURB THE EXISTING SUBSURFACE CONDITIONS.

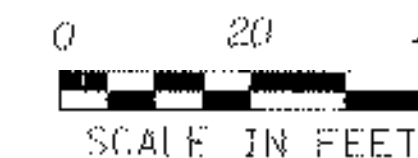

PROJECT NAME:	HUBBARDTON
PROJECT NUMBER:	ST 0161(23)
FILE NAME: PW/03c044/Design/d03c044bdr	PLOT DATE: 21-MAR-2006
PROJECT LEADER: K. UPMAL	DRAWN BY: J. DEVLIN
DESIGNED BY: J. DEVLIN	CHECKED BY: R. DELLASANTA
PLAN SHEET 4, STA 13+75 - 16+85	SHEET 66 OF 92