

VT. ROUTE 30
MM 5.182 = STA. 273+60.96
BEGIN PROJECT STP 2402(I)S

VT. ROUTE 30
MM 6.381 = STA. 336+91.68
END PROJECT STP 2402(I)S

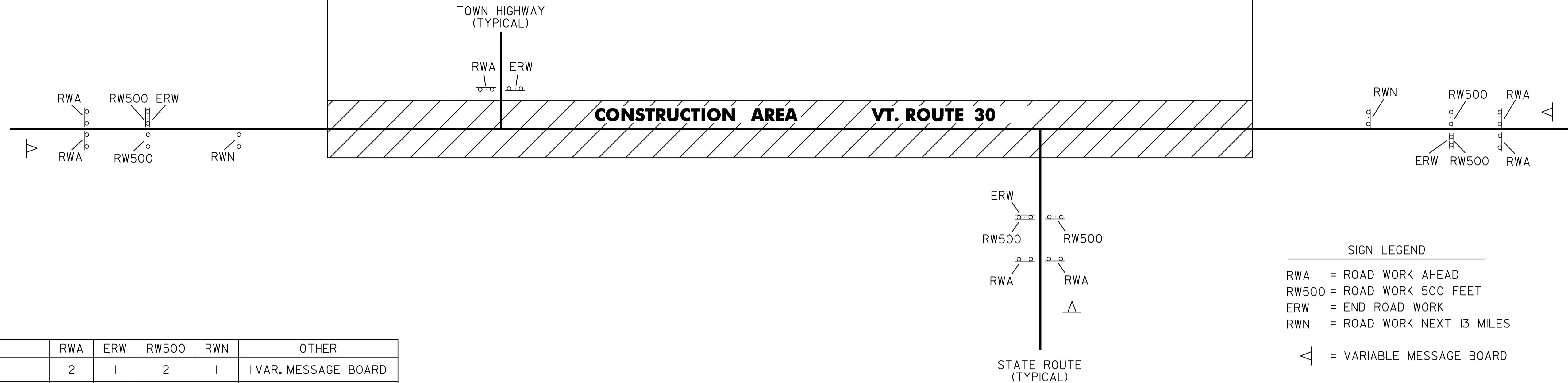

HIGHWAY NAME	RWA	ERW	RW500	RWN	OTHER
BEGIN PROJECT	2	1	2	1	1 VAR. MESSAGE BOARD
CRYSTAL MEADOWS (T-52)	1	1			
CRYSTAL MEADOWS (T-52)	1	1			
EAST CRYSTAL MEADOWS (T-51)	1	1			
NORTH ROAD (T-5)	1	1			
CRYSTAL LANE (T-23)	1	1			
FLOAT BRIDGE ROAD (T-14)	1	1			
PENCIL MILL ROAD (T-6)	1	1			
DIKEMAN ROAD (T-18)	1	1			
MONUMENT HILL ROAD (T-2)	1	1			
HORTONIA ROAD (T-1)	1	1			
GANSON HILL W (T-15)	1	1			
DELANCEY ROAD (T-10)	1	1			
CAMP ROAD (T-9)	1	1			
ST. JOHNS ROAD (T-19)	1	1			
TOWN HIGHWAY ROUTE 144 (T-2)	2	1	2		1 VAR. MESSAGE BOARD
BURR POND ROAD (T-1)	1	1			
VT. ROUTE 73	2	1	2		1 VAR. MESSAGE BOARD
QUARRY ROAD (T-12)	1	1			
HUFF POND ROAD (T-22)	1	1			
T-23	1	1			
BLACKSMITH LANE (T-24)	1	1			
T-13	1	1			
SCHOOL HOUSE ROAD (T-10)	1	1			
VT. ROUTE 73	2	1	2		1 VAR. MESSAGE BOARD
VAIL ROAD (T-8)	1	1			
END PROJECT	2	1	2	1	1 VAR. MESSAGE BOARD
TOTAL	32	27	10	2	

CONSTRUCTION APPROACH SIGNING

NOTES:

- SEE VAOT STD. E-100 FOR ADDITIONAL SIGN PLACEMENT.
- CONSTRUCTION ZONE SIGN LAYOUT SHALL BE IN ACCORDANCE WITH SECTION 6 OF THE LATEST EDITION OF THE MANUAL OF UNIFORM TRAFFIC CONTROL DEVICES (MUTCD).
- CONSTRUCTION SIGNS SHALL BE IN NEW OR LIKE NEW CONDITION PER VAOT STANDARDS.
- DIAMOND SHAPED SIGNS SHALL BE 4' X 4' WITH BLACK LEGEND ON FLUORESCENT ORANGE BACKGROUND.
- CONSTRUCTION ZONE SIGNS SHALL BE INSTALLED ON TWO POSTS EACH OR AS AN NCHRP 350 COMPLIANT SIGN/STAND SYSTEM.
- VARIABLE MESSAGE BOARDS SHALL BE PLACED AS DIRECTED BY THE RESIDENT ENGINEER.

CONSTRUCTION APPROACH SIGNING DETAIL SHEET

PROJECT NAME: CASTLETON - SUDBURY
PROJECT NUMBER: STP 2402(I)S

FILE NAME: p04c028.dgn
PROJECT LEADER: D.E.G.
DESIGNED BY: D.W.E.
IPARM FILE: p04c028cas.i

PLOT DATE: 11-JUN-2007 13:34
DRAWN BY: C.A.K.
CHECKED BY: D.E.G.
SHEET 50 OF 92