

FOR INDEX OF SHEETS, SEE SHEET 2 OF 64

RECORD PLANS

CONTRACTOR: J. HUTCHINS, INC. - RICHMOND, VT.
 RESIDENT ENGINEER: DAVID HOSKING
 CONSTRUCTION BEGAN: JULY 16, 2009
 CONSTRUCTION COMPLETE: AUGUST 4, 2010
 RECORD PLANS BY: DAVID HOSKING & CRAIG PETERC
 I HEREBY CERTIFY THAT ALL THE CONSTRUCTION REQUIRED BY THIS SET OF DRAWINGS HAS BEEN ACCOMPLISHED AS INDICATED HEREIN.
 BY: *David Hosking* RESIDENT ENGINEER
 DATE: 4/8/11 *C. Peterc*

NOTE: Any further information concerning final quantities, amounts or other details relative to this project may be found at Control Files in the electronic archives.

STATE OF VERMONT
 AGENCY OF TRANSPORTATION



BARRE TOWN
 COUNTY OF WASHINGTON
 CONSTRUCTION OF A ROUNDABOUT
 AT THE INTERSECTION OF U.S. ROUTE 302 (MINOR ARTERIAL),
 VT 110 (MAJOR COLLECTOR) AND COBBLE HILL ROAD (LOCAL ROAD)

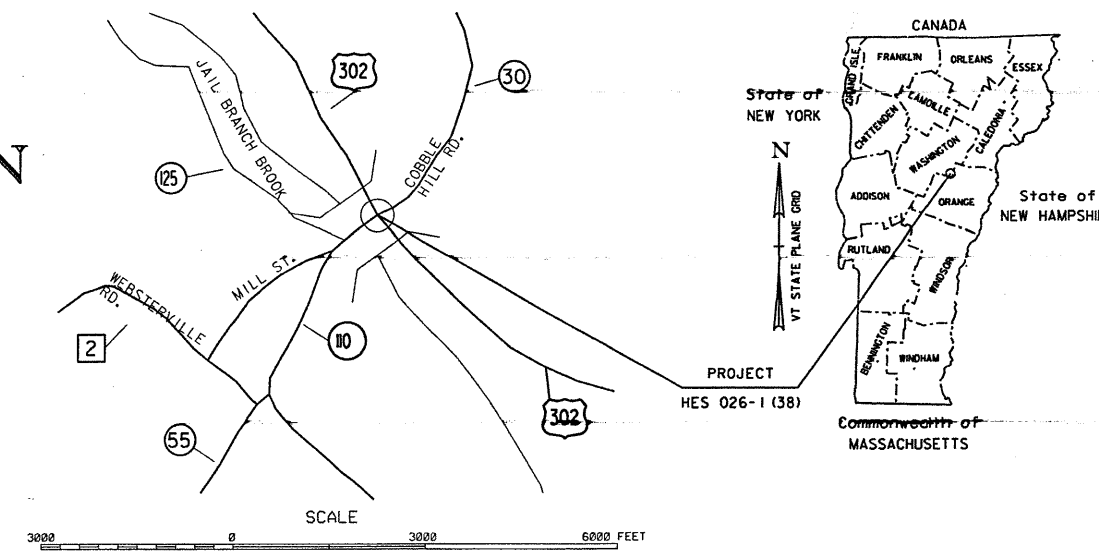

LOCATED AT THE INTERSECTION OF US ROUTE 302, VT 110 AND TH 30 (COBBLE HILL ROAD)
 EXTENDING APPROXIMATELY 291 FEET NORTHWESTERLY AND 309 FEET SOUTHEASTERLY ALONG US ROUTE 302
 AND EXTENDING APPROXIMATELY 169 FEET SOUTHWESTERLY ALONG VT 110
 AND EXTENDING APPROXIMATELY 231 FEET NORTHEASTERLY ALONG COBBLE HILL ROAD.
 THIS PROJECT CONSISTS OF THE CONSTRUCTION OF A ROUNDABOUT, MINOR REALIGNMENT OF THE APPROACHES,
 CONSTRUCTION OF NEW SIDEWALKS, NEW DRAINAGE, NEW LANDSCAPING AND NEW STREET LIGHTS,
 AND RELOCATION OF THE EXISTING PARKING AREA TO A TURNOUT ON US ROUTE 302 APPROXIMATELY 1300 FEET NORTHWEST OF SAID INTERSECTION.
 LENGTH OF US ROUTE 302: 325.00 FT. = 0.062 MILES
 LENGTH OF VT 110: 168.51 FT. = 0.032 MILES
 LENGTH OF COBBLE HILL ROAD: 93.99 FT. = 0.018 MILES
 TOTAL PROJECT LENGTH: 587.50 = 0.111 MILES

US ROUTE 302 TRAFFIC DATA

2007 ADT	= 7,150
2007 DHV	= 930
2027 ADT	= 9,125
2027 DHV	= 1,270
D	= 44%
T	= 6%
V	= 25 MPH
2007-2027 ESAL	= 3,674,000
2007-2047 ESAL	= 9,826,000

VT 110 TRAFFIC DATA

2007 ADT	= 6,400
2007 DHV	= 815
2027 ADT	= 7,400
2027 DHV	= 1,120
D	= 58%
T	= 12%
V	= 25 MPH
2007-2027 ESAL	= 1,993,000
2007-2047 ESAL	= 5,344,000

**BITUMINOUS CONCRETE PAVEMENT
 SUPER PAVE MIXTURE DESIGN CRITERIA**

DESIGN LIFE ESAL (DESIGN LANE)	3,674,000
DESIGN NUMBER OF OPERATIONS	75
PERFORMANCE GRADED ASPHALT BINDER	PG58-34

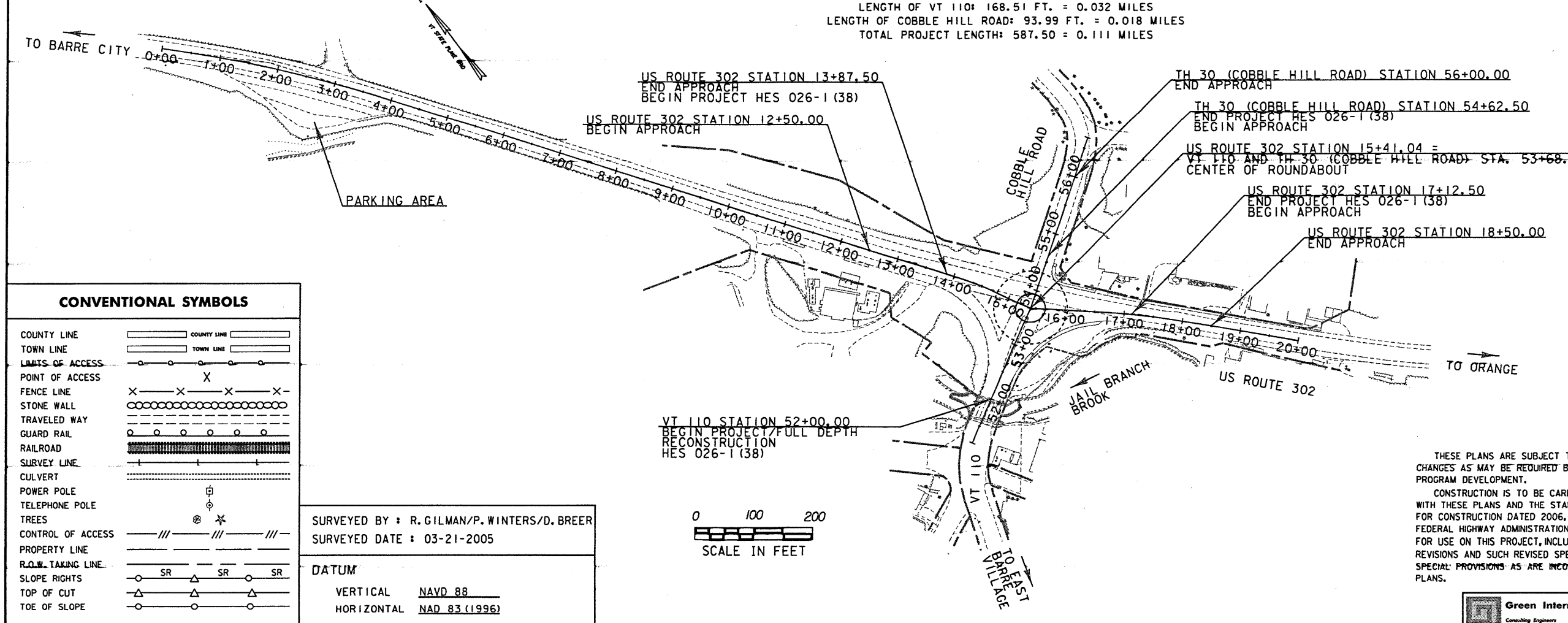

THESE PLANS ARE SUBJECT TO SUCH ENGINEERING CHANGES AS MAY BE REQUIRED BY THE DIRECTOR OF PROGRAM DEVELOPMENT.
 CONSTRUCTION IS TO BE CARRIED ON IN ACCORDANCE WITH THESE PLANS AND THE STANDARD SPECIFICATIONS FOR CONSTRUCTION DATED 2006, AS APPROVED BY THE FEDERAL HIGHWAY ADMINISTRATION ON JUNE 16, 2006. FOR USE ON THIS PROJECT, INCLUDING ALL SUBSEQUENT REVISIONS AND SUCH REVISED SPECIFICATIONS AND SPECIAL PROVISIONS AS ARE INCORPORATED IN THESE PLANS.

DIRECTOR OF PROGRAM DEVELOPMENT
 APPROVED: *[Signature]* DATE: 1-31-08
 PROJECT MANAGER: JOSHUA SCHULTZ
 PROJECT NAME: BARRE TOWN
 PROJECT NUMBER: HES 026-1 (38)
 SHEET 1 OF 64 SHEETS

