

**PROJECT WORK ZONE**

PORTABLE CHANGABLE MESSAGE SIGN  
MILEMARKER 6.195 (WESTBOUND)  
(PROJECT STATION 18+60 LT.)

PORTABLE CHANGABLE MESSAGE SIGN  
MILEMARKER 5.940 (EASTBOUND)

V	T	1	0	5		
C	L	O	S	E	D	
T	O	T	H	R	U	

PORTABLE CHANGABLE SIGN - PHASE 1

T	R	A	F	F	I	C
*	M	M	M	D	D	-
*	M	M	M	D	D	

PORTABLE CHANGABLE SIGN - PHASE 2

\* M=MONTH  
D=DAY

VT ROUTE 105 TO RICHFORD

VT ROUTE 105 TO TROY

VT ROUTE 105 TO TROY

VT ROUTE 105 TO RICHFORD

MORSE HILL ROAD TH 21  
**DETAIL "A"**

**DETAIL "B"**

**DETOUR SHEET 1 PROJECT AREA**

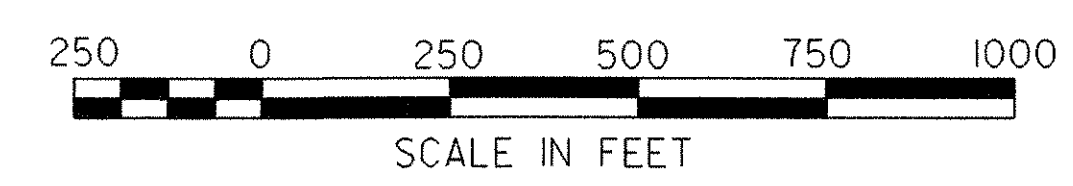
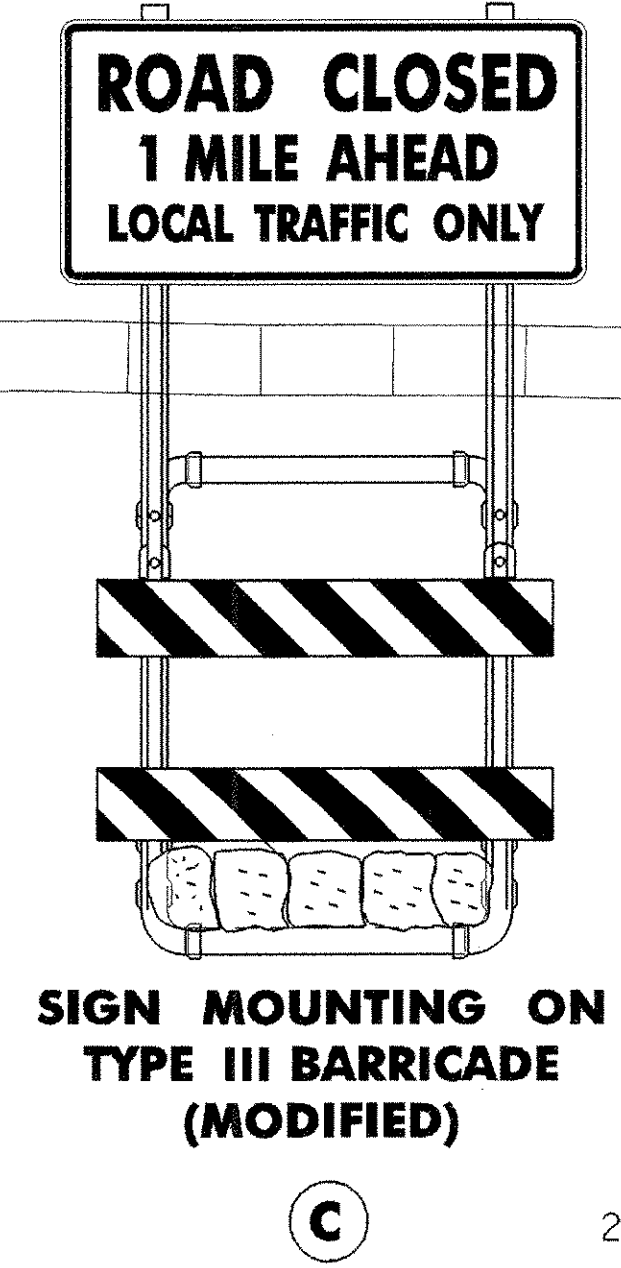
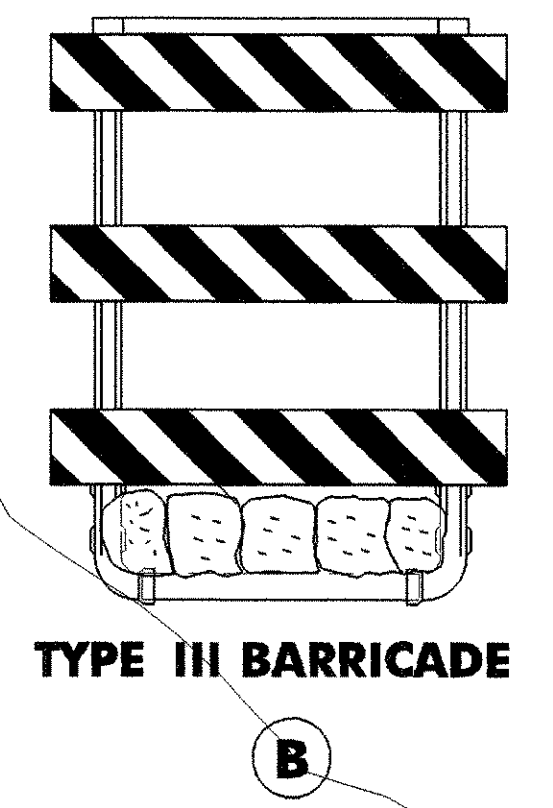
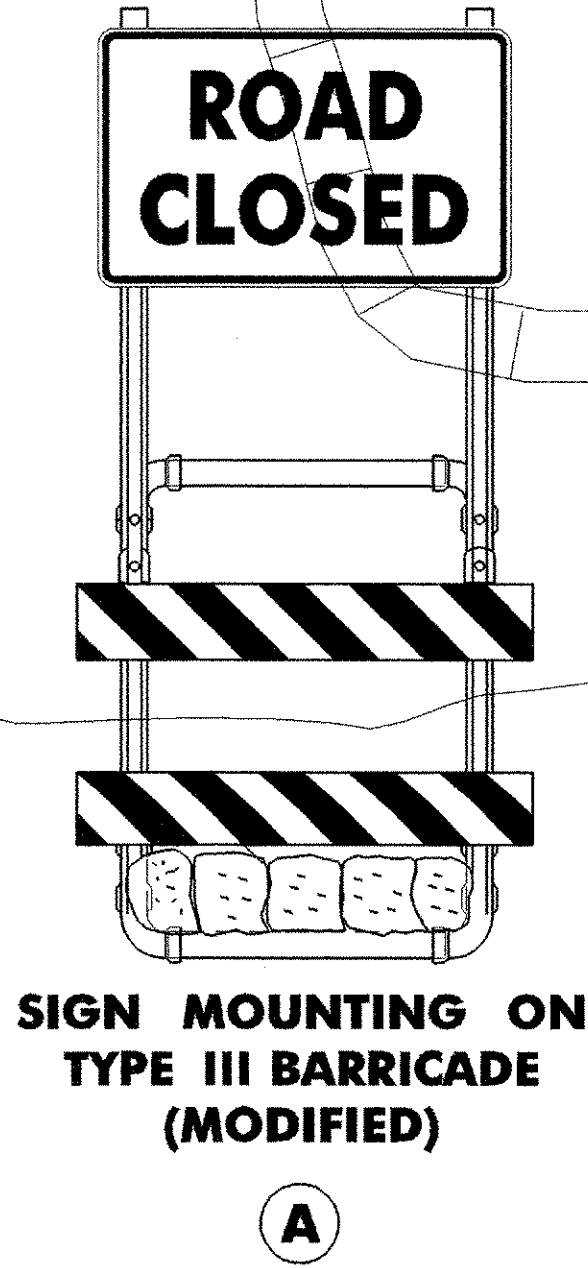

PROJECT NAME: JAY  
PROJECT NUMBER: ST STP CULV (2)  
FILE NAME: 04b140\s04b140detour\signs.dgn  
PROJECT LEADER: W. SYMONDS  
DESIGNED BY: T. FILLBACH  
s04b140dsigns.l  
PLOT DATE: 23-OCT-2006  
DRAWN BY: G. SHANGRAW  
CHECKED BY: T. SUMNER  
SHEET 21 OF 39