

646.414 DURABLE 6" WHITE LINE (MOD.) (RETROREFLECTIVITY/INLAID)
 (ALL LINES WILL INCLUDE EDGE LINE BREAKS AND RADIUS FOR TOWN HIGHWAYS)

CLARENDON:
 STA. 272+00.00 - STA. 288+25.00 DASHED LINE C/L
 STA. 272+00.00 - STA. 288+25.00 EDGE LINE LT
 STA. 274+65.00 - STA. 277+00.00 SOLID LANE LINE LT
 STA. 274+65.00 - STA. 276+65.00 SOLID LANE LINE RT
 STA. 276+65.00 - STA. 278+20.00 DOTTED LANE LINE RT
 STA. 277+00.00 - STA. 279+00.00 DOTTED LANE LINE LT

646.415 DURABLE 6" YELLOW LINE (MOD.) (RETROREFLECTIVITY/INLAID)
 (ALL LINES WILL INCLUDE EDGE LINE BREAKS AND RADIUS FOR TOWN HIGHWAYS)

CLARENDON:
 STA. 272+00.00 - STA. 288+25.00 EDGE LINE RT
 STA. 273+62.0, LT
 STA. 273+62.0, LT

646.41 DURABLE 4" WHITE LINE (MOD.) (RETROREFLECTIVITY/INLAID)

CLARENDON:
 STA. 273+97.92 EDGE LINE LT, T-4
 646.41 DURABLE 4" YELLOW LINE (MOD.) (RETROREFLECTIVITY/INLAID)
 CLARENDON:
 STA. 273+97.92 DOUBLE SOLID LT, T-4

646.614 TEMPORARY 6" WHITE LINE (PAINT)
 (ALL LINES WILL INCLUDE EDGE LINE BREAKS AND RADIUS FOR TOWN HIGHWAYS)

CLARENDON:
 STA. 272+00.00 - STA. 288+25.00 DASHED LINE C/L
 STA. 272+00.00 - STA. 288+25.00 EDGE LINE LT
 STA. 274+65.00 - STA. 277+00.00 SOLID LANE LINE LT
 STA. 274+65.00 - STA. 276+65.00 SOLID LANE LINE RT
 STA. 276+65.00 - STA. 278+20.00 DOTTED LANE LINE RT
 STA. 277+00.00 - STA. 279+00.00 DOTTED LANE LINE LT

646.615 TEMPORARY 6" YELLOW LINE (PAINT)
 (ALL LINES WILL INCLUDE EDGE LINE BREAKS AND RADIUS FOR TOWN HIGHWAYS)

CLARENDON:
 STA. 272+00.00 - STA. 288+25.00 EDGE LINE RT

646.60 TEMPORARY 4" WHITE LINE (PAINT)

CLARENDON:
 STA. 273+97.92 EDGE LINE LT, T-4

646.61 TEMPORARY 4" YELLOW LINE (PAINT)

CLARENDON:
 STA. 273+97.92 DOUBLE SOLID LT, T-4

646.46 24" STOP BAR (THERMOPLASTIC)

CLARENDON:
 STA. 273+97.92 LT, T-4
 STA. 274+65.00 LT/RT
 646.66 TEMPORARY 24" STOP BAR (PAINT)

646.50 DURABLE LETTER OR SYMBOL (THERMOPLASTIC)

CLARENDON:
 STA. 274+74.3 LT, ARROW (1 EA)
 STA. 274+74.3 RT, ARROW (1 EA) 274+64 RT
 STA. 275+18.6 LT, "O,N,L,Y" (4 EA) 275+44 LT
 STA. 275+36.5 RT, "O,N,L,Y" (4 EA) 274+08 RT
 STA. 275+62.9 LT, ARROW (1 EA)
 STA. 275+98.7 RT, ARROW (1 EA)
 STA. 276+07.2 LT, "O,N,L,Y" (4 EA) 276+17 LT
 STA. 276+51.5 LT, ARROW (1 EA)
 STA. 276+60.8 RT, "O,N,L,Y" (4 EA)
 STA. 276+95.8 LT, "O,N,L,Y" (4 EA)
 STA. 281+65.8 LT, "A,H,E,A,D" (5 EA) 281+77 LT
 STA. 281+65.8 RT, "A,H,E,A,D" (5 EA) 281+77 RT
 STA. 282+06.2 LT, "S,I,G,N,A,L" (6 EA) 282+17 LT
 STA. 282+06.2 RT, "S,I,G,N,A,L" (6 EA) 282+17 RT

646.81 PAINTED CURB

CLARENDON:
 STA. 274+74.3 LT, ARROW (2 EA)
 STA. 274+74.3 RT, ARROW (2 EA)
 STA. 275+98.7 RT, ARROW (2 EA)
 STA. 276+51.5 LT, ARROW (2 EA)
 STA. 281+65.8 LT, "A,H,E,A,D" (10 EA)
 STA. 281+65.8 RT, "A,H,E,A,D" (10 EA)
 STA. 282+06.2 LT, "S,I,G,N,A,L" (12 EA)
 STA. 282+06.2 RT, "S,I,G,N,A,L" (12 EA)

CLARENDON:
 STA. 272+00.0 - STA. 273+35.0 RT (140 LF)
 STA. 274+65.0 - STA. 288+25.0 RT (1360 LF)

675.50 REMOVING SIGNS
 AS SHOWN - 13

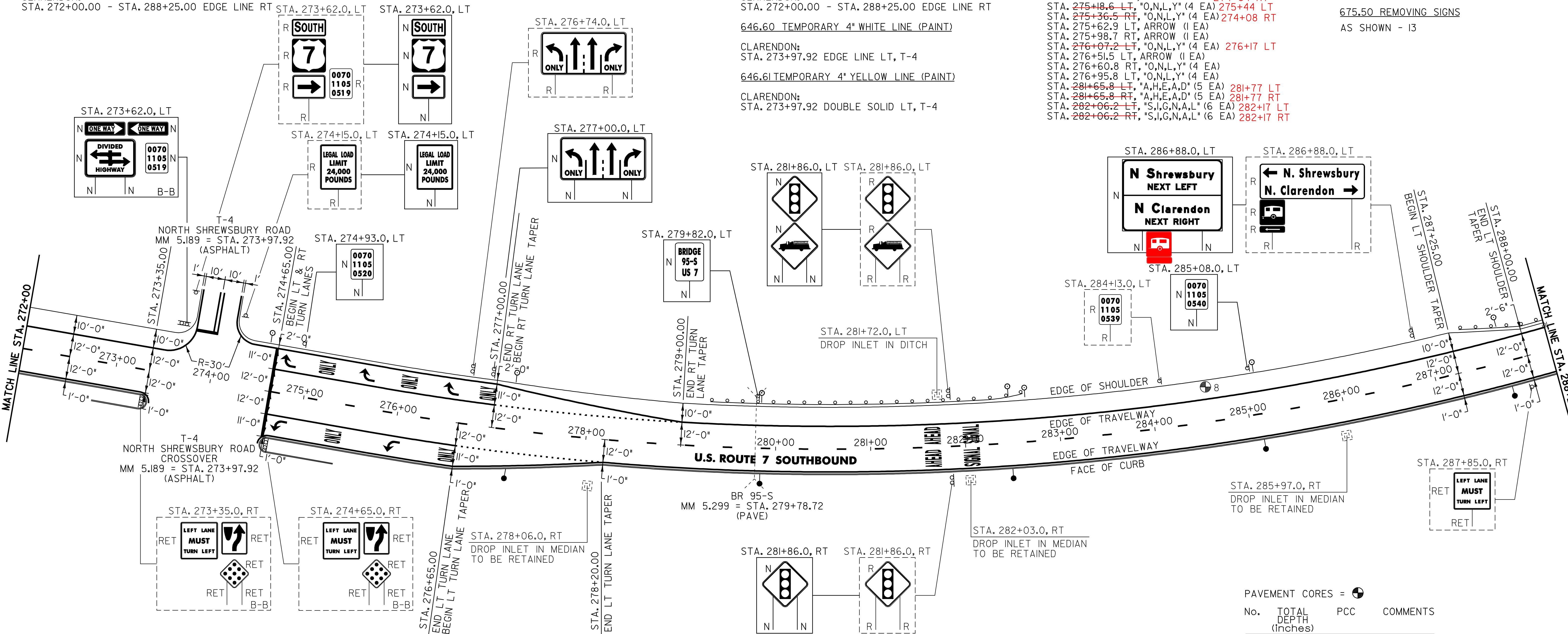

213.10 MILLED RUMBLE STRIPS

CLARENDON:
 STA. 272+00.0 - STA. 273+20.0 LT (120 LF)
 STA. 279+00.0 - STA. 287+75.0 LT (875 LF)

604.412 REHABING DI, CB OR MH, CLASS 1

CLARENDON:
 STA. 281+72.0 LT

621.20 STEEL BEAM GUARDRAIL (GALVANIZED)

CLARENDON: 279+27 300 LF
 STA. 279+41.0 - STA. 282+28.5 LT (287.5 LF)
 STA. 287+47.7 - STA. 287+72.7 LT (25 LF)

621.505 MANUFACTURED TERMINAL SECTION (FLARED)

CLARENDON:
 STA. 282+28.5 - STA. 282+66.0 LT

621.52 TRAILING END TERMINAL

CLARENDON: 279+14 - STA. 279+28 LT
 STA. 279+27.0 - STA. 279+41.0 LT
 STA. 287+33.7 - STA. 287+47.7 LT

621.72 ALUMINUM APPROACH RAIL

CLARENDON:
 STA. 287+72.7 - STA. 288+00.0 LT (27.3 LF)

621.80 REMOVAL AND DISPOSAL OF GUARDRAIL

CLARENDON:
 STA. 279+29.0 - STA. 280+81.0 LT (152 LF)
 STA. 287+36.0 - STA. 288+00.0 LT (64 LF)

676.10 DELINEATORS WITH STEEL POSTS

TYPE I WHITE TYPE I AMBER

CLARENDON:
 STA. 274+56.0 LT STA. 277+20.0 RT
 STA. 277+20.0 LT STA. 279+84.0 RT
 STA. 279+84.0 LT STA. 282+48.0 RT
 STA. 282+48.0 LT STA. 285+12.0 RT
 STA. 282+66.0 LT STA. 287+76.0 RT
 STA. 285+12.0 LT
 STA. 287+76.0 LT

SIGN LEGEND
 R = REMOVE
 S = SALVAGE
 N = NEW
 RET = RETAIN
 B-B = BACK TO BACK
 EXISTING = -----
 NEW = _____

No.	TOTAL DEPTH (inches)	PCC	COMMENTS
8	1.75	NO	-

NOTE:
 1. PAVING LIMIT ON ALL TOWN AND STATE HIGHWAYS SHALL BE MEASURED 25 FT BACK FROM U.S. ROUTE 7 EDGE OF SHOULDER UNLESS DENOTED OTHERWISE ON THE PLANS OR AS DIRECTED BY THE RESIDENT ENGINEER.

PROJECT LAYOUT SHEET #20

PROJECT NAME: WALLINGFORD - RUTLAND TOWN
 PROJECT NUMBER: NH 2408(1)S
 FILE NAME: p04b050.dgn PLOT DATE: \$DATE\$
 PROJECT LEADER: D.E.G. DRAWN BY: C.A.K.
 DESIGNED BY: J.S.P. CHECKED BY: D.E.G.
 IPARM FILE: p04b050L20.1 SHEET 32 OF 80