

BRIDGE TRANSITION AREA DETAIL

N.T.S.

BR 90-S U.S. ROUTE 7 CLARENDON STA. 68+94 TO CLARENDON STA. 72+31
 BR 96-S U.S. ROUTE 7 CLARENDON STA. 288+13 TO CLARENDON STA. 289+42

NOTE:

- DURING THE COLD PLANING PROCESS, PRECAUTION SHALL BE TAKEN TO PREVENT DAMAGING THE EXISTING MEMBRANE AND/OR ANY FINGER PLATE JOINTS. ANY DAMAGE INCURRED TO THE MEMBRANE OR JOINTS DURING THE COLD PLANING PROCESS SHALL BE THE RESPONSIBILITY OF THE CONTRACTOR AND WILL BE REPAIRED OR REPLACED AS DIRECTED BY THE RESIDENT ENGINEER AT NO COST TO THE STATE OF VERMONT.

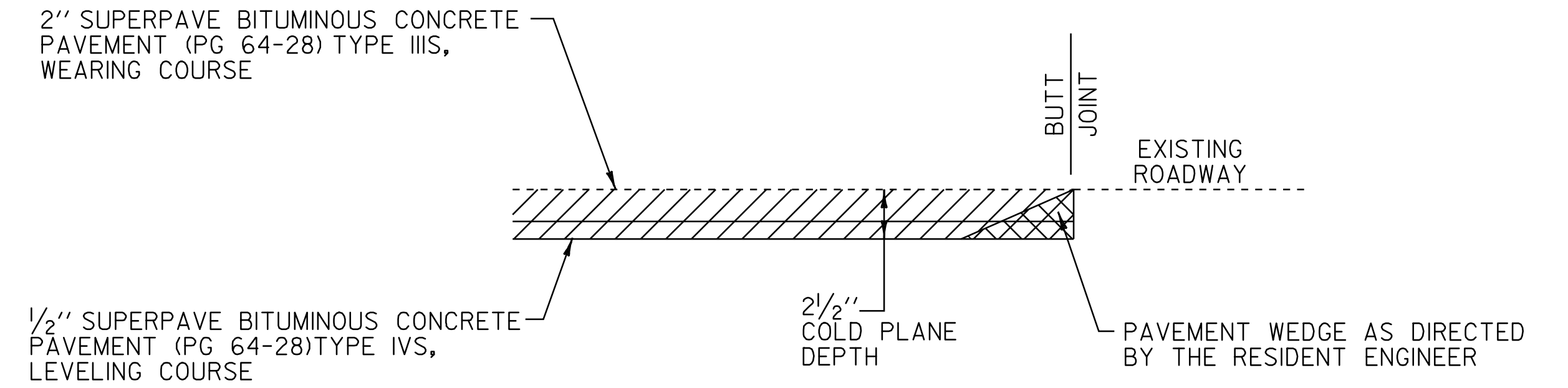

MAINLINE APPROACH AREA DETAIL

LOCATION

N.T.S.

WALLINGFORD STA 344+88.96 - BEGINNING OF PROJECT
 RUTLAND TOWN STA. 35+58.72 - END OF PROJECT

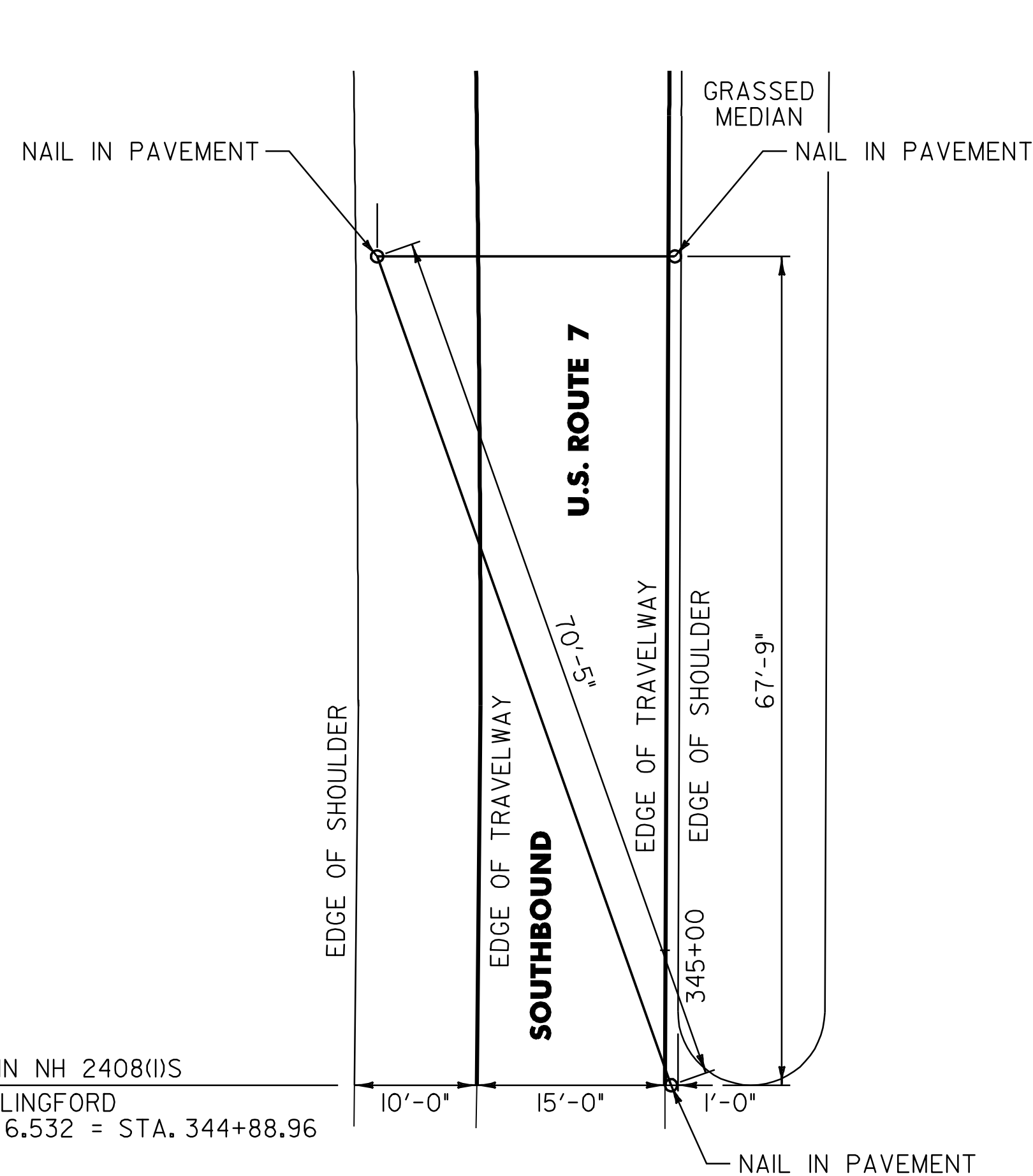

BEGIN PROJECT LOCATION TIES

N.T.S.

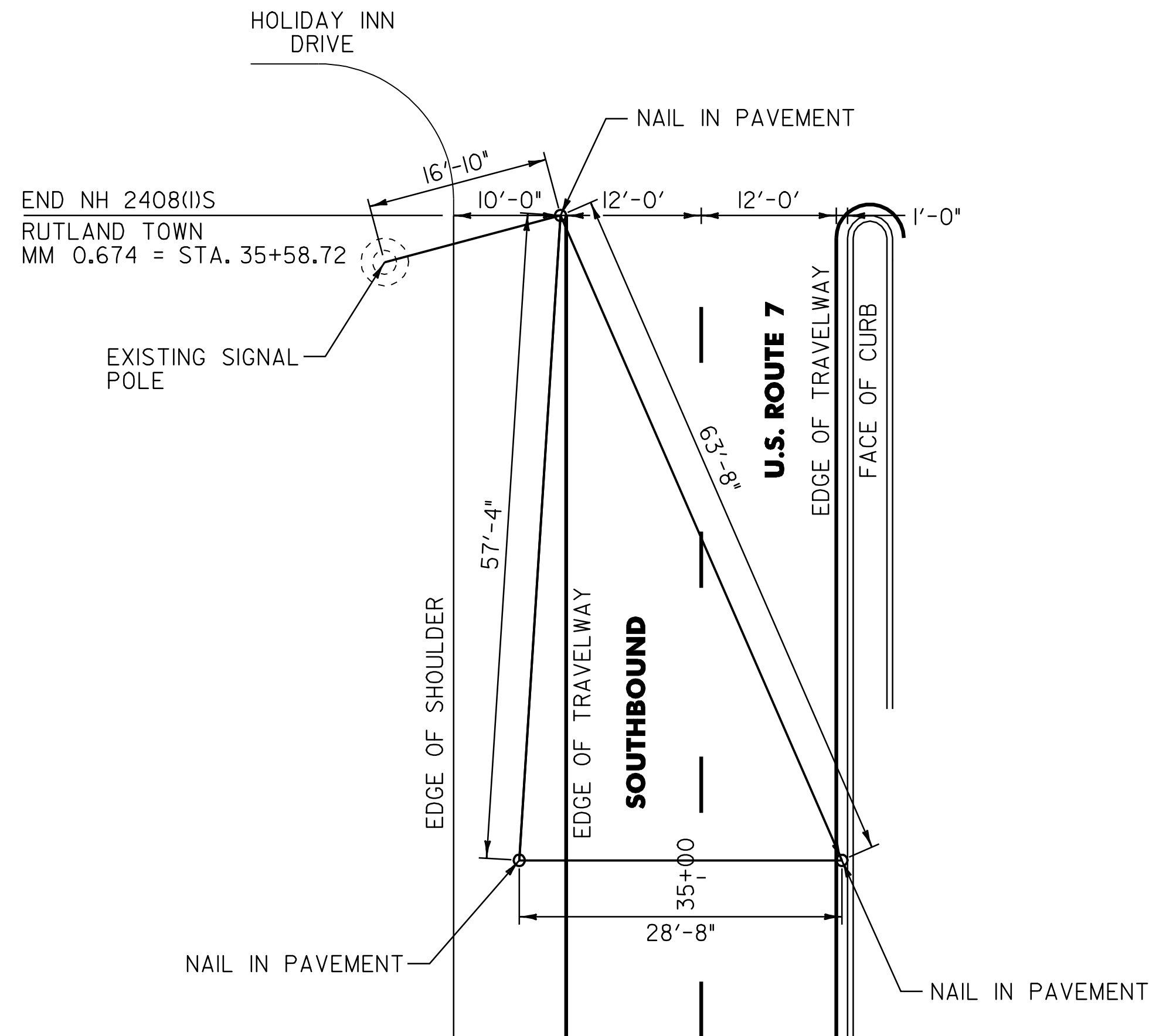

END PROJECT LOCATION TIES

N.T.S.

PAVING DETAIL SHEET #1

PROJECT NAME: WALLINGFORD - RUTLAND TOWN
 PROJECT NUMBER: NH 2408(I)S

FILE NAME: p04b050.dgn
 PROJECT LEADER: D.E.G.
 DESIGNED BY: J.S.P.
 IPARM FILE: p04b050pdl.i

PLOT DATE: \$DATE\$
 DRAWN BY: C.A.K.
 CHECKED BY: D.E.G.
 SHEET 4 OF 80