

TEMPORARY AND DURABLE 4" WHITE LINE STA 135+50 TO 136+71 SOLID LT STA 135+50 TO 138+14 SOLID RT STA 136+94 TO 139+00 SOLID RT STA 138+33 TO 139+00 SOLID RT		SHOULDER BERM REMOVAL STA 138+47 TO 139+00 LT STA 138+82 TO 139+00 RT	
TEMPORARY AND DURABLE 4" YELLOW LINE STA 135+50 TO 136+71 SOLID LT & RT STA 136+91 DOUBLE SOLID LT (TH 738) STA 137+11 TO 137+80 SOLID LT & RT STA 138+00 DOUBLE SOLID RT (TH 738) STA 138+20 TO 139+00 SOLID LT & RT		STEEL BEAM GUARDRAIL STA 138+33 TO 138+82 RT	
TEMPORARY AND DURABLE 24" STOP BAR STA 136+91 LT (TH 738) STA 138+00 RT (TH 738)		ANCHOR FOR STEEL BEAM RAIL STA 138+33 RT	
TEMPORARY AND DURABLE LETTER OR SYMBOL STA 136+84 LT - "STOP" (TH 738) STA 138+06 RT - "STOP" (TH 738)		REMOVAL & DISP. OF GUARDRAIL STA 138+36 TO 138+82 RT	
		REMOVING SIGNS AS SHOWN - 7	

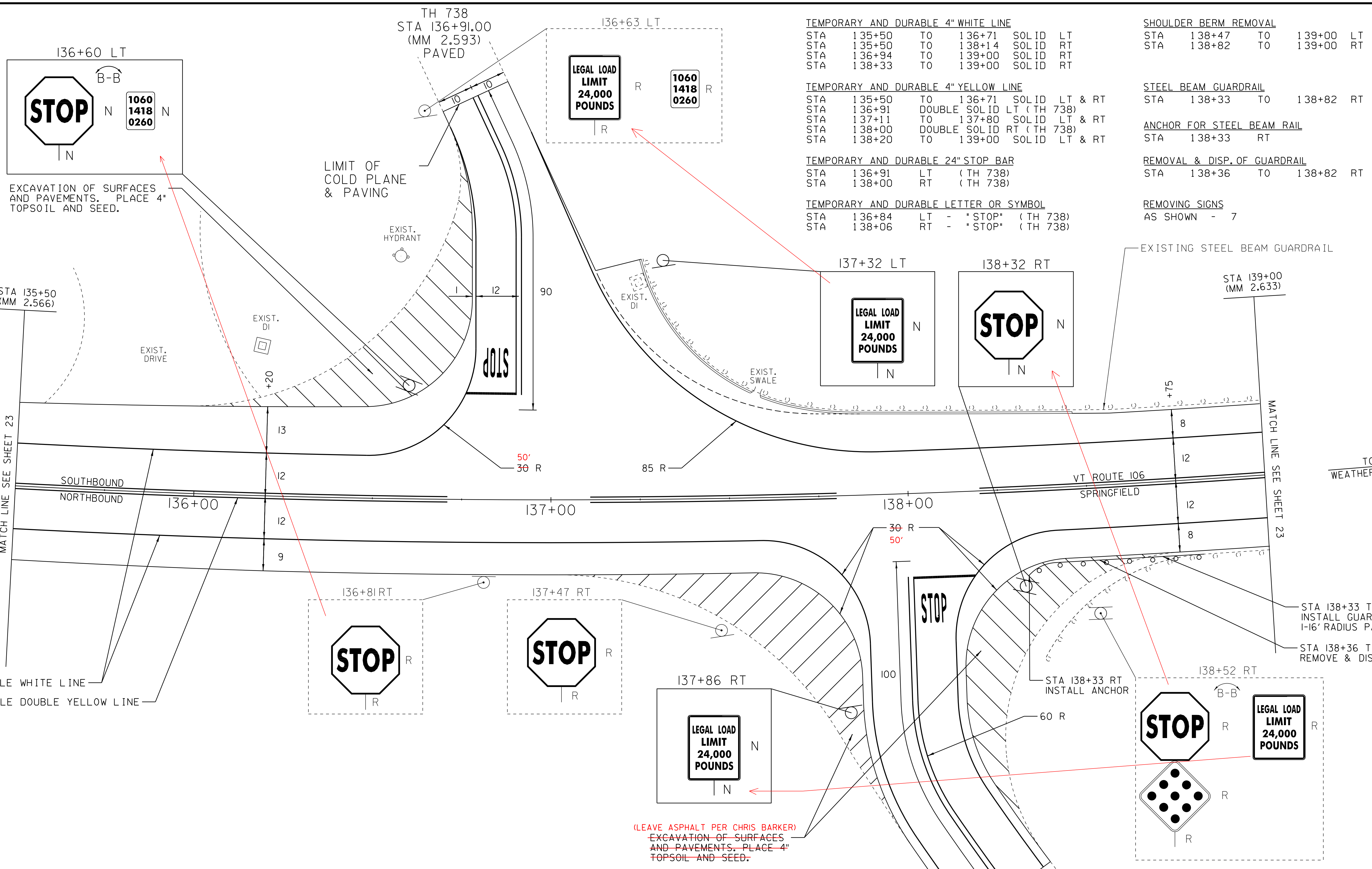

DURABLE WHITE LINE
 DURABLE DOUBLE YELLOW LINE

(LEAVE ASPHALT PER CHRIS BARKER)
 EXCAVATION OF SURFACES
 AND PAVEMENTS. PLACE 4"
 TOPSOIL AND SEED.

LEGEND

R	=	REMOVE EXISTING
S	=	SALVAGE
R & S	=	REMOVE AND SALVAGE
N	=	NEW
RET	=	RETAIN
B-B	=	BACK TO BACK
—	=	NEW RAIL
---	=	EXISTING RAIL

NOT TO SCALE

INTERSECTION DETAIL SHEET 2	SURVEYED BY	CLD	DATE	12/05
	DRAWN BY	SRB	DATE	5/05
	SQUAD LEADER	CRB		
	DESIGN FILE NO.	/pave/04b038/pb038.dgn		
IPARM FILE	pb038dt02.i	DATE PLOTTED	JUN-2012 08	
PROJ. NAME	SPRINGFIELD			
PROJ. NO.	STP 2405(1)S			
SHEET 35	OF	42	SHEETS	

DATUM

VERTICAL	N/A
HORIZONTAL	N/A

TH 738
 STA 138+00.00
 (MM 2.614)
 PAVED

TO WEATHERSFIELD

TO SPRINGFIELD