

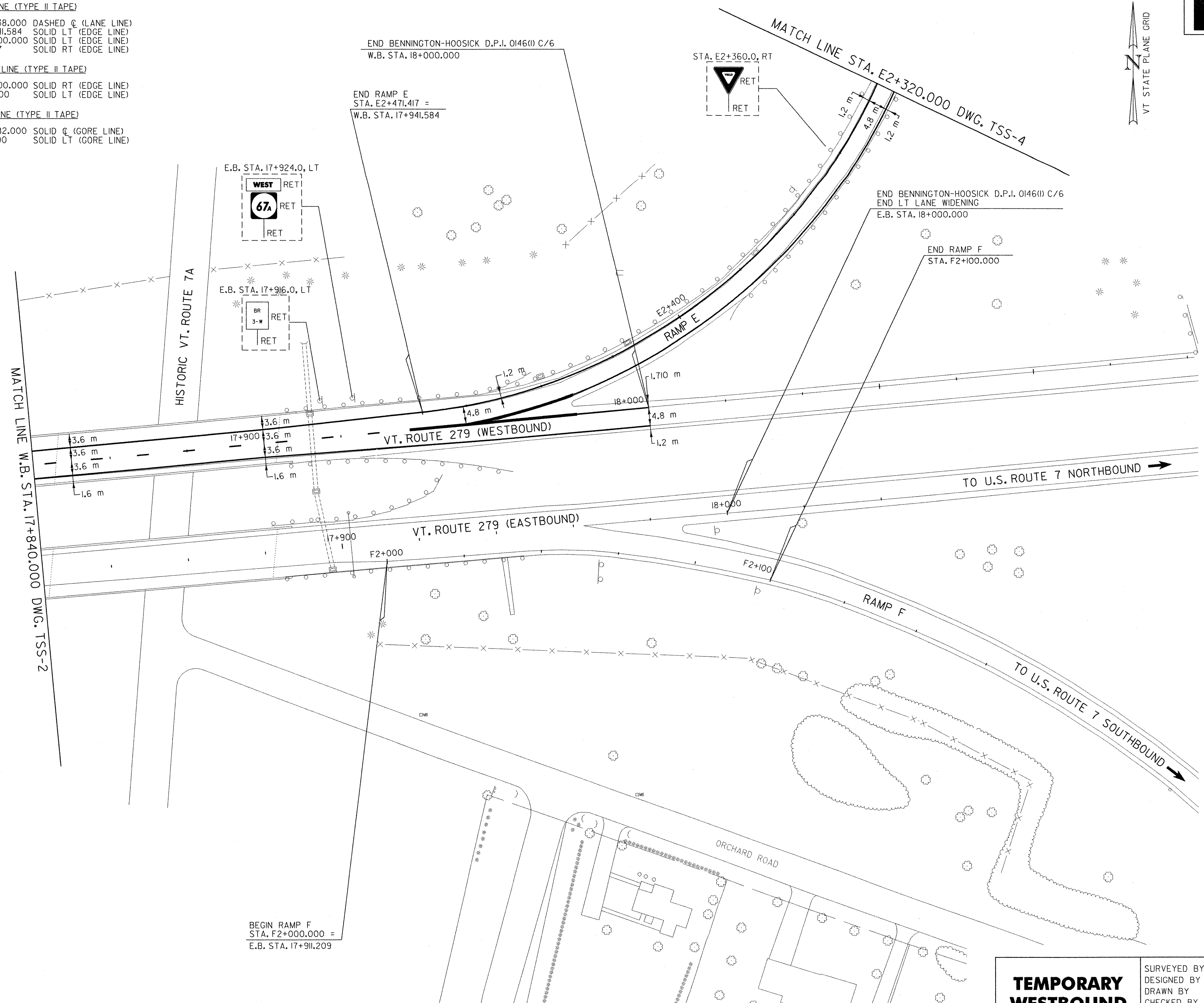

646.614 TEMPORARY 150 mm WHITE LINE (TYPE II TAPE)
 W.B. STA. 17+840.000 - W.B. STA. 17+938.000 DASHED @ (LANE LINE)
 W.B. STA. 17+840.000 - W.B. STA. 17+941.584 SOLID LT (EDGE LINE)
 W.B. STA. 17+982.000 - W.B. STA. 18+000.000 SOLID LT (EDGE LINE)
 STA. E2+320.000 - STA. E2+471.417 SOLID RT (EDGE LINE)

646.615 TEMPORARY 150 mm YELLOW LINE (TYPE II TAPE)
 W.B. STA. 17+840.000 - W.B. STA. 18+000.000 SOLID RT (EDGE LINE)
 STA. E2+320.000 - STA. E2+434.500 SOLID LT (EDGE LINE)

646.64 TEMPORARY 300 mm WHITE LINE (TYPE II TAPE)
 W.B. STA. 17+938.000 - W.B. STA. 17+982.000 SOLID @ (GORE LINE)
 STA. E2+434.500 - STA. E2+461.000 SOLID LT (GORE LINE)



SIGN LEGEND
 R = REMOVE
 S = SALVAGE
 N = NEW
 RET = RETAIN
 B-B = BACK TO BACK
 EXISTING = - - - - -
 NEW = _____

TEMPORARY WESTBOUND STRIPING PLAN	SURVEYED BY	C.H.A. & V.S.E.	DATE	12/93
	DESIGNED BY	D.W.E.	DATE	2/04
	DRAWN BY	C.A.K.	DATE	2/04
	CHECKED BY	D.E.G.	DATE	2/04
DESIGN FILE NO.	TSS03.DGN			
PROJ. NAME	BENNINGTON - HOOSICK D.P.I. 0146(1) C/6			
PROJ. NO.	P.I.N. 1306.60			
DWG. NO.	TSP-3	SHEET 38 OF 83		

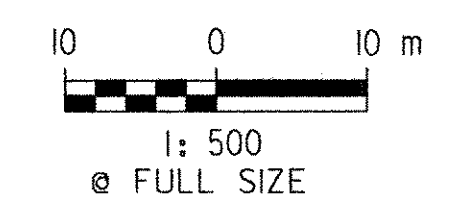

DATUM	
VERTICAL	NAVD 88
HORIZONTAL	NAD 83 (1992)

FILE NAME = ut:\5116\svoot\contract6\tss03.dgn
 DATE/TIME = 2/16/2004
 USER = 2225