

646.614 TEMPORARY 150 mm WHITE LINE (TYPE II TAPE)
 W.B. STA. 17+305.027 - W.B. STA. 17+540.000 SOLID LT (EDGE LINE)
 STA. BIO+064.800 - STA. BIO+175.097 RT (EDGE LINE)

646.615 TEMPORARY 150 mm YELLOW LINE (TYPE II TAPE)
 W.B. STA. 17+305.027 - W.B. STA. 17+540.000 SOLID RT (EDGE LINE)
 STA. BIO+064.800 - STA. BIO+175.097 LT (EDGE LINE)

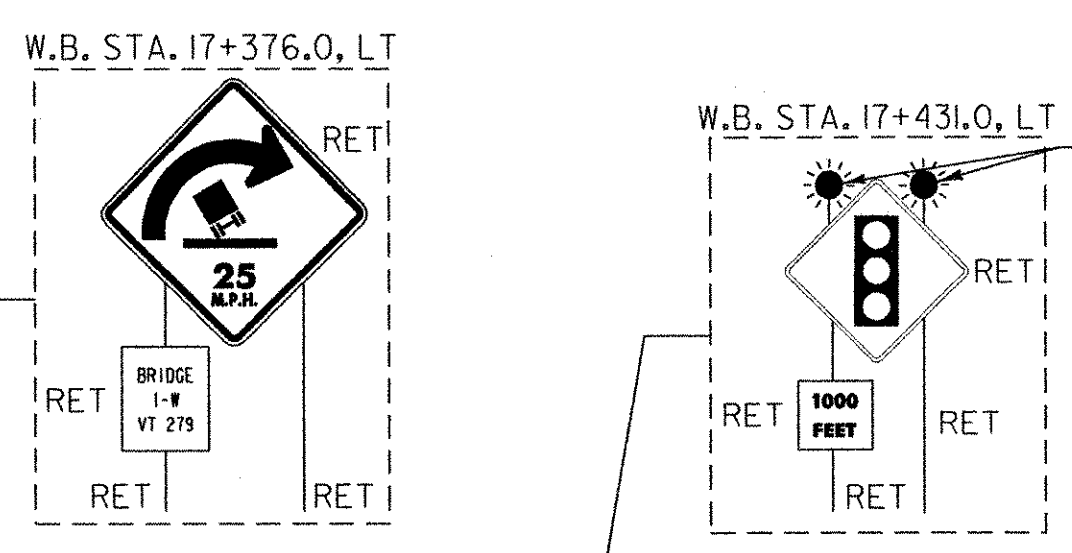
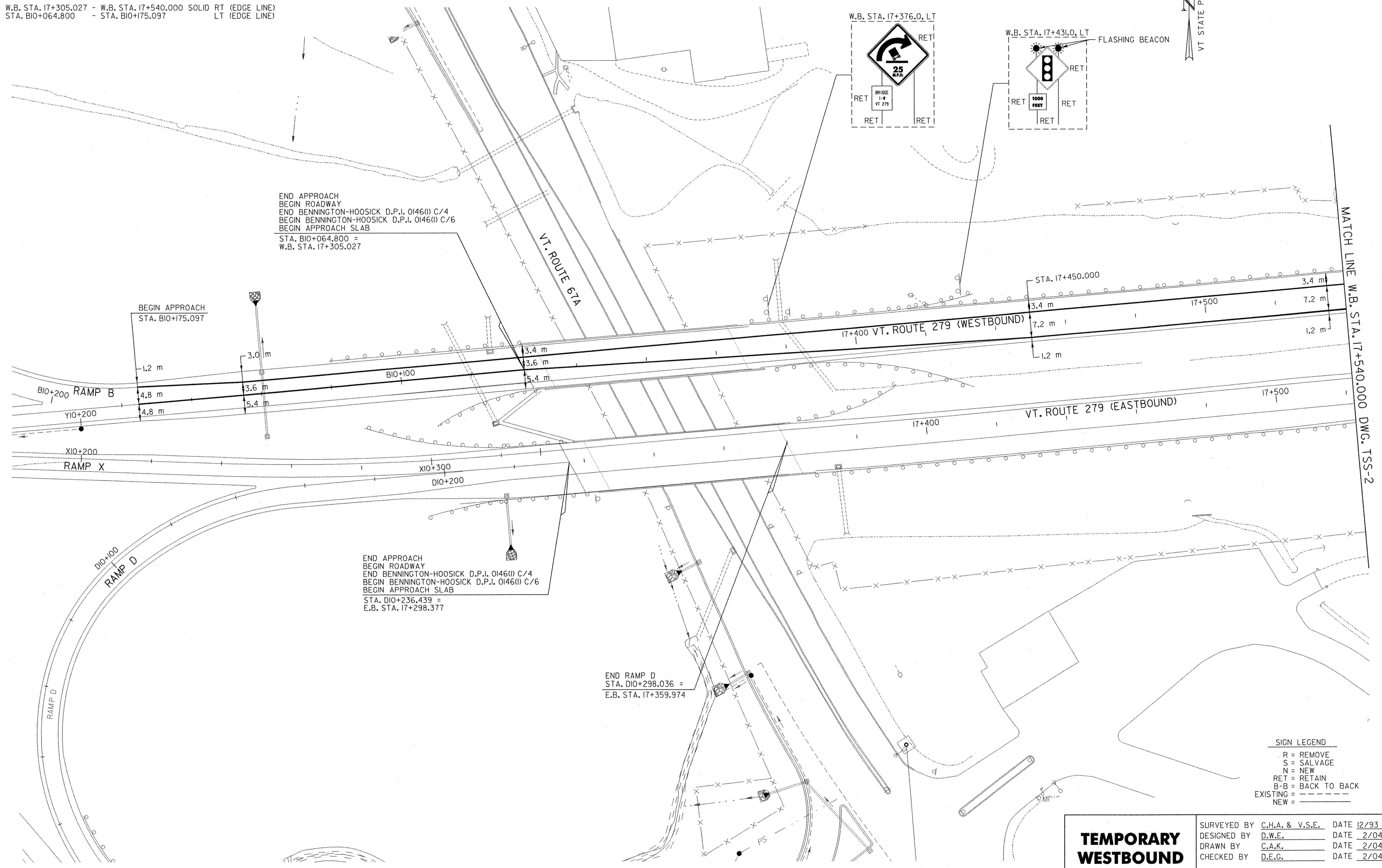

END APPROACH
 BEGIN ROADWAY
 END BENNINGTON-HOOSICK D.P.I. 0146(1) C/4
 BEGIN BENNINGTON-HOOSICK D.P.I. 0146(1) C/6
 BEGIN APPROACH SLAB
 STA. BIO+064.800 =
 W.B. STA. 17+305.027

END APPROACH
 BEGIN ROADWAY
 END BENNINGTON-HOOSICK D.P.I. 0146(1) C/4
 BEGIN BENNINGTON-HOOSICK D.P.I. 0146(1) C/6
 BEGIN APPROACH SLAB
 STA. DIO+236.439 =
 E.B. STA. 17+298.377

END RAMP D
 STA. DIO+298.036 =
 E.B. STA. 17+359.974

SIGN LEGEND
 R = REMOVE
 S = SALVAGE
 N = NEW
 RET = RETAIN
 B-B = BACK TO BACK
 EXISTING = - - - - -
 NEW = _____

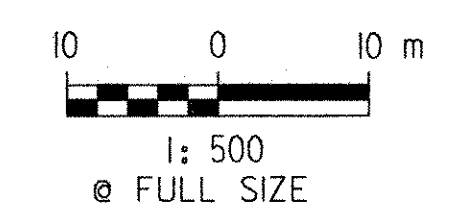

TEMPORARY WESTBOUND SIGNING AND STRIPING PLAN	SURVEYED BY	C.H.A. & V.S.E.	DATE	12/93
	DESIGNED BY	D.W.E.	DATE	2/04
	DRAWN BY	C.A.K.	DATE	2/04
	CHECKED BY	D.E.G.	DATE	2/04
DESIGN FILE NO.	TSS01.DGN			
PROJ. NAME	BENNINGTON - HOOSICK D.P.I. 0146(1) C/6			
PROJ. NO.	P.I.N. 1306.60			
DWG. NO.	TSP-1	SHEET 36 OF 83		

DATUM	
VERTICAL	NAVD 88
HORIZONTAL	NAD 83 (1992)

FILE NAME = ur\5116\vaot\contract6\tss01.dgn
 DATE/TIME = 2/16/2004
 USER = 2225