

LEGEND	
	SILT FENCE
	SILT FENCE FOR DRAINAGE STRUCTURE PROTECTION
	EROSION MATTING, (SEE NOTE 3)

*SEE NOTE 2

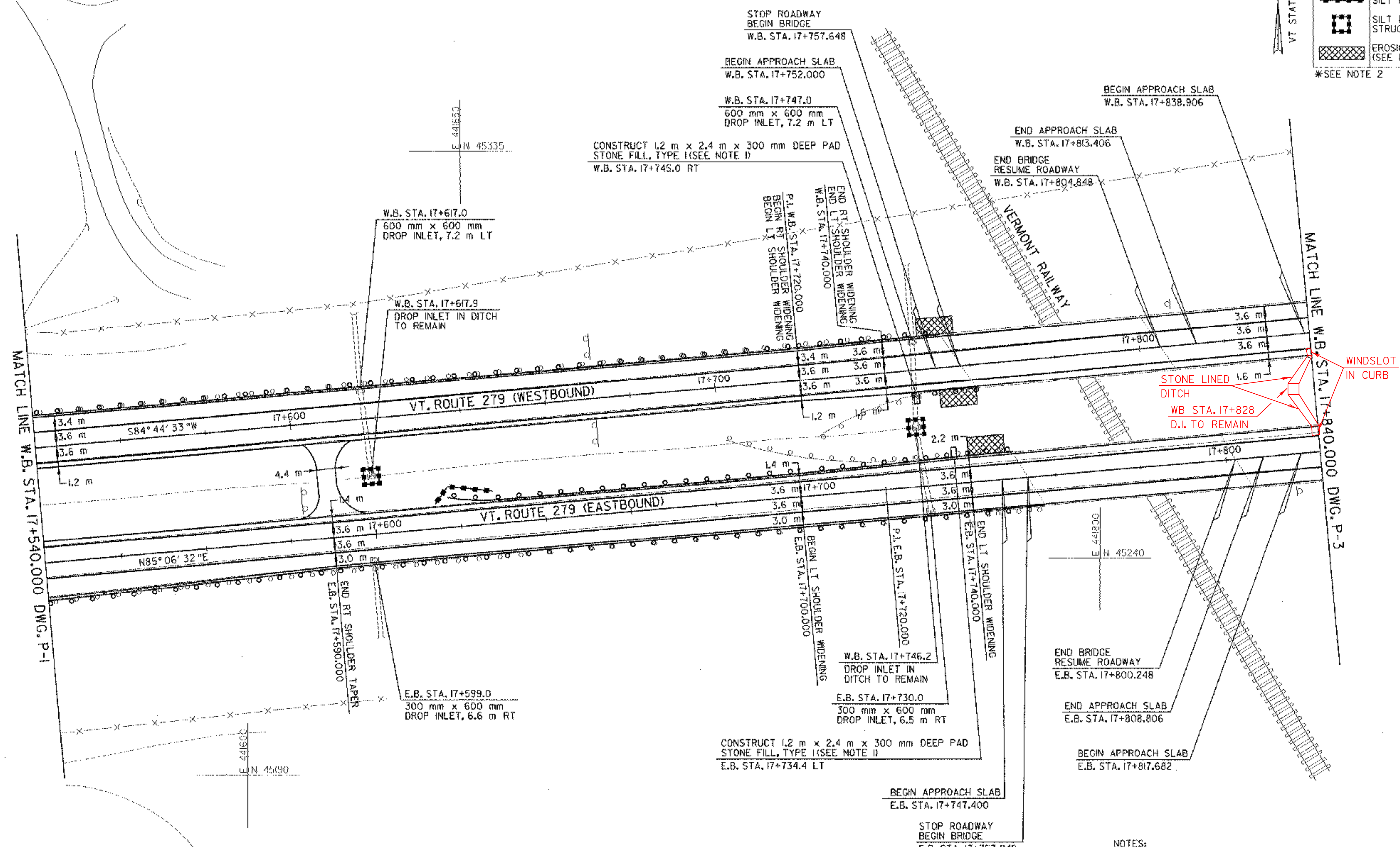

MATCH LINE W.B. STA. 17+540.000 DWG. P-1

MATCH LINE W.B. STA. 17+840.000 DWG. P-3

WINDSLOT IN CURB
STONE LINED 1.6 m DITCH
WB STA. 17+828 D.I. TO REMAIN

- NOTES:
- CONSTRUCT STONE PADS AT CURB ENDS OR AS DIRECTED BY THE RESIDENT ENGINEER. ANY EXCAVATION REQUIRED SHALL BE PAID FOR UNDER ITEM 608.25.
 - ADDITIONAL CONTROLS AND PROTECTION OF THE ENVIRONMENT NOT SHOWN ON THE PLANS MAY BE WARRANTED DURING CONSTRUCTION AND SHALL BE INCORPORATED INTO THE PROJECT AS REQUIRED OR AS DIRECTED BY THE RESIDENT ENGINEER.
 - EMBANKMENT EROSION TO BE FILLED WITH EARTH BORROW, TOPSOIL AND SEED AND COVERED WITH EROSION MATTING OR AS DIRECTED BY THE RESIDENT ENGINEER.

- 213.0 MILLED RUMBLE STRIPS**
W.B. STA. 17+540.0 - W.B. STA. 17+740.7 LT (200.7 m)
W.B. STA. 17+540.0 - W.B. STA. 17+580.9 RT (40.9 m)
W.B. STA. 17+633.8 - W.B. STA. 17+746.9 RT (113.1 m)
E.B. STA. 17+522.1 - E.B. STA. 17+563.1 LT (41.0 m)
E.B. STA. 17+522.1 - E.B. STA. 17+742.6 RT (220.5 m)
E.B. STA. 17+618.1 - E.B. STA. 17+736.3 LT (118.2 m)
- 604.40 CHANGE ELEVATION OF DL CB OR MH**
W.B. STA. 17+617.0 LT
W.B. STA. 17+747.0 LT
E.B. STA. 17+599.0 RT
E.B. STA. 17+730.0 RT
- 616.28 CAST-IN-PLACE CONCRETE CURB, TYPE B**
W.B. STA. 17+741.7 - W.B. STA. 17+751.6 LT (9.9 m)
W.B. STA. 17+745.6 - W.B. STA. 17+757.8 RT (12.2 m)
E.B. STA. 17+735.0 - E.B. STA. 17+747.2 LT (12.2 m)
E.B. STA. 17+743.6 - E.B. STA. 17+753.5 RT (9.9 m)
- 35 TREATED TIMBER CURB BOARD**
616.31 BITUMINOUS CONCRETE CURB, TYPE B
W.B. STA. 17+540.0 - W.B. STA. 17+741.7 LT (8.3 ft)
E.B. STA. 17+522.1 - E.B. STA. 17+743.6 RT (9.1 ft)

- 621.20 STEEL BEAM GUARDRAIL**
W.B. STA. 17+540.0 - W.B. STA. 17+742.6 LT (202.6 m)
E.B. STA. 17+522.1 - E.B. STA. 17+744.5 RT (222.4 m)
E.B. STA. 17+631.8 - E.B. STA. 17+738.2 LT (106.4 m)
- 621.505 MANUFACTURED TERMINAL SECTION (FLARED)**
E.B. STA. 17+631.8 LT (1EA)
- 621.52 TRAILING END TERMINAL**
W.B. STA. 17+744.7 - W.B. STA. 17+748.8 RT
- 621.72 GUARDRAIL APPROACH SECTION, NETIC 2 RAIL (MOD.)**
W.B. STA. 17+742.6 - W.B. STA. 17+751.6 LT
W.B. STA. 17+748.8 - W.B. STA. 17+757.8 RT
E.B. STA. 17+738.2 - E.B. STA. 17+747.2 LT
E.B. STA. 17+744.5 - E.B. STA. 17+753.5 RT
- 621.80 REMOVAL AND DISPOSAL OF GUARDRAIL**
W.B. STA. 17+540.0 - W.B. STA. 17+751.6 LT (211.6 m)
W.B. STA. 17+723.8 - W.B. STA. 17+757.8 RT (34.0 m)
E.B. STA. 17+522.1 - E.B. STA. 17+753.5 RT (231.4 m)
E.B. STA. 17+683.7 - E.B. STA. 17+747.2 LT (63.5 m)

DATUM	
VERTICAL	NAVD 88
HORIZONTAL	NAD 83 (1992)



PLAN	
SURVEYED BY	C.H.A. & V.S.E. DATE 12/93
DESIGNED BY	D.W.E. DATE 2/04
DRAWN BY	C.A.K. DATE 2/04
CHECKED BY	D.E.G. DATE 2/04
DESIGN FILE NO.	PLAN02.DGN
PROJ. NAME	BENNINGTON - HOOSICK D.P.I. 0146(D) C/6
PROJ. NO.	P.I.N. 1306.60
DWG. NO.	P-2
SHEET 21 OF 83	

FILE NAME: h:\5116\vaet\contract68\plan02.dgn
DATE/TIME: 2/19/2004 12:22:25
USER: USER