

LEGEND

- SILT FENCE
- SILT FENCE FOR DRAINAGE STRUCTURE PROTECTION
- EROSION MATTING. (SEE NOTE 5)

*SEE NOTE 4

CURVE B-1
 P.C.=STA. B10+175.097
 P.C.C.=STA. B10+230.345
 $\Delta=35^{\circ}10'19.8''$ RT
 R=90.000 m
 T=28.526 m
 L=55.248 m
 E=4.412 m
 $e_{max}=0.069$ DN, RT

CURVE D-1
 P.C.=STA. D10+000.000
 P.C.C.=STA. D10+105.074
 $\Delta=92^{\circ}37'11.1''$ RT
 R=65.000 m
 T=68.042 m
 L=105.074 m
 E=29.100 m
 $e_{max}=0.077$ DN, RT

CURVE D-2
 P.C.C.=STA. D10+105.074
 P.T.=STA. D10+157.346
 $\Delta=33^{\circ}16'39.0''$ RT
 R=90.000 m
 T=26.896 m
 L=52.272 m
 E=3.933 m
 $e_{max}=0.069$ DN, RT

CURVE X-1
 P.C.=STA. X10+236.136
 P.T.=STA. X10+320.871
 $\Delta=06^{\circ}56'08.5''$ LT
 R=700.000 m
 T=42.420 m
 L=84.735 m
 E=1.284 m
 $e_{max}=0.063$ DN, LT

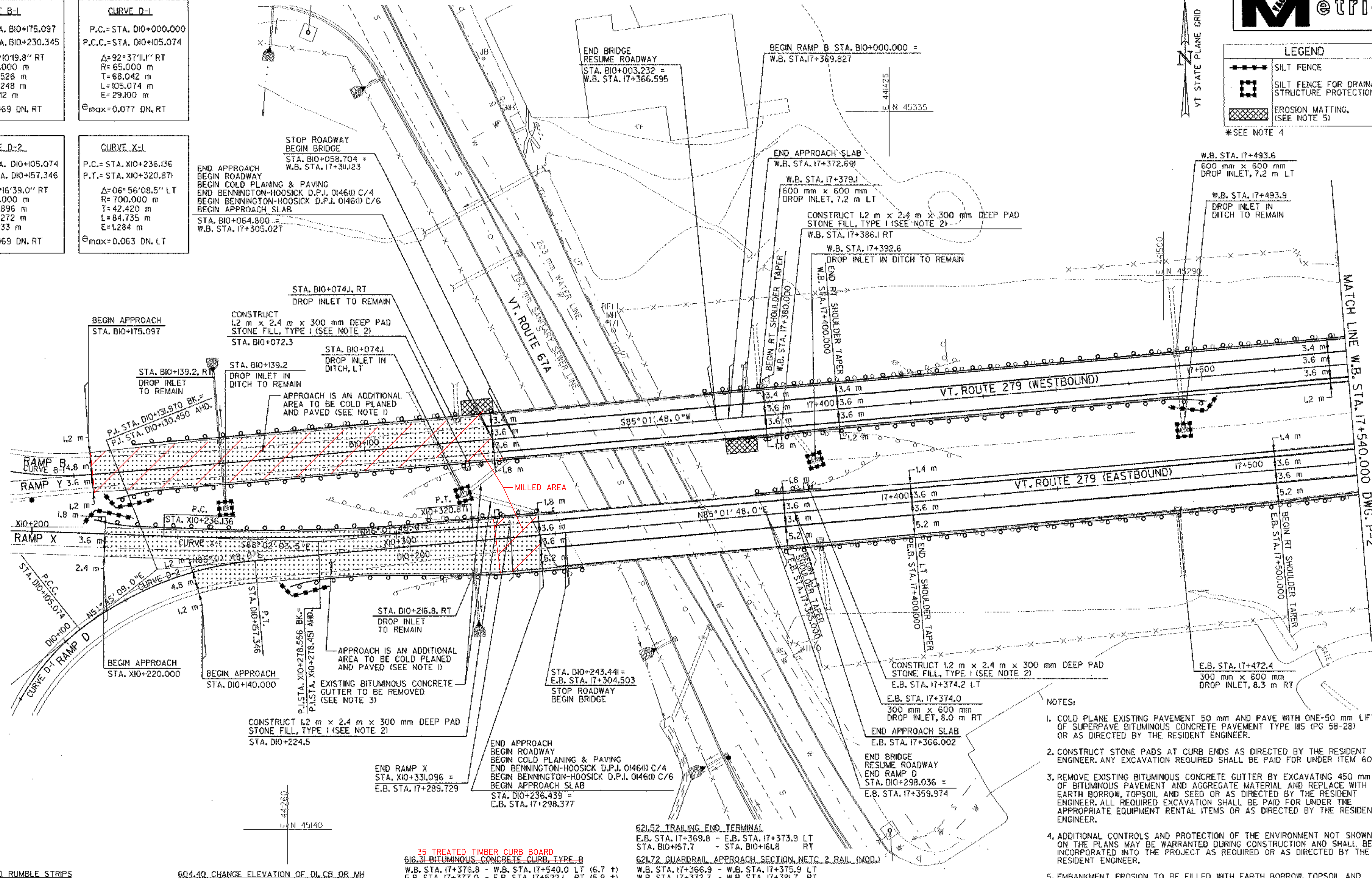

213.0 MILLED RUMBLE STRIPS

W.B. STA. 17+377.8	-	W.B. STA. 17+540.0	LT (162.2 m)
W.B. STA. 17+383.6	-	W.B. STA. 17+540.0	RT (156.4 m)
E.B. STA. 17+371.7	-	E.B. STA. 17+522.1	LT (150.4 m)
E.B. STA. 17+378.0	-	E.B. STA. 17+522.1	RT (144.1 m)
STA. X10+140.0	-	STA. B10+070.4	RT (81.6 m)
STA. X10+067.0	-	STA. X10+250.0	RT (83.0 m)
STA. X10+160.0	-	STA. X10+329.0	LT (169.7 m)
STA. B10+067.0	-	STA. B10+145.0	RT (69.0 m)
STA. D10+190.0	-	STA. D10+232.4	RT (42.4 m)

604.40 CHANGE ELEVATION OF DI, CB, OR MH

W.B. STA. 17+379.1	LT		
W.B. STA. 17+493.6	LT		
E.B. STA. 17+374.0	RT		
E.B. STA. 17+472.4	RT		
STA. B10+074.1	LT		
W.B. STA. 17+366.9	-	W.B. STA. 17+376.8	LT (9.9 m)
W.B. STA. 17+372.7	-	W.B. STA. 17+384.9	RT (12.2 m)
E.B. STA. 17+360.8	-	E.B. STA. 17+373.0	LT (12.2 m)
E.B. STA. 17+367.1	-	E.B. STA. 17+377.0	RT (9.9 m)
STA. B10+059.5	-	STA. B10+071.7	LT (12.2 m)
STA. B10+065.1	-	STA. B10+075.0	RT (9.9 m)
STA. D10+225.1	-	STA. D10+237.3	LT (12.2 m)
STA. D10+233.4	-	STA. D10+243.3	RT (9.9 m)

35 TREATED TIMBER CURB BOARD

616.31 BITUMINOUS CONCRETE CURB, TYPE B

W.B. STA. 17+376.8	-	W.B. STA. 17+540.0	LT (6.7 ft)
E.B. STA. 17+377.0	-	E.B. STA. 17+522.1	RT (5.9 ft)
STA. B10+075.0	-	STA. B10+150.0	RT (3.1 ft)
STA. D10+203.4	-	STA. D10+233.4	RT (11.2 ft)

621.20 STEEL BEAM GUARDRAIL

W.B. STA. 17+375.9	-	W.B. STA. 17+540.0	LT (164.1 m)
W.B. STA. 17+381.7	-	W.B. STA. 17+491.9	RT (110.2 m)
E.B. STA. 17+376.1	-	E.B. STA. 17+522.1	RT (145.0 m)
STA. B10+068.5	-	STA. B10+155.9	LT (87.4 m)
STA. B10+074.1	-	STA. B10+157.7	RT (83.6 m)
STA. D10+177.3	-	STA. D10+234.3	RT (57.0 m)
STA. X10+229.0	-	STA. X10+331.6	LT (102.6 m)

621.505 MANUFACTURED TERMINAL SECTION (FLARED)

W.B. STA. 17+491.9	RT (IEA)
STA. B10+155.9	LT (IEA)
STA. D10+177.3	RT (IEA)
STA. X10+229.0	LT (IEA)

621.52 TRAILING END TERMINAL

E.B. STA. 17+369.8	-	E.B. STA. 17+373.9	LT
STA. B10+157.7	-	STA. B10+161.8	RT

621.72 GUARDRAIL APPROACH SECTION, NETC 2 RAIL (MOD.)

W.B. STA. 17+366.9	-	W.B. STA. 17+375.9	LT
W.B. STA. 17+372.7	-	W.B. STA. 17+381.7	RT
E.B. STA. 17+360.8	-	E.B. STA. 17+369.8	LT
E.B. STA. 17+367.1	-	E.B. STA. 17+376.1	RT
STA. B10+059.5	-	STA. B10+068.5	LT
STA. B10+065.1	-	STA. B10+074.1	RT
STA. D10+228.3	-	STA. D10+237.3	LT
STA. D10+234.3	-	STA. D10+243.3	RT

621.80 REMOVAL AND DISPOSAL OF GUARDRAIL

W.B. STA. 17+366.9	-	W.B. STA. 17+540.0	LT (173.1 m)
W.B. STA. 17+372.7	-	W.B. STA. 17+432.6	RT (59.9 m)
E.B. STA. 17+360.8	-	E.B. STA. 17+392.3	LT (31.5 m)
E.B. STA. 17+367.1	-	E.B. STA. 17+522.1	RT (155.0 m)
STA. B10+059.5	-	STA. B10+090.6	LT (31.1 m)
STA. B10+065.1	-	STA. B10+119.4	RT (54.3 m)
STA. X10+281.1	-	STA. X10+331.6	LT (50.5 m)
STA. D10+194.5	-	STA. D10+243.3	RT (48.8 m)
STA. D10+228.3	-	STA. D10+237.3	LT (9.0 m)

DATUM

VERTICAL	NAVD 88
HORIZONTAL	NAD 83 (1992)

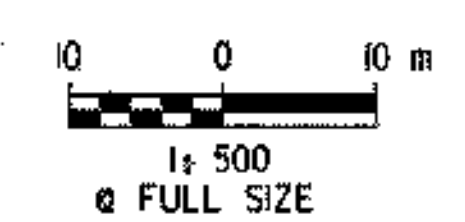

PLAN

SURVEYED BY	C.H.A. & V.S.E.	DATE	12/93
DESIGNED BY	D.W.E.	DATE	2/04
DRAWN BY	C.A.K.	DATE	2/04
CHECKED BY	D.E.G.	DATE	2/04
DESIGN FILE NO.	PLAN01.DGN		
PROJ. NAME	BENNINGTON - HOOSICK D.P.I. 0146(I) C/6		
PROJ. NO.	P.I.N. 1306.60		
DWG. NO.	P-1	SHEET	20 OF 83

FILE NAME = \\V16116\project\contract\ac\plan\plan21.dgn
DATE/TIME = 2/18/2004 10:52:22
USER = 2228