

NOTES:

- SITE LIGHTS SHALL BE MOUNTED ON CONCRETE BASES PER VTRANS STANDARD E-180B WITH BASE TO PROJECT 30' ABOVE PAVEMENT SURFACE (SEE DETAIL ON SHEET 3).
- AT EACH NEW LIGHT POLE LOCATION SPECIFIED, INSTALL A CONCRETE POLE BASE, STAINLESS STEEL ANCHOR BOLTS, NUTS AND WASHERS (FLAT AND LOCK), NEW STEEL POLE, LUMINAIRE ARM, LUMINAIRE, PHOTO CELL, WIRING, AND WATERPROOF DISCONNECT KITS.
- CONTRACTOR SHALL MAKE CONTACT WITH AND PERFORM WORK IN COMPLIANCE WITH THE ELECTRIC UTILITY COMPANY.
- COMPACT STRUCTURAL BACKFILL AROUND CONCRETE BASE TO 95% MAXIMUM DENSITY STANDARD PROCTOR.
- CONDUIT LOCATION SHOWN ON PLANS IS APPROXIMATE. FINAL LOCATION TO BE DETERMINED BY THE ENGINEER. ALL PARK & RIDE LIGHTS TO BE CONNECTED TO THE NEW POWER STANCHION.
- THE NEW POWER DROP STANCHION SHALL BE INSTALLED PER VTRANS STANDARD E-175 OPTION #1, IN A LOCATION ACCEPTABLE TO THE UTILITY OWNER. ALL WORK, MATERIALS AND LABOR ASSOCIATED WITH ITS INSTALLATION SHALL BE PAID UNDER POWER DROP STANCHION, STREET LIGHTING.

LEGEND	
○	TYPE P SITE LIGHT
○	TYPE A SITE LIGHT
■	FIBERGLASS PAD AND CABINET
■ JB	JUNCTION BOX
— UE —	EXISTING UNDERGROUND ELECTRIC
— UE —	UNDERGROUND ELECTRICAL
— UTV —	UNDERGROUND CATV
— UT —	UNDERGROUND TELEPHONE
— E —	OVERHEAD ELECTRICAL
A	CONDUIT SCHEDULE KEY TAG

SITE LOCATION & CIRCUITING SCHEDULE				
SITE LIGHT	STATION	OFFSET	CIRCUIT	VOLTAGE
A-1	31+47.00	68.00,LT	6,8	MULTI-TAP WIRED 240V
A-2	32+14.00	0.00,LT	6,8	MULTI-TAP WIRED 240V
A-3	31+65.00	68.00,RT	2,4	MULTI-TAP WIRED 240V
A-4	30+90.00	68.00,RT	2,4	MULTI-TAP WIRED 240V
B-1	30+32.00	97.80,LT	7,9	MULTI-TAP WIRED 240V
B-2	30+26.75	10.20,LT	2,4	MULTI-TAP WIRED 240V
P-1	31+28.80	0.00,LT	2,4	MULTI-TAP WIRED 240V

14.20, RT

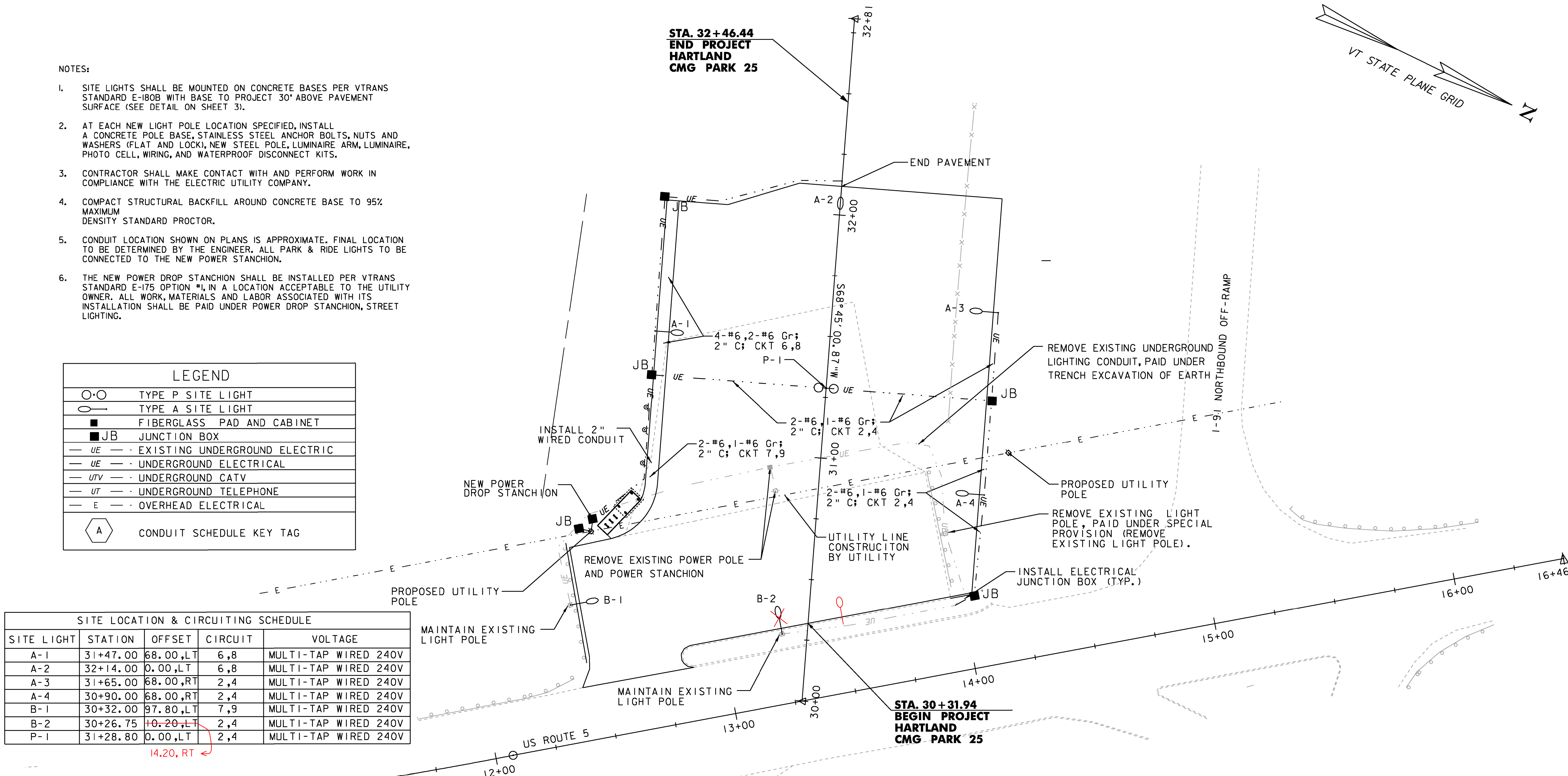

SITE LIGHTING SCHEDULE									
TYPE	QUANTITY PER POLE	LAMP TYPE	LAMP WATTAGE	OPTICS TYPE	OPTICS DISTRIBUTION	LENS TYPE	MOUNTING HEIGHT	REMARKS	QUANTITY ON PROJECT
P	2	LED	105	FULL-CUT-OFF	IES AREA 5	N/A	20 FT.	IES AREA 5	1
A	1	LED	105	FULL-CUT-OFF	IES TYPE III	N/A	20 FT.	IES TYPE III	4
B	1	LED	105	FULL-CUT-OFF	IES TYPE A	N/A	20 FT.	IES TYPE A	2

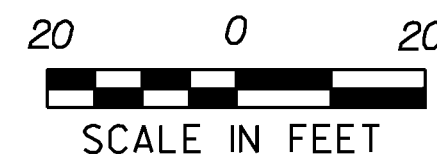

Hoyle, Tanner & Associates, Inc.

HTA PROJECT 904221	MODEL z20k154LGT
-----------------------	---------------------

PROJECT NAME: HARTLAND
PROJECT NUMBER: CMG PARK(25)

FILE NAME: Z20k154light.dgn
PROJECT LEADER: WAYNE L. DAVIS
DESIGNED BY: JCC

LIGHTING & ELECTRICAL PLAN

PLOT DATE: 9/16/2013
DRAWN BY: JCC
CHECKED BY: CRM
SHEET 18 OF 30