

- LEGEND**
- ERW = END ROAD WORK
 - RW500 = ROAD WORK 500 FT
 - RWA = ROAD WORK AHEAD
 - RWN = ROAD WORK NEXT XX MILES
 - SRW500 = SIDE ROAD WORK 500 FT
 - SRWA = SIDE ROAD WORK AHEAD
 - CLOSED = PARK & RIDE CLOSED

LOCATION	ERW	RW500	RWA	RWN	SRW500	SRWA	CLOSED
US ROUTE 5							
EAST OF SITE	1				2	2	
WEST OF SITE	1				2	2	
I-91 NB OFF RAMP						2	
PARK AND RIDE							1
TOTALS	2				4	6	1

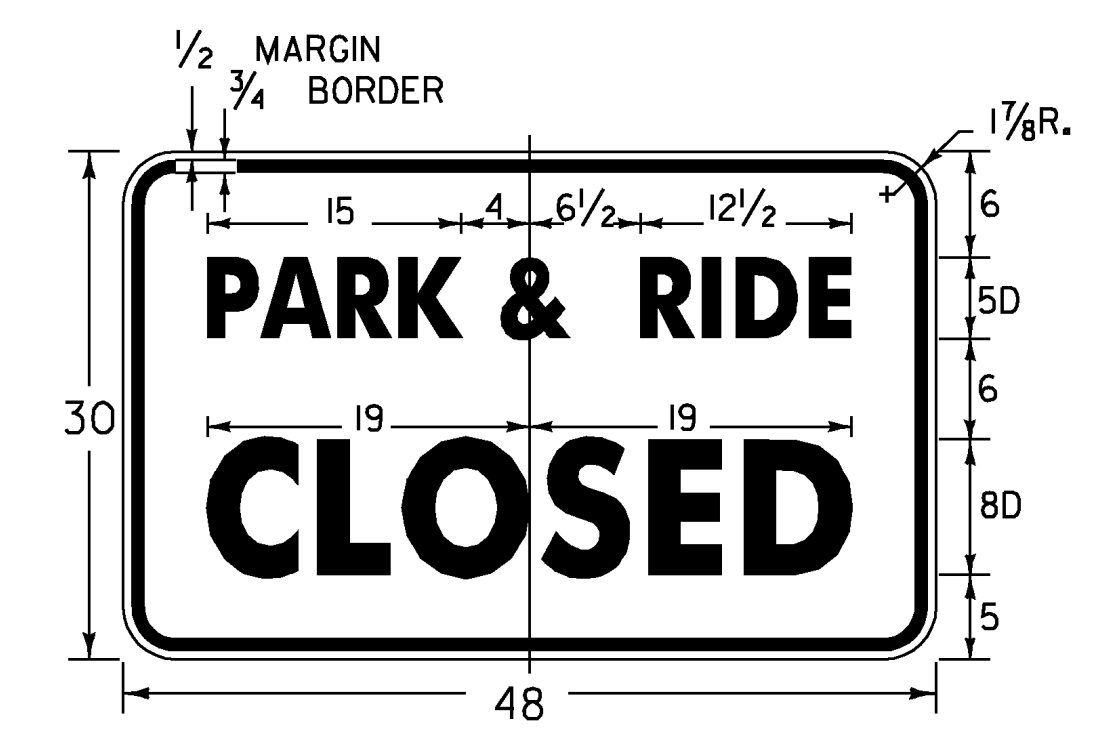
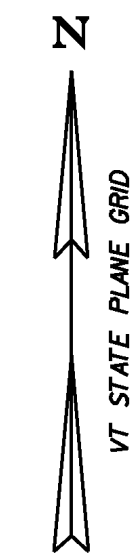
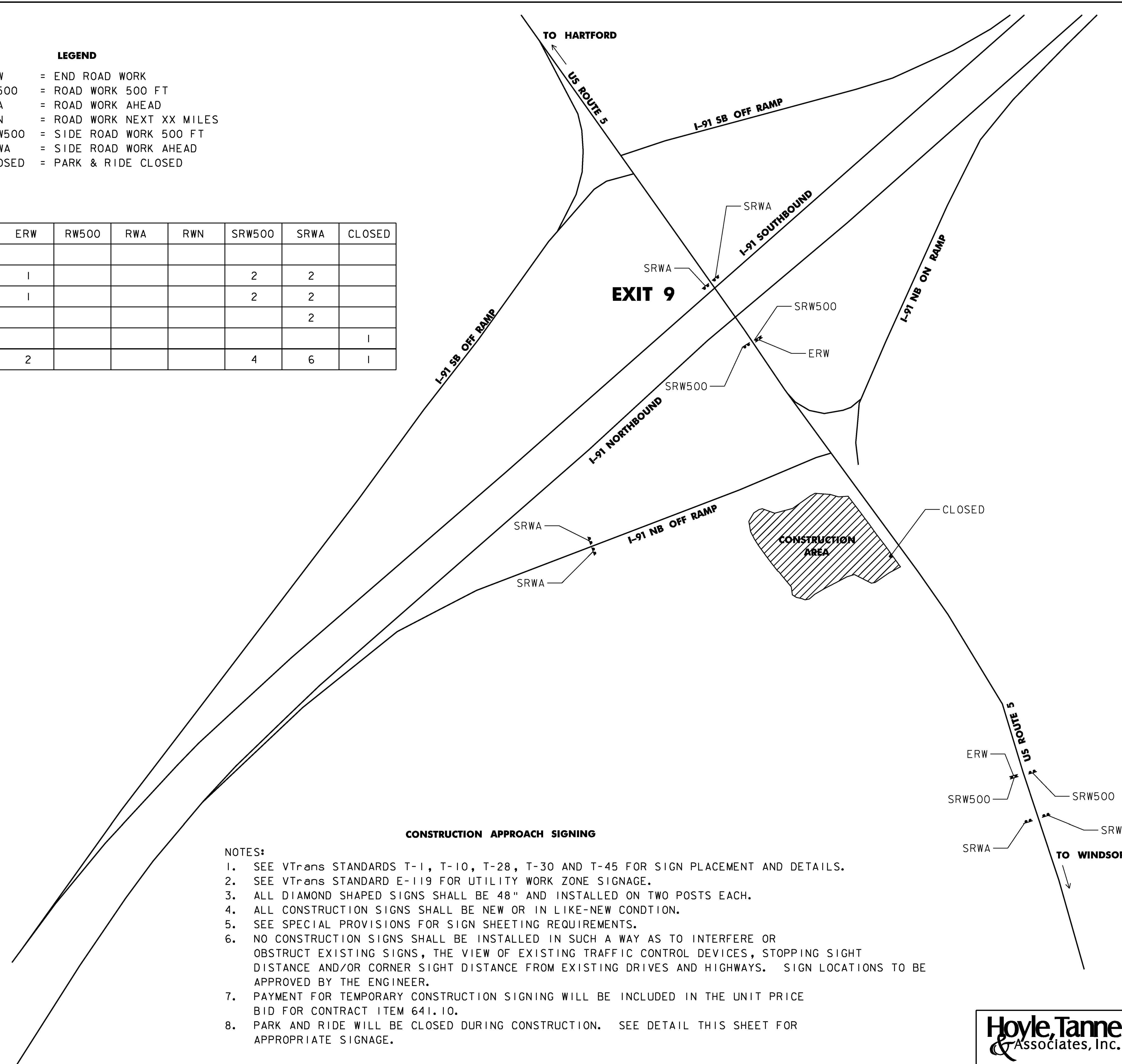

COLORS:
 BLACK TEXT AND BORDER
 WHITE REFLECTORIZED BACKGROUND

CONSTRUCTION APPROACH SIGNING

- NOTES:
1. SEE VTrans STANDARDS T-1, T-10, T-28, T-30 AND T-45 FOR SIGN PLACEMENT AND DETAILS.
 2. SEE VTrans STANDARD E-119 FOR UTILITY WORK ZONE SIGNAGE.
 3. ALL DIAMOND SHAPED SIGNS SHALL BE 48" AND INSTALLED ON TWO POSTS EACH.
 4. ALL CONSTRUCTION SIGNS SHALL BE NEW OR IN LIKE-NEW CONDITON.
 5. SEE SPECIAL PROVISIONS FOR SIGN SHEETING REQUIREMENTS.
 6. NO CONSTRUCTION SIGNS SHALL BE INSTALLED IN SUCH A WAY AS TO INTERFERE OR OBSTRUCT EXISTING SIGNS, THE VIEW OF EXISTING TRAFFIC CONTROL DEVICES, STOPPING SIGHT DISTANCE AND/OR CORNER SIGHT DISTANCE FROM EXISTING DRIVES AND HIGHWAYS. SIGN LOCATIONS TO BE APPROVED BY THE ENGINEER.
 7. PAYMENT FOR TEMPORARY CONSTRUCTION SIGNING WILL BE INCLUDED IN THE UNIT PRICE BID FOR CONTRACT ITEM 641.10.
 8. PARK AND RIDE WILL BE CLOSED DURING CONSTRUCTION. SEE DETAIL THIS SHEET FOR APPROPRIATE SIGNAGE.

Hoyle, Tanner & Associates, Inc.

HTA PROJECT 90422I	MODEL Z02KI54const
-----------------------	-----------------------

PROJECT NAME: HARTLAND	PROJECT NUMBER: CMG PARK(25)
FILE NAME: Z20KI54const.dgn	PLOT DATE: 9/30/2013
PROJECT LEADER: WAYNE L. DAVIS	DRAWN BY: JCC
DESIGNED BY: JCC	CHECKED BY: CRM
CONSTRUCTION APPROACH SIGNING	SHEET 12 OF 30

9/30/2013 10:54 AM
 C:\Users\jcc\OneDrive\Documents\2013\90422I.dgn