

INDEX OF SHEETS

- 1 TITLE SHEET
- 2 QUANTITY SHEET
- 3 RIGHT-OF-WAY PLAN
- 4 LAYOUT PLAN
- 5 LIGHTING PLAN
- 6 LIGHTING DETAILS 1
- 7 LIGHTING DETAILS 2
- 8 LIGHTING DETAILS 3
- 9 CONSTRUCTION APPROACH SIGNS
- 10 EROSION CONTROL PLAN
- 11 EROSION CONTROL DETAILS
- 12 EROSION CONTROL NOTES
- 13 GENERAL DETAILS
- 14 SIGN DETAILS

VTRANS DESIGN STANDARDS

E - 100	CONSTRUCTION APPROACH SIGNS	01/02/04
E - 100A	SIDE ROAD CONSTRUCTION APPROACH SIGNS	01/02/04
E - 144	REGULATORY SIGN DETAILS	03/29/99
E - 160	FLANGED CHANNEL SIGN POST	05/20/99
E - 173	PULLBOXES AND JUNCTION BOXES	08/09/95
E - 175	POWER DROP STANCHIONS	11/17/93
E - 180A	STREET LIGHTING DETAILS	08/09/95
E - 180B	STREET LIGHTING DETAILS	08/09/95
E - 193	PAVEMENT MARKING DETAILS	08/18/95
E - 164	SQUARE STEEL SIGN POST	05/20/99

STATE OF VERMONT AGENCY OF TRANSPORTATION



PROPOSED IMPROVEMENT TOWN OF BARRE COUNTY OF WASHINGTON COMMUTER PARK-AND-RIDE LOT

THIS PROJECT IS LOCATED ON THE WEST SIDE OF VT ROUTE 14 IN THE TOWN OF BARRE,
NORTH OF THE VT ROUTE 14 AND VT ROUTE 63 INTERSECTION.

WORK TO BE PERFORMED UNDER THIS PROJECT INCLUDES NEW LIGHTING WITH OTHER APPURTENANCES, NEW PAVEMENT MARKINGS, AND SIGNS.

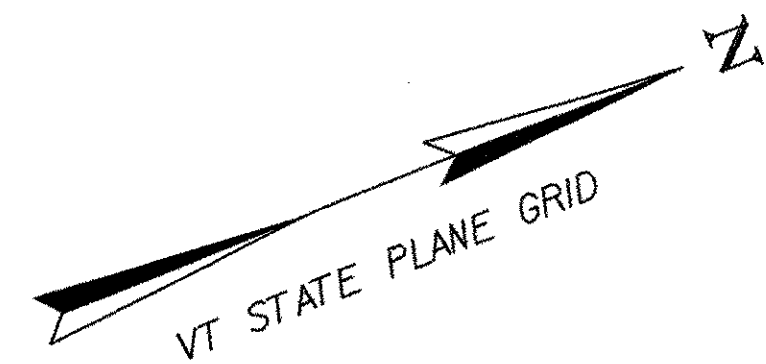
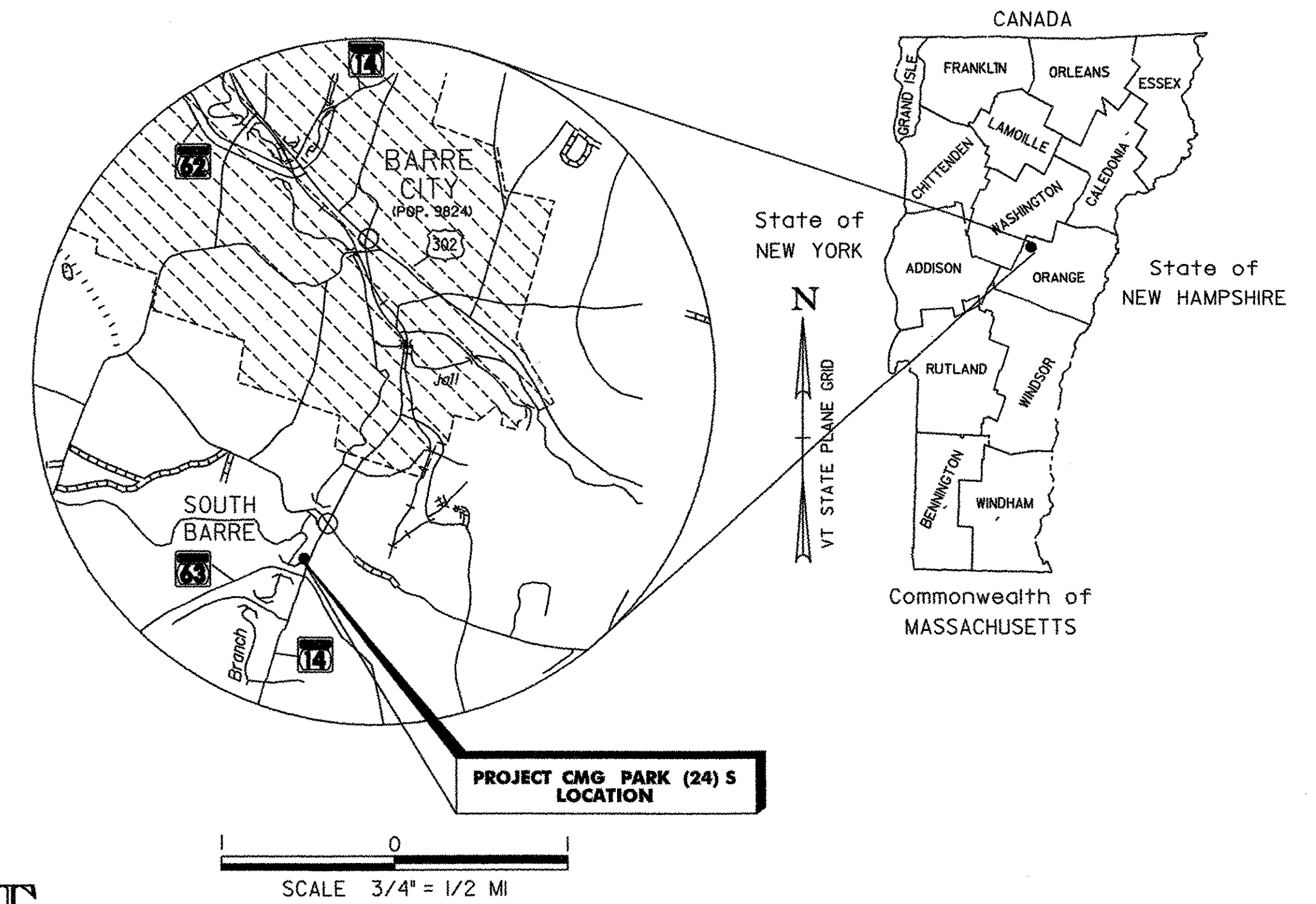

RECORD PLANS	
CONTRACTOR:	TREMBLAY CONSTRUCTION, LLC - WASHINGTON, VT
RESIDENT ENGINEER:	CARL FIELDER
CONSTRUCTION BEGAN:	JULY 18, 2006
CONSTRUCTION COMPLETE:	DECEMBER 6, 2006
RECORD PLANS BY:	CARL FIELDER
I HEREBY CERTIFY THAT ALL THE CONSTRUCTION REQUIRED BY THIS SET OF DRAWINGS HAS BEEN ACCOMPLISHED AS INDICATED HEREIN.	
BY:	<i>Carl Fielder</i> RESIDENT ENGINEER
DATE:	8/9/07
NOTE: Any further information concerning final quantities, amounts or other details relative to this project may be found at Central Files in the electronic archives.	

CONVENTIONAL SYMBOLS	
COUNTY LINE	
TOWN LINE	
LIMITS OF ACCESS	
POINT OF ACCESS	
FENCE LINE	
STONE WALL	
TRAVELED WAY	
GUARD RAIL	
RAILROAD	
SURVEY LINE	
CULVERT	
POWER POLE	
TELEPHONE POLE	
TREES	
CONTROL OF ACCESS	
PROPERTY LINE	
R.O.W. TAKING LINE	
SLOPE RIGHTS	
TOP OF CUT	
TOE OF SLOPE	

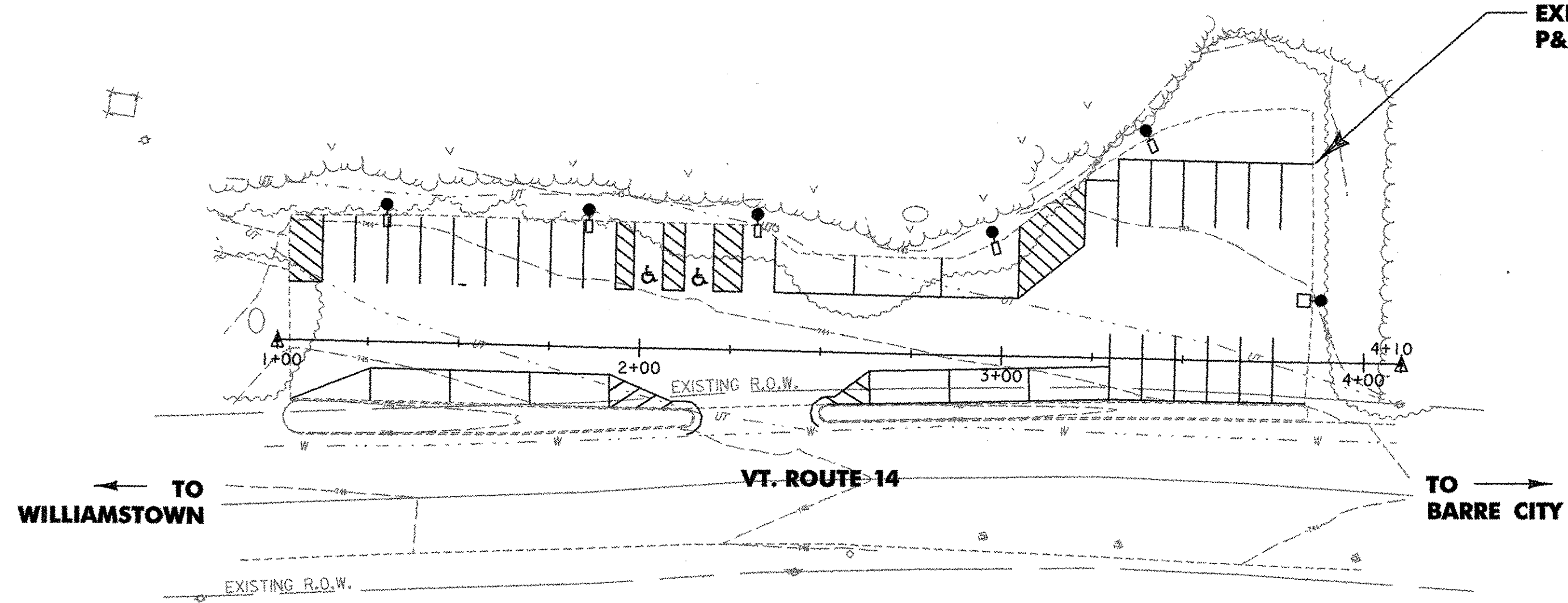

SURVEYED BY :	VSE
SURVEYED DATE :	JUNE, 2005
DATUM	
VERTICAL	NAVD 88
HORIZONTAL	NAD 83

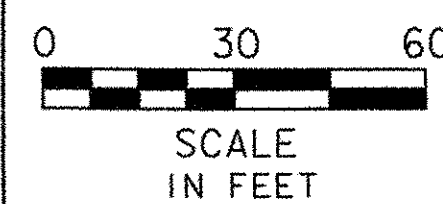

BUILT AS DESIGNED

THESE PLANS ARE SUBJECT TO SUCH ENGINEERING CHANGES AS MAY BE REQUIRED BY THE FEDERAL HIGHWAY ADMINISTRATION OR THE DIRECTOR OF PROGRAM DEVELOPMENT.
CONSTRUCTION IS TO BE CARRIED ON IN ACCORDANCE WITH THESE PLANS AND THE STANDARD SPECIFICATIONS FOR CONSTRUCTION DATED 2001, AS APPROVED BY THE FEDERAL HIGHWAY ADMINISTRATION ON JANUARY 4, 2001 FOR USE ON THIS PROJECT, INCLUDING ALL SUBSEQUENT REVISIONS AND SUCH REVISED SPECIFICATIONS AND SPECIAL PROVISIONS AS ARE INCORPORATED IN THESE PLANS.

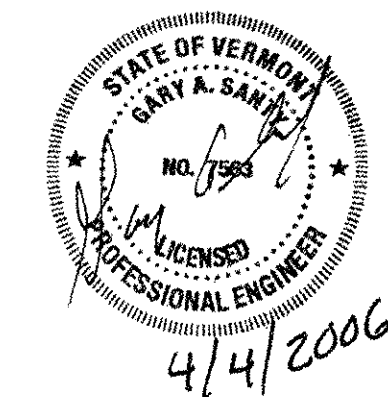

DIRECTOR OF PROGRAM DEVELOPMENT	
APPROVED <i>Richard Johnson</i>	DATE 4-5-06
PROJECT MANAGER : WAYNE L. DAVIS	
PROJECT NAME : BARRE TOWN	
PROJECT NUMBER : CMG PARK (24) S	
SHEET 1 OF 14 SHEETS	

